

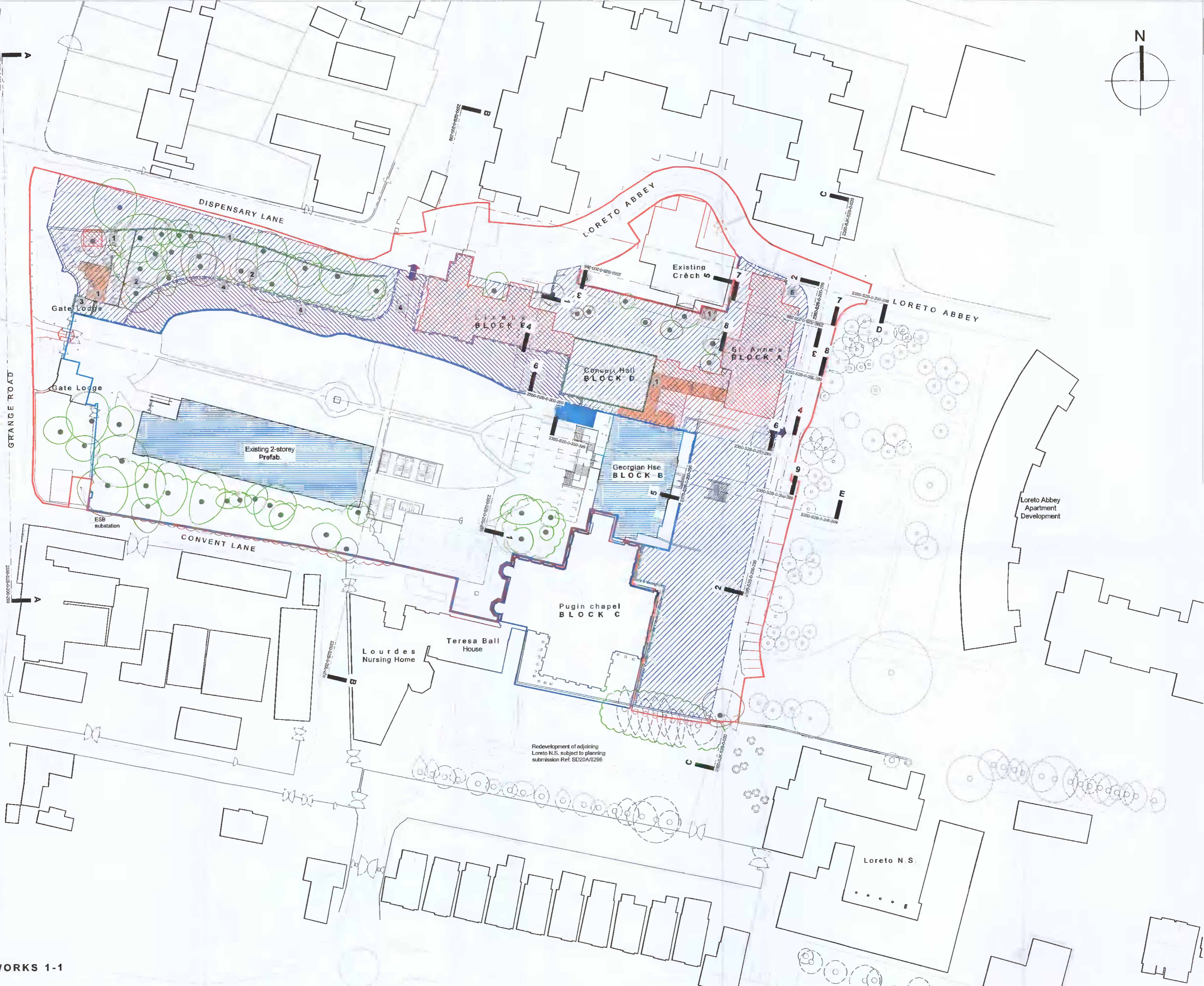

- LEGEND**
- Contractors site area
 - Site area in-use by school
 - Site area shared by school and contractors
 - Proposed demolition
 - Proposed building works
 - School building in-use
 - Temporary WC accommodation. The layout is indicative only and subject to suppliers detail.
 - Construction site access
 - Staff and Student campus access
 - Erect 2m plywood hoarding
 - Erect 3m high protective hoarding around historic structures
 - Existing trees adjacent to site
 - Existing trees on site
 - Existing trees to be removed on site
 - Existing vegetation on site
 - Existing vegetation to be removed on site
- 1 Demolitions in accordance with 2350-SJK-S2B-0-023
 - 2 Holding works to original Gate Lodge
 - 3 Tree removal and protection accordance with 2350-SJK-S2B-0-030 and Austen Associates report
 - 4 Existing Dispensary Lane vehicle access route reconfigured to accommodate one-way vehicle route with set-down area and new egress route onto Dispensary Lane with pedestrian paths and new gates
 - 5 New palisade fence to boundary
New painted steel railings to boundary plinth wall



SITE PLAN: PHASING WORKS 1-1

Conditions of use of this drawing
 note: If this A1 size drawing is reproduced at a smaller size which makes these conditions difficult to read, please contact the Architects office for a legible copy of these conditions:
 1. This drawing is the design and contains copyright. All rights are reserved. No part thereof may be copied or reproduced in any form whatsoever without the written consent of the copyright owner, Simon J. Kelly Architects.
 2. This drawing is to be used only for the specific purpose for which it has been prepared. This drawing is not to be used for any other purpose, and no liability or responsibility is given as to the suitability for construction purposes, unless the purpose of this drawing is stated to be "construction" or "contract". If the purpose is stated to be "contract" this drawing is not to be used for construction if it does not contain "contract" or "contract".
 3. The Employer is granted a copyright license to use this drawing and its contents for the purpose for which the drawing has been prepared. If the drawing has been prepared for construction purposes the license will only be valid for a single construction project and shall expire once a single construction project has occurred. Any other license only passes to the Employer on payment of Architects fees in full and in any event the license cannot be assigned without the written consent of Simon J. Kelly Architects.
 4. Where the Architects provides or prepares drawings for the project which the copyright material was specifically prepared for, the Architects does not accept any liability whatsoever for the use of this drawing and its contents for any other purpose or project other than that for which it was specifically prepared. In copyright infringement in the drawing and its contents (in whole or in part) by any other person than that for which it was specifically prepared. In copyright infringement in the drawing and its contents (in whole or in part) by any other person than that for which it was specifically prepared. In copyright infringement in the drawing and its contents (in whole or in part) by any other person than that for which it was specifically prepared.

5. Do not scale off this drawing. Rigid metric dimensions only should be taken off this drawing. Imperial dimensions, if any, contained on this drawing are given for illustrative purposes only.
 6. All contractors, whether main or sub-contractors, must visit the site and are responsible for taking and checking any and all dimensions levels and the like that relate to the works.
 7. Where the drawing contains discrepancies in relation to other relevant documents, such discrepancies shall be brought to the attention of the Architects who shall issue a written instruction as to what information is to be followed, and will not be liable for any errors or omissions.
 8. Reference to National Standards whether to Irish (BSI) or otherwise, or codes of practice (COP) shall be deemed to refer to the relevant standard or code current at the date of issue of the drawing unless otherwise stated.
 9. Any reference to the "Architect" or "Architects" on this or any other relevant document shall mean the particular project Architect and/or a Director of Simon J. Kelly Architects who has been nominated as such in writing but only while such Architect remains in the employment of Simon J. Kelly Architects.
 10. Any queries as to the meaning or application of these conditions shall be submitted in writing to the Architect for their ruling and such a ruling shall be conclusive as to the meaning or application of these conditions.
 11. Simon J. Kelly Architects, their Agents, Architects, employees or directors shall not be liable for any loss, damage or injury consequential or otherwise to a person or property arising from the use of this drawing and its contents for any other purpose or project other than that for which it was specifically prepared.
 12. Should anyone copy this drawing in whole or in part with or without consent and use the copy in relation to a purpose not for which it was specifically prepared, such use is at the sole and exclusive risk of the copier and Simon J. Kelly Architects do not accept any liability whatsoever for use in relation to such use.

13. Should anyone copy this drawing in whole or in part with or without consent they should also copy these conditions of use in full and reproduce them with the copy. These conditions of use are to be read in conjunction with the drawing and its contents. These conditions of use form part of the drawing and its contents and are the property of the Architects and its contents.
 14. The use of or reliance upon this drawing and/or its contents shall be deemed to be acceptance of these conditions of use unless otherwise agreed in writing, and written agreement to be signed for and issued by the Architects prior to the use or reliance upon the drawing and its contents.
 15. All drawings are to be read in conjunction with the fire safety compliance report, all other contract documents, all statutory consents and all regulations and all statutory obligations.

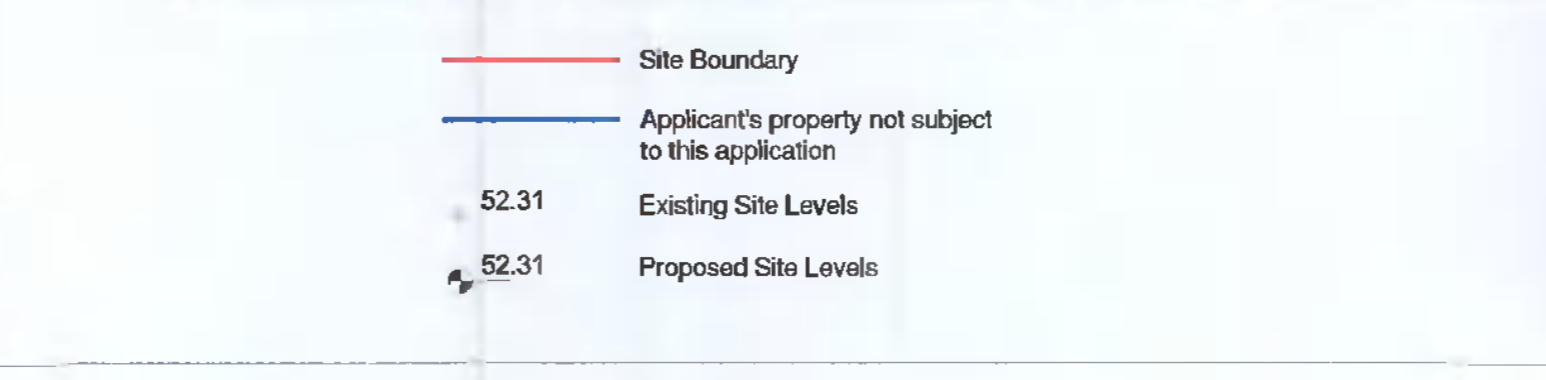

preliminary
not for construction

<p>PROJECT: Gaelscoil na nPhiarasáigh - Loreto Abbey, Rathfarnham</p> <p>CLIENT: Department of Education / Board of Management</p> <p>DRAWING: Department of Education / Board of Management Site Plan - Phasing of Works, 1-1</p>			
<p>DRAWING PURPOSE: Planning</p> <p>DRAWING SIZE: A1</p>	<p>DRAWN BY: CUJK</p> <p>SCALE: 1:500</p>	<p>APPROVED: [Signature]</p> <p>DATE: March '22</p>	<p>DATE: March '22</p> <p>REV. NO.: A</p>
<p>DRAWING REFERENCE: 2350-SJK-S2B-0-010</p>		<p>CONTACT: 1 Mount Street Crescent, Dublin 2, D02 XE57 +353 1 676 4128 info@pjk.ie www.pjk.ie</p>	
<p>CONTACT: Fitzgerald Kavanagh + Partners 1 Mount Street Crescent, Dublin 2, D02 XE57 +353 1 676 4128 info@pjk.ie www.pjk.ie</p>		<p>CONTACT: Simon J. Kelly Architects 21 Middle Street, Galway +353 91 56 2949 Cora Yard, Westport, Mayo +353 88 24 414 info@sjka.ie www.sjka.ie</p>	