

This drawing is to be read in conjunction with the respective arboricultural schedules and reports relevant to this project.  
 Where contradictions between this drawing and any other design information becomes apparent, the respective authors should be contacted immediately.  
 It is the responsibility of the main site contractor to check and verify all information and measurements onsite and confirm prior to the commencement of works, and to ensure that all site operatives work in accordance with respective arboricultural reports and BS5837:2012. Trees in relation to design, demolition and construction.

**BS5837:2012 Tree Categorisation**

	<b>Category A</b> Trees of high quality with an estimated remaining life expectancy of at least 40 years
	<b>Category B</b> Trees of moderate quality with an estimated life expectancy of at least 20 years
	<b>Category C</b> Trees of low quality with an estimated life expectancy of at least 10 years, or young trees with a stem diameter below 150mm
	<b>Category U</b> Those in such a condition that they cannot realistically be retained as living trees in the context of the current land use for longer than 10 years

**Key**

	<b>Root Protection Areas</b> The minimum area around a tree deemed to contain sufficient roots and rooting volume to maintain the trees viability.
	Tree, Shrub or Hedgerow Group.
<b>T70</b>	Reference Number for Tree or Group.
	Existing site levels.

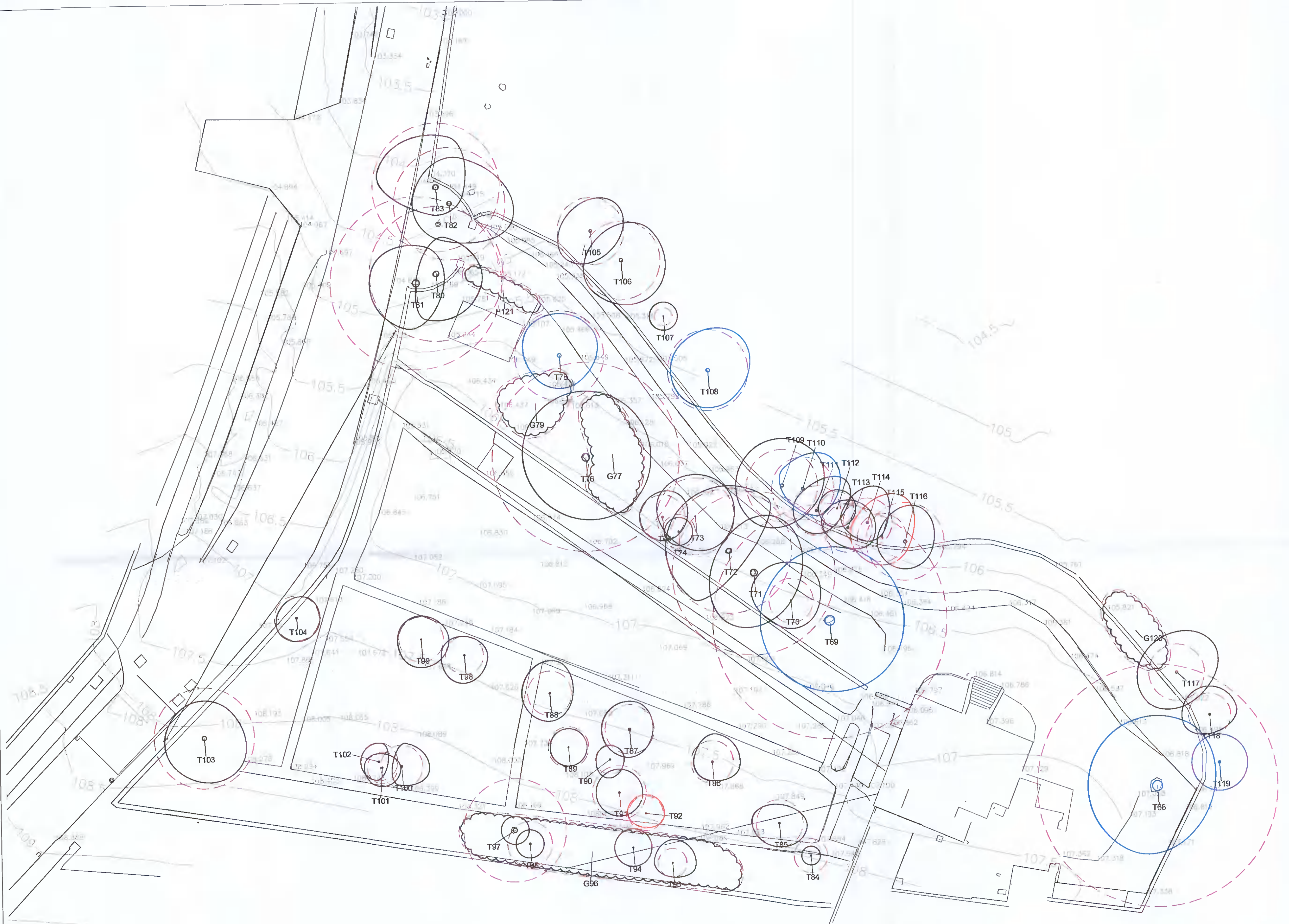

Revision	Date	Description

Title	
<b>Tree Survey Plan</b>	
Project	
<b>Prospect House, Stocking Lane, Ballyboden, Co. Dublin</b>	
Client	
<b>MSJA Ltd.</b>	
Date	May 2022
Scale	1:200 @ A1
Status	Planning
Drawn by	CMCC
Dwg ref	190215-P-20
Checked by	CMCC
Rev	-

This drawing is the copyright of Charles McCorkell Arboricultural Consultancy. It has been produced for the client and project as stated above. This drawing may not be reproduced or amended, except by the written permission of Charles McCorkell Arboricultural Consultancy. No liability will be accepted for any amendments made by other persons.

**CHARLES MCCORKELL**  
ARBORICULTURAL CONSULTANCY

T: 085 843 7015 / E: charles@cmrbor.com / W: www.cmrbor.com