

GLAS VIEW

NUMBER 79 IS A 2 STOREY 3 BED SEMI-DETACHED HOUSE OF TOTAL AREA 100 M²

NUMBER 79A IS A 2 STOREY 3 BED DETACHED HOUSE OF TOTAL AREA 97 M²

THE TOTAL OVERALL SITE AREA IS 358 M².

THE SITE AREA OF NUMBER 79 IS 190 M², THE SITE AREA OF NUMBER 79A IS 170 M².

PRIVATE OPEN SPACE NUMBER 79 IS 60 M² PRIVATE OPEN SPACE NUMBER 79A IS 61 M²

NUMBER 79 IS PROVIDED WITH 2 CAR PARKING SPACES AS THE PROPOSED NEW HOUSE NUMBER 79A IS LOCATED IN ZONE 2 (RESIDENTIAL) AND IS WITHIN 400M OF A BUS STOP 1 CAR PARKING SPACE IS PROVIDED IN ACCORDANCE WITH 11.4.2 CAR PARKING STANDARDS FROM THE COUNTY DEVELOPMENT PLAN.

PROPOSED NEW 2 STOREY 3 BEDROOM DETACHED DWELLING - NUMBER 79A

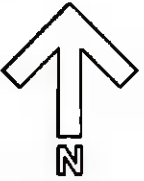
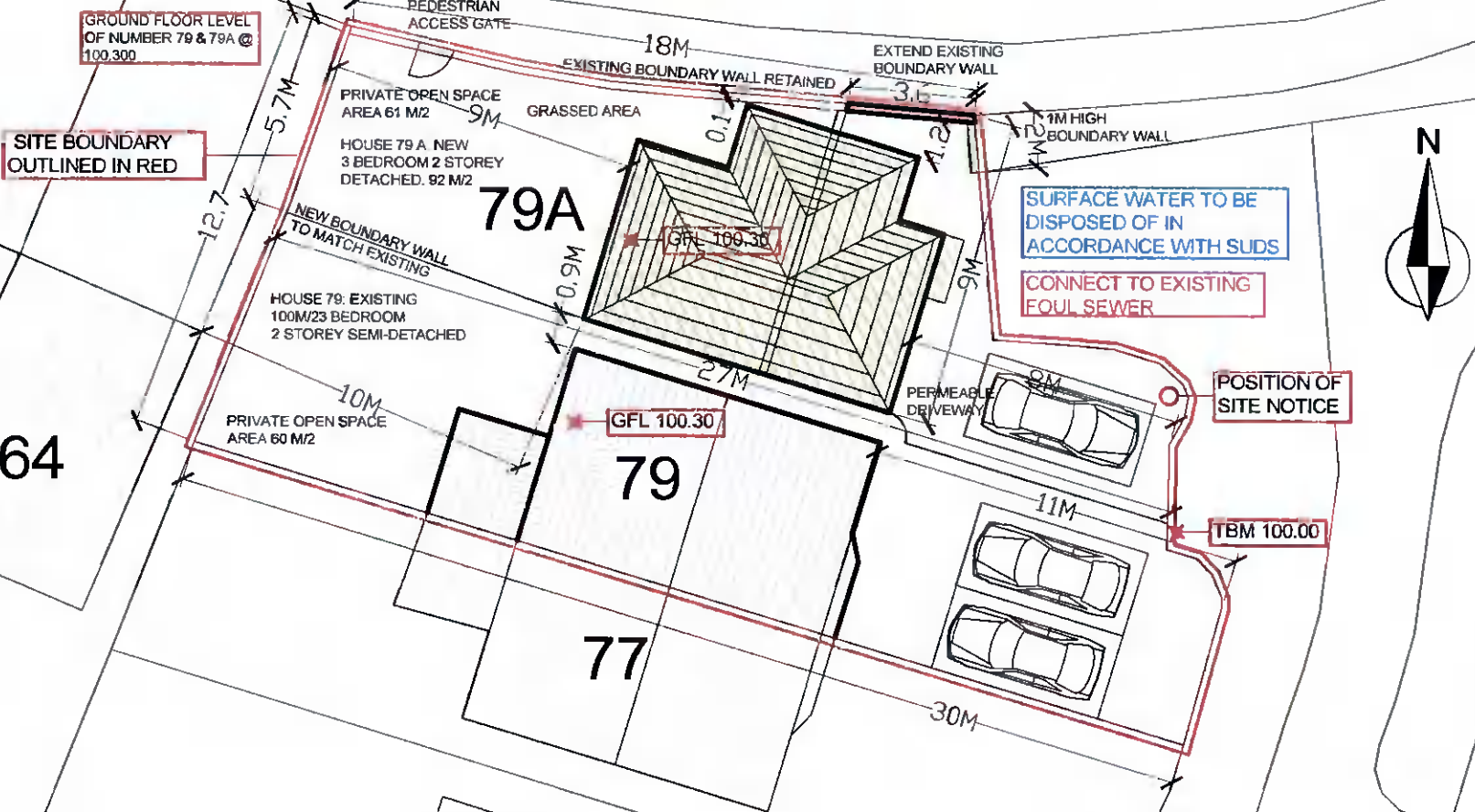

SITE BOUNDARY:

SITE AREA 0.0358 ha.

©COPYRIGHT OF JAMES BRYAN ARCHITECTURAL & PLANNING SERVICES

THIS DRAWING OR PART OF IS NOT TO BE REPRODUCED WITHOUT PRIOR WRITTEN CONSENT FROM JAMES BRYAN ARCHITECTURAL & PLANNING SERVICES

THIS DRAWING IS NOT TO BE USED FOR CONSTRUCTION

P.	Planning Application	02 06 2022
NO.	REVISION	DATE

James Bryan
Architectural & Planning Services

1307 Kili West, Kill, Co. Kildare, W61 A7X3. Tel: 045 878 983, 087 6881 843. e-mail: jamesgbryan@gmail.com

PROJECT:
79 Moy Glas Chase, Lucan, Co. Dublin, K78 Y962.

TITLE:
SITE LAYOUT PLAN

PROJECT NUMBER: 032/2021	DRAWING NUMBER:
DATE: 02 JUNE 2022	002 REVISION P
SCALE: 1:200 @ A3	

ORDNANCE SURVEY IRELAND LICENCE NO. 50244624

© ORDNANCE SURVEY IRELAND/
GOVERNMENT OF IRELAND

SITE LAYOUT PLAN
SCALE 1:200@A3
OS MAP REF: 3261 - 11, 3261 - 12. ITM CENTRE POINT CO-ORDINATE X, Y = 704654, 733548.
SUBJECT SITE OUTLINED IN RED