

GENERAL NOTES

1. DO NOT SCALE THIS DRAWING. WORK ONLY TO FIGURED DIMENSIONS.
2. FOR ALL RELEVANT NOTES, REFER TO STRUCTURAL AND CIVIL ENGINEERING PERFORMANCE SPECIFICATION.
3. ANY DISCREPANCIES ARE TO BE REPORTED TO PINNACLE CONSULTING ENGINEERS IMMEDIATELY.
4. THIS DRAWING IS TO BE READ IN CONJUNCTION WITH ALL OTHER RELEVANT ENGINEERS, ARCHITECTS AND SUB-CONTRACTORS DRAWINGS AND DETAILS.

LEGEND

- PROPOSED PRIVATE WATER SEWER
- PROPOSED PRIVATE FOUL SEWER
- EXISTING PRIVATE FOUL WATER SEWER
- EXISTING PRIVATE SURFACE WATER SEWER
- EXISTING PUBLIC FOUL SEWER
- EXISTING PUBLIC SURFACE WATER SEWER
- SURFACE WATER LAND DRAIN
- MANHOLE BACKDROP
- DRAINAGE CHANNE
- DRAINAGE RUN TO BE ABANDONED
- INTERNAL FOUL GULLY PIPE
- ROAD GULLY
- FLOODING EYE
- FOUL DRAINAGE HOUSE CONNECTION
- SOIL VENT PIPE
- STUB STACK
- AIR ADMITTANCE VALVE
- FOUL INTERCEPTOR TRAP
- RAINWATER DOWNPIPE
- SPRINKLER RAINWATER DOWNPIPE
- PROPOSED LEVEL
- EXISTING TIE IN LEVEL
- EXISTING LEVEL
- SITE BOUNDARY
- ATTENUATION TANK
- SURFACE SLOPE
- PROPOSED EXTERNAL ROAD UPGRADE

0 50MM ON A1 DWG. 50

PO2	RED BOUNDARY LINE UPDATED	FJVR	SO'R	MAY 2022
PO1	PLANNING SUBMISSION	FJVR	SO'R	APR 2022
REV	DESCRIPTION	BY	CHK	DATE
CLIENT				
CAPAMI LTD				

PROJECT
OLDCOURT
OCIL 4

DRAWING TITLE
PROPOSED FOUL & SURFACE
WATER DRAINAGE LAYOUT
SHEET 2 OF 2

PINNACLE
 CONSULTING ENGINEERS

GROSVENOR COURT,
 67A PATRICK STREET,
 DUN LAOGHAIRE,
 COUNTY DUBLIN
 IRELAND.

DRAWING STATUS			
PLANNING			
SCALE @ A1	DATE	DRAWN BY	CHECKED
1:500	JAN '22	FJVR	SO'R
DRG NO.	REVISION		
PI90302-254	P02		
COPYRIGHT PINNACLE			

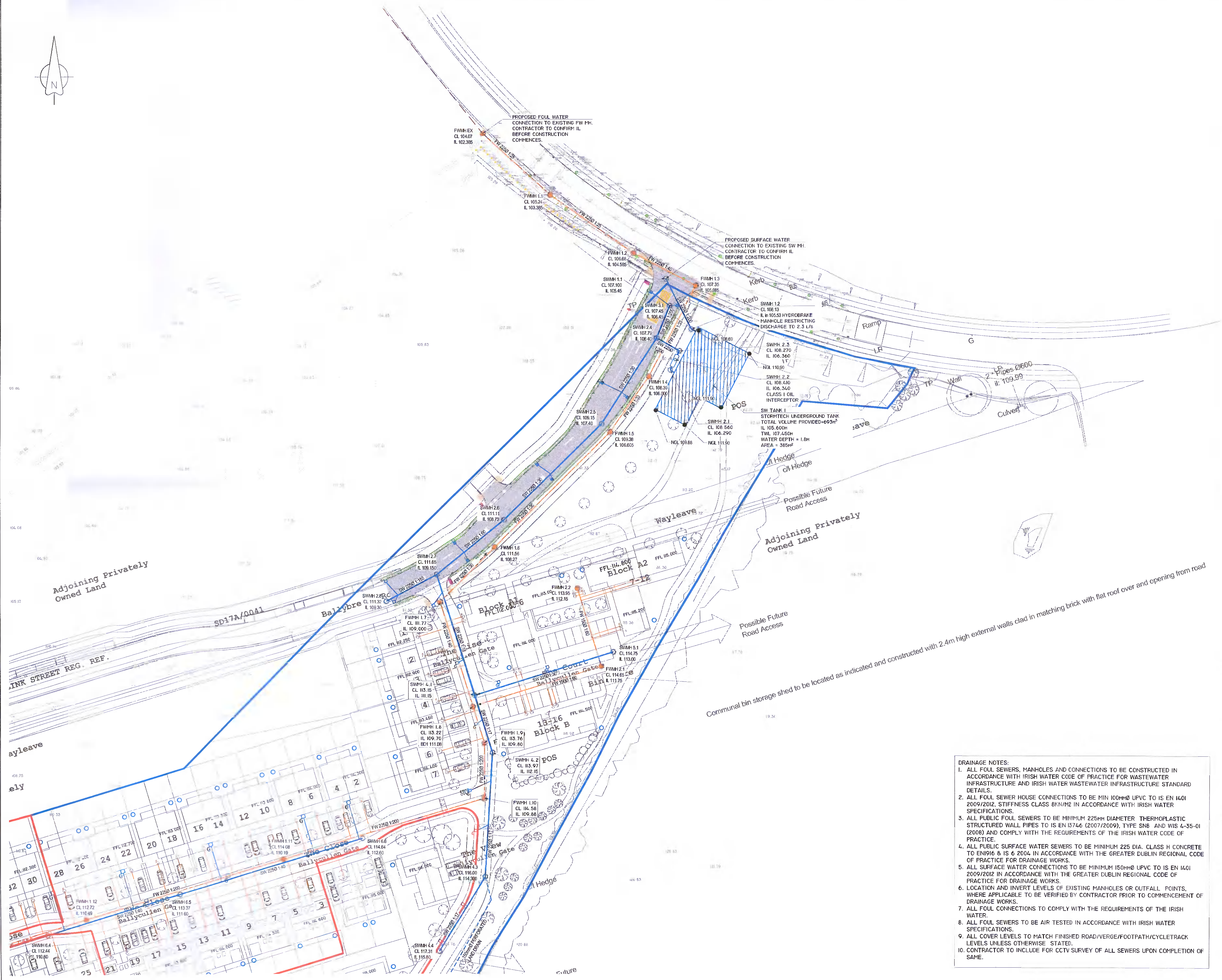

- #### DRAINAGE NOTES:
1. ALL FOUL SEWERS, MANHOLES AND CONNECTIONS TO BE CONSTRUCTED IN ACCORDANCE WITH IRISH WATER CODE OF PRACTICE FOR WASTEWATER INFRASTRUCTURE AND IRISH WATER WASTEWATER INFRASTRUCTURE STANDARD DETAILS.
 2. ALL FOUL SEWER HOUSE CONNECTIONS TO BE MIN 100mm Ø UPVC TO IS EN 1401 2009/2012 STIFFNESS CLASS 8kN/m² IN ACCORDANCE WITH IRISH WATER SPECIFICATIONS.
 3. ALL PUBLIC FOUL SEWERS TO BE MINIMUM 225mm DIAMETER THERMOPLASTIC STRUCTURED WALL PIPES TO IS EN 13746 (2007/2009), TYPE SN6 AND WIS 4-35-01 (2008) AND COMPLY WITH THE REQUIREMENTS OF THE IRISH WATER CODE OF PRACTICE.
 4. ALL PUBLIC SURFACE WATER SEWERS TO BE MINIMUM 225 DIA. CLASS H CONCRETE TO EN1916 & IS 6 2004 IN ACCORDANCE WITH THE GREATER DUBLIN REGIONAL CODE OF PRACTICE FOR DRAINAGE WORKS.
 5. ALL SURFACE WATER CONNECTIONS TO BE MINIMUM 150mm Ø UPVC TO IS EN 1401 2009/2012 IN ACCORDANCE WITH THE GREATER DUBLIN REGIONAL CODE OF PRACTICE FOR DRAINAGE WORKS.
 6. LOCATION AND INVERT LEVELS OF EXISTING MANHOLES OR OUTFALL POINTS, WHERE APPLICABLE TO BE VERIFIED BY CONTRACTOR PRIOR TO COMMENCEMENT OF DRAINAGE WORKS.
 7. ALL FOUL CONNECTIONS TO COMPLY WITH THE REQUIREMENTS OF THE IRISH WATER.
 8. ALL FOUL SEWERS TO BE AIR TESTED IN ACCORDANCE WITH IRISH WATER SPECIFICATIONS.
 9. ALL COVER LEVELS TO MATCH FINISHED ROAD/VERGE/FOOTPATH/CYCLETRACK LEVELS UNLESS OTHERWISE STATED.
 10. CONTRACTOR TO INCLUDE FOR CCTV SURVEY OF ALL SEWERS UPON COMPLETION OF SAME.

Communal bin storage shed to be located as indicated and constructed with 2.4m high external walls clad in matching brick with flat roof over and opening from road