

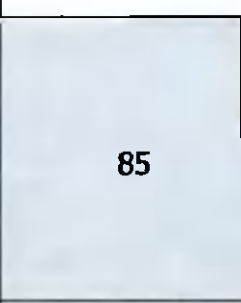

WAINSFORT MANOR DRIVE

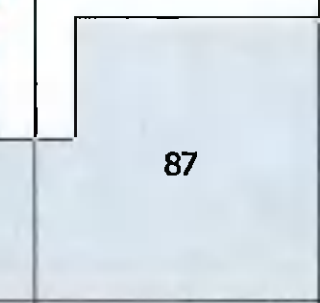
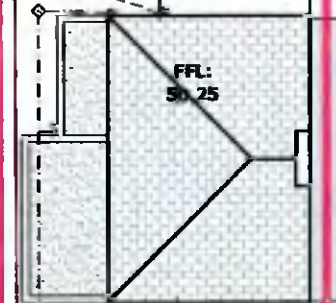
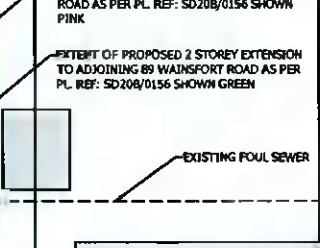
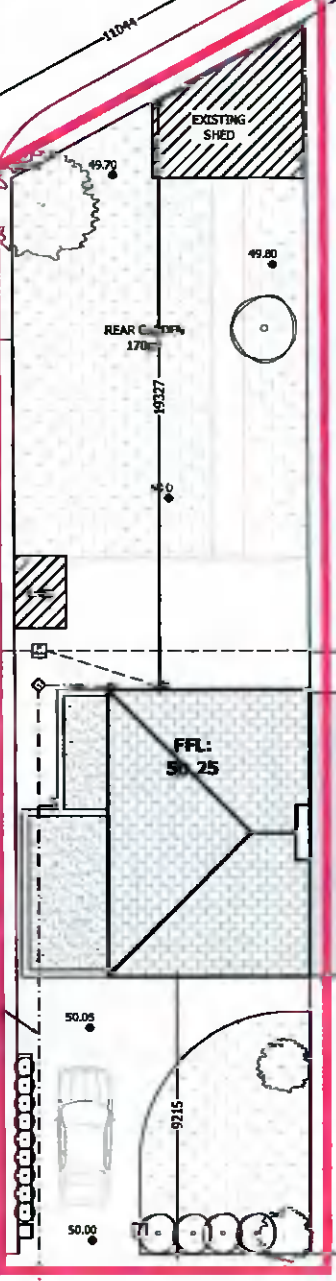
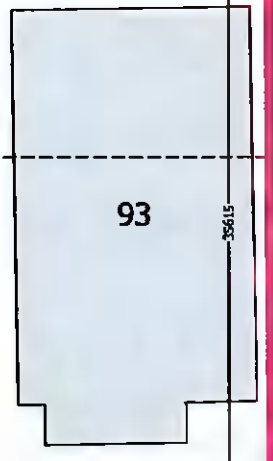
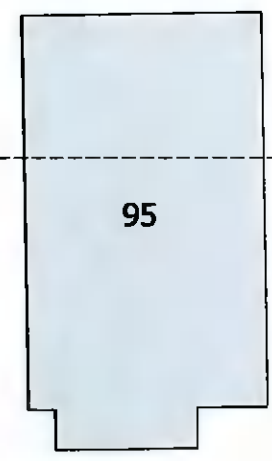

EXISTING SURFACE WATER DRAIN

F.F.L. 50.25

EXTENT OF PROPOSED SINGLE STOREY EXTENSION TO ADJOINING 89 WAINSFORT ROAD AS PER PL. REF: SD208/0156 SHOWN PINK

EXTENT OF PROPOSED 2 STOREY EXTENSION TO ADJOINING 89 WAINSFORT ROAD AS PER PL. REF: SD208/0156 SHOWN GREEN

EXISTING FOUL SEWER

REAR GARDEN 170

EXISTING SHED

WAINSFORT ROAD R817

NOTES:
 THIS DRAWING AND ANY DESIGN HEREON IS THE COPYRIGHT AND PROPERTY OF RYEHILL PLANNING & DESIGN AND SHOULD NOT BE REPRODUCED WITHOUT THEIR WRITTEN CONSENT. FIGURED DIMENSIONS ONLY TO BE USED. ALL DIMENSIONS ARE TO BE CHECKED OUT ON SITE AND CONFIRMED WITH THE OFFICE BEFORE ANY WORK IS CARRIED OUT. DO NOT USE SCALED DIMENSIONS. THE INFORMATION CONTAINED IN THIS DRAWING IS TO BE TAKEN WITH INFORMATION CONTAINED ON ALL OTHER DRAWINGS AND IF THE WORKS ARE NOT ADEQUATELY DESCRIBED OR SHOWN, CONTRACTOR IS TO CONSULT WITH THE OFFICE BEFORE PUTTING WORK TO HAND. ONLY BEST QUALITY WORKMANSHIP AND MATERIALS WILL BE ACCEPTED IN THE EXECUTION. ALL MATERIALS AND WORKMANSHIP TO CONFORM TO THE LATEST B.S.C.P. AND I.S.C.P. ALL FIRE DOORS, WHERE REQUIRED, TO CONFORM TO THE LATEST RELEVANT CODES OF PRACTICE. THE WORK TO BE CARRIED OUT, WHETHER BY SUBCONTRACTOR OR GENERAL CONTRACTOR, IS TO BE CAREFULLY SELECTED BY THE GENERAL CONTRACTOR HAVING REGARD TO COMPETENT & MATERIAL SIZES, THICKNESS, BEDDING, TOLERANCE Etc. & APPROVAL IS TO BE OBTAINED FROM THE OFFICE BEFORE WORK IS PUT TO HAND. ALL WORKS TO COMPLY WITH CURRENT BUILDING REGULATIONS.

Project:	PROPOSED EXTENSION, 91 WAINSFORT ROAD
Drg. No.:	01-0122
Title:	EXISTING SITE LAYOUT PLANNING
Scale:	1:250
Client:	RESTFILE Ltd.
Date:	23rd MAY 2022
Drawn By:	KENNETH O' HARA
Phone:	086 3431269



01
 01 371m² 1:250

COLLEGE DRIVE