

Note : All dimensions to be checked on site prior to construction of the proposed works.

ex. concrete ridge tiles.
 ex. concrete tiled roof.
 ex. rooflight.
 ex. soffit & fascia boards.
 ex. structure.
 ex. windows.
 ex. floors.
 ex. foundations.

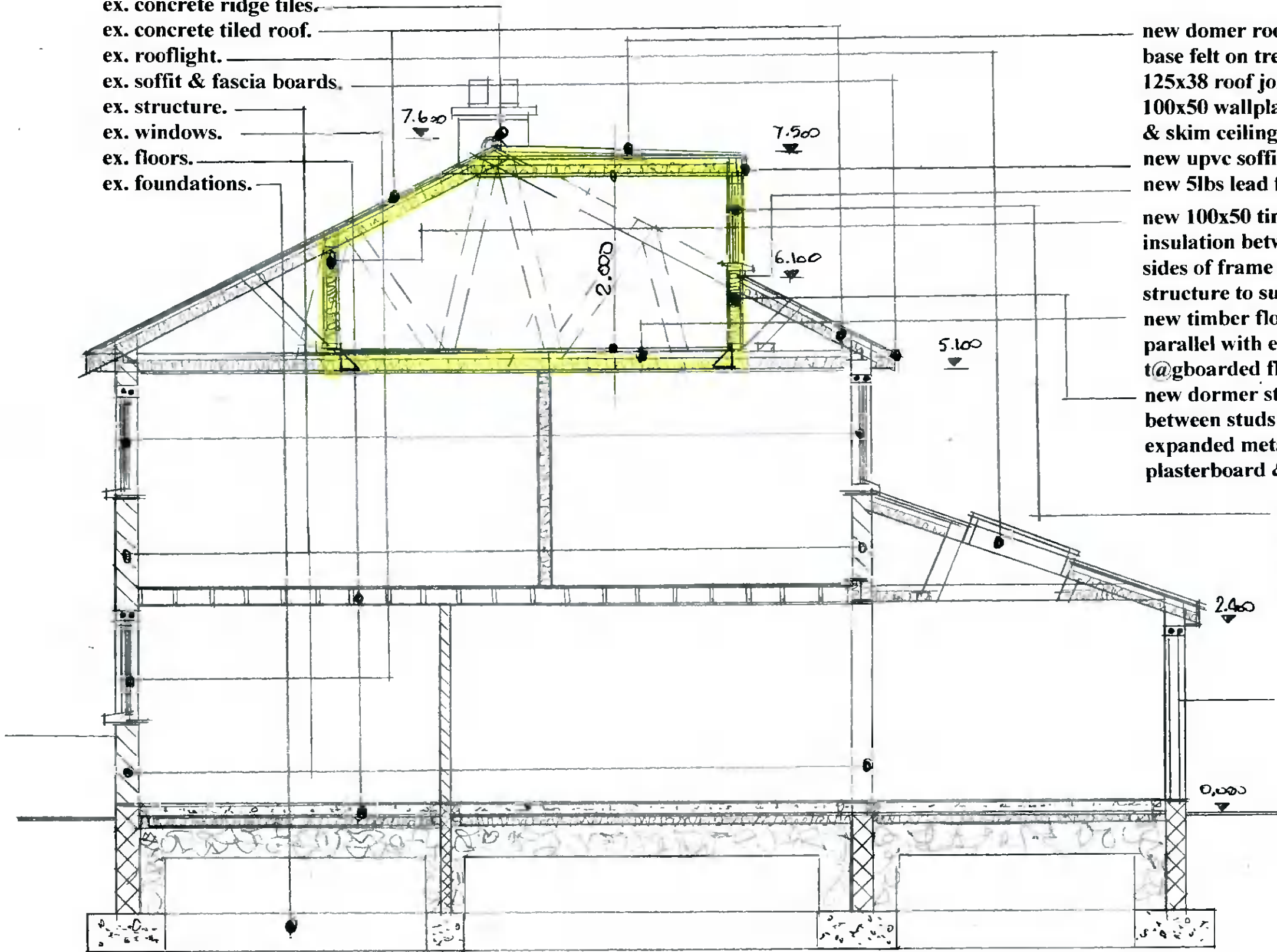

new dormer roof structure to be selected fiberglass roof covering on base felt on treated 188mm plywood decking on firring pieces on 125x38 roof joists @ 400 centres with 100 insulation between joists on 100x50 wallplate on dpc on timber frame structure with plasterboard & skim ceiling finish.
 new upvc soffit & fascia boards to match ex. with vents in soffits.
 new 5lbs lead flashings with counter flashings.
 new 100x50 timber truss frame structure partition with 100 insulation between studs with 18mm plywood sheeting screwed both sides of frame with galvanized steel hangers fixed to new frame structure to support new timber floor.
 new timber floor to be 175x38 floor joists @ 400 centres to run parallel with ex. ceiling joists fix to galvanized steel hangers with t@gboarded floor finish.
 new dormer structure to be 150x50 stud frame with 150 insulation between studs with smooth concrete render finish externally on expanded metal on breathable membrane with 65 insulated plasterboard & skim finish internally.

new upvc double glazed window with two no.175x38 timber joists bolted together head over with upvc cill on dpc on 150x50 stud structure under.

Section A. A. scale 1:50.