

**Existing Ground Floor Plan.**  
Scale 1:100

Existing Ground Floor Area :  
72.61 Sq. metres.

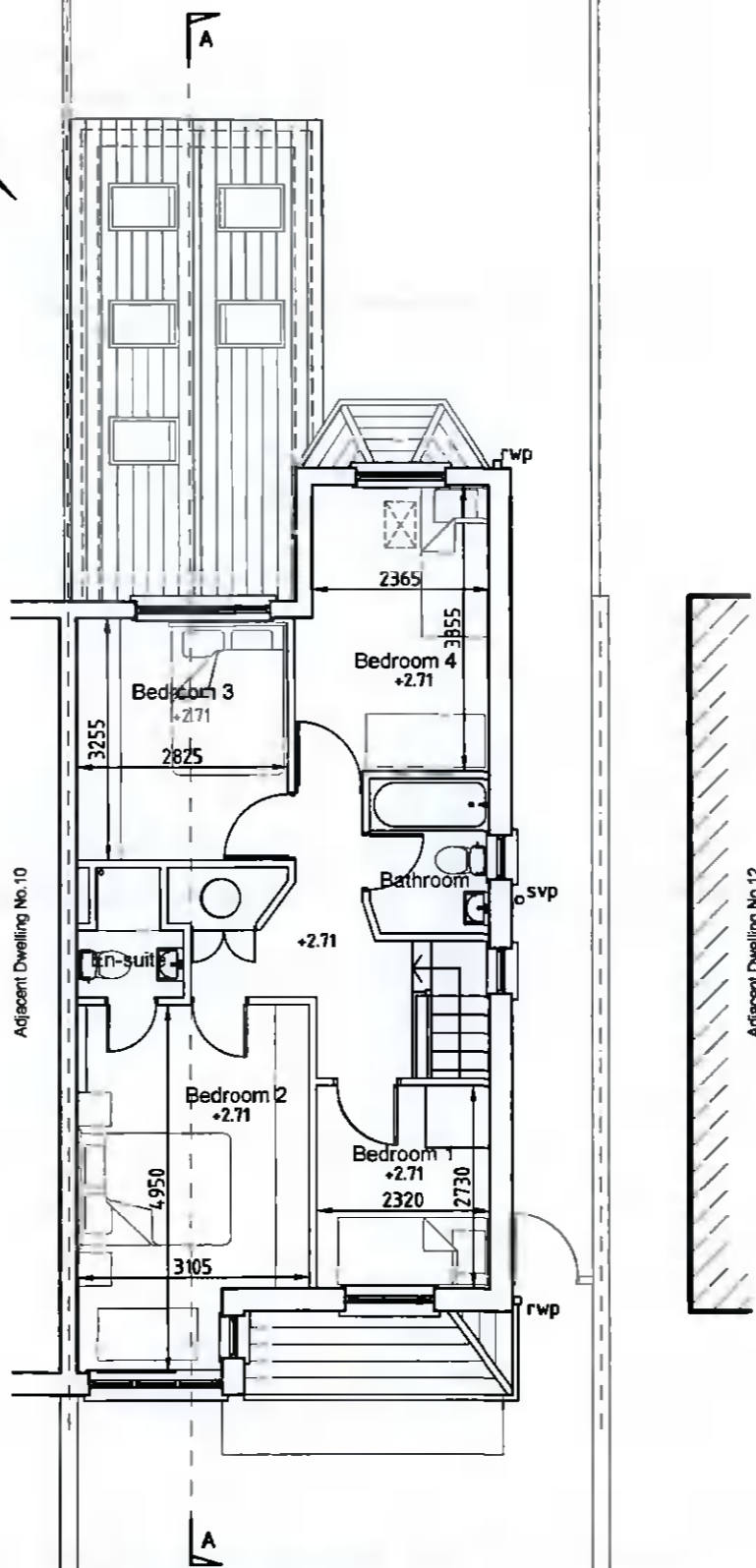

**Existing First Floor Plan.**  
Scale 1:100

Existing First Floor Area :  
56.29 Sq. metres.

- Notes:**
1. This drawing issued for Planning Permission purposes only and not for construction.
  2. All dimensions to be checked on site and not scaled from this drawing.
  3. For Section A-A refer to Drawing No. 2219-03.

Date	By	Rev.
Drawing Title		
Proposed Attic Conversion at 11 Hermitage Valley, Lucan, Co. Dublin. Existing Floor Plans.		
Applicant:		Agent:
James Leslie 11 Hermitage Valley, Lucan, Co. Dublin.		John Shevlin 114 Ashington Rise, Navan Road, Dublin 7.
Drn. JDS	Date 04.05.22	Scales As Shown at A3
Job No.	Drawing No.	Rev.
2219	01	