

**Notes:**  
All drawings are the copyright of the consultants (NJA Planning Consultants) and may not be used in whole or in part without their expressed permission in writing.  
Do not scale from this drawing, use written dimensions only.  
All dimensions to be checked on site by the contractor and the consultant notified of any discrepancies.  
All levels indicated are approximate relative levels and do not relate to Ordnance Datum.  
All levels must be checked on site.  
All works to be carried out in accordance with the 1997 Building Regulations, with all subsequent revisions to same, and with the requirements of the relevant Local Authority

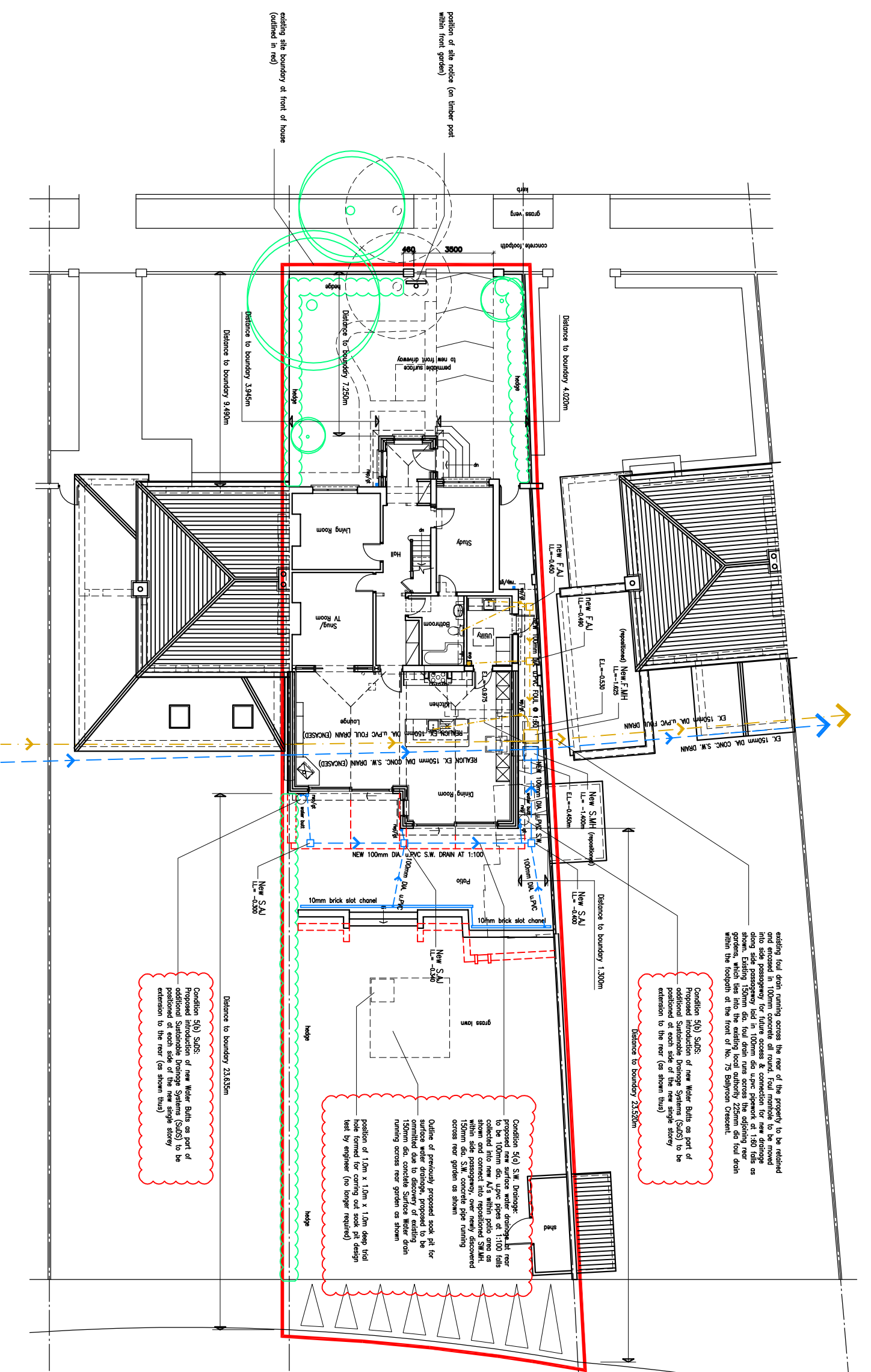
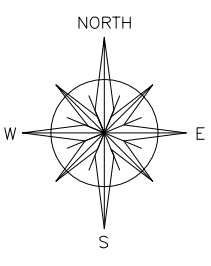

# Site Block Plan / Drainage Layout

Site Area = 0.1334acres/538.77sqm

COMPLIANCE SUBMISSION

REVISION	DESCRIPTION	MADE BY	DATE
B	REVISED TO COMPLY WITH CONDITIONS No.2 & 5 - SD219/0563	N. JONES	JUNE'22
A	ALL REVISIONS: REAR EXTENSION & PATIO REDUCED IN SIZE/DEPTH, SURFACE WATER DRAINAGE REVISED / FIVE 50MM PIT DESIGN MODIFIED & WATER BUTTS ADDED TO K.I.M.P.'S	N.JONES	JAN.'22
REVISION		MADE BY	DATE

SUMNER 15 BATTERFIELD CRESCENT, RATHFARHAM, DUBLIN 14, TEL: 481347 FAX: 087/8601710  
**Niall Jones & Associates**  
Planning Consultants

JOB TITLE  
**PROPOSED EXTENSION & INTERNAL ALTERATIONS AT  
69 BALLYROAN CRESCENT, RATHFARHAM, DUBLIN 14  
FOR MR FERUGS MCCABE**

DRAWING TITLE  
**PLANNING DRAWING:  
PROPOSED SITE BLOCK PLAN / DRAINAGE LAYOUT**

SCALE	DATE	DRAWN BY	CHECKED	JOB No.	DRAWING No.	REV.
1:200 1:100	NOV.'21	N.Jones	N.J.	20/258	P.07	B

Email: njaplanningconsultants@gmail.com