

Overall Site Plan 1:250@A0

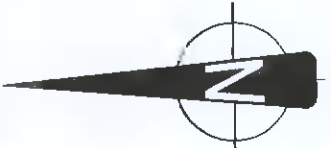

GENERAL NOTES

1. COPYRIGHT RESERVED
2. ALL DIMENSIONS ARE TO FACE UNLESS OTHERWISE SPECIFIED
3. ALL WORK SHALL BE IN ACCORDANCE WITH THE NATIONAL BUILDING REGULATIONS
4. THE CONTRACTOR IS RESPONSIBLE FOR OBTAINING ALL LOCAL AND STATE PERMITS
5. ALL STRUCTURES TO BE TO PHYSICAL DIMENSIONS IN FULL
6. ALL LOCAL LEVELS REFER TO AVERAGE SEASIDE LEVEL
7. ALL LOCAL LEVELS REFER TO AVERAGE SEASIDE LEVEL
8. ALL LOCAL LEVELS REFER TO AVERAGE SEASIDE LEVEL
9. ALL LOCAL LEVELS REFER TO AVERAGE SEASIDE LEVEL
10. ALL LOCAL LEVELS REFER TO AVERAGE SEASIDE LEVEL

| REV | DATE | DESCRIPTION | BY |
|-----|------|-------------|----|
|     |      |             |    |
|     |      |             |    |
|     |      |             |    |
|     |      |             |    |



Existing gate and driveway and roadside boundaries to be improved by recessing and widening gate to provide 180m sightlines set back 2m from existing road edge (sight lines shown dashed pink).

Note 1: 60kmph speed limit on adjacent access road achieves improved visibility (previous sight lines shown dashed blue for comparison).

New Solid Timber Automatic Entrance Gate set back 3.2m from existing road edge located at approx. position of existing gate (to be removed)

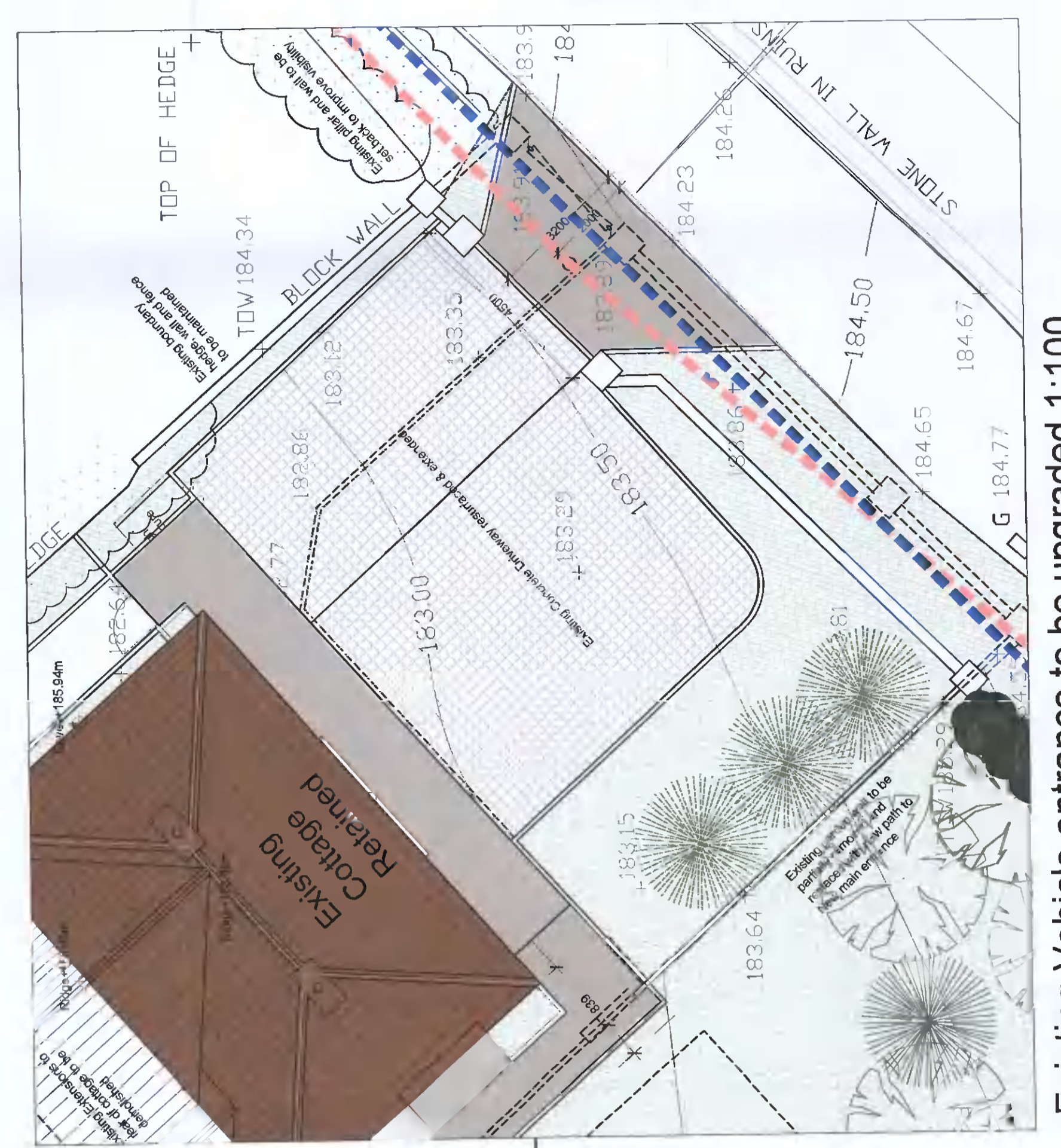

Existing Vehicle entrance to be upgraded 1:100



Model View from South

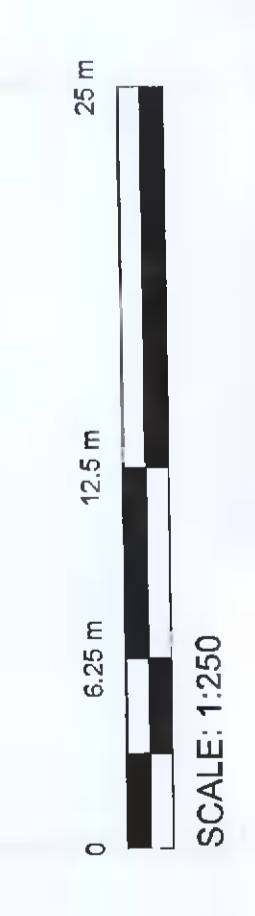

**JOHN FLEMING**  
ARCHITECTS

THE TREE HOUSE, 17 RICHVIEW OFFICE PARK  
CLONSREACH, D14 X8B2, IRELAND  
(01) 8888888 E. info@jfa.ie W. www.jfa.ie

CLIENT  
MR. Gareth McHale

PROJECT  
Proposed Extension to Existing House  
Mount Carmel, Clonsreath, Ireland, Co. Dubh.

DRAWING  
Overall Site Plan

SCALE  
1:250 @ A0

DATE  
21/11/2023

PROJECT NUMBER  
P-SR-250

REVISION  
A

DRAWING LOCATION  
C:\Users\jfa\OneDrive\Documents\jfa\p-sr-250

ISSUED FOR  
Planning Further info.