

15 mm Gyproc Duraline board either side of Gypframe 70 S 60 C studs  
50 mm Isover acoustic roll in cavity

Envirograf intumescent coated slabs, or equivalent, along line above and below lines of stud partitions to provide 60 minutes fire resistance and acoustic barrier

Existing glazed timber screen to corridor. Provide screen printed decal to glass.

100 mm Rockwool insulation installed between the existing joists, tight into the sides of the joists  
Selected floor finish. Refer to finishes schedule.  
20 mm plywood sheeting (T&G)  
Existing timber floor boards

Existing timber joists  
Existing ceiling to be retained. Ceiling to be restrained using metal straps fixed at 200 mm centres across top of floor joists. Stainless steel washers countersunk into plaster at 200 mm centres to ceilings and fixed through ceiling to perforated metal straps using stainless steel wires.

Double layer of Gyproc Fireline board to upgrade floor to minimum 60 minutes fire resistance, fixed through lath and plaster ceiling to existing joists  
Service void below 60 minutes fire resistant ceiling  
Layer of Gyproc Wall board, with gypsum skim and painted finish, on Gyproc Casoline MF suspended ceiling to create service void

Gyproc Shaftwall system - 2 layers of 12.5 mm Gyproc Fireline board on Gypframe 60 I 70 I studs at 600mm centres. 19 mm Gyproc CoreBoard to outer face

Existing timber wainscoting to be made good as required / new timber wainscoting. Painted finish to selected colour  
Selected floor finish

250 mm concrete slab to Structural Engineer's detail  
PIR insulation board  
DPM / radon membrane

Large stone, no fines, blinded with 20 mm chips

Velux GGL UK04 conservation rooflight (1340 by 980 mm), or equivalent, installed in accordance with manufacturer's written instructions

Timber trimmers  
Existing roof slates, reused where possible, on treated timber slating battens, treated with a wood preservative, using copper nails. Replacement slates to be new Penrhyn Welsh slate, colours to be selected to match existing

Treated timber counter battens  
Tyvek Supro or Solitex Plus vapour permeable / breathable sarking felt, minimum overlap 100 mm. Provide one metre strip of Paralon under roofing felt at eaves

Fill between rafters with selected breathable insulation (Therma-Hemp natural insulation / Cosywool natural insulation / Heraklith wood fibre board, or equivalent)

Existing lath and plaster ceiling to be retained. Provide ceiling restraint system of braced or stainless steel screws with washers screwed into underside of existing rafters. New lime plaster plugs to all washers

Thermal Upgrade Option - Install new wood fibre, Heraklith, or equivalent, insulation below existing ceiling. Clay / lime plaster finish to underside

- 1 Ecophon Solo Rectangle acoustic ceiling raft (40 mm), or equivalent, 2.4 m wide, suspended below existing ceiling in accordance with manufacturer's instructions
- 2 Gyproc Shaftwall system - 2 layers of 12.5 mm Gyproc Fireline board on Gypframe 60 I 70 I studs at 600 mm centres. 19 mm Gyproc CoreBoard to outer face
- 3 Works to existing windows: Repairs and draft sealing to windows, re-glaze in slim glazing (0.7 w/m²K)
- 4 Remove existing ground floor. Replace with 250 mm deep concrete slab on insulation on LDPE radon membrane (e.g. Monarflex, or equivalent) on blinded and compacted granular material (no fines)
- 5 Velux GGL UK04 conservation rooflight (1340 by 980 mm), or equivalent
- 6 Remove existing roof slates, retaining any slates which are in a condition suitable for reuse. Fill between rafters with selected breathable insulation (e.g. Therma-Hemp natural insulation / Heraklith wood fibre board). Provide new Tyvek Supro or Solitex Plus vapour permeable / breathable membrane and treated timber 50 by 35 mm treated timber battens and counter battens. Replacement slates to be new Penrhyn Welsh slate, colours to be selected to match existing
- 7 Remove existing plasterboard to either side of existing glazed timber screen to corridor. Provide screen printed decal to glass
- 8 Retain existing timber window surrounds, under window cupboards, skirting, architraves, and wainscoting. Protect timber linings with Envirograf ES / VFR white fire protection coating to achieve Class 0 rating where required. Painted finish to selected colour
- 9 Floor Upgrade Type 1: Upgrade floor to 60 minutes fire protection. Remove, number, and record existing timber floorboards. Remove sand / cinder and debris from between floor joists. Install 100 mm Rockwool insulation between the existing joists, tight into the sides of the joists. Provide double layer of Gyproc Fireline board fixed through lath and plaster ceiling to existing joists  
Existing ceiling to be restrained using perforated metal straps fixed at 200 mm centres across the top of the floor joists. Stainless steel washers countersunk into plaster at 200 mm centres to ceilings and fixed through ceiling to perforated metal straps using stainless steel wires  
Provide double layer of Gyproc Fireline board fixed through lath and plaster ceiling to existing joists  
Form service void with layer of Gyproc Wall board, with gypsum skim and painted finish, on Gyproc Casoline MF suspended ceiling
- 10 Double layer of selected breathable insulation (e.g. Therma-Hemp natural insulation / Cosywool natural insulation / Heraklith wood fibre board), between ceiling joists, and perpendicular of existing ceiling joists, to flat ceiling area
- 11 Carefully remove existing T&G cladding to steel beams and provide 60 minutes fire protection to underside and sides by encasing with 15 mm Glasroc Firecase (see detail). Timber T and G cladding to be reinstated. Protect timber with Envirograf ES / VFR white fire protection to achieve Class 0 rating as required. Painted finish to selected colour
- 12 Existing timber queen post truss, strengthened in accordance with Structural Engineers' details
- 13 Existing timber shutters to be retained. Provide additional shutters to match where shutters are missing or the shutter boxes have been removed.
- 14 Remove existing lime plaster only where boasted or spawled - locations as noted on the condition survey with an allowance for additional unforeseen. New lime plaster finish, type and mix TBC on analysis of existing areas. Prepare existing and new lime plaster finish
- 15 Existing ridge tiles to be carefully recorded, numbered, and removed for re-use. Refit over Tegral Ridge Roll fixed continuously over ridge
- 16 15 mm Gyproc Duraline board either side of Gypframe 70 S 60 C studs. 50 mm Isover acoustic roll in cavity
- 17 Gravel French drain to building perimeter, connected to surface water system
- 18 Concrete wall, to Structural Engineers' detail, with cut granite / limestone facing, concrete capping, and powder coated railing
- 19 Thermal Upgrade to Walls: Make good wall and adhere 50 mm CalsiTherm Climate Board to wall. Finish with two layers of 2mm KP-Kalkglätte smooth plaster with reinforcement mesh between. Existing timber paneling details to be retained and altered to accommodate wall insulation. New paint finish (1 coat Beeck Fixative / 2 coats Beeck Maxil Pro (Sd 0.01 m)

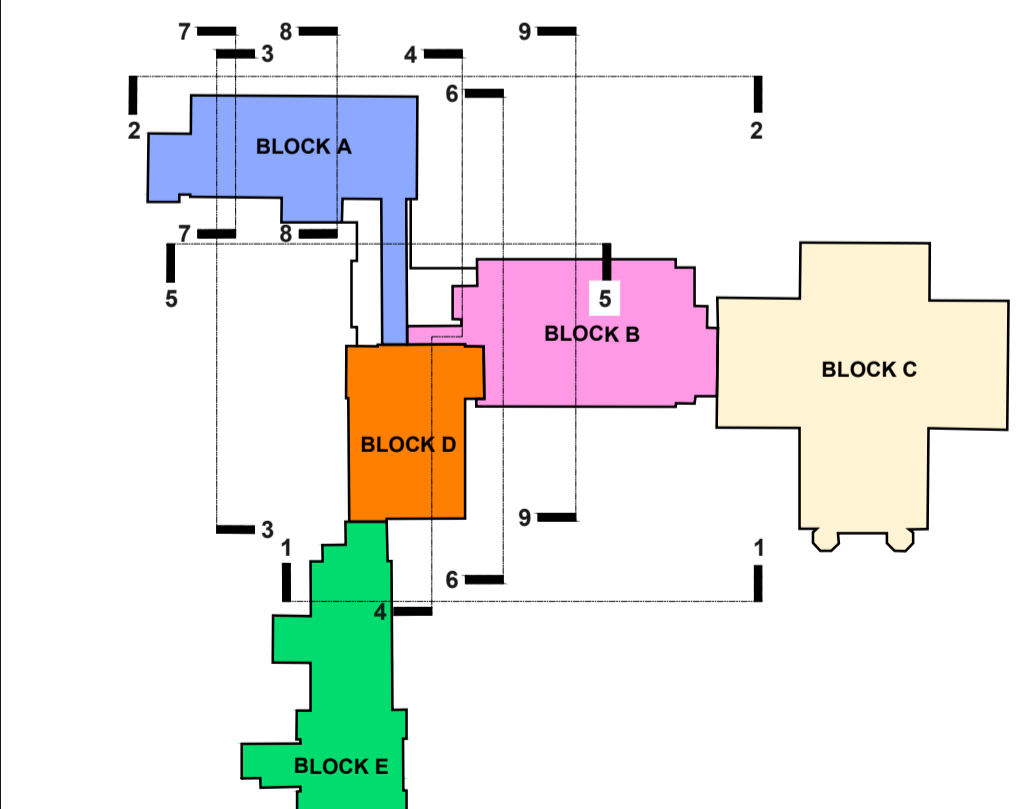

KEY PLAN

SECTION 7-7

**Conditions of use of this drawing**  
note: if this A1 size drawing is reproduced at a smaller size which makes these conditions difficult to read, please contact the Architects office for a legible copy of these conditions.  
1. This drawing is the property of the Architects and all rights are reserved. No part hereof may be copied or reproduced in any form or by any means without the prior written consent of the Architects.  
2. This drawing is to be used only for the specific project and for the specific purpose for which it has been prepared. This drawing is not to be relied upon for construction purposes, and no implied or expressed warranty is given as to the suitability for construction purposes, unless the purpose of this drawing is stated to be "for construction" or "for contract". If the purpose is stated to be "for contract" this drawing is not to be used for construction if it is also marked "preliminary".  
3. The Employer is granted a copy right to use this drawing and its contents for the purpose for which the drawing has been prepared. If this drawing has been prepared for construction purposes the license will only be valid for a single construction project and shall expire once a single construction project has been completed. Any such license only passes to the Employer on payment of Architects fees in full and in any event the license cannot be assigned without prior written consent of Simon J Kelly Architects.  
4. Where the Architects conditions of engagement provide that the Employer obtains copyright (whether by transfer of ownership or express or implied license) for use on projects other than the project which the copyright material was specifically prepared for, the Architect does not accept any liability whatsoever howsoever arising for use of this drawing and its contents (in whole or in part) in relation to any project and/or purpose other than that for which it was specifically prepared. A copyright assignment to use this drawing and its contents (in whole or in part) is not a warranty that use of this drawing and its contents (in whole or in part) is appropriate in circumstances other than the purpose and project for which it has been prepared.

5. Do not scale off this drawing. Figure metric dimensions only should be taken off this drawing. Imperial dimensions, if any, contained on this drawing are given for illustrative purposes only.  
6. All contractors, whether main or sub contractors, must visit the site and are responsible for taking and checking any and all dimensions levels and the like that relate to the work.  
7. Where this drawing contains discrepancies in relation to other relevant documents, such discrepancies shall be brought to the attention of the Architects who shall issue a written instruction as to which information is to be followed, and until such written Architects instruction has been issued any work carried out on foot of the discrepancy shall be unauthorised.  
8. References to National Standards, whether to Irish (ISI), British (BS), or otherwise, or codes of practice (CP) shall be deemed to refer to the relevant standard or code current at the date of issue of the drawing notwithstanding any reference to the contrary or to any earlier standard.  
9. Any reference to the "Architect" or "Architects" on this or any other relevant documents shall mean the nominated project Architect and/or a Director of Simon J Kelly Architects who has been nominated as the partner-in-charge but only while such Architect remains in the employment of Simon J Kelly Architects.  
10. Any questions as to the meaning or application of these conditions shall be submitted in writing to the Architect for his/her ruling and such a ruling shall be conclusive as to the meaning or application of these conditions.  
11. Simon J Kelly Architects, their Agents, Architects, employees and/or directors shall not be liable for any loss damage or injury consequential or otherwise howsoever arising for failure to comply with any or all of these conditions.  
12. Should anyone copy this drawing in whole or in part without consent and use the copy in relation to a purpose and/or project for which the drawing has not been prepared for, such use is at the sole and exclusive risk of the copier and Simon J Kelly Architects do not accept any liability whatsoever howsoever arising in relation to such use.

13. Should anyone copy this drawing in whole or in part with or without consent they should also copy these conditions of use in full and reproduce them with the copy. These conditions of use are to be read in conjunction with the drawing and its contents, these conditions of use form part of the drawing and/or its content and are inseparable from this drawing and/or its content.  
14. The use of or reliance upon this drawing and/or its contents shall be deemed to be acceptance of these conditions of use unless otherwise agreed in writing, such written agreement to be sought from and issued by the Architects prior to the use or reliance upon this drawing and/or its contents.  
15. All drawings are to be read in conjunction with the fire safety compliance report, all other contract documents, all statutory consents and/or requirements and all statutory obligations.

preliminary  
not for construction

PROJECT: Gaelcholáiste an Phiarsaigh - Loreto Abbey, Rathfriland		rev. / date / description	
CLIENT: Department of Education / Board of Management		Fitzgerald Kavanagh + Partners 1 Mount Street Crescent, Dublin 2, D02 XF57 +353 1 676 4128 info@fkp.ie www.fkp.ie	
DRAWING: General Arrangement: Detail Section 7-7 Block A - St Anne's		Simon J Kelly Architects 21 Middle Street, Galway +353 91 66 2949 Cox's Yard, Westport, Mayo +353 96 24 414 mail@sjk.ie www.sjk.ie	
DRAWING PURPOSE: Planning	DRAWN BY: BS/LD/CUIÇ	APPROVED: REV. NO:	DATE: May '22
DRAWING SIZE: A1	SCALE: 1:50; 1:10	DRAWING REFERENCE: 2350-SJK-S2B-A-350	