



**ROOFLIGHTS**  
14 no. 1380 x 1170 mm velux heritage rooflights and associated flashing installed in existing roof

**ROOF**  
Strip existing roof slates and salvage circa 25% for reuse with 75% new natural slates of an appropriate size and colour (Blue Bangor), on new counter-battens and new breather membrane, allowing for propping to roof truss structure to Structural Engineer Consultant's detail

Existing rooflights to be refurbished

**ROOF**  
Standing seam metal/membrane roof finish on 150 mm insulation laid to fall on acoustic metal deck

**ROOF**  
Strip existing roof slates and salvage circa 25% for reuse with 75% new natural slates of an appropriate size and colour (Blue Bangor), on new counter-battens and new breather membrane, allowing for 40% replacement of Structural roof timber to Structural Engineer Consultant's detail

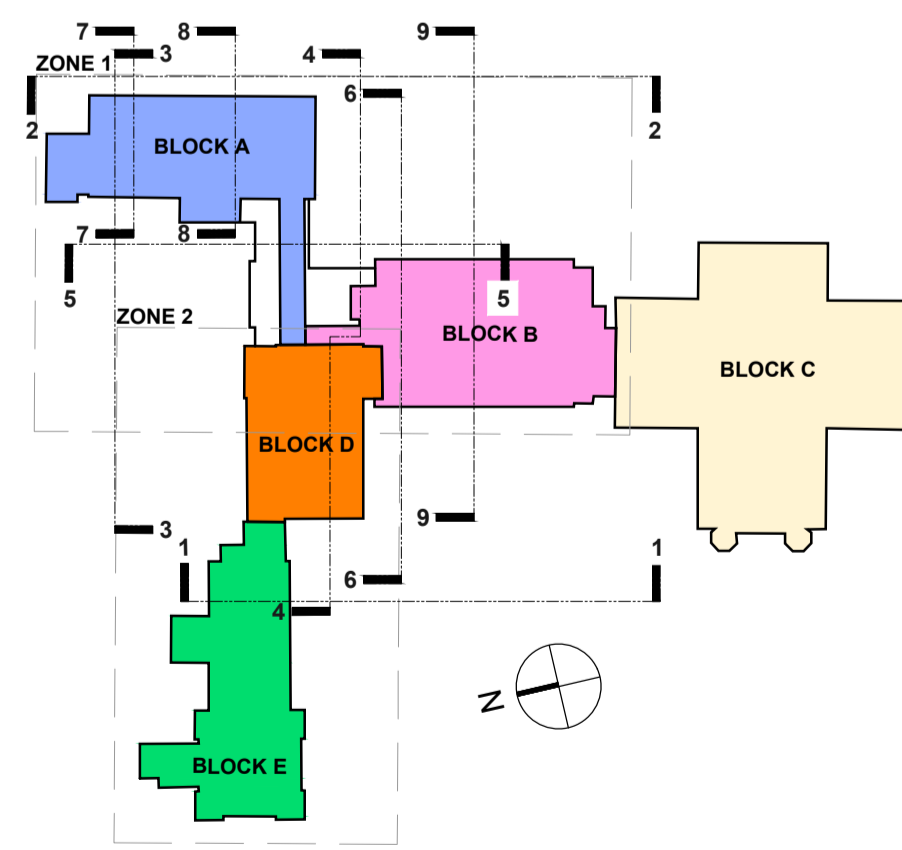

KEY PLAN

PROPOSED ROOF PLAN - ZONE 1

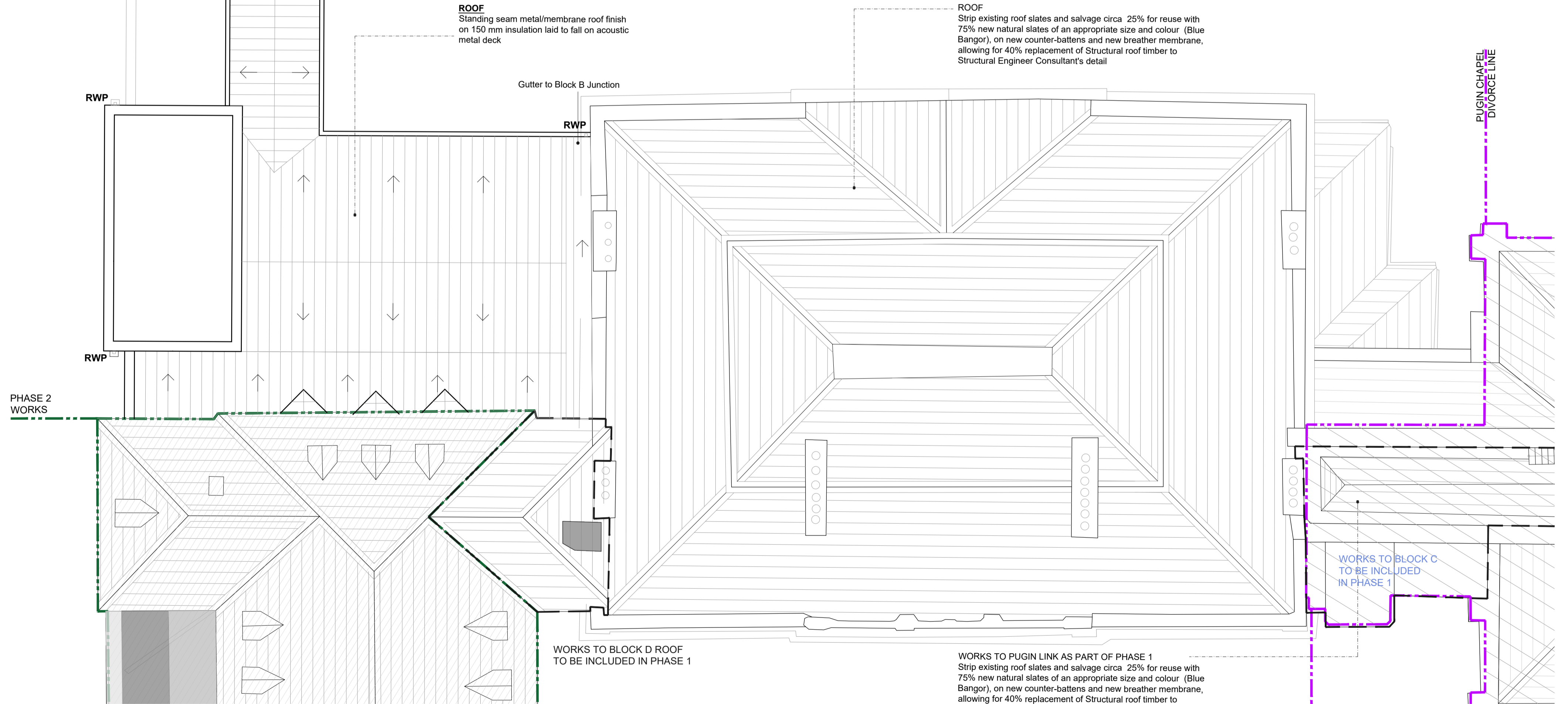

**Conditions of use of this drawing**  
note: if this A1 size drawing is reproduced at a smaller size which makes these conditions difficult to read, please contact the Architects office for a legible copy of these conditions.  
1. This drawing is to be used only for the specific project and for the specific purpose for which it has been prepared. This drawing is not to be relied upon for construction purposes, and no implied or expressed warranty is given as to the suitability for construction purposes, unless the purpose of this drawing is stated to be "construction" or "contract". If the purpose is stated to be "contract" this drawing is not to be used for construction if it is also marked "preliminary".  
2. The Employer is granted a copyright licence to use this drawing and its contents for the purpose for which the drawing has been prepared. If this licence has been produced for construction purposes the licence will only be valid for a single constructed reproduction and shall expire once a single reproduction has occurred. Any such licence only passes to the Employer on payment of Architects fees in full and in any event the licence cannot be assigned without prior written consent of Simon J Kelly Architects.  
3. Where the Architects conditions of engagement provide that the Employer obtains copyright (whether by transfer of ownership or expressed or implied licence) for use on projects other than the project which the copyright material was specifically prepared for, the Architect does not accept any liability whatsoever (howsoever arising) for use of this drawing and its contents (in whole or in part) in relation to any project and/or purpose other than that for which it was specifically prepared. A copyright entitlement to use this drawing and its contents (in whole or in part) is not a warranty that use of this drawing and its contents (in whole or in part) is appropriate in circumstances other than the purpose and project for which it has been prepared.  
4. Do not scale off this drawing. Figured metric dimensions only should be taken off this drawing. Imperial dimensions, if any, contained on this drawing are given for illustrative purposes only.  
5. All contractors, whether main or sub contractors, must visit the site and are responsible for taking and checking any and all dimensions levels and the like that relate to the work.  
6. Where this drawing contains discrepancies in relation to other relevant documents, such discrepancies shall be brought to the attention of the Architects who shall issue a written instruction as to which information is to be followed, and until such written Architects instruction has been issued any work carried out on foot of the discrepancies shall be unauthorised.  
7. References to National Standards, whether to BS, BS, BS, or otherwise, or codes of practice (CP) shall be deemed to refer to the relevant standard or code current at the date of issue of the drawing notwithstanding any reference to the contrary or to any earlier standard.  
8. Any reference to the "Architect" or "Architects" on this or any other relevant documents shall mean the nominated project Architect and/or a Director of Simon J Kelly Architects who has been nominated as the partner-in-charge but only while such Architect remains in the employment of Simon J Kelly Architects.  
9. Any questions as to the meaning or application of these conditions shall be submitted in writing to the Architect for his/her ruling and such a ruling shall be conclusive as to the meaning or application of these conditions.  
10. Simon J Kelly Architects, their Agents, Architects, employees and/or directors shall not be liable for any loss damage or injury consequential or otherwise howsoever arising for failure to comply with any or all of these conditions.  
11. Should anyone copy this drawing in whole or in part with or without consent and use the copy in relation to a purpose and/or project for which the drawing has not been prepared for, such use is at the sole and exclusive risk of the copier and Simon J Kelly Architects do not accept any liability whatsoever howsoever arising in relation to such use.  
12. Should anyone copy this drawing in whole or in part with or without consent they should also copy these conditions of use in full and reproduce them with the copy. These conditions of use are to be read in conjunction with the drawing and its contents, these conditions of use from part of the drawing and/or its content and are inseparable from the drawing and/or its content.  
13. The use of or reliance upon this drawing and/or its contents shall be deemed to be acceptance of these conditions of use unless otherwise agreed in writing, such written agreement to be sought from and issued by the Architects prior to the use or reliance upon this drawing and/or its contents.  
14. All drawings are to be read in conjunction with the fire safety compliance report, all other contract documents, all statutory consents and/or requirements and all statutory obligations.

**KEY**  
Walls to be Removed  
Proposed New Construction  
Phase 2 Scope of Work  
Pugin Chapel - Future Project

Window Non-Rated  
Window With fire rated internal secondary glazing (see detail)  
Doorset Non-Rated  
Doorset 30Mins Fire Resistance with Intumescent Strips & Smoke Seals  
Doorset 60Mins Fire Resistance with Intumescent Strips & Smoke Seals

Window Non-Rated  
Window With fire rated internal secondary glazing (see detail)  
Doorset Non-Rated  
Doorset 30Mins Fire Resistance with Intumescent Strips & Smoke Seals  
Doorset 60Mins Fire Resistance with Intumescent Strips & Smoke Seals

Window Non-Rated  
Window With fire rated internal secondary glazing (see detail)  
Doorset Non-Rated  
Doorset 30Mins Fire Resistance with Intumescent Strips & Smoke Seals  
Doorset 60Mins Fire Resistance with Intumescent Strips & Smoke Seals

Window Non-Rated  
Window With fire rated internal secondary glazing (see detail)  
Doorset Non-Rated  
Doorset 30Mins Fire Resistance with Intumescent Strips & Smoke Seals  
Doorset 60Mins Fire Resistance with Intumescent Strips & Smoke Seals

**PROJECT:**  
Gaelchoiste an Phiarsaigh - Loreto Abbey, Rathfarnham  
**CLIENT:**  
Department of Education / Board of Management  
**DRAWING:**  
General Arrangement  
Zone 1 - Roof Plan  
**DRAWING PURPOSE:**  
Stage 2B  
**DRAWING SIZE:**  
A1  
**SCALE:**  
1:100  
**DRAWN BY:**  
LD/CIUC  
**APPROVED:**  
PC  
**DATE:**  
April '22  
**DRAWING REFERENCE:**  
2350-S2B-1-184  
**REV. NO:**

rev. date description  
Fitzgerald Kavanagh + Partners  
1 Mount Street Crescent,  
Dublin 2,  
D02 XF57  
+353 1 676 4128  
info@fkp.ie  
www.fkp.ie

**SK**  
Simon J Kelly Architects  
21 Middle Street,  
Galway  
+353 91 66 2949  
Cox's Yard,  
Westport, Mayo  
+353 98 24 414  
mail@sjk.ie  
www.sjk.ie

preliminary  
not for construction