

GROUND FLOOR DEMOLISH PLAN 1:100

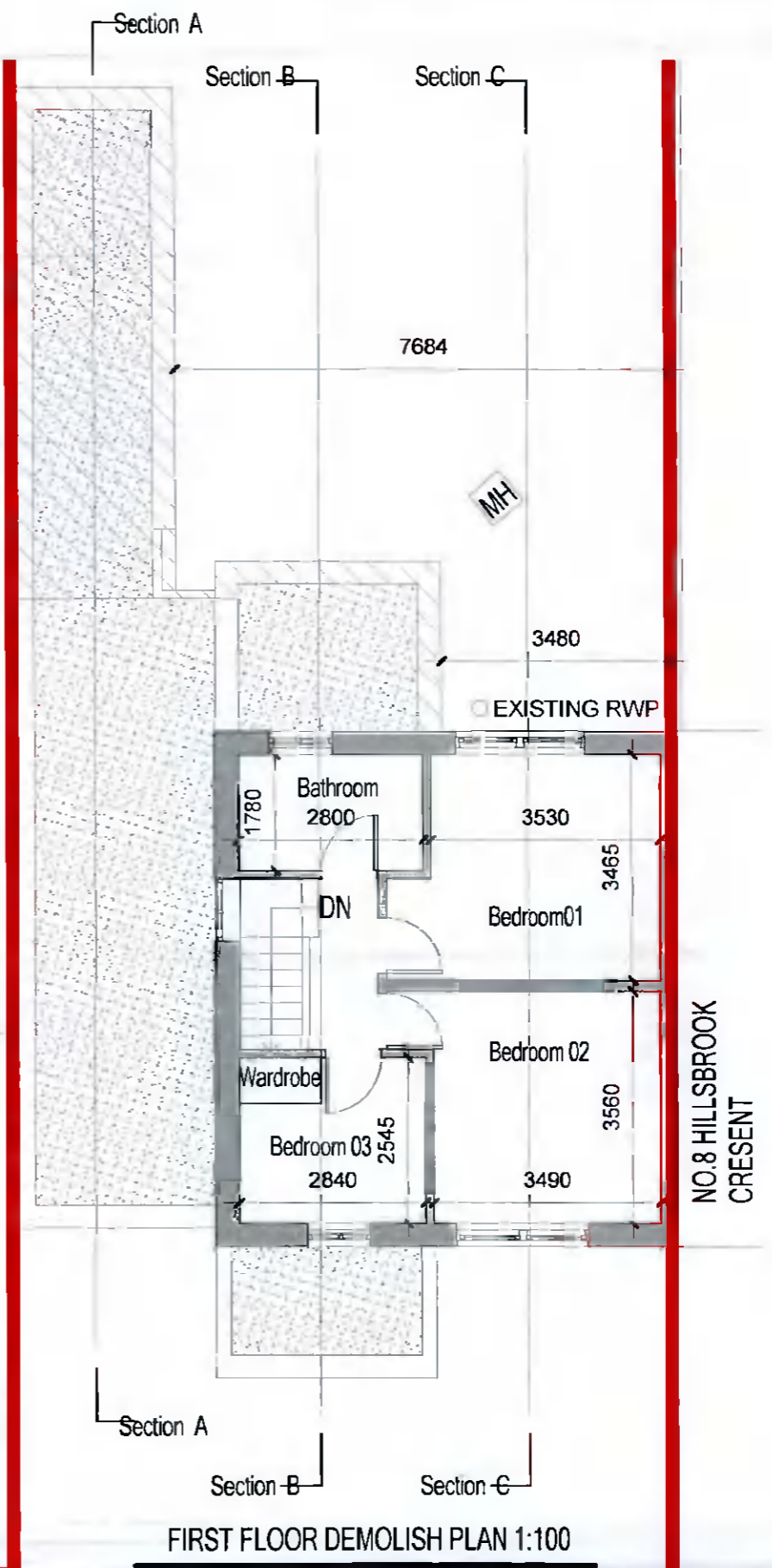

FIRST FLOOR DEMOLISH PLAN 1:100

NOTES:  
ALL DRAWINGS TO BE READ IN CONJUNCTION WITH ENGINEERS SPECIFICATION AND DETAILS

ALL CONSTRUCTION WORK TO COMPLY WITH THE CURRENT BUILDING REGULATIONS AND SPECIFICATIONS. COMPLIANCE OF SUCH TO BE RESPONSIBILITY OF THE BUILDING CONTRACTOR ON SITE OR CLIENT PRIOR TO COMMENCEMENT OF CONSTRUCTION WORK.

DEVELOPMENT TO BE BUILT ON THE INSIDE OF THE BOUNDARY, LINE OF THE BOUNDARY TO BE CONFIRMED PRIOR TO CONSTRUCTION BY CONTRACTOR. UNDERPINNING TO ENGINEERS SPECIFICATION. NO ELEMENT OF THE CONSTRUCTION TO BE ENCROACHING ON THE NEIGHBOUR'S PROPERTY.

ALL EXISTING STRUCTURE TO BE INSPECTED BY ENGINEER, ANY ADDITIONS OR ALTERATIONS TO THE STRUCTURE BE SPECIFIED AND INSPECTED BY ENGINEER.

ALL DRAINAGE TO BE CONFIRMED ON SITE

ALL DRAINAGE BOTH NEW AND EXISTING TO BE SPECIFIED AND INSPECTED BY ENGINEER.

infometaarchitects@gmail.com

Issue : Planning

NO.	Description	Date
1	Additional Information	MAY 22

Client : Zhifu Sun / Zhenfang Luo

Job: Proposed Rear & Side Extension for 7 Hillsbrook Crescent, Perrystown, Dublin 12

Description: Proposed Demolish Floor Plans

Project No.	001-00	2022-D12-ZZ-ZZ-DR-A-XX-00023
Date	22.05.2022	
Drawn By	SW	Scale 1 : 100@A3
Check By	SW	

2022/05/22 09:15:55