

EXISTING ROOF FLOOR PLAN 1:100

Proposed flat roof build up to first floor, more information refer to 2022-D12-ZZ-ZZ-DR-A-00030.

3 No. new triple glazed roof lights.

Proposed flat roof, more information refer to 2022-D12-ZZ-ZZ-DR-A-00030.

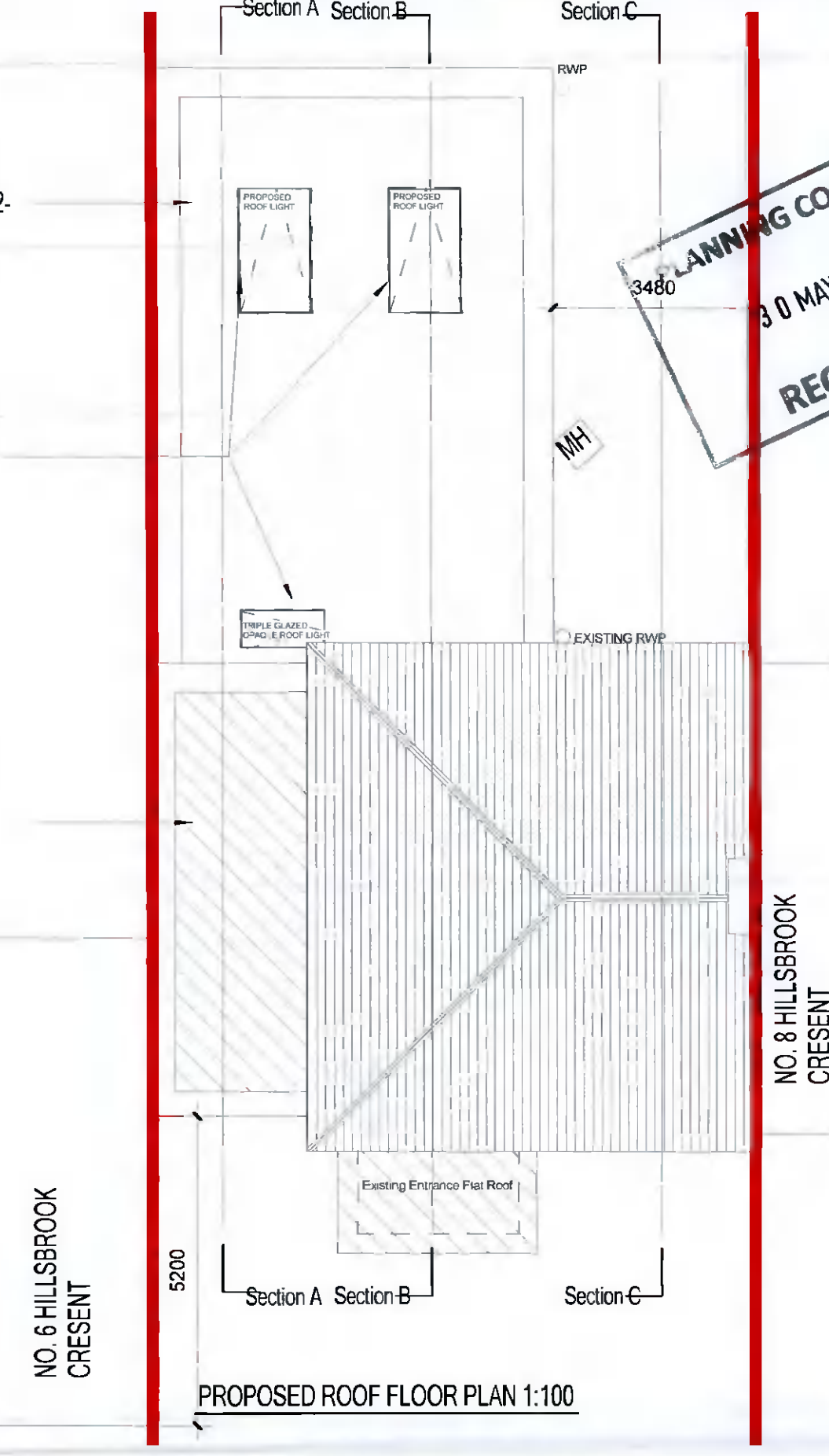

PROPOSED ROOF FLOOR PLAN 1:100

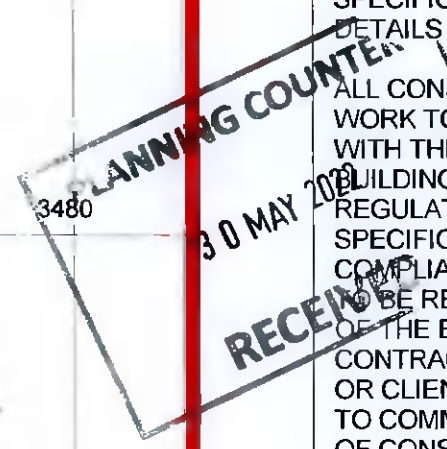

NOTES:
ALL DRAWINGS TO BE READ IN CONJUNCTION WITH ENGINEERS SPECIFICATION AND DETAILS
ALL CONSTRUCTION WORK TO COMPLY WITH THE CURRENT BUILDING REGULATIONS AND SPECIFICATIONS. COMPLIANCE OF SUCH TO BE RESPONSIBILITY OF THE BUILDING CONTRACTOR ON SITE OR CLIENT PRIOR TO COMMENCEMENT OF CONSTRUCTION WORK.

DEVELOPMENT TO BE BUILT ON THE INSIDE OF THE BOUNDARY. LINE OF THE BOUNDARY TO BE CONFIRMED PRIOR TO CONSTRUCTION BY CONTRACTOR. UNDERPINNING TO ENGINEERS SPECIFICATION. NO ELEMENT OF THE CONSTRUCTION TO BE ENCROACHING ON THE NEIGHBOUR'S PROPERTY.

ALL EXISTING STRUCTURE TO BE INSPECTED BY ENGINEER, ANY ADDITIONS OR ALTERATIONS TO THE STRUCTURE BE SPECIFIED AND INSPECTED BY ENGINEER.

ALL DRAINAGE TO BE CONFIRMED ON SITE

ALL DRAINAGE BOTH NEW AND EXISTING TO BE SPECIFIED AND INSPECTED BY ENGINEER.

NO.6 HILLSBROOK CRESENT

NO.8 HILLSBROOK CRESENT

NO.6 HILLSBROOK CRESENT

NO.8 HILLSBROOK CRESENT



Meta living lab

infometaarchitects@gmail.com

Issue : Planning

NO.	Description	Date
1	Additional Information	MAY 22

Client : Zhifu Sun / Zhenfang Luo

Job: Proposed Rear & Side Extension for 7 Hillsbrook Cresnet, Perrystown, Dublin 12

Description: Existing & Proposed Roof Plans

Project No.	001-00	2022-D12-ZZ-ZZ-DR-A-XX-00022
Date	22.05.2022	
Drawn By	SW	Scale
Check By	SW	

1 : 100@A3

2022/05/22 09:40:55