

LEGEND:
 PROPOSED SITE BOUNDARY ———

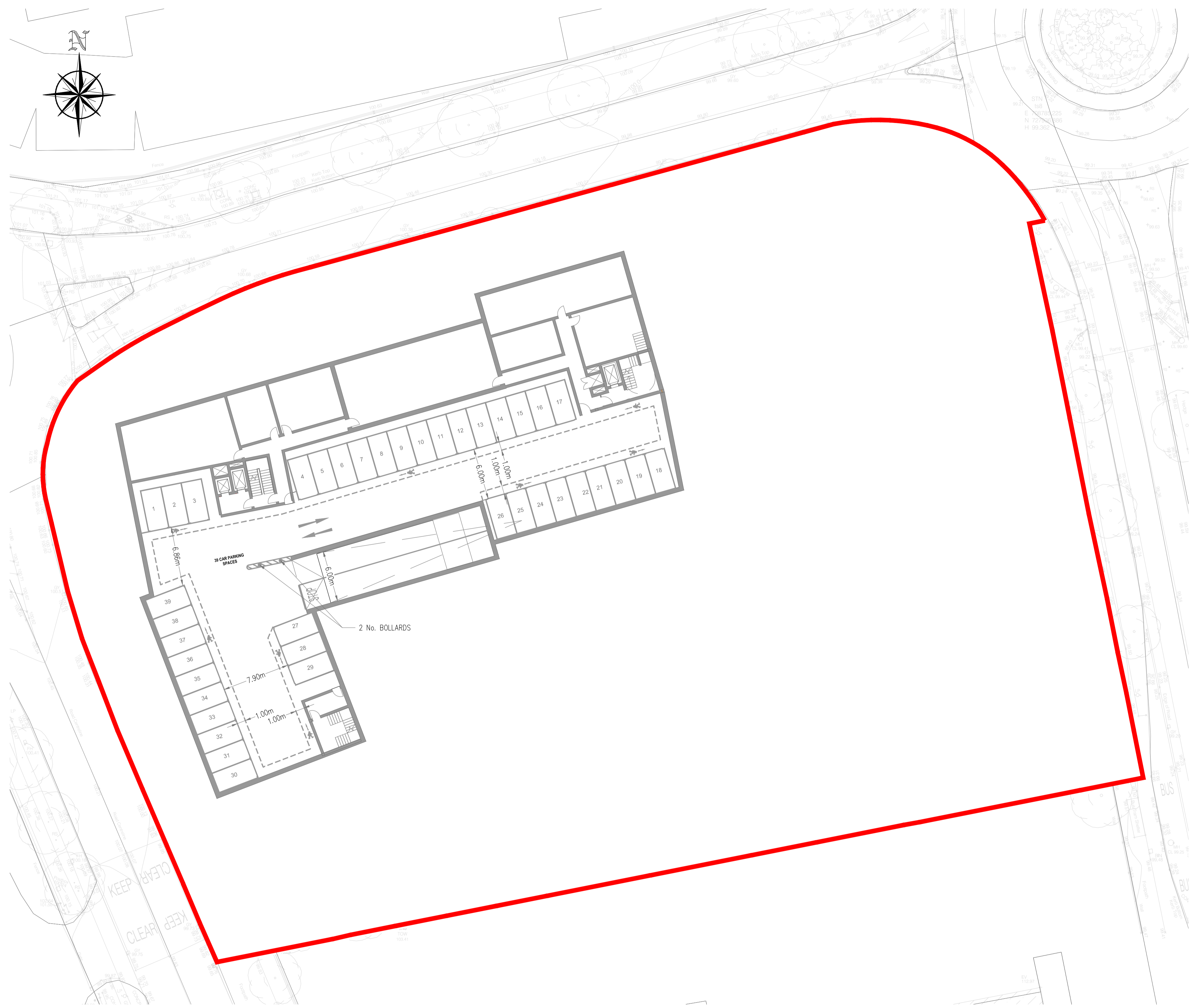

PROPOSED BASEMENT LEVEL LAYOUT.
 SCALE= 1:250

PLANNING DRAWING
 THIS DRAWING HAS BEEN ISSUED FOR
 PLANNING PURPOSES ONLY
 AND MUST NOT BE USED
 FOR ANY OTHER CIRCUMSTANCES

NOTES

- For setting out refer to Architect's drawings.
- This drawing to be read in conjunction with all other Architectural and Engineering drawings and all other relevant drawings and Specifications.
- DO NOT SCALE THIS DRAWING. Use figured dimensions only.
- No part of this document may be reproduced or transmitted in any form or stored in any retrieval system of any nature without the written permission as copyright holder except as agreed for use on the project for which the document was originally issued.
- Ordnance Survey Ireland Licence Number EN 0074022

Rev. No.	Date	REVISION NOTE	Drn. By	Chkd. By
P1	11.04.2022	ISSUED FOR REVIEW	DB	DB
P2	11.05.2022	ISSUED FOR REVIEW	SC	GF
P3	16.05.2022	ISSUED FOR PLANNING	SC	RF

Client	Landmarque Belgard Development Co. Ltd
Project	The Arboury Belgard Road, Dublin 24
Title	PROPOSED BASEMENT LEVEL LAYOUT
Dwg. No.	BR-CSC-ZZ-BR-DR-C-0004
Date	Apr. 2022
Drn. by	SC
Chkd. by	RF
Aprvd. by	DR
Scale	1:250@A1
Revision	P3

CS Consulting Group
 DUBLIN | LONDON | LIMERICK

Head Office
 19-22 Dame Street, Dublin 2.
 T: +353 (0)1 5480863
 e: info@csconsulting.ie
 w: www.csconsulting.ie

NSAI Certified

Quality Environment Health & Safety
 I.S. EN ISO 9001:2008
 I.S. EN ISO 14001:2004
 I.S. EN ISO 50001:2011
 OHSAS 18001:2007