

Landscape Rationale

To be read in conjunction with landscape drawings

Proposed Development St. Edmunds, Palmerstown (Compliance)

Ronan Mac Diarmada & Associates

Landscape Architects & Consultants

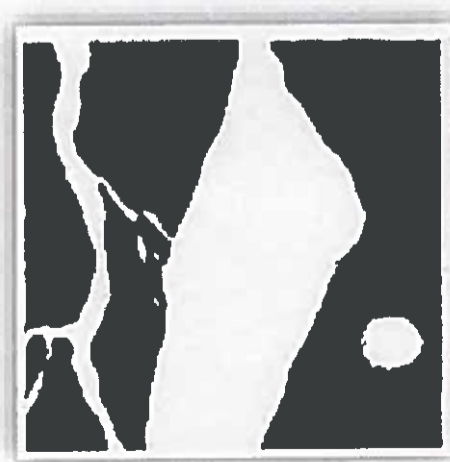

St. Edmunds

Landscape Masterplan(Compliance) Proposed

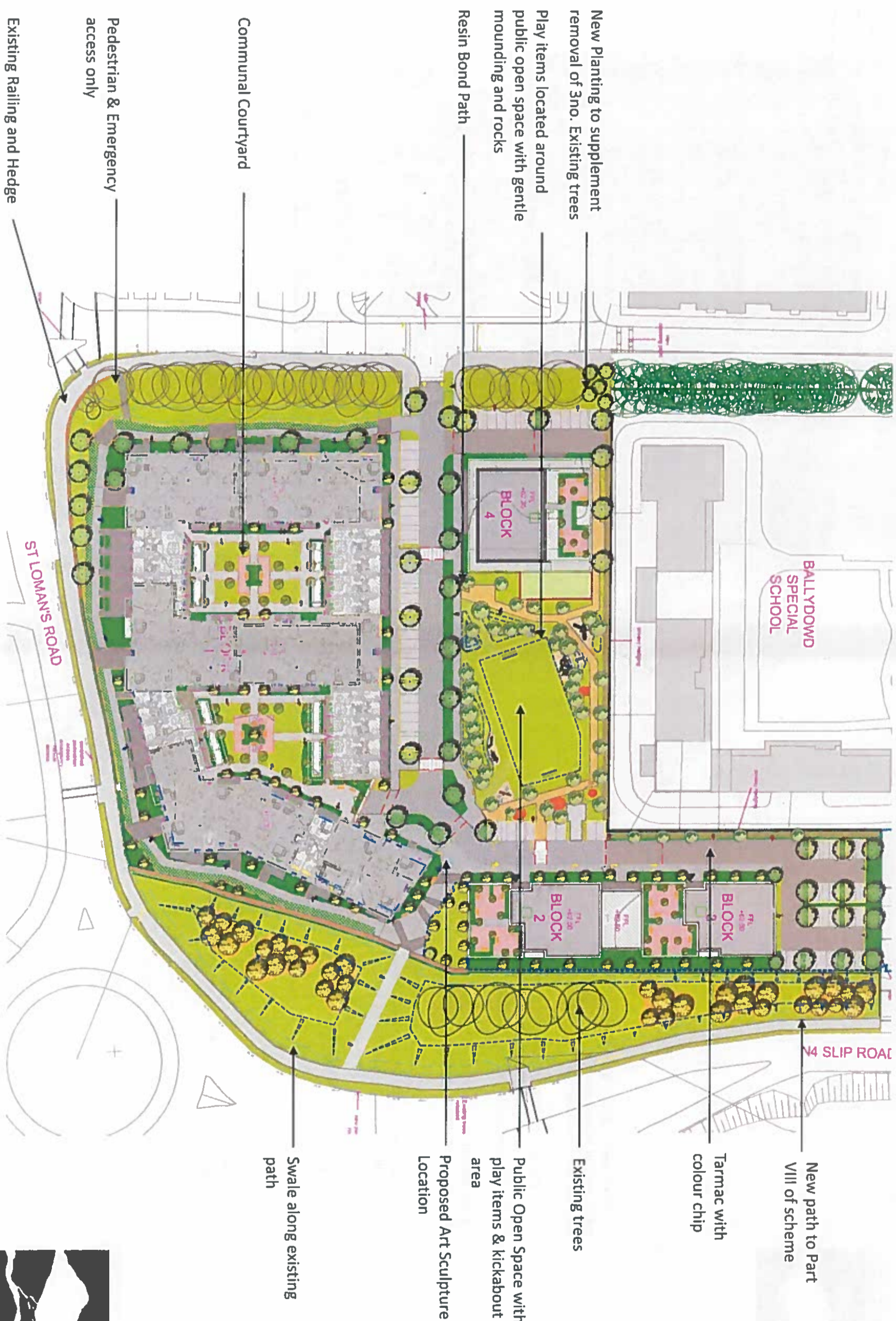

St. Edmunds

Open Space & Communal Space

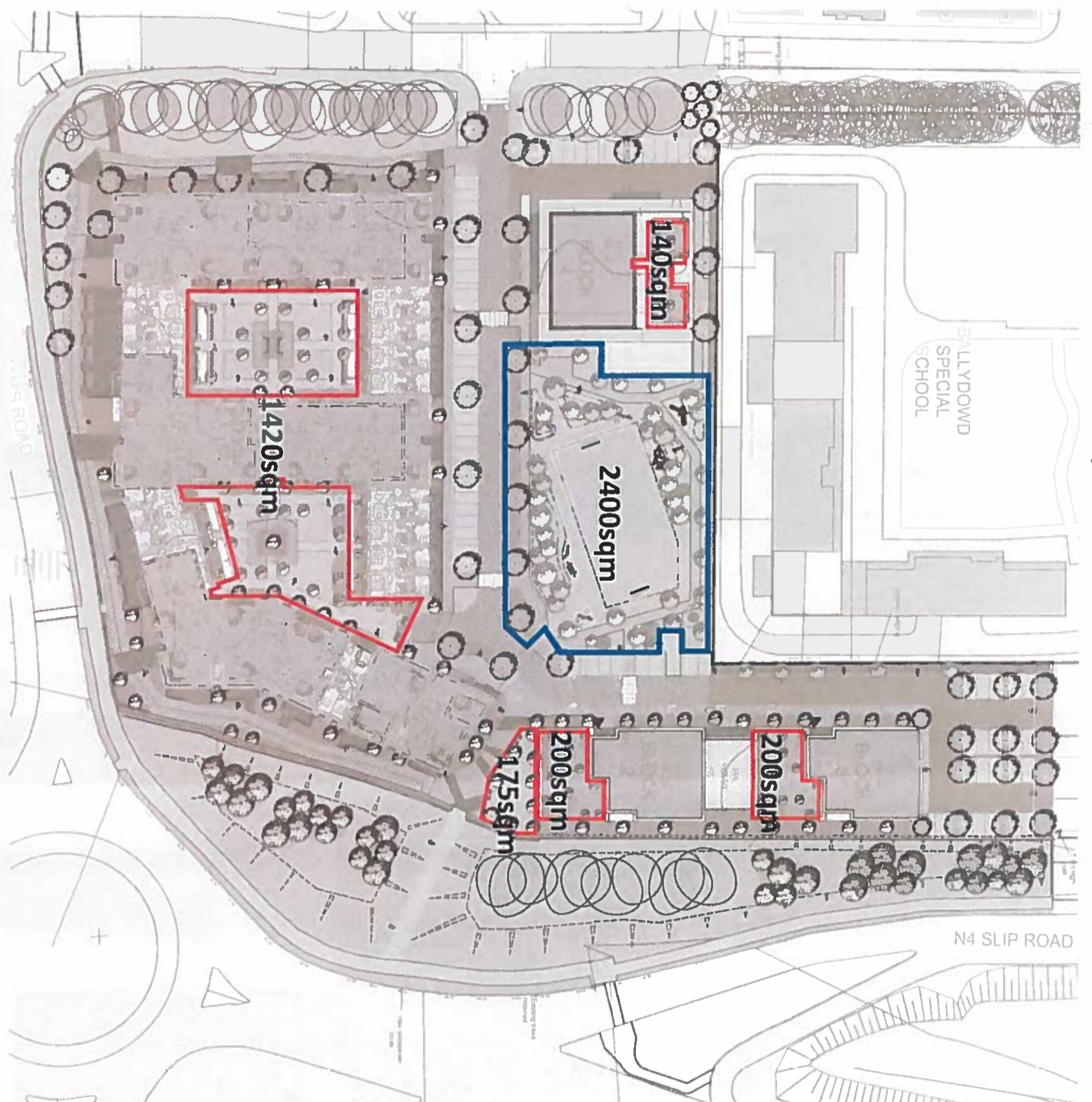

Public Open Space Breakdown as per Architect*

PUBLIC OPEN SPACE

GROSS SITE AREA (including SDCCLands & OMC lands): 27249sqm - 2.72 ha
NET SITE AREA: 20688sqm - 2.06 ha

Public Open Space provided: 2400 sqm (11.5%)

Communal Open Space provided:	
BLOCK 1	1420 sqm
BLOCK 2	200 sqm
SHARED BETWEEN BLOCK 1 & 2	175 sqm
BLOCK 3	200 sqm
BLOCK 4	140 sqm

- ▭ Communal Open Space
- ▭ Open Space

The Quality, functionality and usability of the open space has been developed with the end user as the focal point.

It has been developed to provide a wide range of amenity and activity on the main open space.

A large kick about with goal posts on either end is proposed, a number of play items for children aged 2 – 12 years old are also included.

A number of natural play items, rocks and tree trunks have been located along with the slopes and mounds proposed for the open space.



St. Edmunds

Existing Trees & Proposed Trees

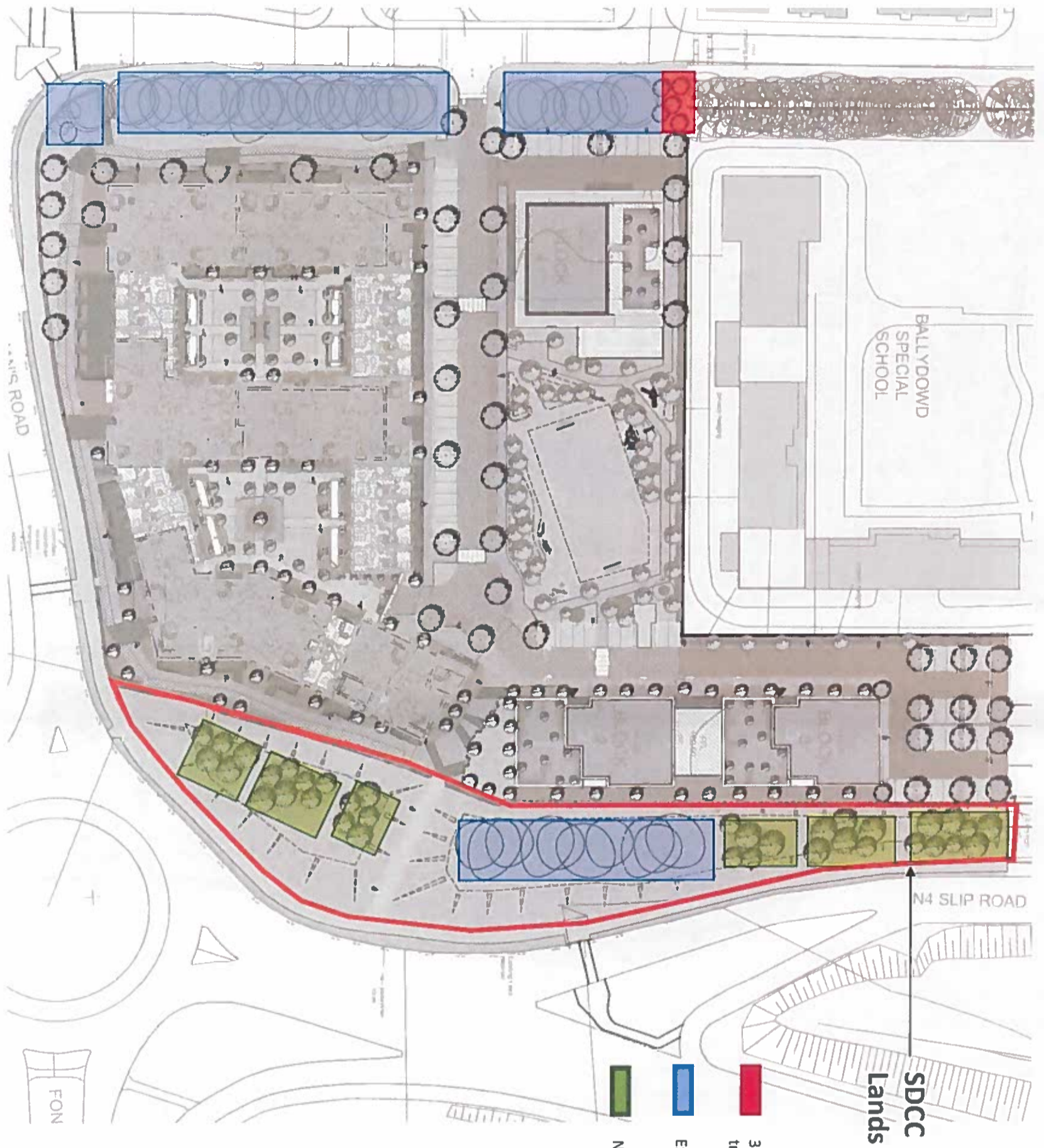

- 3 no. Trees to be removed and new trees implanted during construction
- Existing trees to be retained
- New Native Tree Planting

St. Edmunds

Pedestrian Linkage through Development

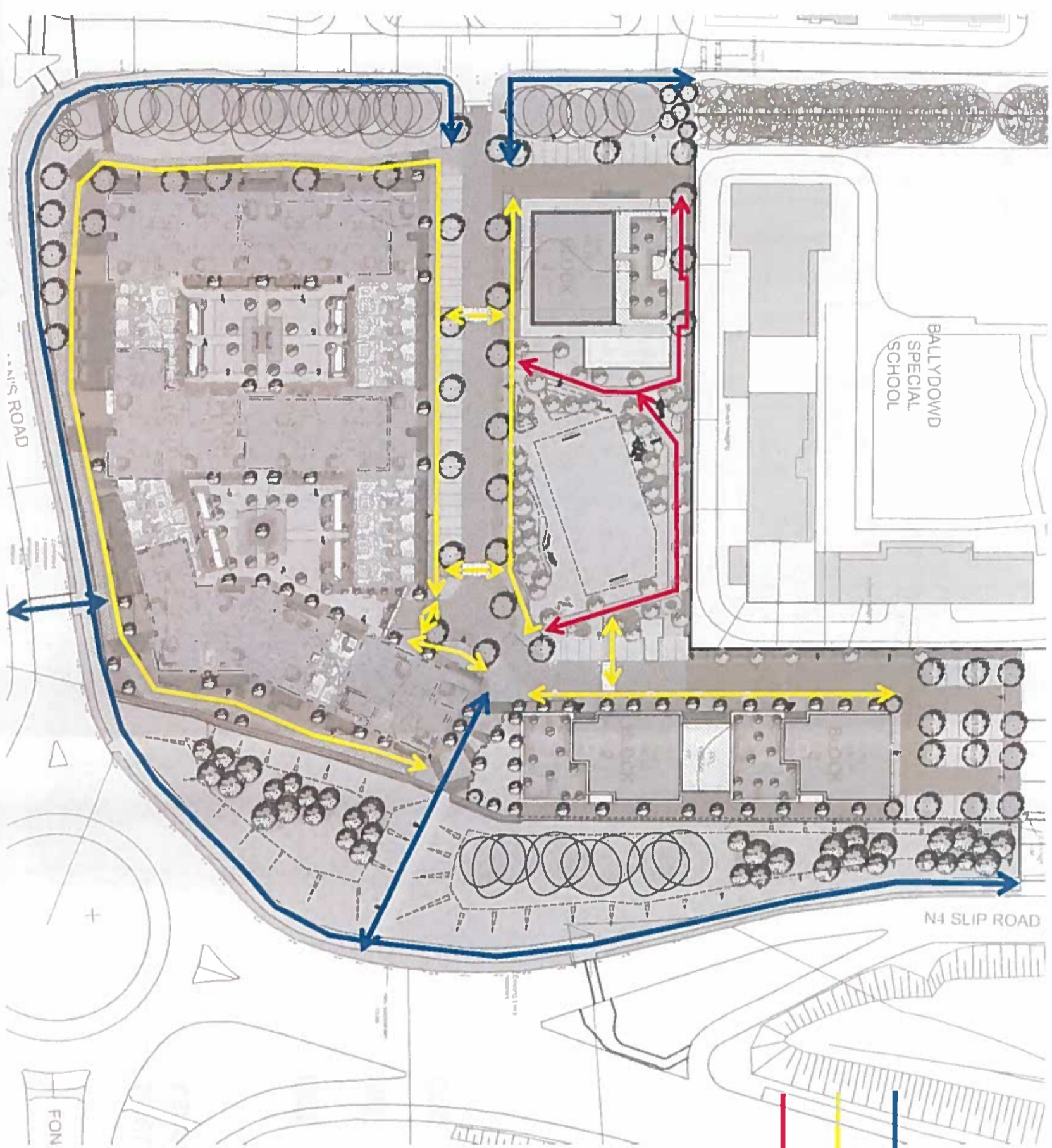



- External link to development
- Internal green link for development
- Amenity link through open space

St. Edmunds

Landscape Masterplan

Road Treatment

-  Tarmacadam
-  Lismore Paving Block
(240x160, 160x160,
160x120 x80mm)
-  Tarmacadam with colour chip



Tarmacadam with colour chip



Rustic Paving Block to on street parking

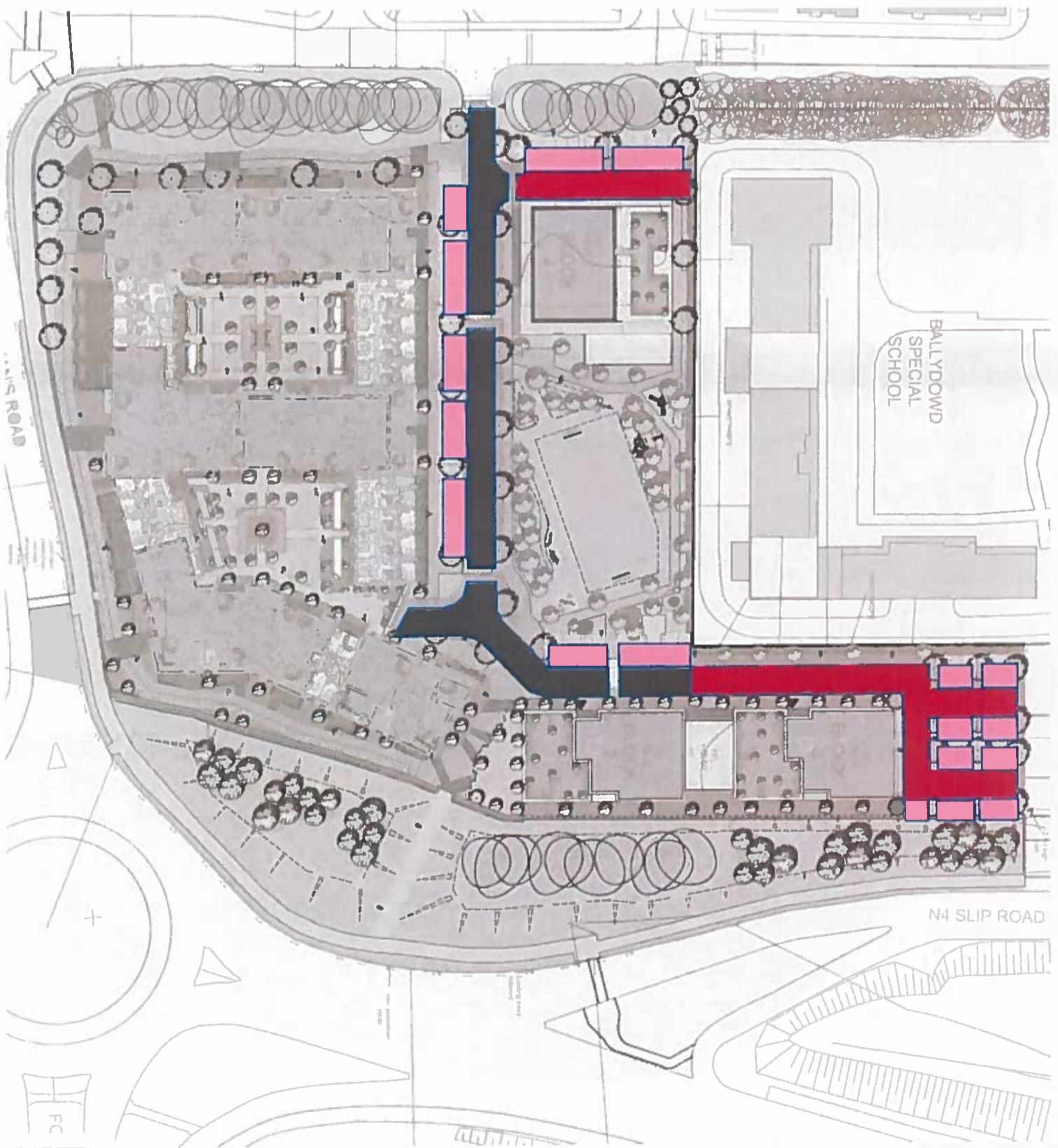

St. Edmunds

Landscape Masterplan

Hardscape Treatment (or similar approved)

- Irish Curragh Gold 200x50mm
- Newgrange paving 240x160 & 160x160, 160x120mm (Grey)
- Newgrange paver 240x160 & 160x160, 160x120mm (silver)
- Newgrange paver 240x160 & 160x160, 160x120mm (black)

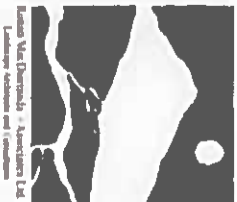
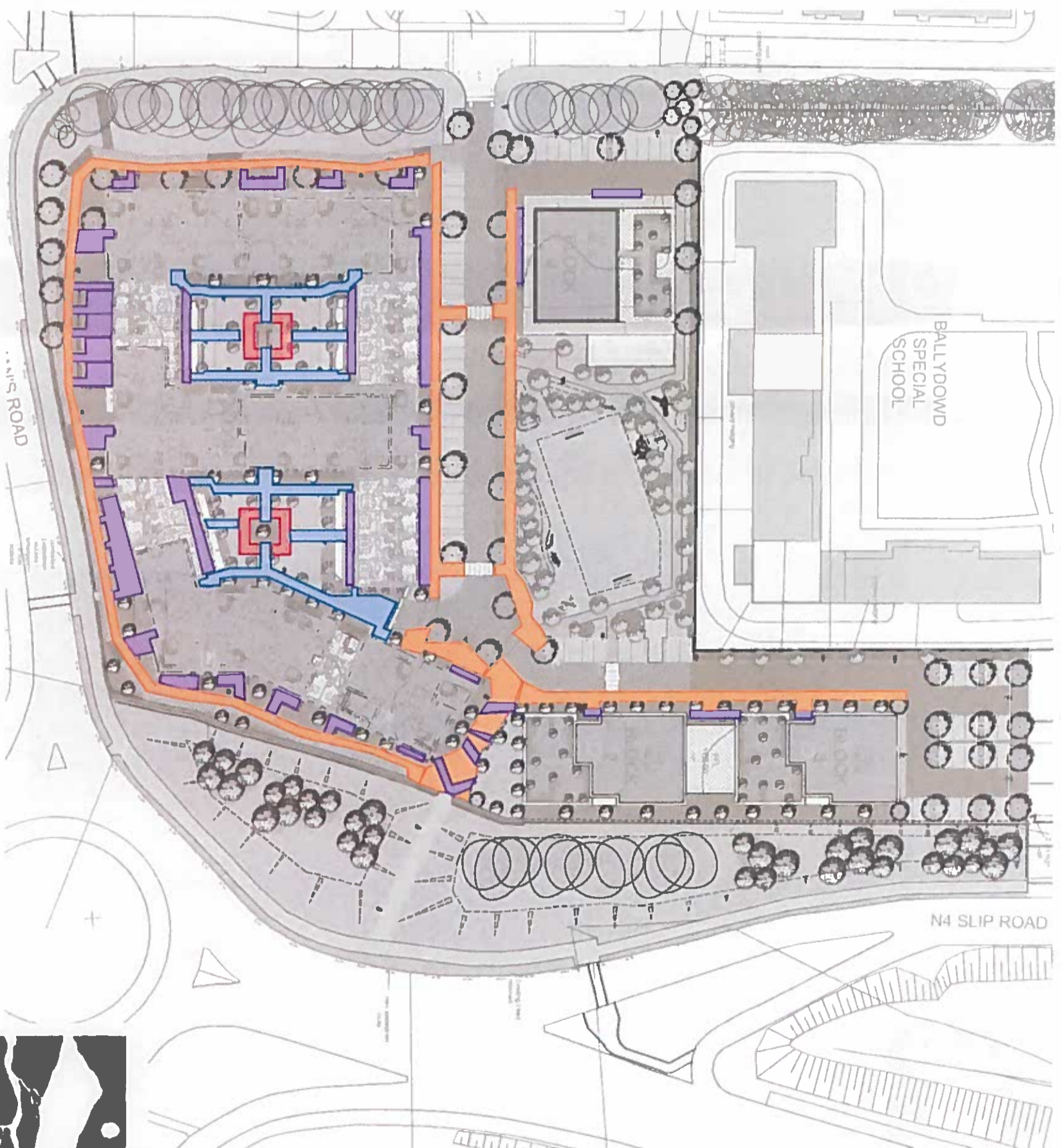

St. Edmunds

Landscape Masterplan

Path Treatment (or similar approved)

- Resin Bond path
- Concrete path
- Grasscrete – planted with Armeria maritima



Beige Tarmac



Concrete Path to Open Space



Grasscrete planted with Armeria maritima

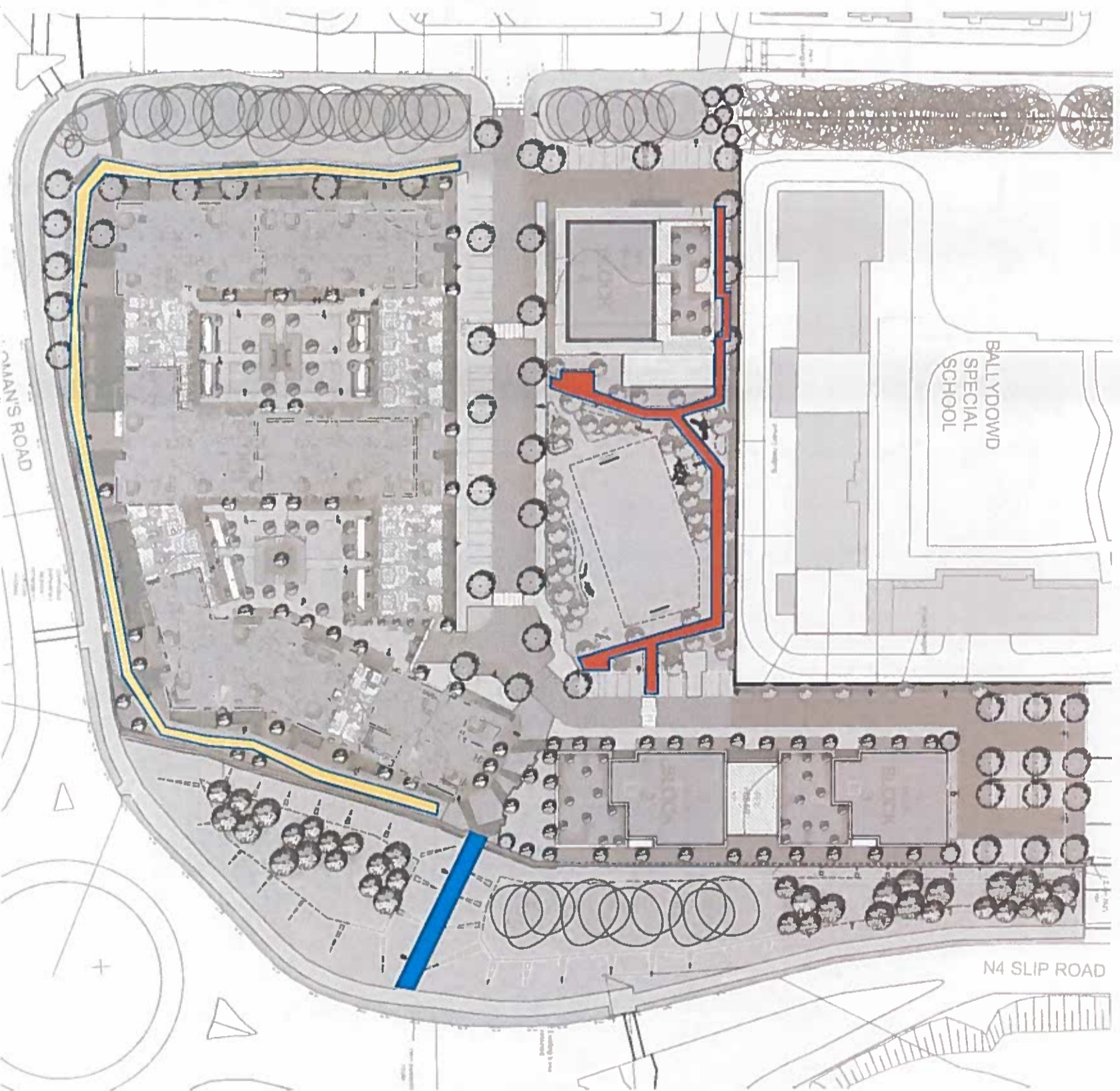

St. Edmunds - A Vision for the Future

St. Edmunds

Landscape Masterplan

Urban Furniture Locations

 Hartecast 2028 Bench or similar approved

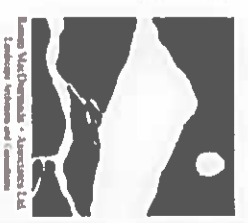
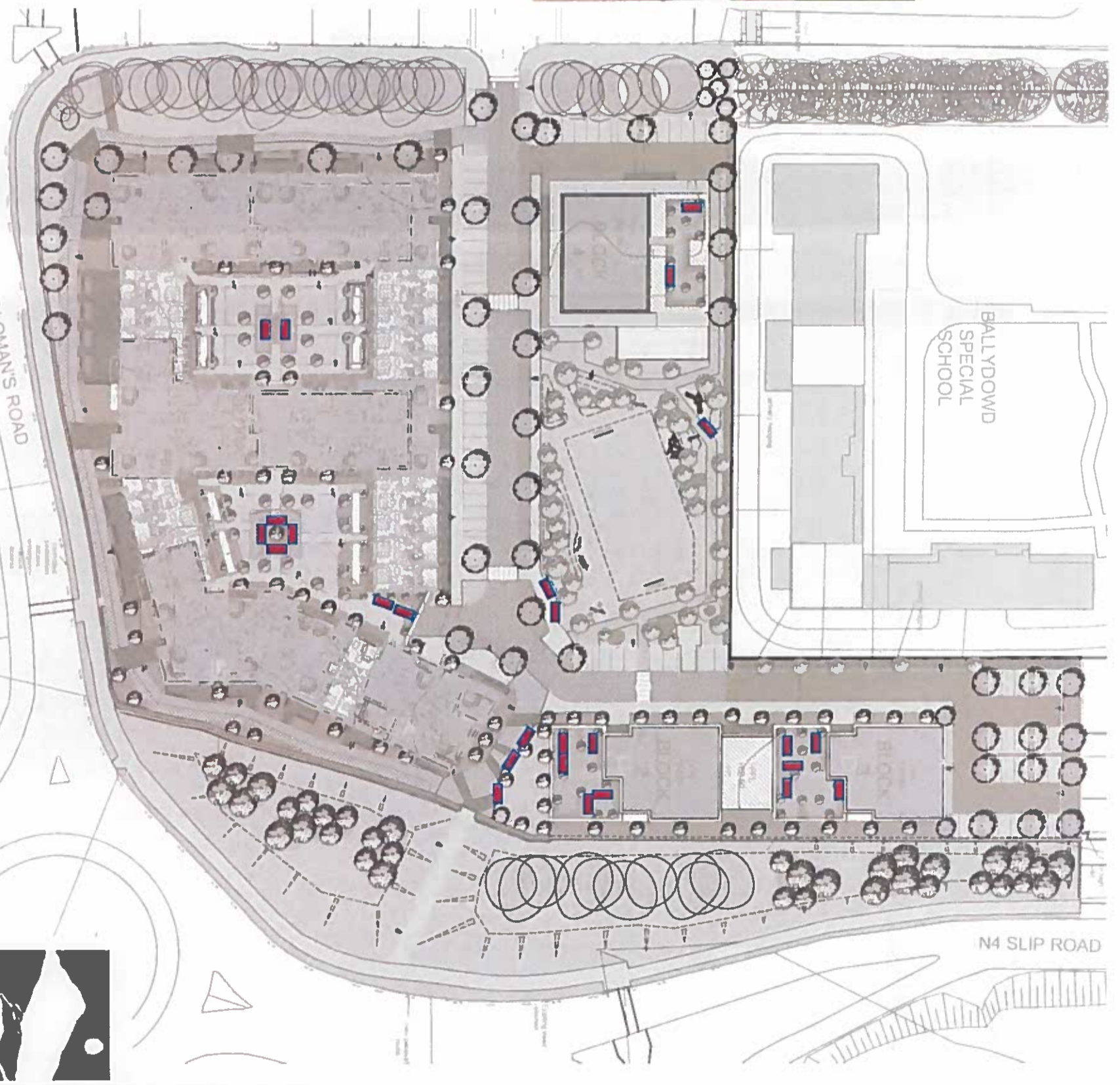
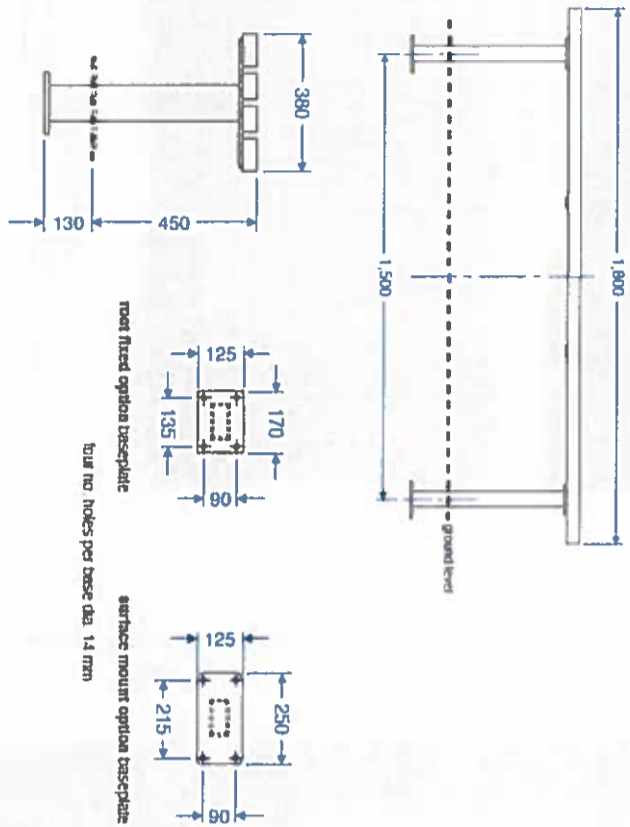

St. Edmunds Landscape Masterplan

Public Art Piece

 Art piece location

The art piece is to be viewed by all, both the future residents of the development and the wider public who will make use of the proposed facilities' within the Urban Plaza.

Typical Examples of Public Art in Dublin

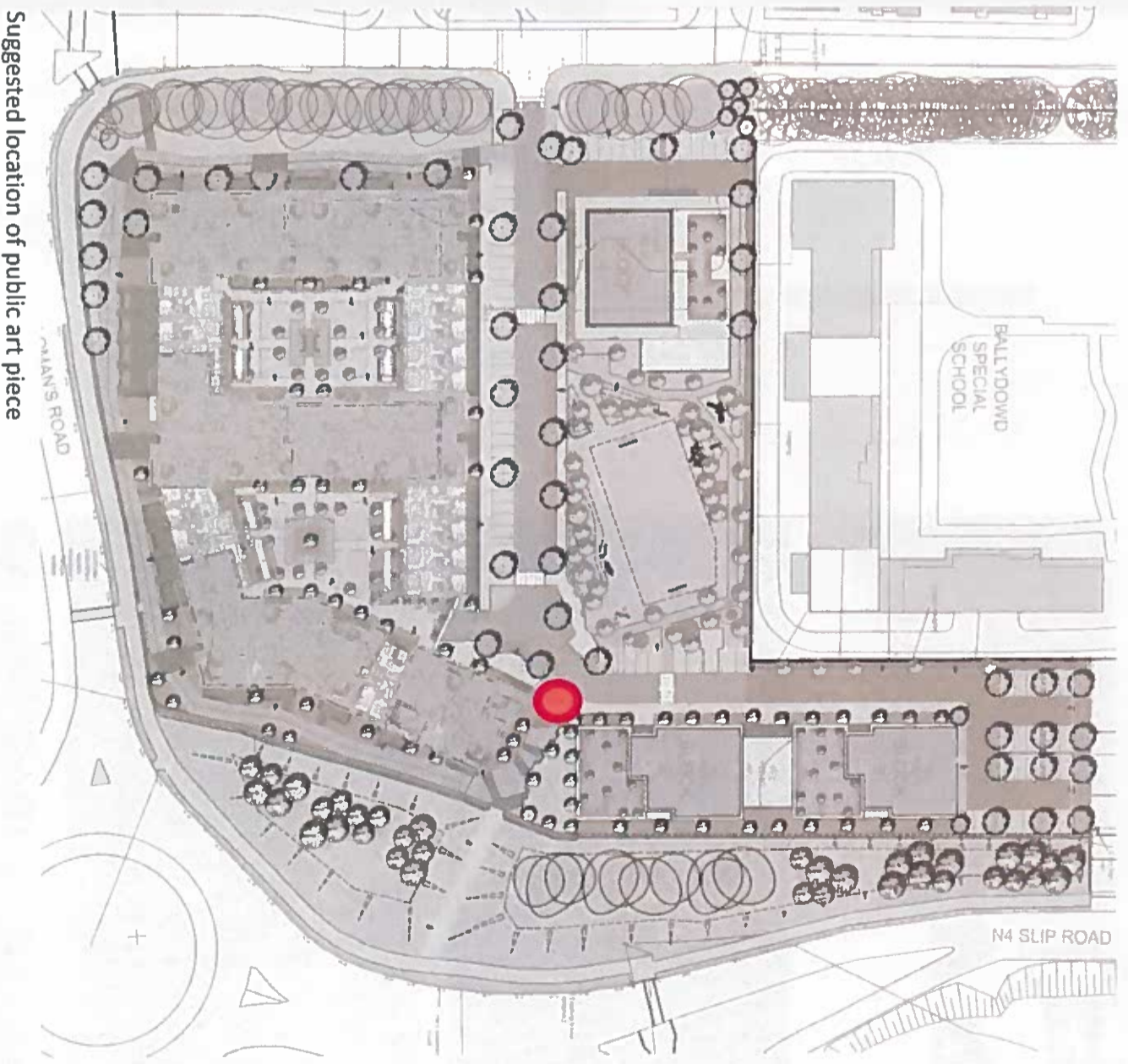

Robert Mackintosh Architects Ltd
Landscape Architecture & Interiors

St. Edmunds

Proposed Design for Public Open space



Soccer Goal Posts Spec:
 Manufactured from wood, metal or approved material.
 Distance between the posts is 3.54M.
 Distance from lower edge of the crossbar to the ground is 1.77M.
 Goalposts & the crossbar must be white & do not exceed 120cmØ.
 Nets may be Provided.

Goal Post Ireland – supplier

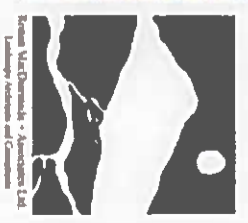
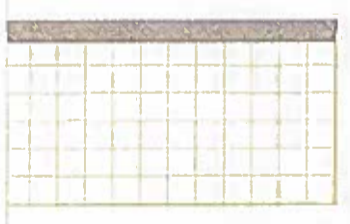
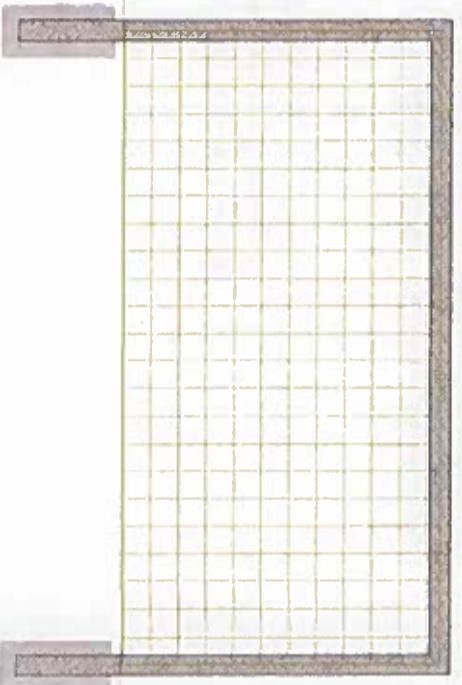

St. Edmunds

Children's play items

Embankment Slide

Age range :3+



The Central Open Space is the location of both formal and informal play elements. The mounding and play items provides a unique source of adventure for the children. There is also a kickabout space for older children to utilise.



Play Tower and slide

Age range :3+



Pick up sticks

Age range :6+

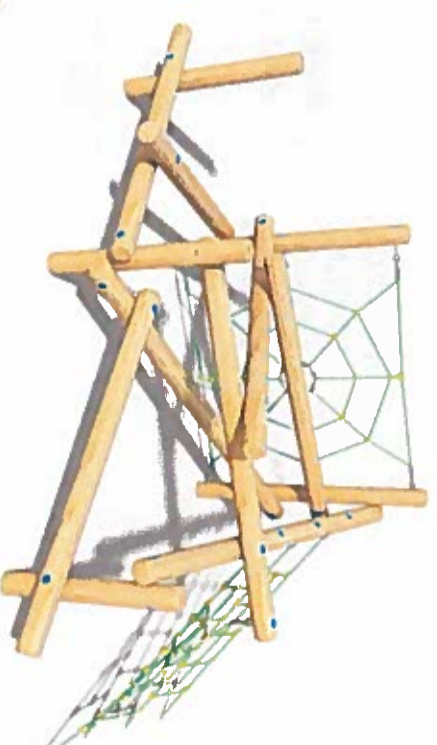

Stepping Logs

Age range :3+



Waterlilies balancing post

Age range :2+



Play Item Specification

Natural Play items taken from the Kompan, Buglo, Wicksteed Range or similar Approved.

All Products are manufactured from Robinia wood. Robinia is a type of Hardwood Timber with unique properties of strength and durability.

Robinia wood does not rot or give the user splinters and is also vandal resistant.

It is perfect for a natural play scheme.

Each Play Item has a fall zone protected with Safagrass Matting or TigerMulch. Safagrass is an environmentally friendly, non-slip, impact absorbing safety surface.

Matting products are available in various sizes and critical fall heights (CFH). Matting is secured with Pegs and Ties.

Safagrass Matting must meet with standards EI1177.



St. Edmunds Children's play items

Play Tower and slide

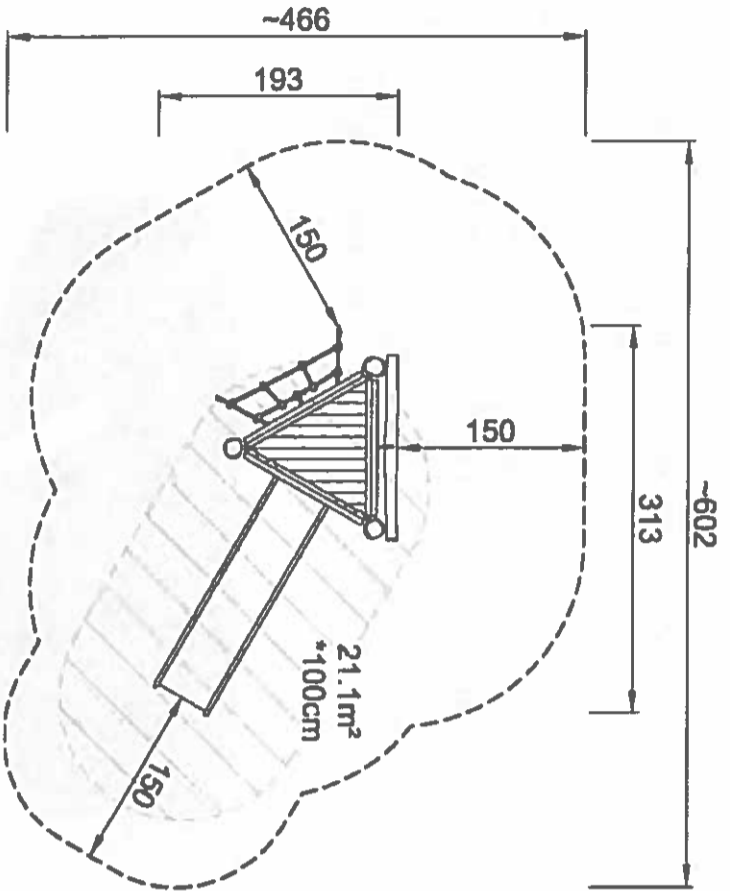

NRO1003-1001
*100cm
**320cm
***21.1m²

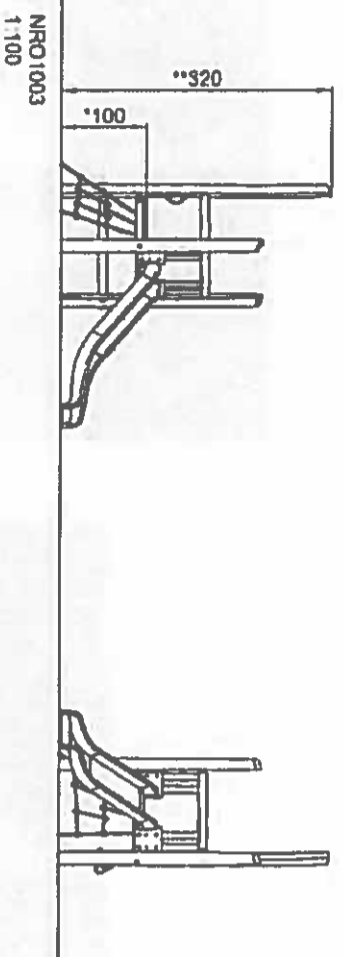

Embankment Slide

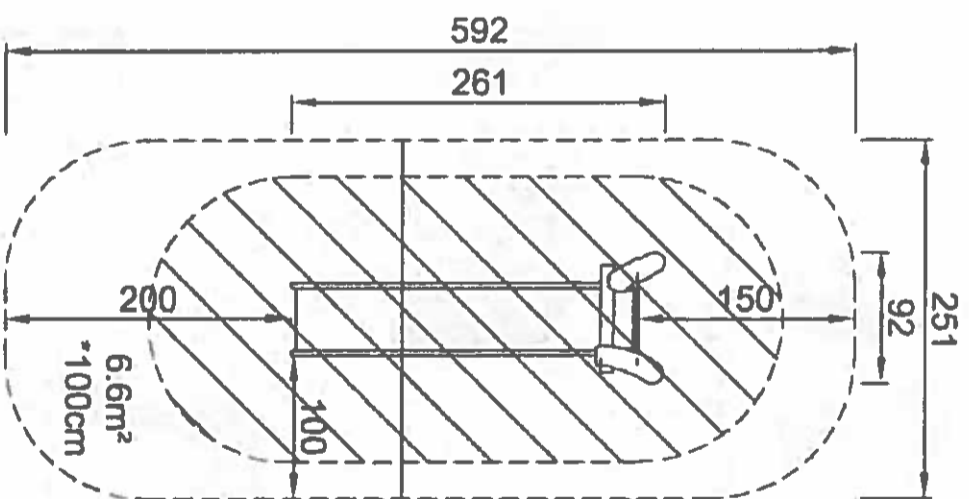

NRO308
*100cm
**192cm
***14.1m²

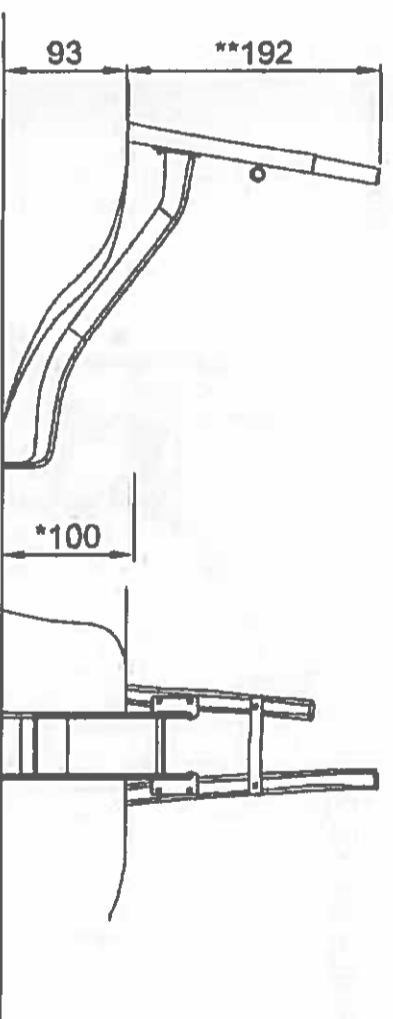

St. Edmunds

Children's play items

Waterlilies balancing post

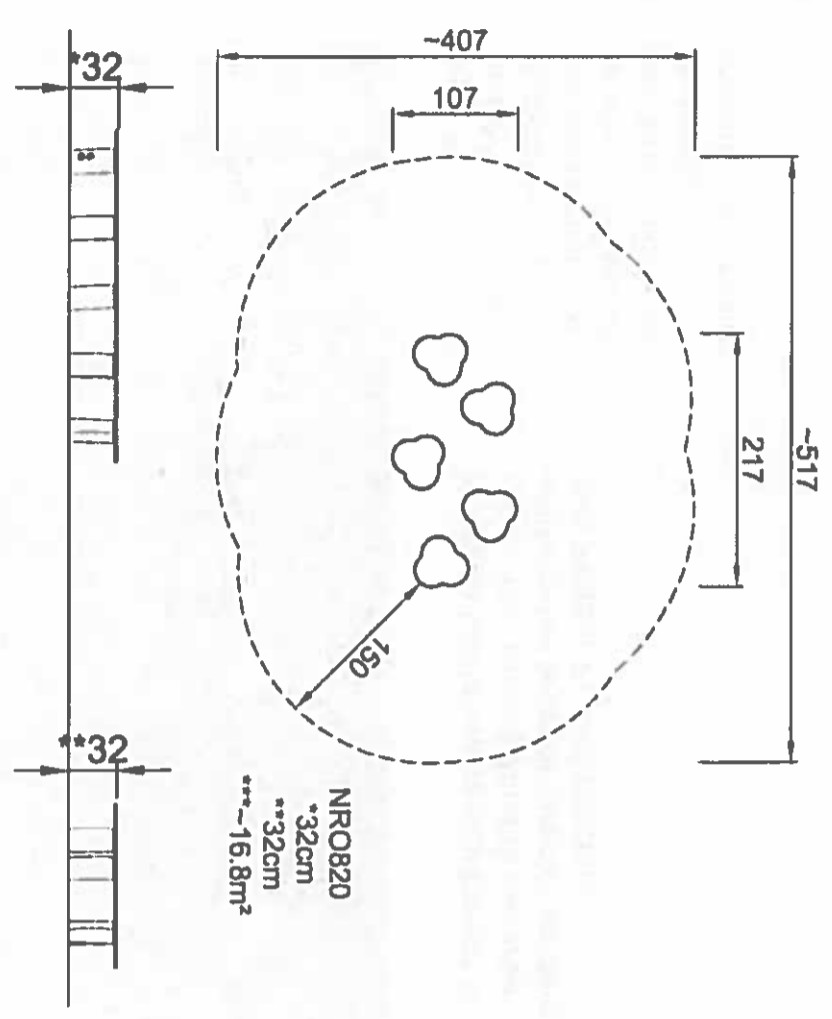

Stepping Logs

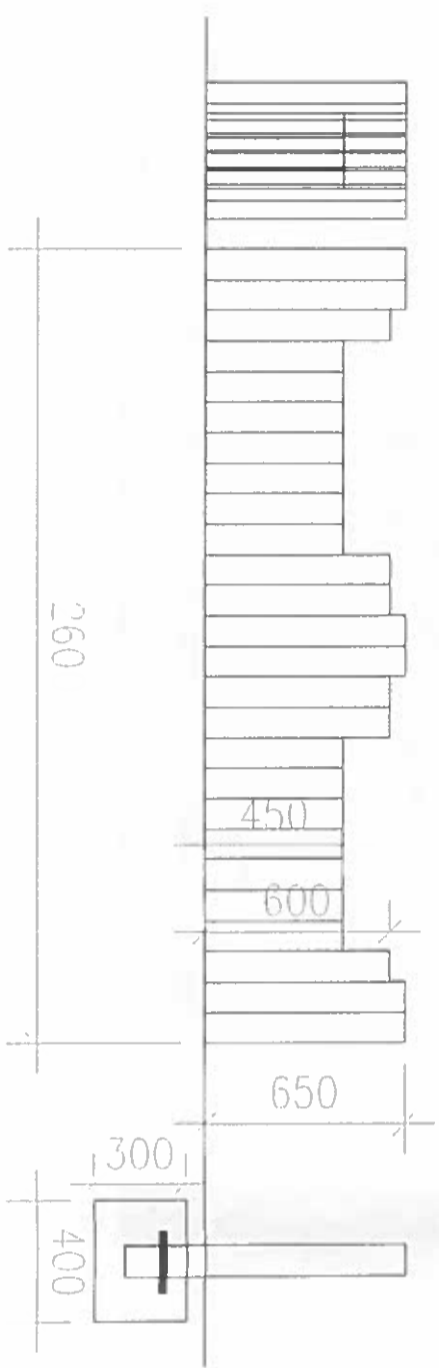

Pick up sticks

PICK-UP STICKS PICUSA
46.5 SQ METRES 70mm WETPOUR
22.0 LINEAR METRES WETPOUR EDGING
MAX FFH = 1850mm

44.5 SQ METRES 55mm TILES
25.0 LINEAR METRES TILE EDGING
32 GRASS MATS
182 MATTA MATS

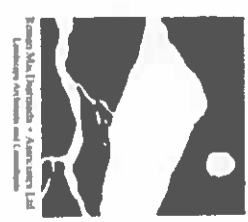
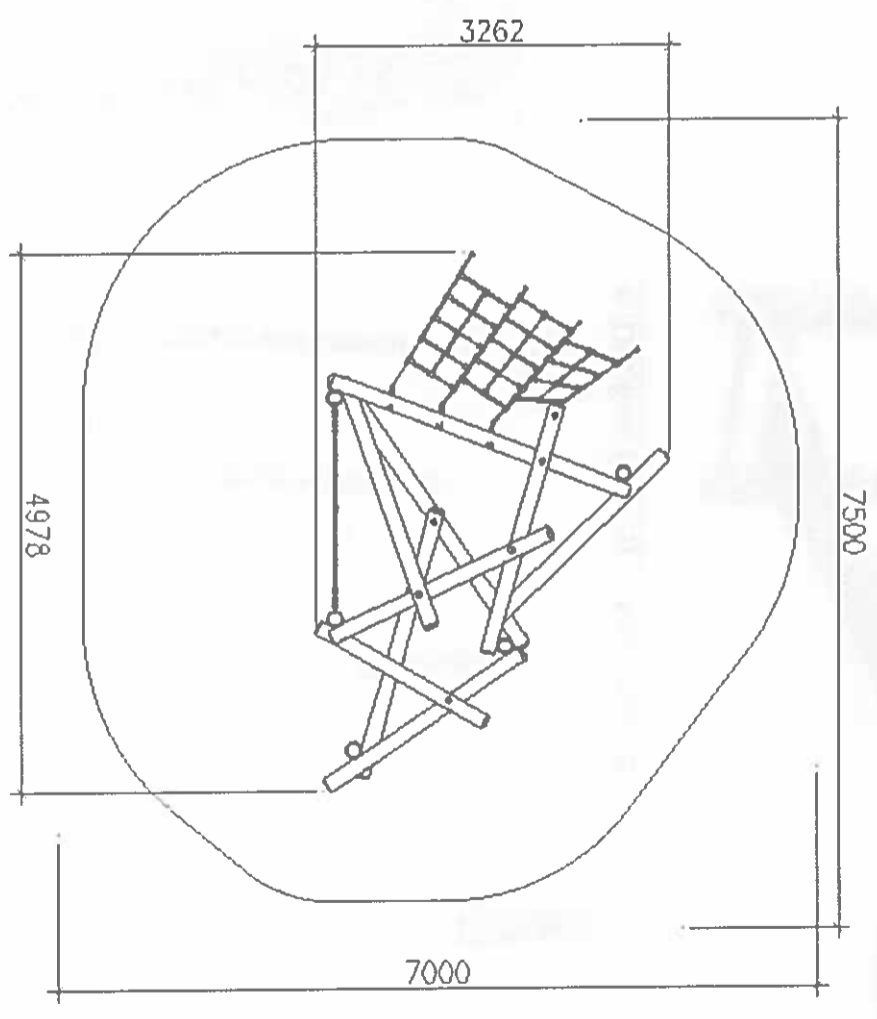

St. Edmunds

Calisthenics items



Note: South Dublin County Council Parks Department to be advised of proposed calisthenics elements prior to ordering & to be involved in construction of same.

Kompan Calisthenics equipment is made from steel elements covered with double layer of powder coating. Wet Rubber Pour Surfacing.

1. Incline press Age range :13+



2. Dip Bench Age range :13+



3. Push up bars Age range :13+



4. Decline Bench Age range :13+

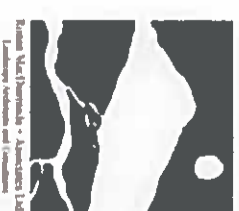

St. Edmunds

Calisthenics items

1. Incline press

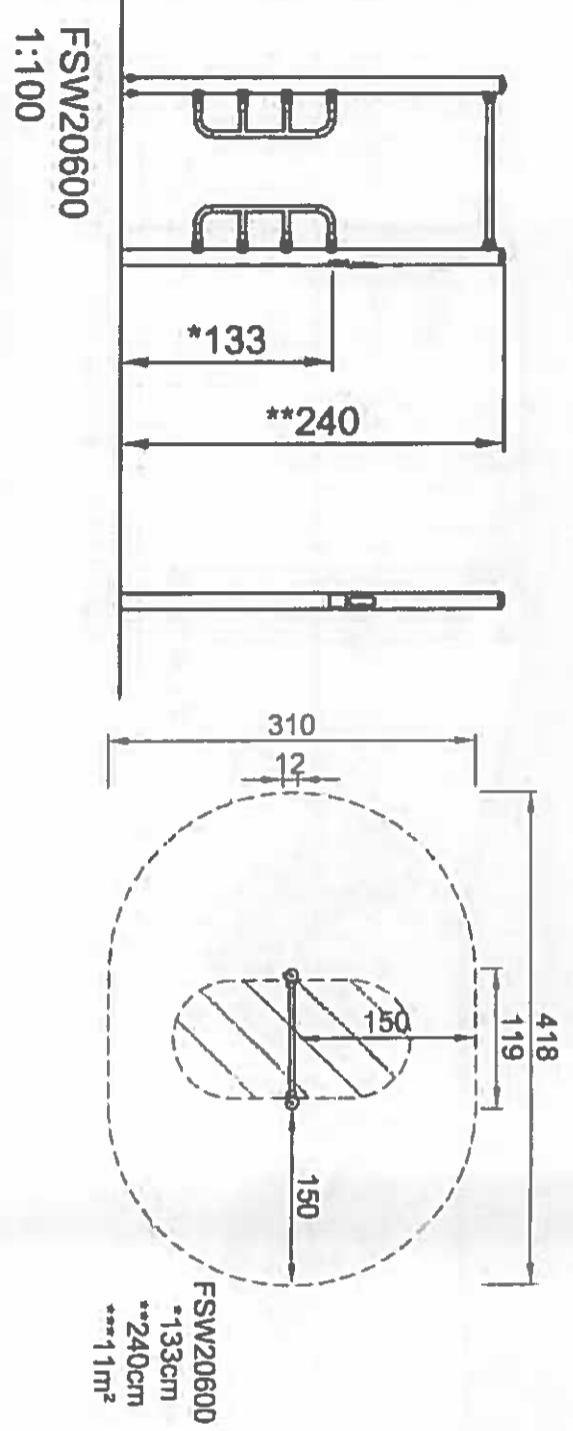

2. Dip Bench

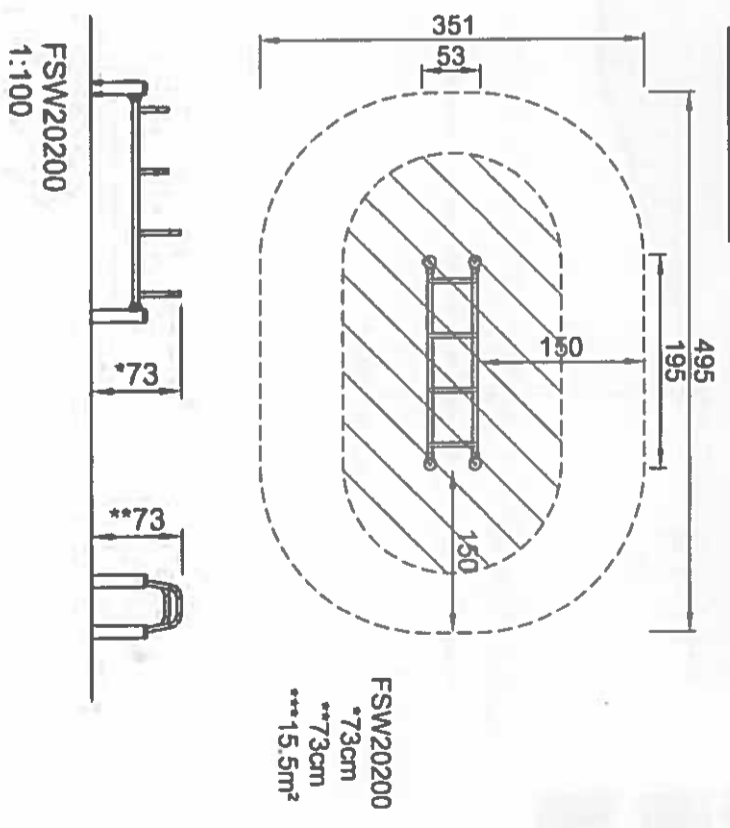

3. Push up bars

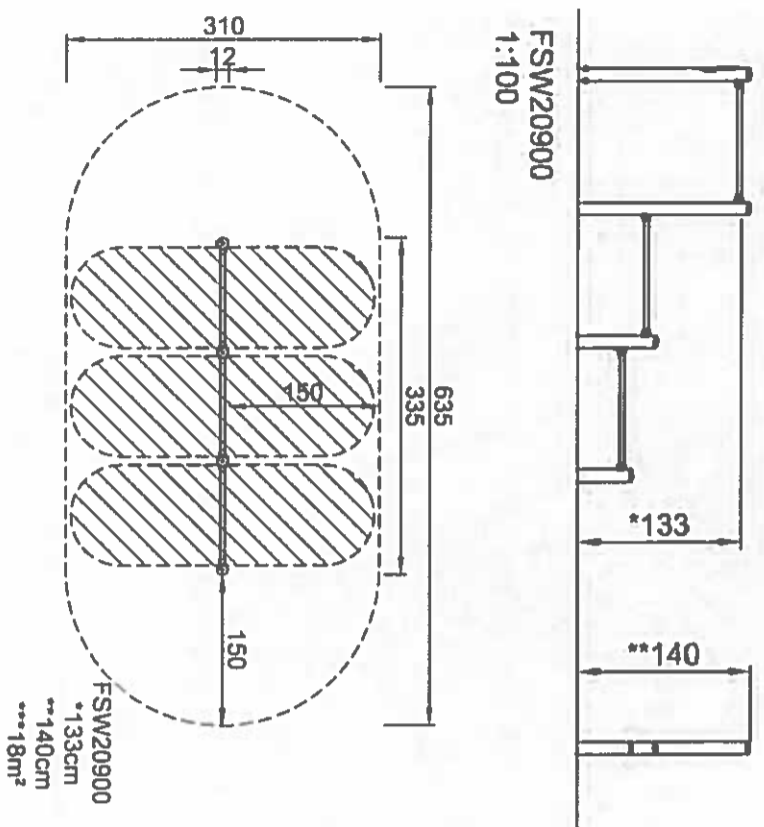

4. Decline Bench

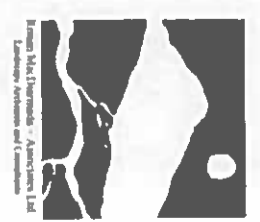
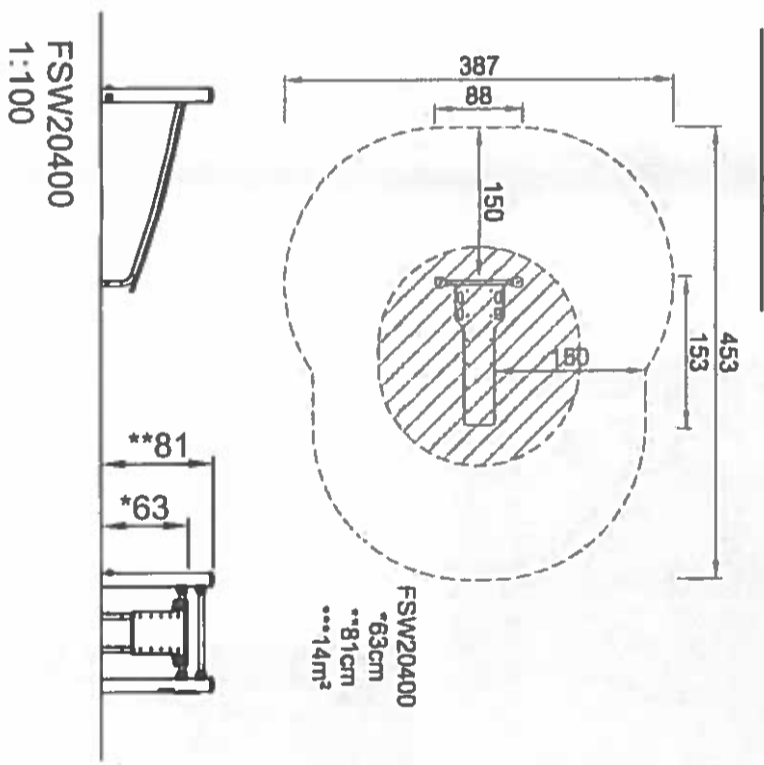

St. Edmunds Eastern Boundary

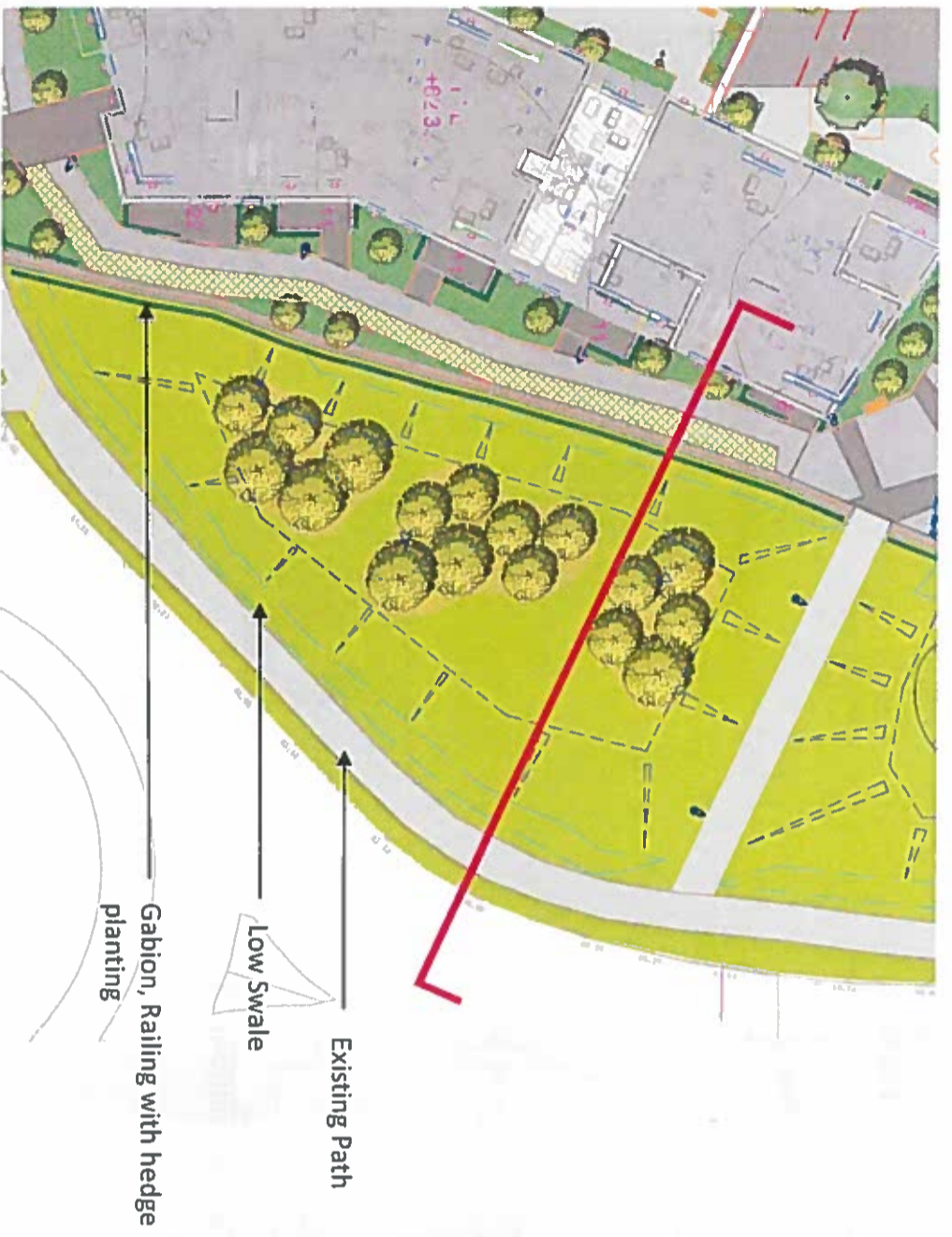

Section H-HH - Open Space Scale (1:100)

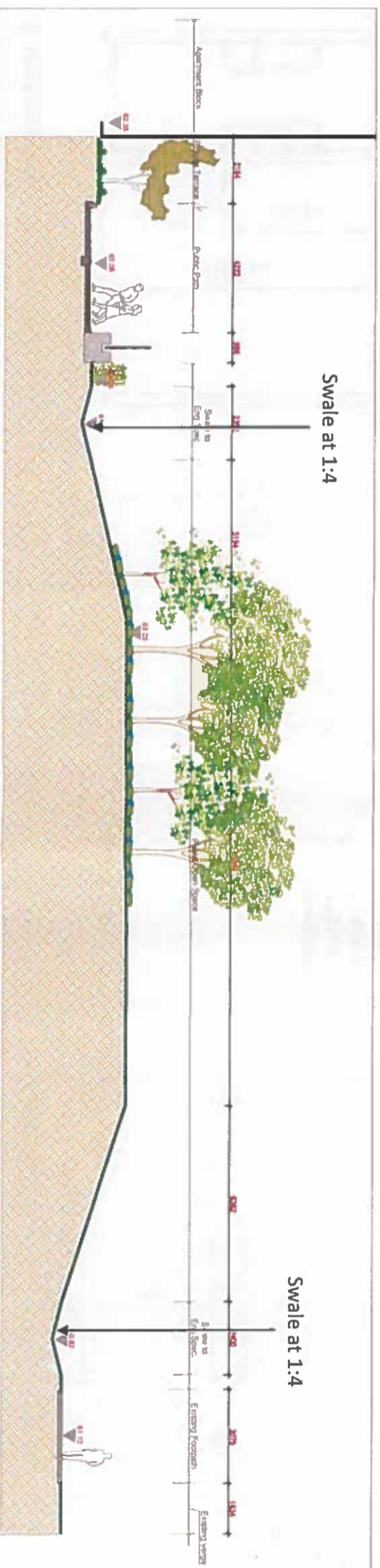

St. Edmunds Communal Courtyards



Vents screened

Vents

Private Terrace



Defensive Planting

Green/Sedum Roofs

Seating



Vents screened



Robert Vale Architects + Associates Ltd
Landscape Architects and Planners

St. Edmunds

Interaction between private ground floor terraces and the streetscape

Ground floor terraces are located around the perimeter of blocks 1 & 2. They are screened from the public realm and communal open spaces by a 1.2m high metal railing and hedge planting to enhance privacy. Each terrace is has a gate so therefore own door access from the street and communal open space is possible.

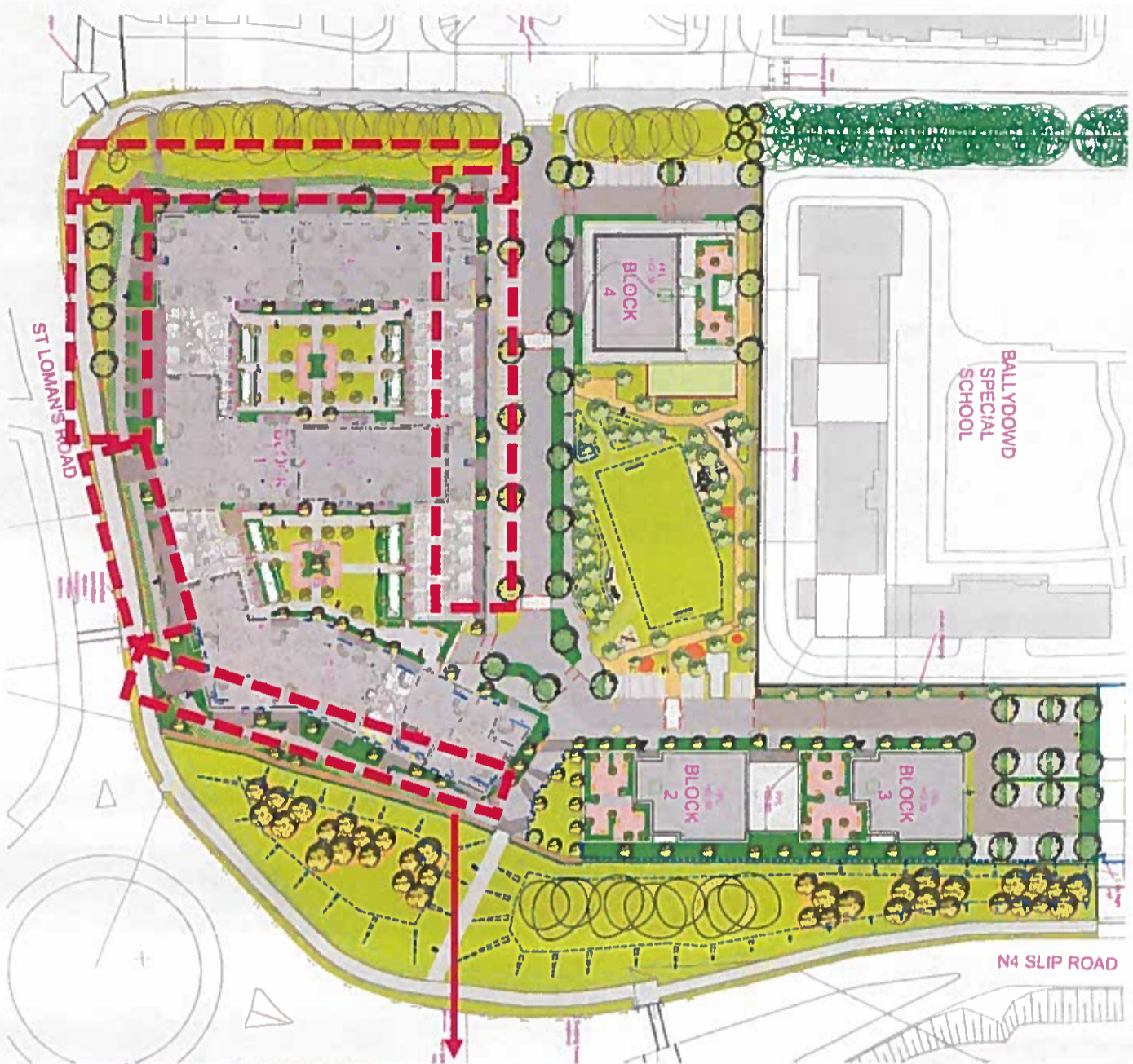

Detail of terraces

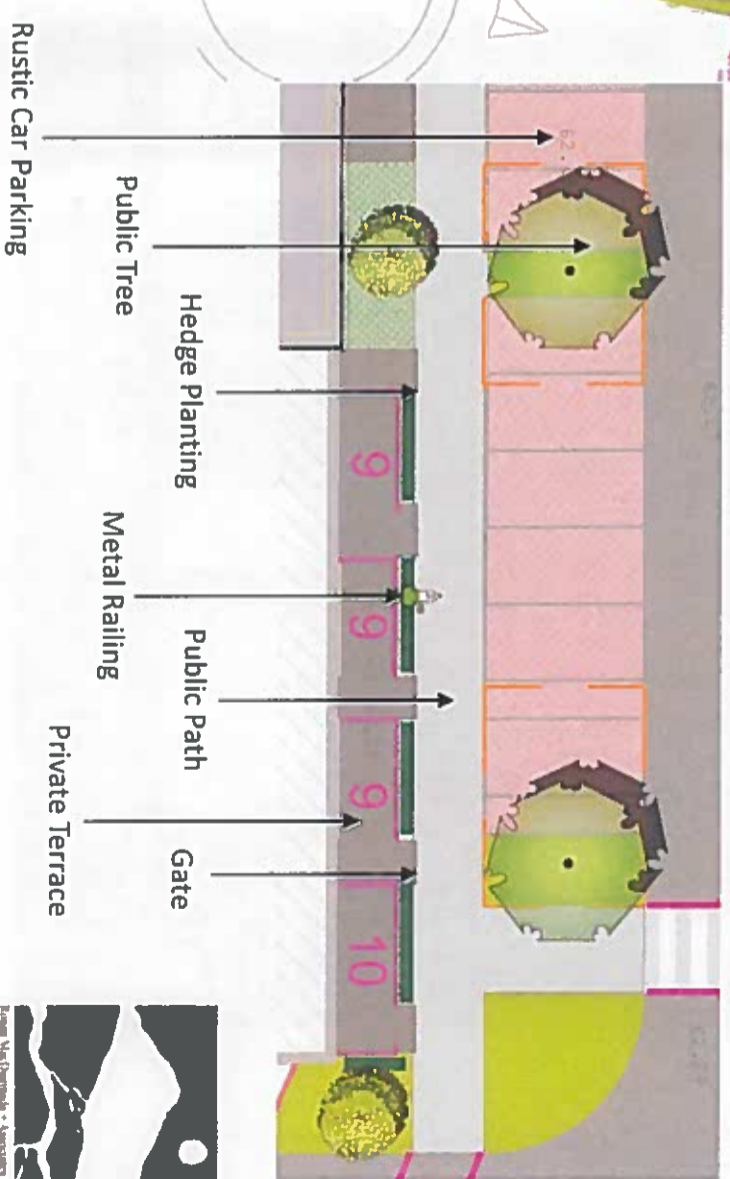

Locations of Private ground floor terraces outlined in red.

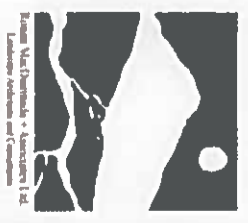

St. Edmunds

Terrace areas and boundary treatment



Area A
Total Terrace Area = 91



Metal Railing with hedge to private terrace boundary

Newgrange paver toto terrace

Area C
Total Terrace Area = 225

(boundary to curtilage of private terraces or similar approved)

Railing Details Scale (1:25)

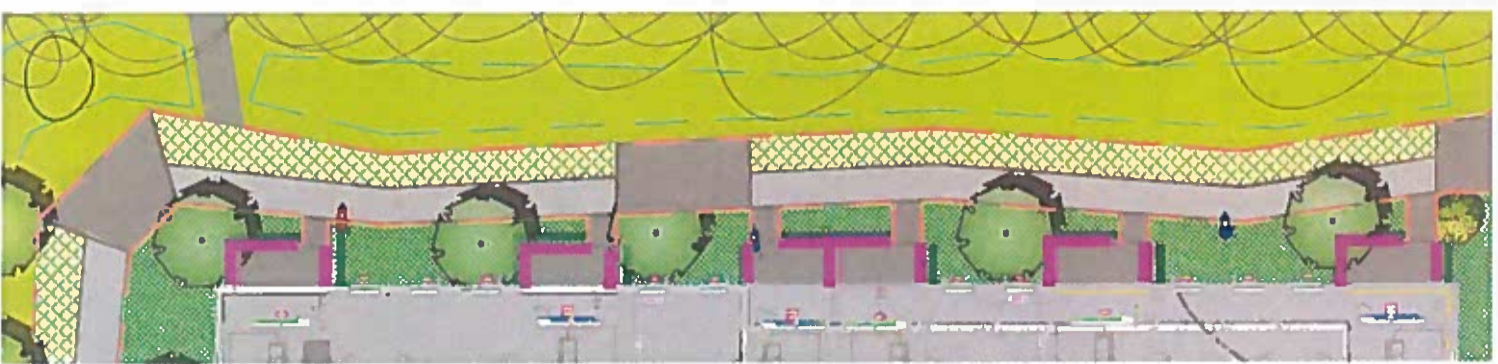
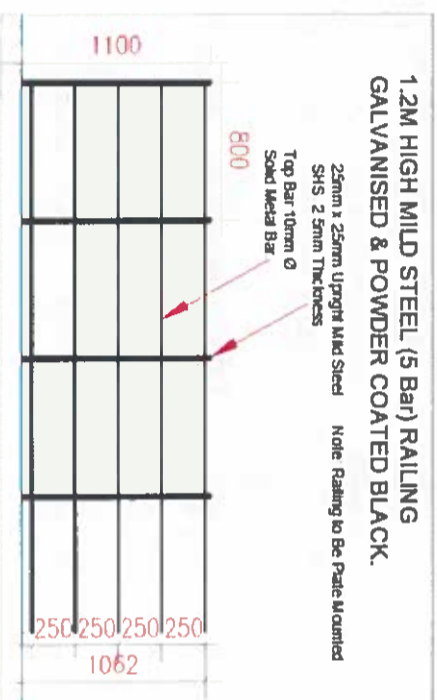

Area B
Total Terrace Area = 60



Area D
Total Terrace Area = 67

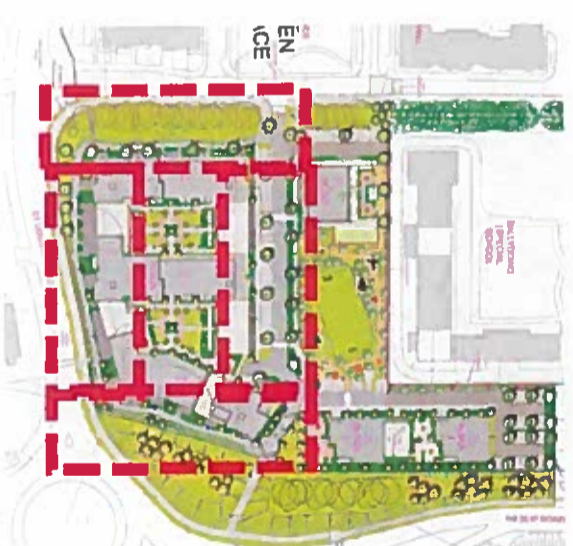

St. Edmunds

Terrace areas and treatment

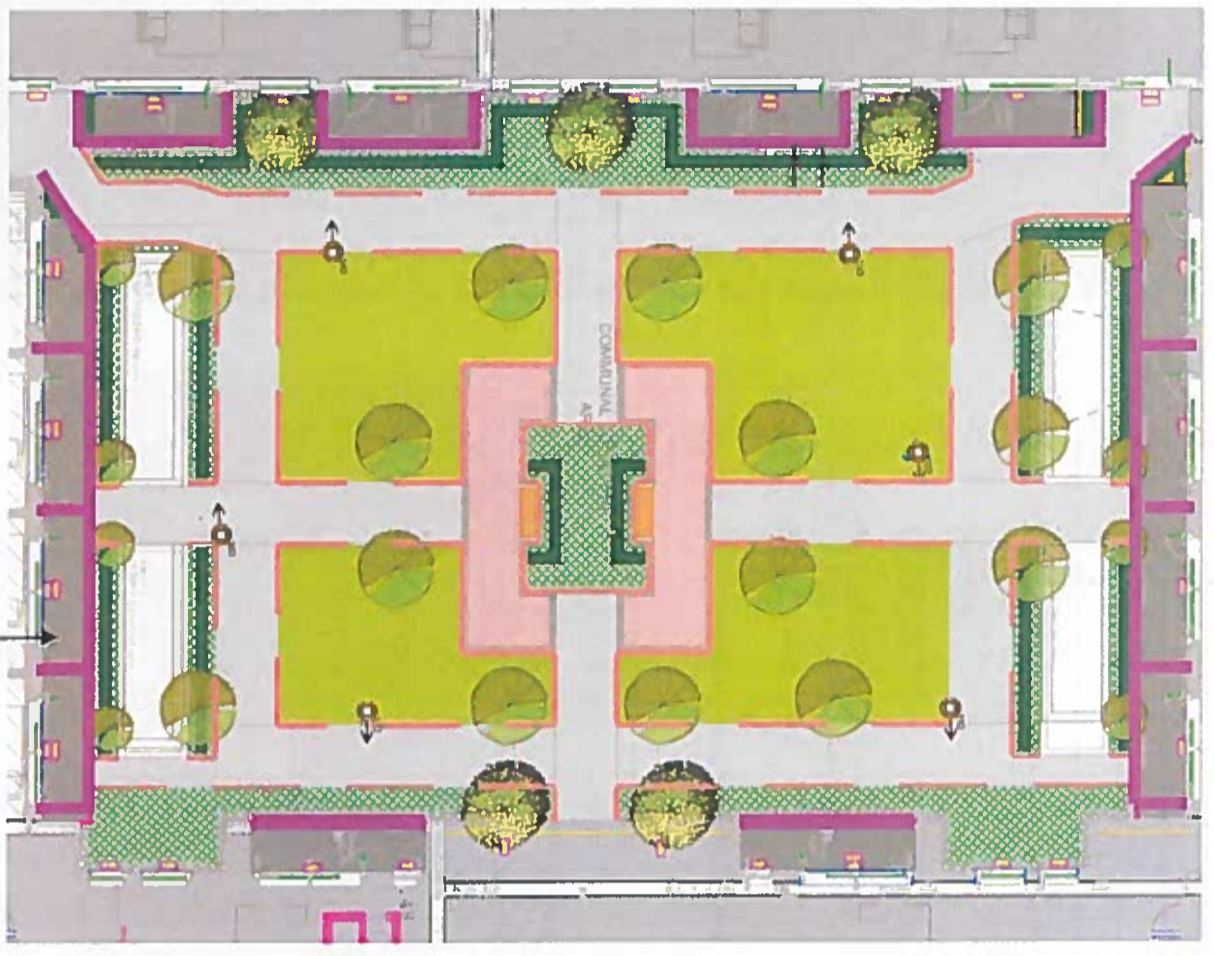

Total Terrace Area = 95

Paving to terrace

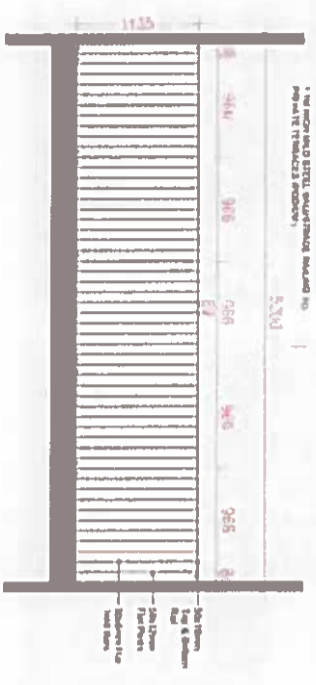

Total Terrace Area = 104

Metal Railing with hedge to private terrace boundary

The communal/private terrace space has been altered to provide for more defensible space for the private units. Paths have been directed away from the private spaces as much as possible. Planting of medium sized shrubs to provide for a soft boundary has been included to increase the privacy of the individual unit and reduce the impact of noise if any.



St. Edmunds

Interaction between private ground floor terraces and the streetscape/public paths

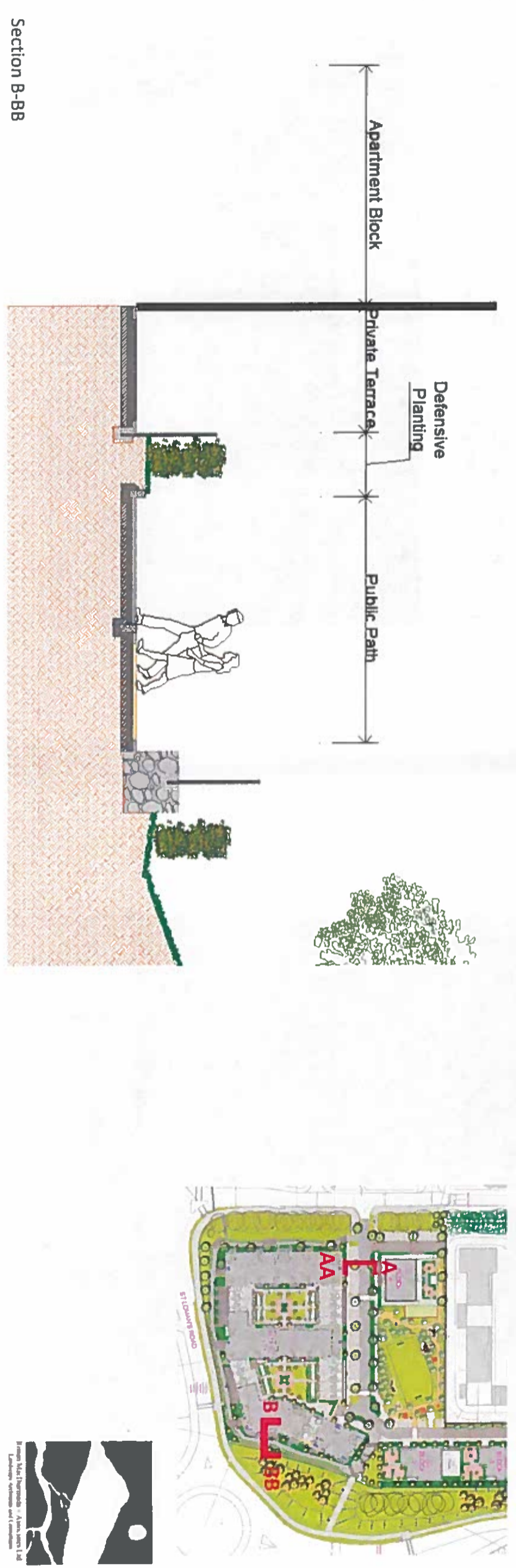
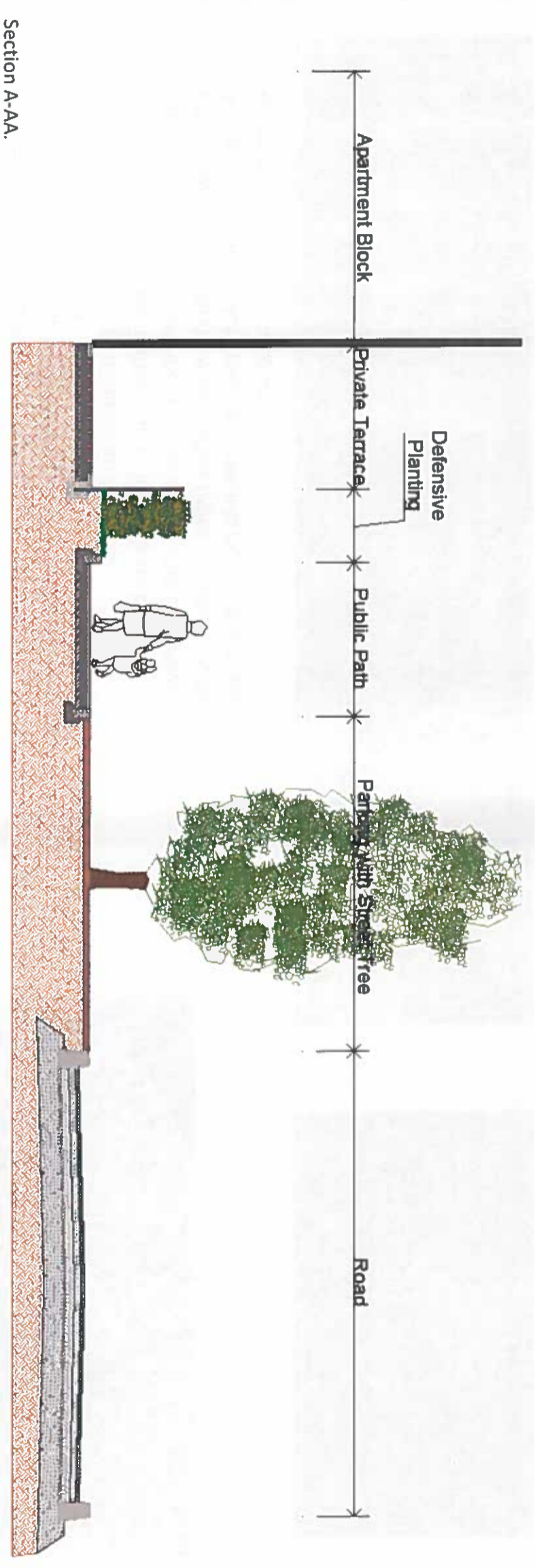

St. Edmunds Sedum Roof



- The root system: Sedum has very shallow roots, a key requirement for an extensive green roof, considering the modest depth of the substrate layer.
- Sedum is also drought-resistant
- Sedum needs relatively little nutrients and maintenance compared to other types of plant
- Sedum is very resilient to diseases and insects
- Sedum is also very adaptable: due to its capacity to adapt its metabolic system in periods of drought, it is able to survive in extremely dry conditions where other types of plants would die. And furthermore, Sedum recovers remarkably quickly as soon as water becomes available again.

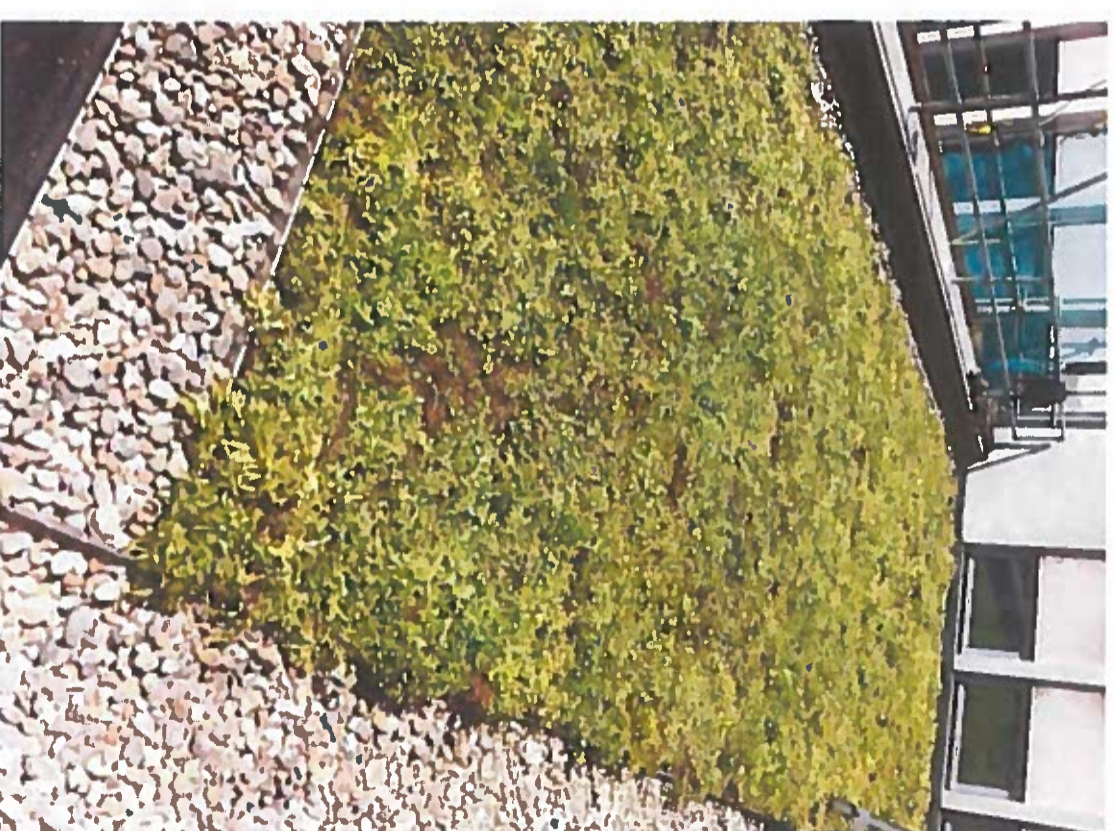

St. Edmunds Sedum Roof

- **Drainage:** Vegetative roof drainage design must both maintain optimum growing conditions in the growth medium and manage heavy rainfall without sustaining damage due to erosion or ponding of water.
- **Plant nourishment and support:** The engineered medium must be carefully designed to provide for excellent plant growth, no wind scouring, and proper water holding capacity.
- **Protection of underlying waterproofing systems:** Vegetative roof assemblies must protect the underlying waterproofing system from human activities (including the impact of maintenance) and biological attack, and solar degradation. A capillary break immediately above the membrane is required for most membranes.
- **Waterproofing systems:** Waterproofing is critical for protecting the structure from water intrusion.
- **Insulation systems:** Insulation is critical for saving energy.



Extensive Vegetation (Sedums, etc.)
 Growing Media
 Filter Fabric
 Moisture Retention / Drainage Panel
 Insulation
 Root Barrier
 Protection Course and Capillary Break
 Waterproofing Membrane (not rubberized asphalt depicted)
 Substrate (concrete deck depicted)



Extensive Vegetation (Sedums, etc.)
 Growing Media
 Filter Fabric
 Moisture Retention / Drainage Panel
 Insulation
 Root Barrier
 Protection Course and Capillary Break
 Waterproofing Membrane (not rubberized asphalt depicted)
 Substrate (metal deck with gypsum board depicted)

St. Edmunds Raised Planter Detail

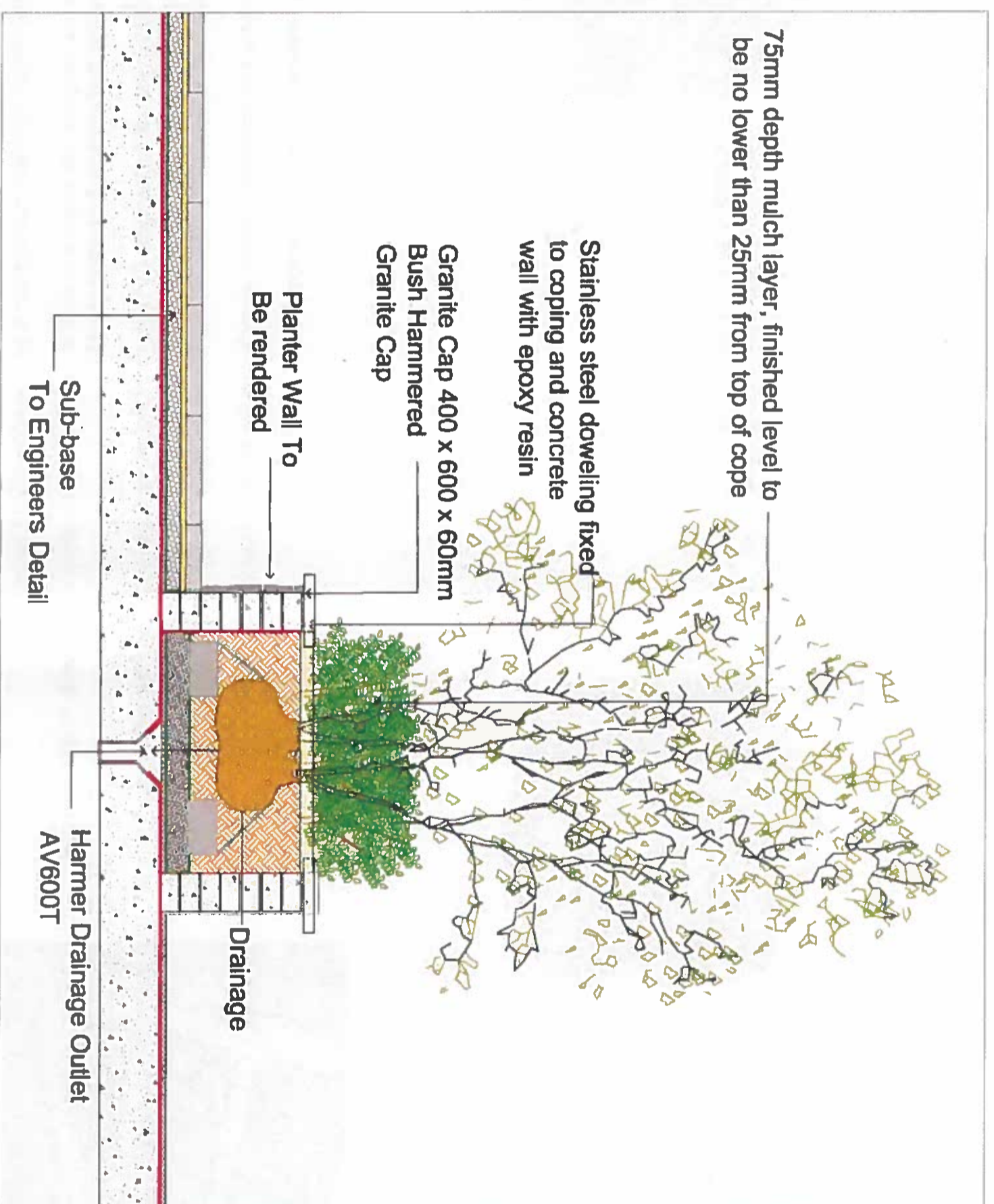

St. Edmunds

Swale and drop kerb locations

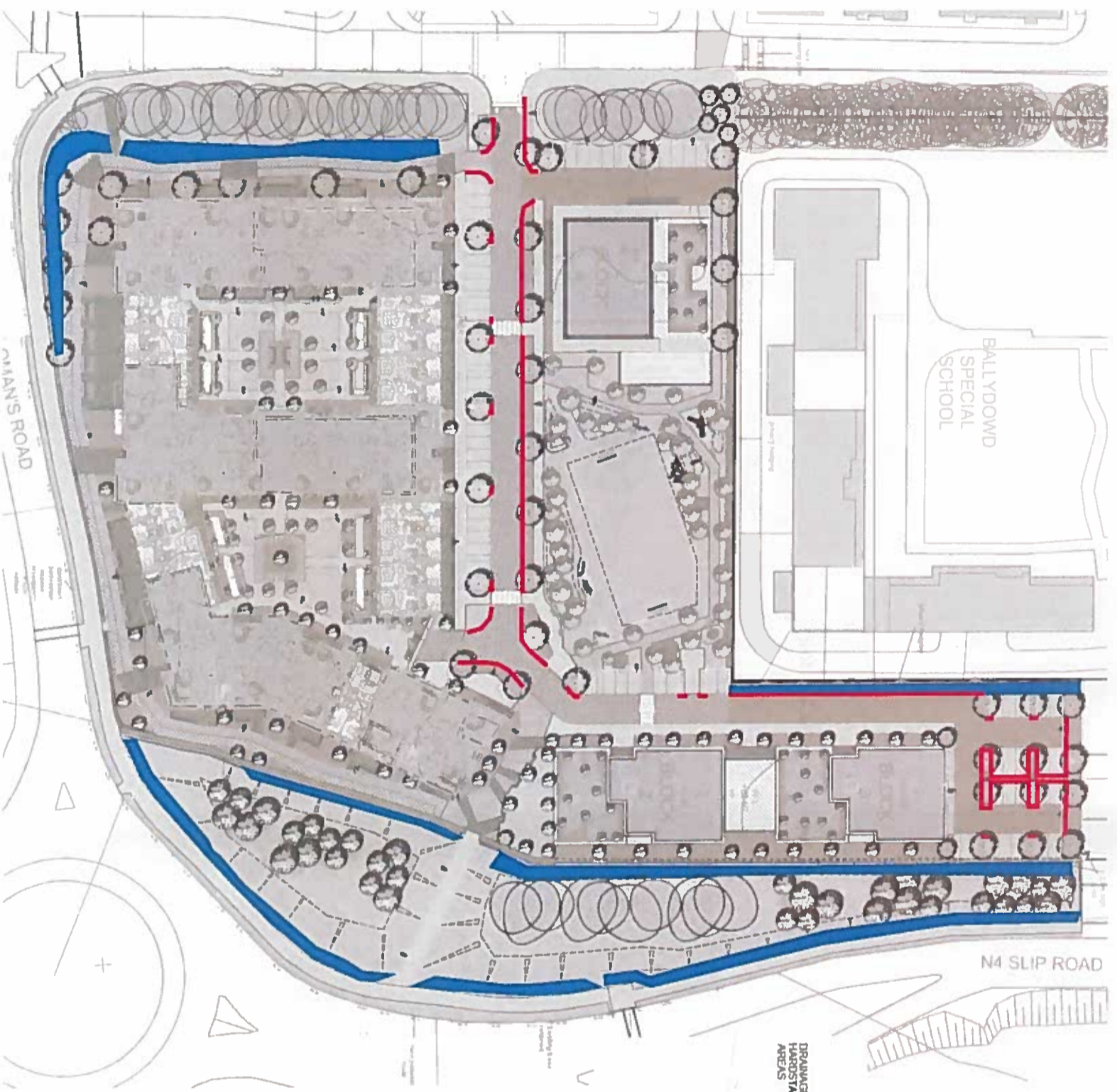

- █ Swale Locations
- █ Drop Kerb Locations

Bio-retention Detail to Drop Kerb Locations. See engineer Dwgs. and report for more details

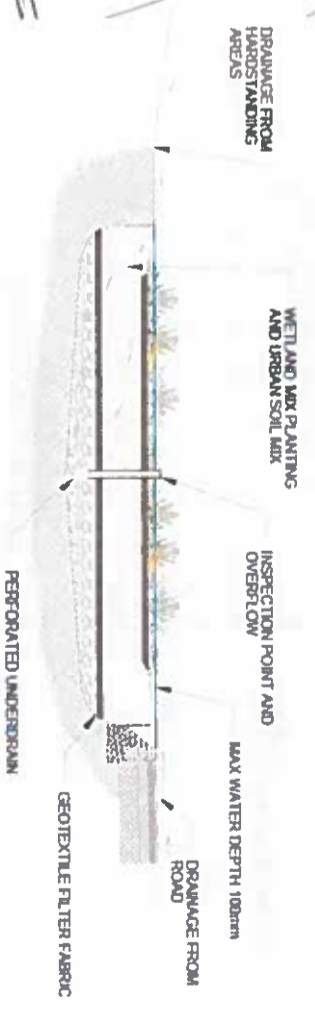

St. Edmunds

Example of Swale Details

Section E-EE - Open Space Scale (1:100)

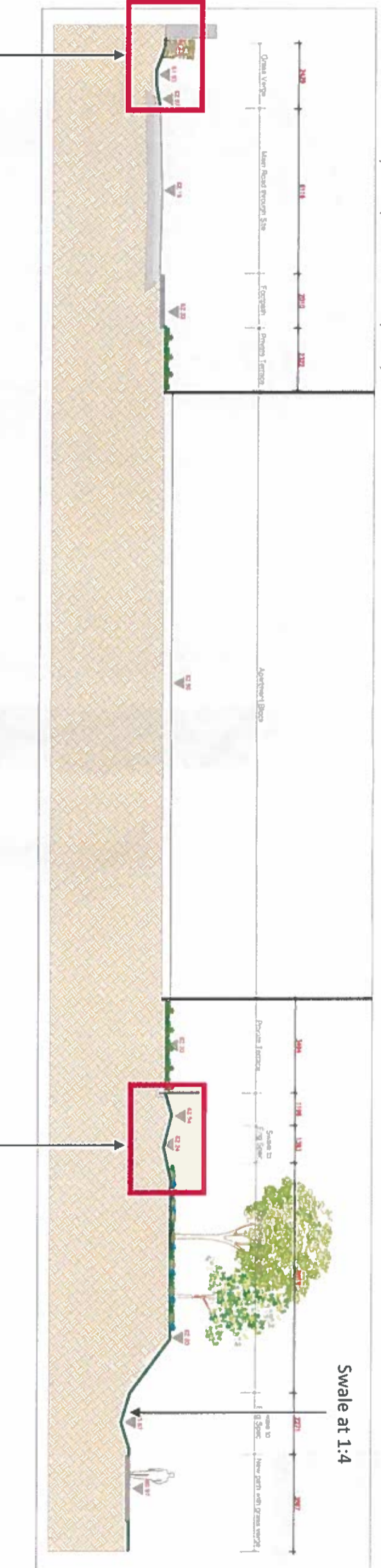

Swale at 1:4

Swale to Roadside, Drop Kerb. Please see Engineer drawings and report for more detail

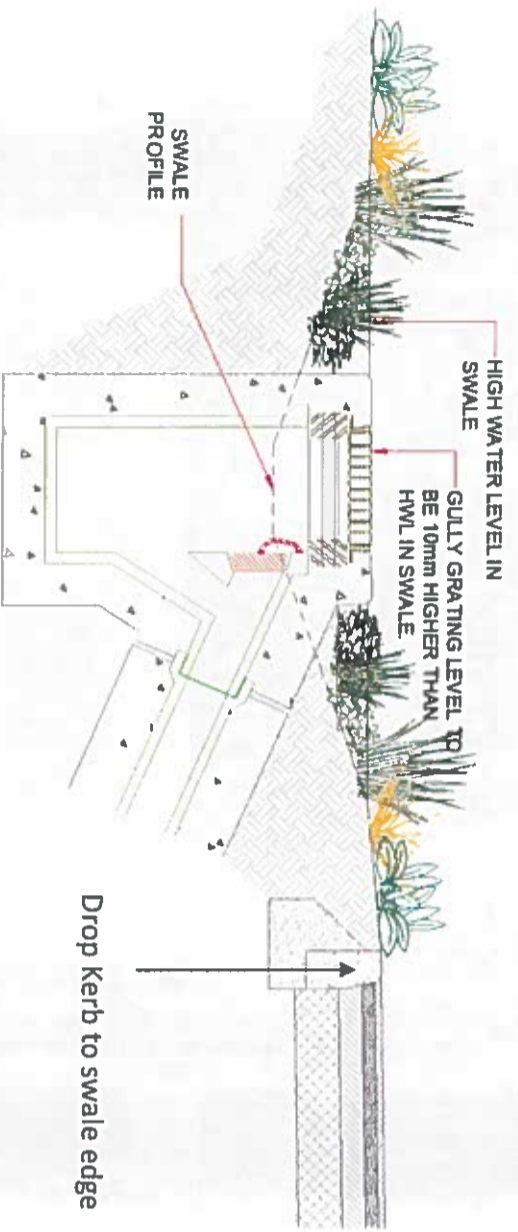

Swale to Open Space. Please see Engineer drawings and report for more detail

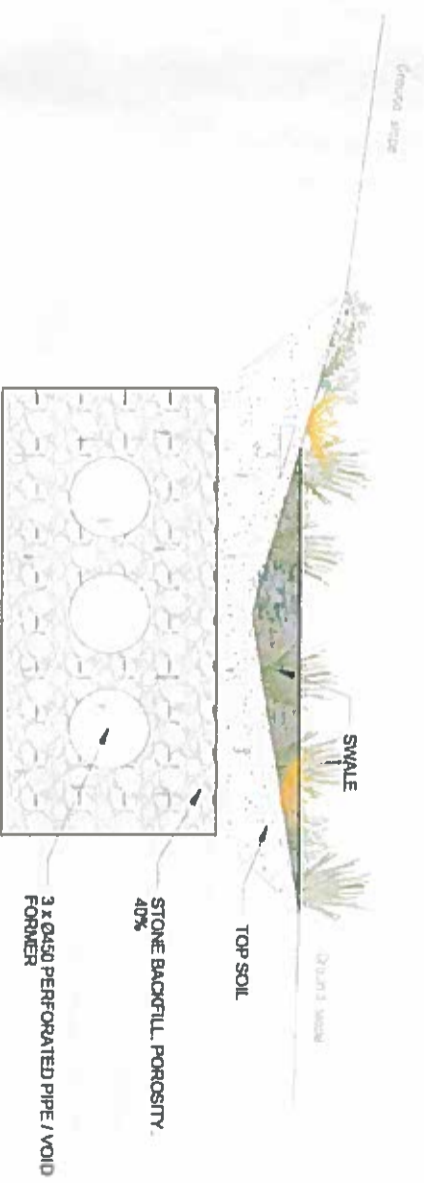

St. Edmunds

Drop Kerb Water Flow Example

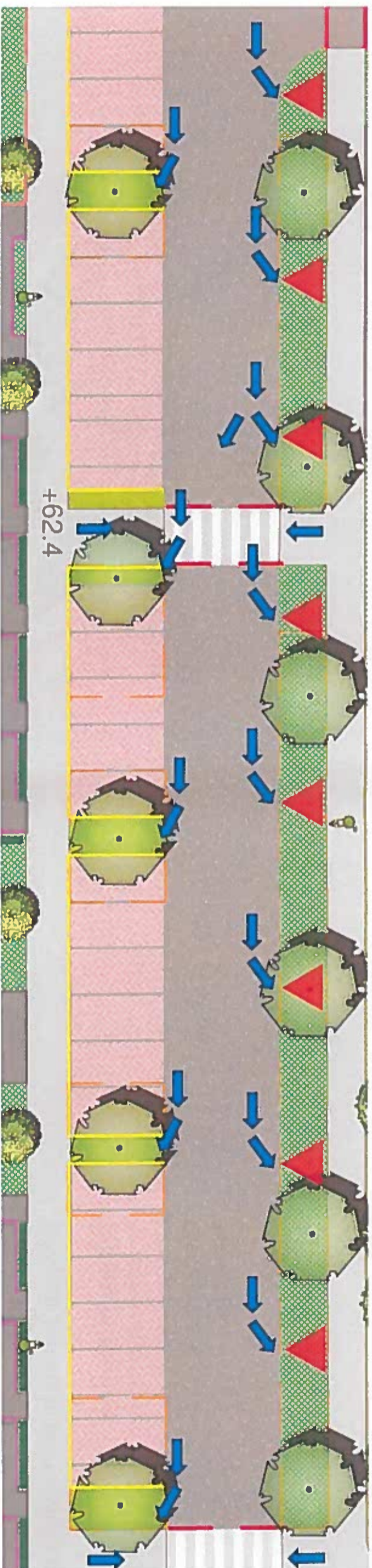

▼ **Drop Kerb Location**

→ **Surface Water Flow**

Please see Engineer Dwgs. for more details on drop kerb locations and swales

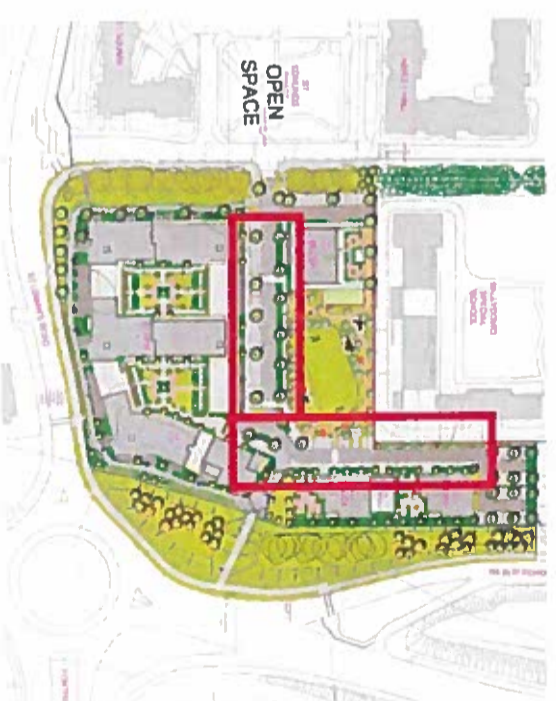

Location Plan



St. Edmunds Tree Pit Detail

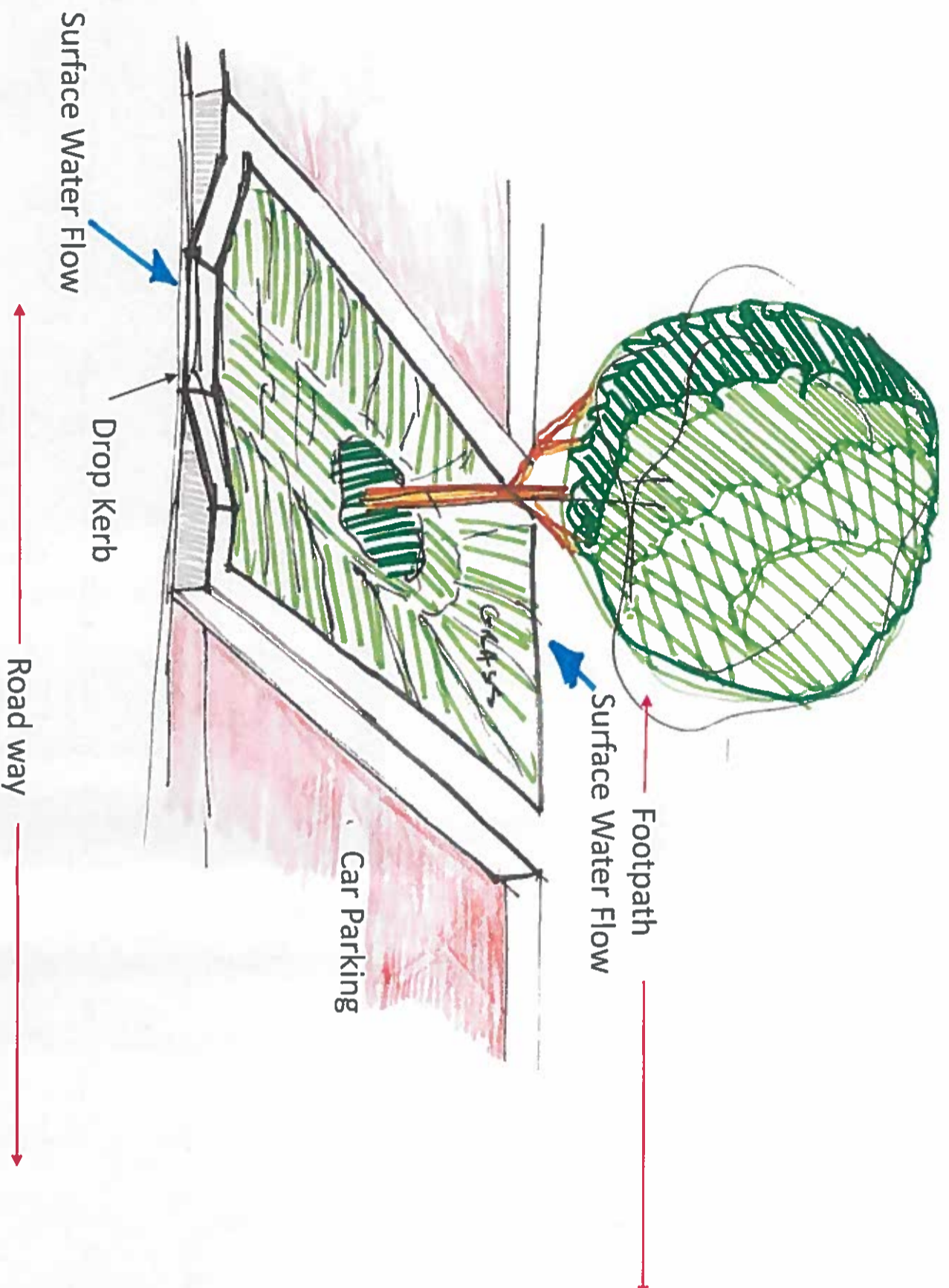

Groundcover
 Persicaria affine
 Hedera helix 'Hibernica'
 Vinca minor
 Bergenia spp.

Perennials
 Ligularia przewalskii 'The Rocket'
 Astilbe spp. (Snowdrift, Hyacinth)
 Iris siberica
 Iris pseudoacorus
 Achillea millefolium 'Song Siren Laura'
 Helleborus foetidus
 Salvia spp (variety to be chosen for wet)

Bulb/Corm/Rhizome
 Aquilegia canadensis
 Kniphofia uvaria
 Crocosmia spp
 Allium spp

Grass:
 Carex pendula

Fern
 Dryopteris felix-mas
 Dryopteris dilatata



Brian MacDonagh & Associates Ltd
 Landscape Architects and Gardeners

St. Edmunds

Drop Kerb Detail

Plan View of Tree Pit

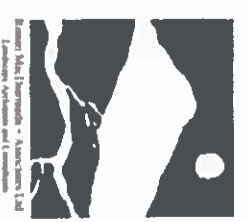
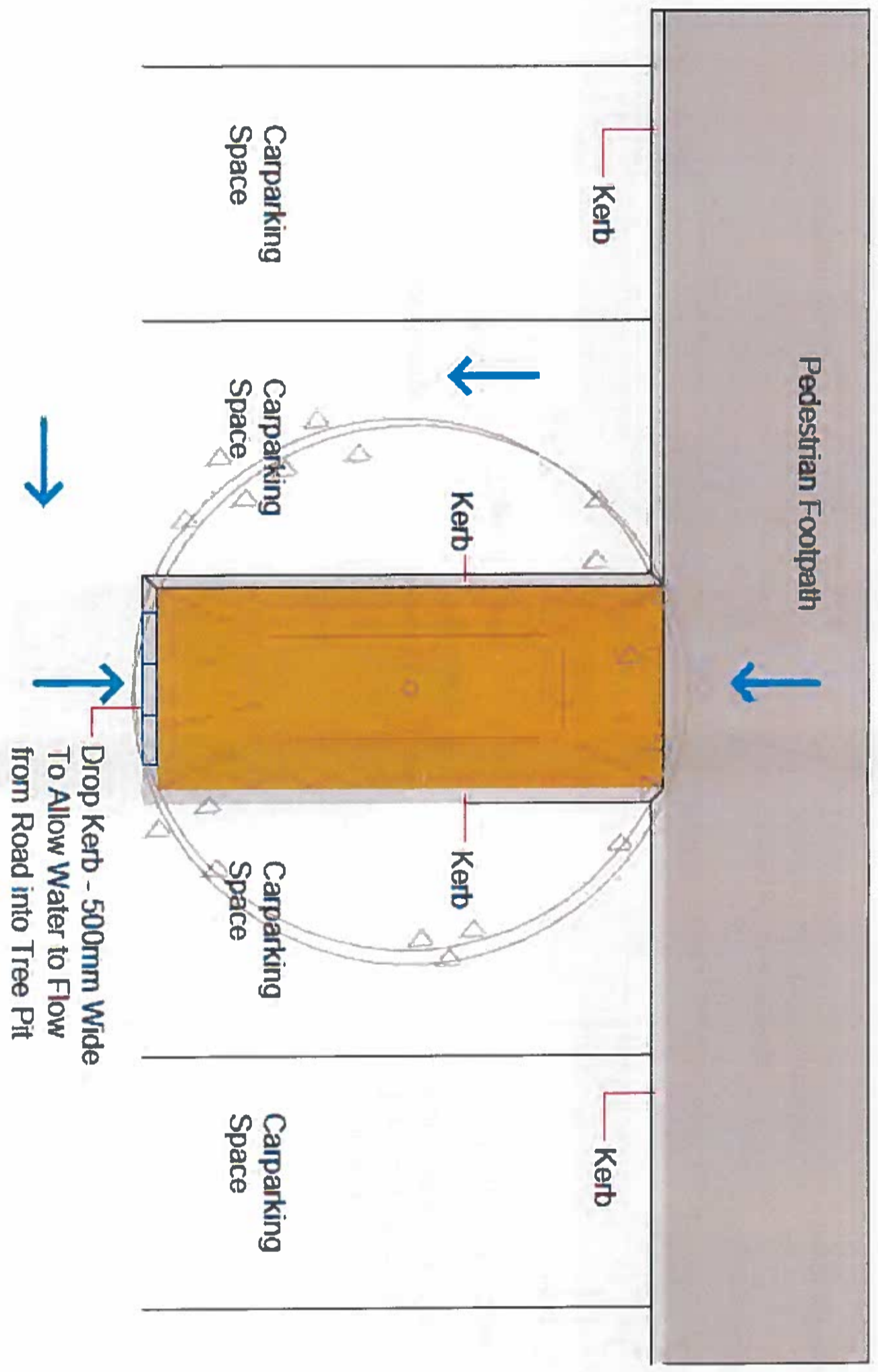

St. Edmunds Drop Kerb Detail

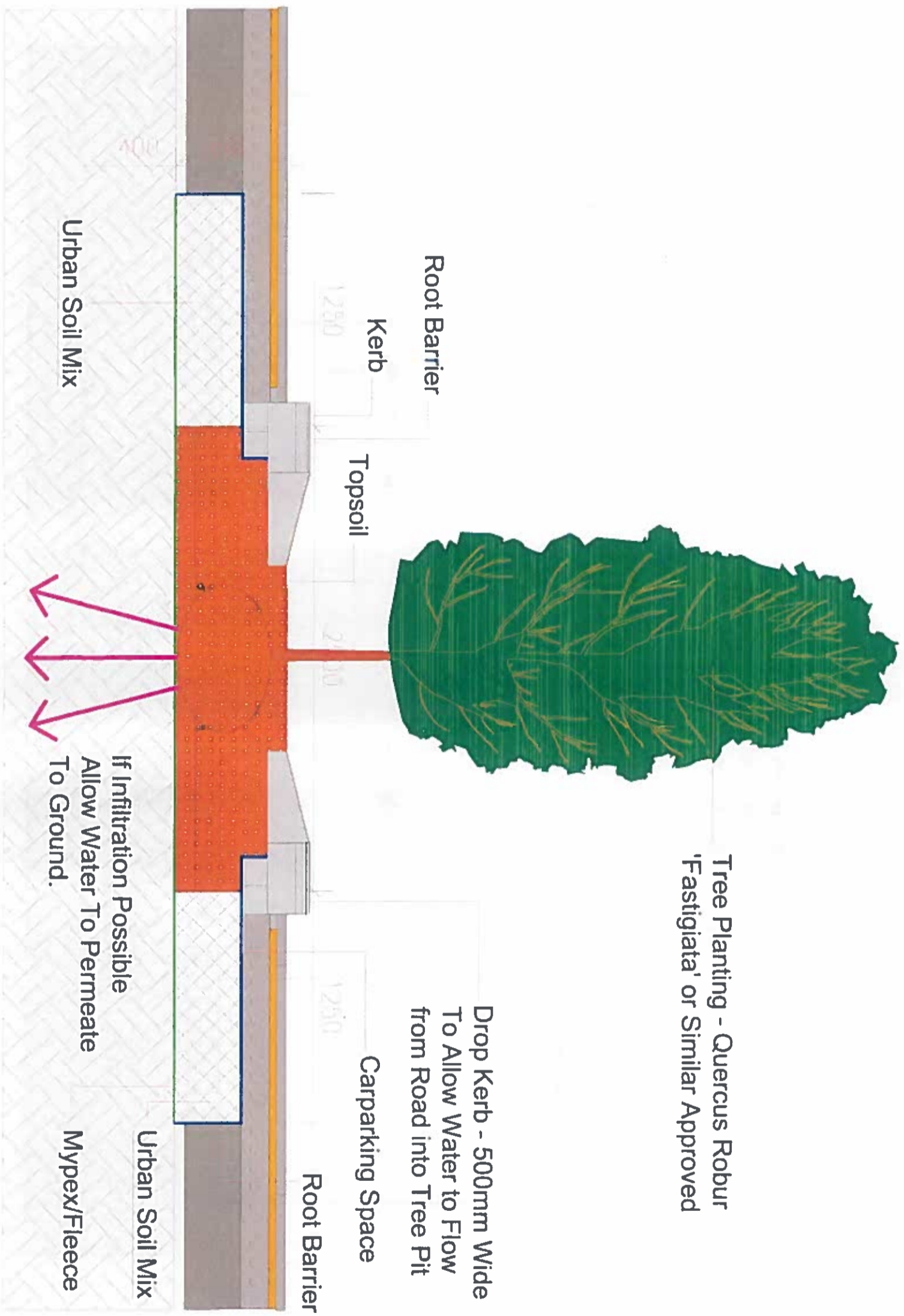

St. Edmunds

Suggested Surface Treatments

(or similar approved)



Charcoal paving



Tarmac with colour chip



Heather paving



Natural Grey paving



Beige Tarmac



Rustic paving

Resin Bonded (Scattercoat) Pedestrian Path Detail

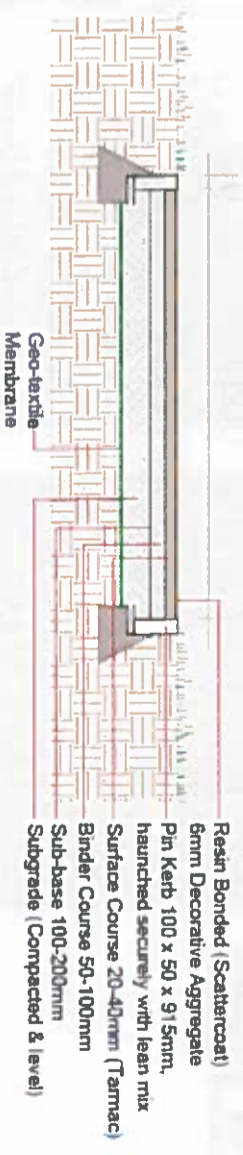

N.B. Resin Bonded Surfacing is weather dependant. The traditional laying season is typically April to September to avoid cold wet weather and dew in the air. Ground temperature must be >10°C, as the resin is sensitive to moisture before curing.



Resin Bonded (Scattercoat)
6mm Decorative Aggregate
Pin Kerb 100 x 50 x 91.5mm,
haunched securely with lean mix



Resin Mastic Systems - Aquatec Ltd
Landscape Contractors and Suppliers

St. Edmunds

Suggested Planting

Proposed Tree Planting

- No. Name.**
1. Betula pendula
 2. Laurus nobilis - Cone Shaped
 3. Carpinus betulus 'Fastigiata'
 4. Acer campestre 'Elsrijk'
 5. Fagus sylvatica
 6. Rhus typhinia
 7. Fagus sylvatica 'Dawyck'
 8. Larix decidua
 9. Betula pendula 'Multi-stem'
 10. Acer palmatum
 11. Amelanchier lamarckii
 12. Tilia cordata 'Greenspire'
 13. Quercus robur
 14. Pinus sylvestris
 15. Quercus robur 'Fastigiata'
 16. Malus 'John Downie'
 17. Arbutus unedo
 18. Viburnum opulus

Proposed Hedge Planting

- No. Name.**
1. Prunus lusitanica (Single Row)
 2. Elaeagnus ebbingei (Single Row)
 3. Native Hedgerow (Double Row)
 - 50% Craetagus monogyna
 - 35% Prunus spinosa
 - 5% Ilex aquifolium
 - 5% Rosa canina
 - 5% Lonicera periclymenum
 - 'Graham Thomas'



Carpinus betulus 'Fastigiata'



Laurus nobilis



Betula pendula - multi-stem



Quercus robur 'Fastigiata'



Malus 'John Downie'



Betula pendula



Elaeagnus x ebbingei



Prunus lusitanica



Amelanchier lamarckii

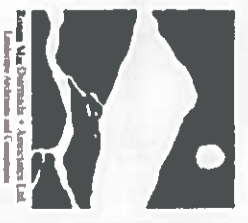

Kingside Management & Horticulture Ltd
Landscape Architects and Gardeners

St. Edmunds

Suggested Planting

Proposed Groundcover & Shrub Planting

- | No. | Name |
|-----|---------------------------|
| 1. | Persicaria affine |
| 2. | Hedera helix hibernica |
| 3. | Lavandula angustifolia |
| 4. | Prunus 'Otto Luyken' |
| 5. | Libertia grandiflora |
| 6. | Crocosmia citronella |
| 7. | Rhododendron yakushimanum |
| 8. | Sedum spectabile |
| 9. | Skimmia japonica |
| 10. | Miscanthus sinensis |
| 11. | Crocosmia lucifer |
| 12. | Phyllostachys aurea |
| 13. | Fragaria ananassa |
| 14. | Hemerocallis 'Tejas' |
| 15. | Astelia 'Silver Spear' |
| 16. | Vinca minor |
| 17. | Agapanthus blue storm |
| 18. | Perovskia atriplicifolia |
| 19. | Bergenia cordifolia |
| 20. | Helleborus niger |

Proposed Bulb Planting

- | No. | Name |
|-----|---------------------|
| 1. | Crocus sativus |
| 2. | Galanthus nivalis |
| 3. | Muscari armeniacum |
| 4. | Colchicum autumnale |
| 5. | Narcissus jonquilla |



Libertia grandiflora



Bergenia cordifolia



Sedum spectabile



Perovskia atriplicifolia



Vinca minor



Astelia 'Silver Spear'



Hedera helix hibernica

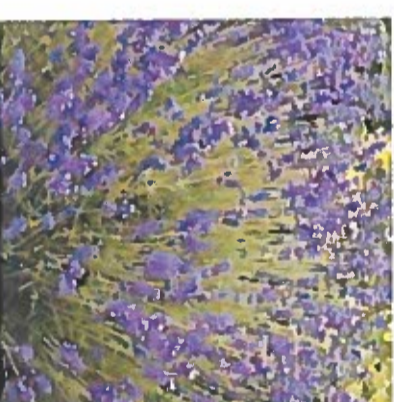

Lavandula angustifolia



Miscanthus sinensis



Crocus sativus



Galanthus nivalis



Muscari armeniacum



Broomfield Nurseries - Auctivity Ltd
Landscape Architects and Gardeners

