

C13

DATE: 11 May 2022  
D/T No: Graham Sheehan  
PROJECT NAME: SES 17821 Rev D  
St Edmund's Moykerr Limited



Designed in accordance with ISEN13201-2:2015 Class P4 for public roads. P5 for private courtyards.  
Rev A: Latest site layout used.  
Rev B: Latest site layout used.  
Rev C: Some column positions revised and bollards added to private courtyards.  
Rev D: Courtyard bollards relocated.

## Outdoor Lighting Report

PREPARED BY: Sabre Electrical Services Ltd.  
Unit 11 Bellevue Ind. Est.  
Finglas  
Dublin 11.  
Email: graham@sabrelighting.ie  
Ph: 01 8110875

## Layout Report

### General Data

Dimensions in Metres Angles in Degrees

### Calculation Grids

ID	Grid Name	X	Y	X' Length	Y' Length	X' Spacing	Y' Spacing
1	Grid 1	595.00	578.00	201.00	225.00	1.50	1.50
2	Grid 2	635.00	612.00	80.00	55.00	1.00	1.00

### Luminaires

#### Luminaire A Data



Supplier	C U Phosco
Type	P852-12-F3-WW-CA0700-27W
Lamp(s)	730C WW
Lamp Flux (klm)	3.02
File Name	P852-12-F3-WW-CA0700-27W.ies
Maintenance Factor	0.83
Imax70,80,90(cd/klm)	693.4, 572.2, 102.0
No. in Project	6

#### Luminaire B Data



Supplier	C U Phosco
Type	P852-12-F2-WW-CA0700-27W
Lamp(s)	730C WW
Lamp Flux (klm)	3.08
File Name	P852-12-F2-WW-CA0700-27W.ies
Maintenance Factor	0.83
Imax70,80,90(cd/klm)	750.5, 280.0, 34.0
No. in Project	8

#### Luminaire C Data



Supplier	C U Phosco
Type	P852-12-R3B-WW-CA0200-8W
Lamp(s)	730C WW
Lamp Flux (klm)	1.04
File Name	P852-12-R3B-WW-CA0200-8W.ies
Maintenance Factor	0.83
Imax70,80,90(cd/klm)	876.7, 56.5, 1.7
No. in Project	14

#### Luminaire D Data



Supplier	Urban Schreder
Type	PHAROS 5118 Cylindrical, PC, Smooth Asy mmetrical, Clear prote
Lamp(s)	8 XP-G3 350mA WW 730 230V
LampFlux(klm)/Colour	0.87 WW 3000K/70
File Name	PHAROS 5118 8 XP-G3 350mA WW 730 1 1W 448242 Cylindrical, PC, Smooth Clear
Maintenance Factor	0.83
Imax70,80,90(cd/klm)	484.6, 794.8, 24.9
No. in Project	18

### Layout

ID	Type	X	Y	Height	Angle	Tilt	Cant	Out- reach	Dimmed to	Target X	Target Y	Target Z
1	B	608.26	691.46	6.00	272.00	0.00	0.00	0.40	100%			
2	B	636.80	672.60	6.00	92.00	0.00	0.00	0.40	100%			
3	B	665.14	687.80	6.00	272.00	0.00	0.00	0.40	100%			
4	B	689.57	669.21	6.00	87.00	0.00	0.00	0.40	100%			
5	B	717.95	674.64	6.00	157.00	0.00	0.00	0.40	100%			
6	A	717.57	695.78	6.00	357.00	0.00	0.00	0.40	100%			
7	A	724.86	734.98	6.00	0.00	0.00	0.00	0.40	100%			
8	A	726.75	764.40	6.00	359.00	0.00	0.00	0.40	100%			
9	B	736.70	785.95	6.00	268.00	0.00	0.00	0.40	100%			

**Layout Continued**

ID	Type	X	Y	Height	Angle	Tilt	Cant	Out-reach	Dimmed to	Target X	Target Y	Target Z
10	B	753.58	784.70	6.00	272.00	0.00	0.00	0.40	100%			
11	B	745.54	762.86	6.00	90.00	0.00	0.00	0.40	100%			
12	C	733.55	676.15	6.00	62.00	0.00	0.00	0.40	100%			
13	C	769.95	655.29	6.00	62.00	0.00	0.00	0.40	100%			
14	C	753.82	664.18	6.00	58.00	0.00	0.00	0.40	100%			
16	C	615.84	659.99	6.00	357.00	0.00	0.00	0.40	100%			
17	C	613.40	638.78	6.00	356.00	0.00	0.00	0.40	100%			
18	C	611.98	612.99	6.00	350.00	0.00	0.00	0.40	100%			
19	A	615.49	721.21	6.00	358.00	0.00	0.00	0.40	100%			
20	A	613.95	700.40	6.00	357.00	0.00	0.00	0.40	100%			
21	C	665.74	700.65	6.00	158.00	0.00	0.00	0.40	100%			
22	C	627.59	596.44	6.00	82.00	0.00	0.00	0.40	100%			
23	C	659.81	594.59	6.00	98.00	0.00	0.00	0.40	100%			
24	C	686.88	598.37	6.00	100.00	0.00	0.00	0.40	100%			
25	C	712.22	600.49	6.00	104.00	0.00	0.00	0.40	100%			
26	C	726.51	616.95	6.00	167.00	0.00	0.00	0.40	100%			
27	C	734.16	636.82	6.00	162.00	0.00	0.00	0.40	100%			
28	C	741.85	656.43	6.00	161.00	0.00	0.00	0.40	100%			
29	A	719.05	718.73	6.00	359.00	0.00	0.00	0.40	100%			
30	D	659.58	646.90	1.00	357.00	0.00	0.00	0.00	50%			
30	D	658.88	637.91	1.00	354.00	0.00	0.00	0.00	50%			
32	D	650.11	627.08	1.00	263.00	0.00	0.00	0.00	50%			
33	D	643.90	647.84	1.00	178.00	0.00	0.00	0.00	50%			
34	D	643.68	638.78	1.00	177.00	0.00	0.00	0.00	50%			
35	D	642.76	627.86	1.00	174.00	0.00	0.00	0.00	50%			
36	D	686.61	636.35	1.00	267.00	0.00	0.00	0.00	50%			
37	D	684.86	646.33	1.00	183.00	0.00	0.00	0.00	50%			
38	D	704.68	645.73	1.00	329.00	0.00	0.00	0.00	50%			
39	D	683.30	628.86	1.00	181.00	0.00	0.00	0.00	50%			
40	D	700.79	628.89	1.00	177.00	0.00	0.00	0.00	50%			
41	D	711.24	654.08	1.00	158.00	0.00	0.00	0.00	50%			
41	D	688.76	629.01	1.00	1.00	0.00	0.00	0.00	50%			
42	D	701.23	639.00	1.00	329.00	0.00	0.00	0.00	50%			
43	D	651.34	649.01	1.00	77.00	0.00	0.00	0.00	50%			
44	D	683.85	639.86	1.00	329.00	0.00	0.00	0.00	50%			
45	D	691.76	643.96	1.00	355.00	0.00	0.00	0.00	50%			

DATE: 11 May 2022

DESIGNER: Graham Sheehan

PROJECT No: SES 17821 Rev D PROJECT NAME: St Edmund's Moykerr Limited



**Layout Continued**

ID	Type	X	Y	Height	Angle	Tilt	Cant	Out-reach	Dimmed to	Target X	Target Y	Target Z
46	D	696.95	633.58	1.00	88.00	0.00	0.00	0.00	50%			
47	D	658.22	628.99	1.00	354.00	0.00	0.00	0.00	50%			

## Horizontal Illuminance (lux)

Grid 1



### Results

Eav	5.10
Emin	1.23
E <sub>max</sub>	13.36
E <sub>min</sub> /E <sub>max</sub>	0.09
E <sub>min</sub> /E <sub>av</sub>	0.24

# Horizontal Illuminance (lux)

Grid 1



## Results

Eav	5.10
Emin	1.23
E <sub>max</sub>	13.36
E <sub>min</sub> /E <sub>max</sub>	0.09
E <sub>min</sub> /E <sub>av</sub>	0.24

## Horizontal Illuminance (lux)

Grid 2



### Results

Eav	7.81
Emin	1.56
E <sub>max</sub>	30.50
E <sub>min</sub> /E <sub>max</sub>	0.05
E <sub>min</sub> /E <sub>av</sub>	0.20

## Horizontal Illuminance (lux)

Grid 2

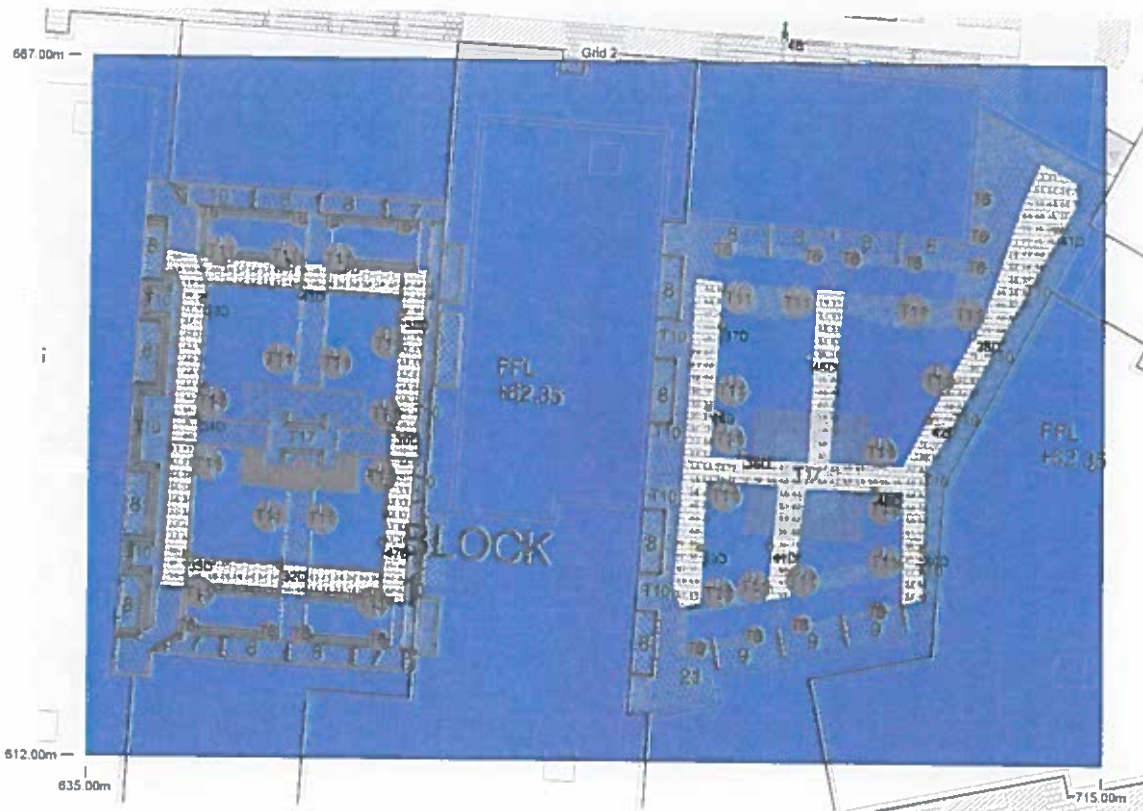

### Results

Eav	7.81
Emin	1.56
Emax	30.50
Emin/Emax	0.05
Emin/Eav	0.20