

NOTE  
 ALL DIMENSIONS TO BE CHECKED ON SITE  
 NO DIMENSIONS TO BE SCALED FROM THIS DRAWING  
 THIS DRAWING IS TO BE READ IN CONJUNCTION WITH  
 RELEVANT CONSULTANT'S DRAWINGS  
 NO PART OF THIS DOCUMENT MAY BE REPRODUCED OR  
 TRANSMITTED IN ANY FORM OR STORED IN ANY RETRIEVAL  
 SYSTEM OF ANY NATURE WITHOUT THE WRITTEN PERMISSION  
 OF THE LANDSCAPE ARCHITECT AS COPYRIGHT HOLDER EXCEPT  
 AS AGREED FOR USE ON THE PROJECT FOR WHICH THE  
 DOCUMENT WAS ORIGINALLY ISSUED  
 FOR DRAWING INDEX, GENERAL NOTES, REFER TO  
 DWG L1-001

CLIENT:  
**ADAMSTOWN STATION AND BOULEVARD LTD.**

ARCHITECTS:  
**MDO ARCHITECTS**

**LEGEND**

	SITE BOUNDARY		AREA SUBJECT OF FUTURE OUTLINE PERMISSION
	P1 - PUBLIC REALM FOOTPATH - BITU CONCRETE		LAWN PLANTING
	P2 - CYCLE PLATH - COLOURED TARMAC		SHRUB PLANTING
	P3 - STREET PARKING BLOCK PAVING		SHRUB PLANTING
	P4 - OFF-STREET PARKING - BLOCK PAVING WITH CHARCOAL TRIM		WILDFLOWER PLANTING
	P5 - PRIVATE AMENITY SPACE - BLOCK PAVING		EMERGENT AQUATIC PLANTING
	P6 - PRIVATE AMENITY SPACE - FLAG PAVING		SHALLOW POOL / CHANNEL
	P7 - PARK PAVING - EXPOSED AGGREGATE BITU CONCRETE		MEADOWY GRASS
	P8 - PARK PAVING - SELF BINDING GRAVEL		SWALE
	P9 - SOFT POUR PAVING		NATURAL PLAY
	P10 - HOME ZONE - BUFF COLOURED HIGH FRICTION PAVING		BENCH
	P11 - ROAD - ASPHALT		NATURAL PLAY LOGS
	PRECAST CONCRETE BRIDGE WITH PAVING		STEPPING STONES
	PROPOSED BUS STOP		ROCKERS
	PROPOSED TREE		LIGHT POLE
	EXISTING TREE TO BE RETAINED		

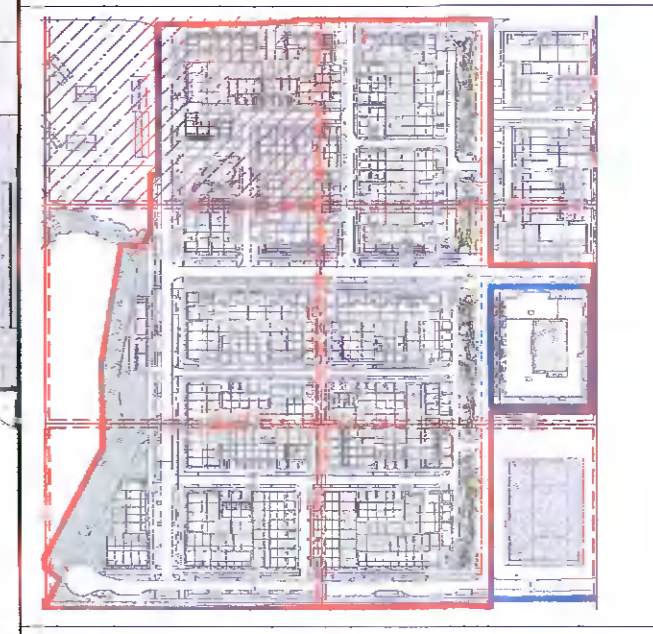

**REVISIONS**

Job No.	23A2A	Drawn By	KFR
Dwg No.	L1-100-1	Checked By	JM
Scale	As indicated @A1	Date	APRIL 2022

**JOB DESCRIPTION**

Site	ADAMSTOWN BOULEVARD
Project	ADAMSTOWN BOULEVARD PHASE 1
Title	GENERAL ARRANGEMENT PLAN - SHEET 1 OF 6

**NMP**  
 Niall Montgomery & Partners  
 Architects 33 Rock Road, Willemstown, Blackrock, Co Dublin  
 Telephones: 2121 800 Fax: 2121 007 Email: info@nmp.ie

