

⊕ Proposed Ground Floor Plan
Floor Area 123m sq.

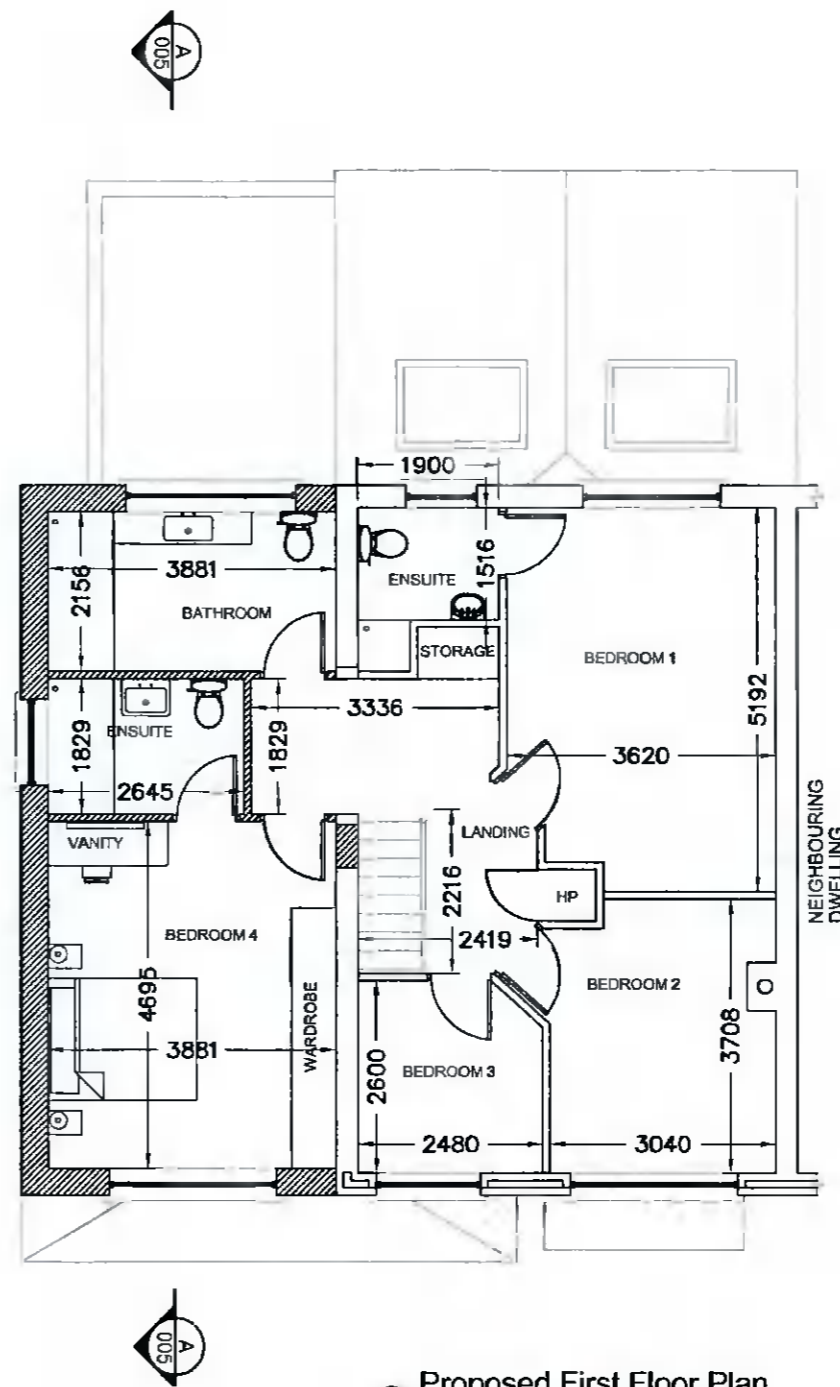

⊕ Proposed First Floor Plan
Floor Area 79m sq.

P	ISSUED FOR PLANNING	TW	APR' 2022
REV:	REVISION TITLE:	DRN:	CHD: DATE:

Architectural Planning
4 CARRIGMORE CLOSE, AYLESBURY,
Dublin 24 - Ph: 01 4148358

CLIENT: **NEIL & CIARA REID**
JOB TITLE: **PROPOSED WORKS AT 1 WOODSTOWN
RISE, KNOCKLYON, DUBLIN 16**

TITLE: **PROPOSED FLOOR PLANS**
SCALE: 1:100
INITIALS: TW
DATE: APR' 2022
JOB No: S401
DRAWING No: 002
REV: P

THIS DRAWING IS ISSUED FOR PLANNING PERMISSION ONLY, AND IS NOT A CONSTRUCTION DRAWING

NOTES:
This drawing is to be read in conjunction with all relevant Engineers drawings.
Do not scale use figured dimensions ONLY.
All dimensions in millimeters unless otherwise stated.
All dimensions to be checked on site.
All building works to comply with current building regulations & in accordance with Homebond Standards.