

Existing First Floor Plan

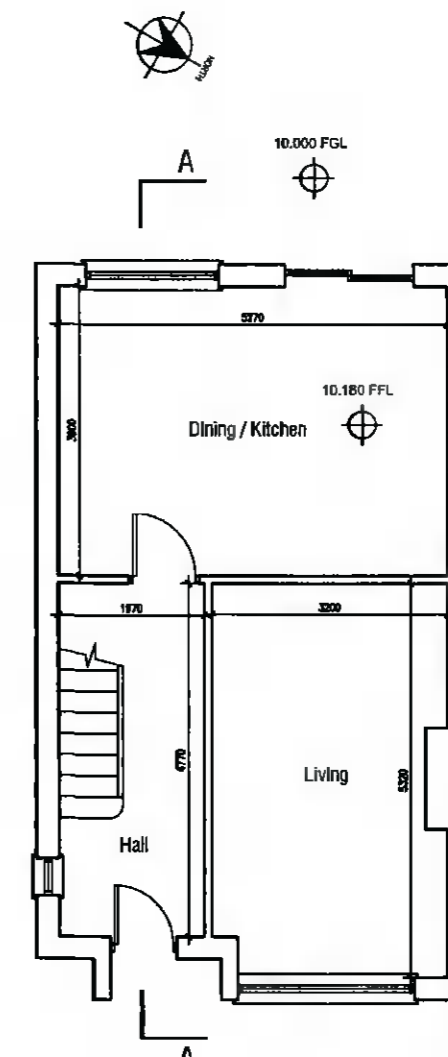

Existing Ground Floor Plan

10.000 FGL

description EXISTING FLOOR PLANS	job Proposed alterations to 20 Grangebrook Avenue Rathfarnham Dublin 16	scale 1:100	client Ronny and Dominika Tjahjadi	1 Do not scale this drawing. 2 Errors and omissions to be immediately notified to Architect. 3 All dimensions to be checked on site. 4 Drawing for Planning Permission purposes only.	revisions date info
	drawing no. 2022-P-100	date 25.04.22	issue Planning		
	revn.	drawn MOC			
		checked			

Michael O'Connor
 18 Lissadel Wood,
 Swords Road,
 Malahide,
 Co. Dublin.
 087-7577664