

ARBORICULTURAL ASSESSMENT

51 GRANGE PARK
RATHFARNHAM
DUBLIN 14

Project No.	Date	Revision
TGRA003	13/04/22	-

Report Prepared by

Ciaran Keating
BSc Pl. Sci. & Ecol
H.N.D. Hort
AA Tech Cert Arb, PG Dip. Arb & Urban Forestry

E-mail: cmkhortandarb@gmail.com
Mobile: 087 1182343,
Drumone, Oldcastle, Co. Meath

CONTENTS

1. Client brief and Methodology	2
2. General description of trees	2
3. Impact of the proposed development.....	3

Appendix i VEGETATION DESCRIPTION

Supporting drawings:

TGRA002 101 Tree Survey & Constraints
TGRA002 102 Arboricultural Impact

1. Client brief & Methodology

CMK Hort + Arb Ltd. were commissioned by Magahy Broderick Associates to undertake an assessment of trees and woody vegetation at 51 Grange Park Rathfarnham. The site is located at the intersection of Whitechurch Road and St Patricks Cottages, Rathfarnham, Dublin (image 1). It is proposed to develop the site and build four new homes. The site was assessed on the 27th of March 2022.

The survey methodology, supporting drawings and documentation follow the recommendations contained within BS 5837 (2012). The analysis of the trees was undertaken using the VTA methodology as developed by Mattheck and Breloer (1994).



Image 1. Site location

2. General description of trees

The site is bordered by a 22m long *Griselinia* (*Griselinia littoralis*) hedge on the boundary with St. Patrick's Cottages and Leyland cypress (*xCuprocyparis leylandii*) along the boundary with Whitechurch Road. There are no internal trees or shrubs.

The *griselinia* hedge has, in the main, been well maintained (image 2) whereas the Leyland cypress hedge has not been managed appropriately in recent times and is overgrown and now reaching tree-like proportions (image 3). The original planting of the cypress was at 1m spacings. Time and a lack of appropriate management inputs has reduced the quality of many of the cypress with dominant specimens shading out the less dominant.

The locations of the trees and hedge are shown on drawing TGRA003 101 Tree Survey & Constraints.



Image 2. View of *Griselinia* hedge from St Patrick's Cottages



Image 3. View of Leyland cypress from Whitechurch Road

3. Impact of the proposed development

The proposed development of the site which is shown on drawing TGRA003 102 Arb

Impact will require all of the existing Leyland cypress and griselinia to be removed.

The Leyland cypress are considered to be incompatible with the proposed development in terms of their location but also their height and spread which would create extensive shading of properties. In general terms it is also considered that this cultivar is unsuitable for most urban environments for these reasons and also because it provides very limited ecological benefits.

The griselinia hedge will be required to be removed to facilitate the new entrances. It is proposed to plant new hedging in the spaces available between entrances.

The overall loss of vegetation from the site is not considered significant and can be more than adequately mitigated by new tree and shrub planting.

Appendix i VEGETATION DESCRIPTION

Species	Age class	Description	Category	Length m Height m Width m	Long-term potential yrs
Leyland cypress xCuprocyparis leylandii	Mature	An overgrown, unmanaged hedge of approximately 15m length. Dominant specimens out competing smaller trees.	C2	15.5 17 5	5-10
Griselinia Griselinia littoralis	Mature	Mostly well developed with no visible defects. A section of the hedge to west has become overgrown and unmanaged	B2	22 3 1.5	10-15



LEGEND

ARBORICULTURAL IMPACT

- A TREES OF HIGH VALUE AND QUALITY
- B TREES OF MODERATE VALUE AND QUALITY
- C TREES OF LOW QUALITY AND VALUE
- D TREES OF VERY LOW QUALITY AND VALUE RECOMMENDED FOR REMOVAL

ART BOUNDARY

DRAWING TO BE INTERPRETED WITH REFERENCE TO THE ARBORICULTURAL ASSESSMENT & IMPACT REPORT

REVISIONS





NO.	DATE	DESCRIPTION

PROJECT	51 GRANDE PARK, BAYVIEW, DUBLIN 14	JOB NO.	T0914023
DRAWING	TREE SURVEY AND CONSTRUCTION	DATE	15/04/22
DRAWN BY	CHERRY GARDNER	SCALE	1:200 @ A2
STATUS	DRAWING	FOR	INITIALS
DRAWING NO.	1/21	REVISION	

NOTES:
1. This drawing is a site plan and should be read in conjunction with the Arboricultural Assessment & Impact Report.
2. The drawing is the property of CMK Horticulture & Arboriculture Ltd.

CMK
Horticulture & Arboriculture

LEGEND
ARBORCULTURAL IMPACT

-  TREES TO BE RETAINED
-  TREES TO BE REMOVED TO FACILITATE DEVELOPMENT
-  TREES OF VERY LOW QUALITY AND VALUE RECOMMENDED FOR REMOVAL
-  SITE BOUNDARY

DRAWING TO BE INTERPRETED WITH REFERENCE TO THE ARBORCULTURAL ASSESSMENT & IMPACT REPORT

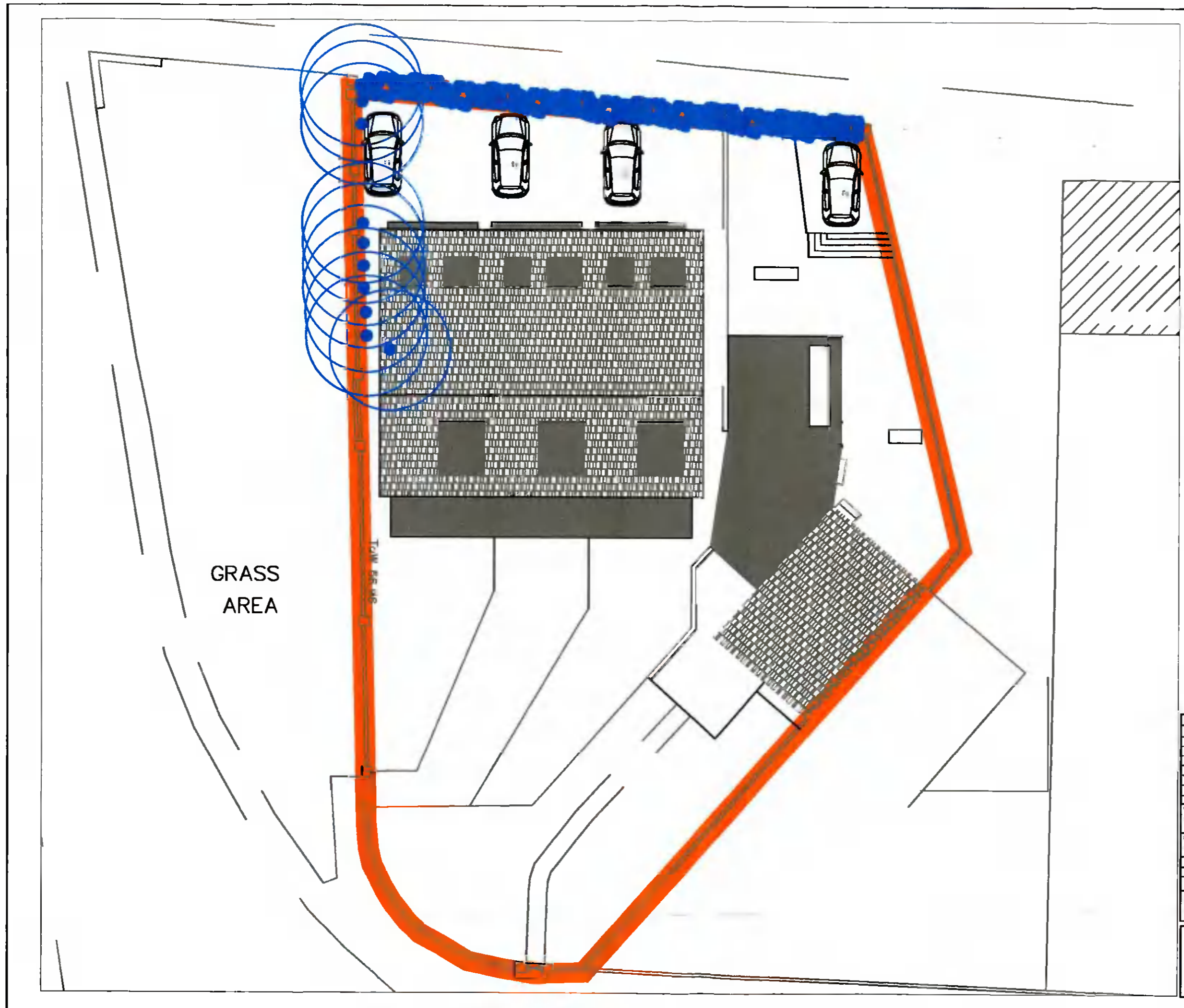

REVISIONS

NO.	DATE	DESCRIPTION

PROJECT: 1 SANDS PARK RATHFARNHAM DUBLIN 14 DRAWING NO: 1/10002

DRAWING: TREE SURVEY AND CONSTRAINTS DATE: 22/05/2018 SCALE: 1:100 @ A2

DRAWN BY: GINA FEENEY CA: CA

STATUS: PLANNING REVISION: 1

NOTES:
 1. This drawing is for planning purposes only.
 2. All dimensions are approximate and subject to site survey.
 3. © CMK Horticulture & Arboriculture 2018. All rights reserved.

