

DRG. No. P-S.A-7

SITE PLAN

SCALE 1" = 20'

Rev. 2/24/25

Lucan

LUCAN ROAD

R 835

Publin

Commercial Footpath

Site No. 819



SD 17A/0208

SD 14A/0276

Roos Lodge

Extension outlined blue

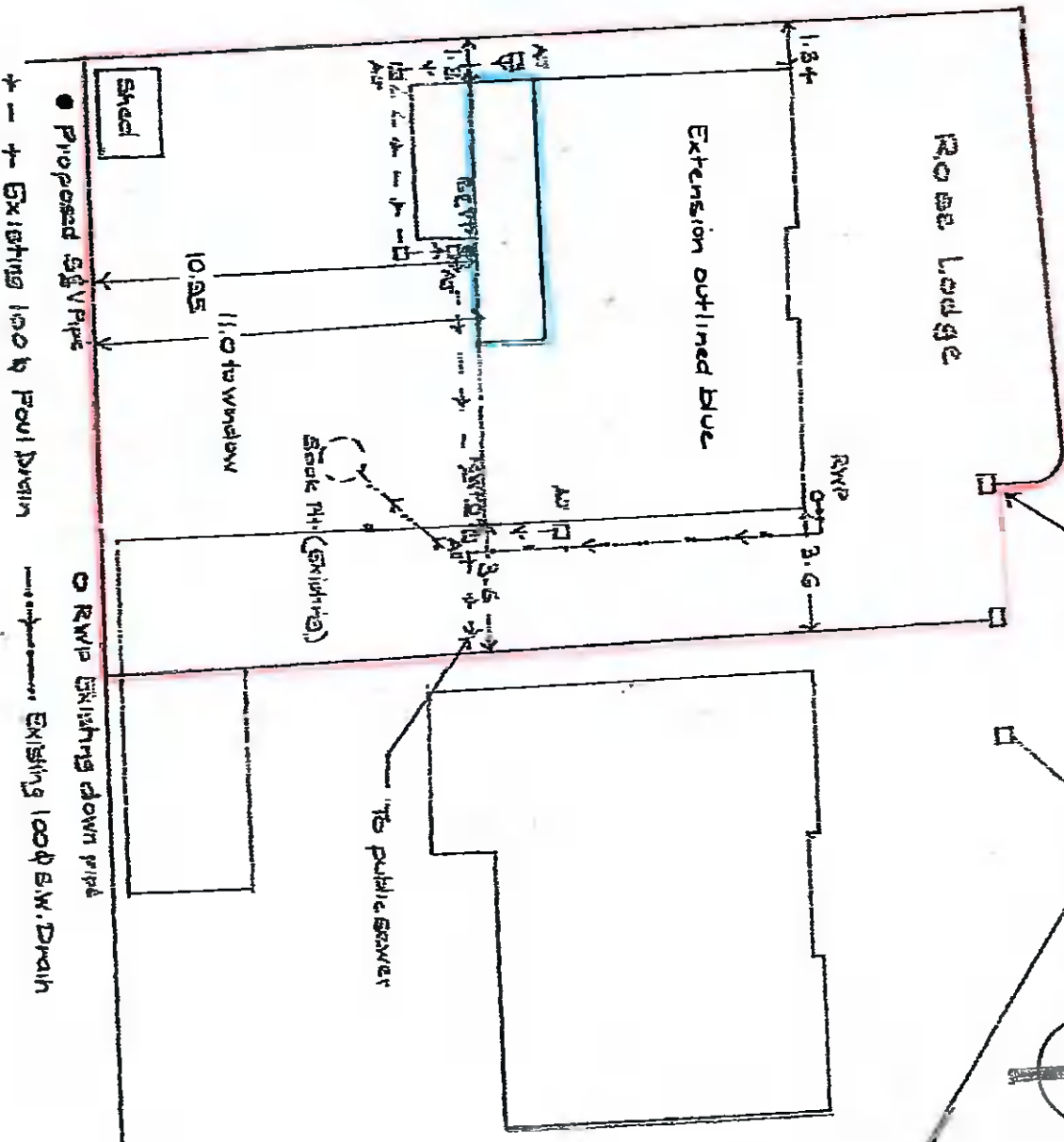

Shed

Proposed 8" V Pipe

Existing 100' Poul Drain

RWIP Existing down pipe

Existing 100' S.W. Drain

Stoole Pit (Existing)

To public sewer

Extension Main & Salsb Al Salsb