

NOTES

SITE BOUNDARY
 ASSUMED AS PER PLANNING
 PERMISSION REF. SD19A0053

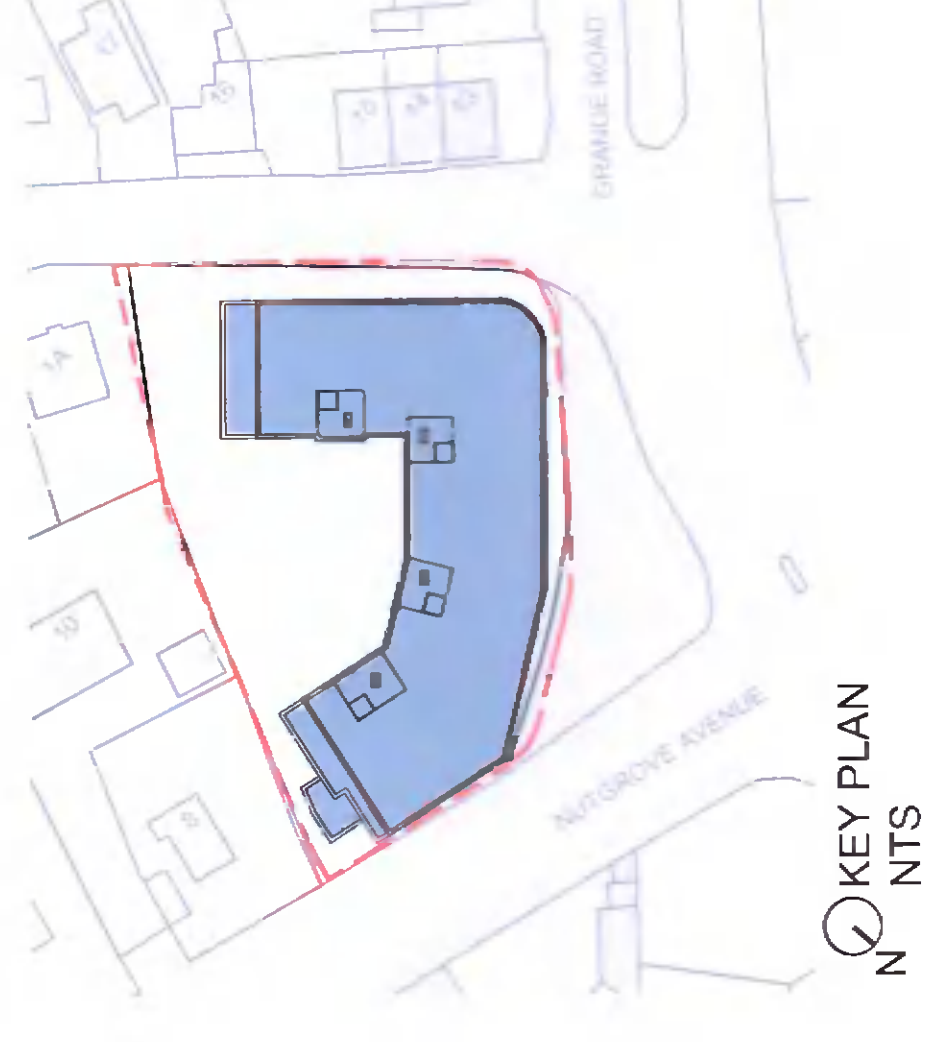

KEY PLAN
 N
 NTS

- LEGEND**
- 1 BED STUDIO UNIT
 - 1 BED / 2 PERSON UNIT
 - 2 BED / 3 PERSON UNIT
 - 2 BED / 4 PERSON UNIT

FIRST FLOOR PLAN

- APT. 15-18 2 SQ.M
- 2 BED (4 PERSON)
- APT. 14-16 3 SQ.M
- 2 BED (3 PERSON)
- APT. 15-18 3 SQ.M
- STUDIO (1 PERSON)
- APT. 17-19 2 SQ.M
- 2 BED (4 PERSON)
- APT. 15-18 2 SQ.M
- 1 BED (2 PERSON)
- APT. 14-16 3 SQ.M
- 2 BED (3 PERSON)
- APT. 17-19 2 SQ.M
- 2 BED (4 PERSON)
- APT. 15-18 2 SQ.M
- 1 BED (2 PERSON)
- APT. 14-16 3 SQ.M
- 2 BED (3 PERSON)
- APT. 17-19 2 SQ.M
- 2 BED (4 PERSON)

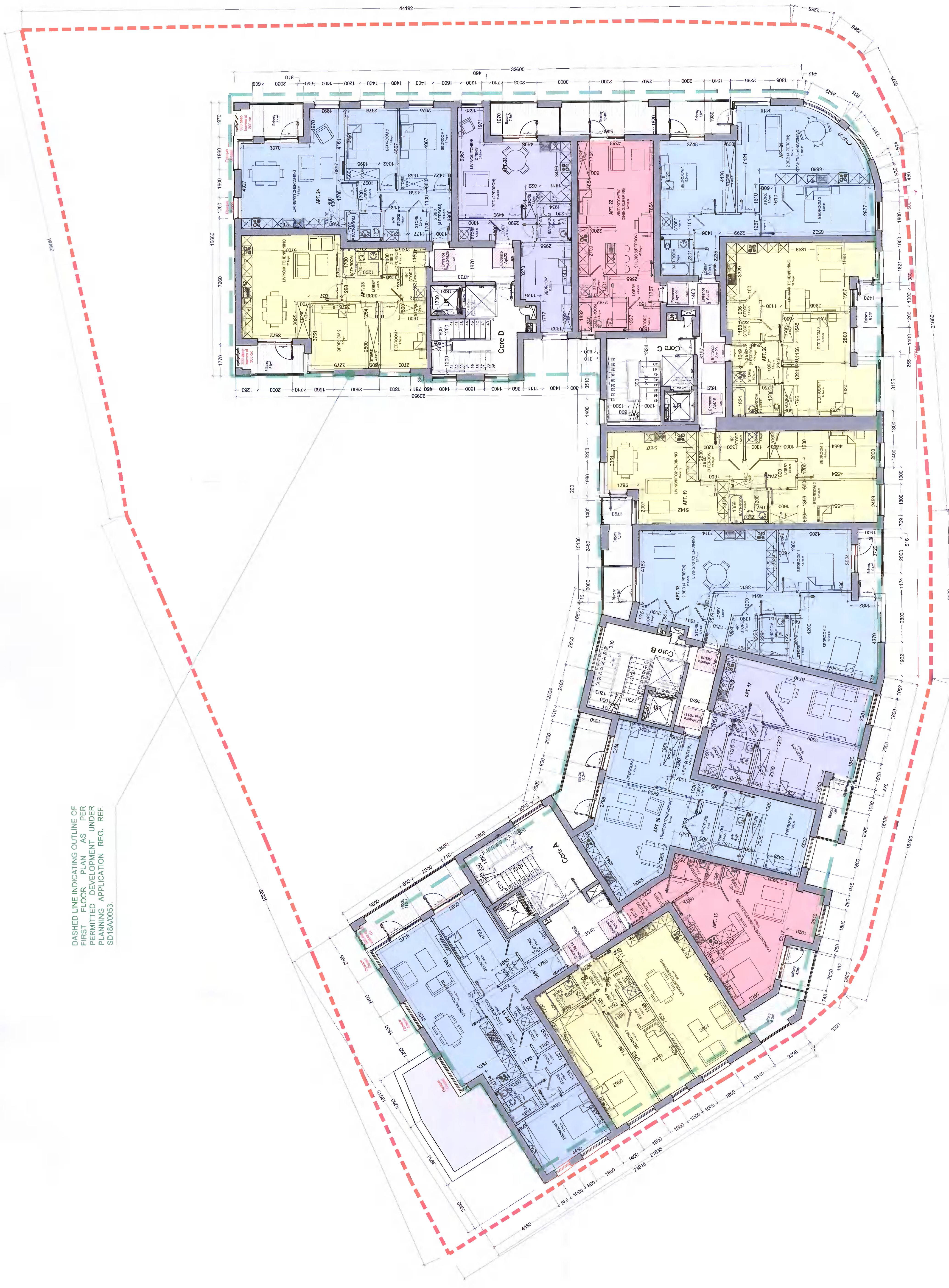

DASHED LINE INDICATING OUTLINE OF
 FIRST FLOOR DEVELOPMENT AS
 PERMITTED UNDER
 PLANNING APPLICATION REF. REF.
 SD19A0053

REV	DATE	DRN	NOTES

DO NOT SCALE FROM THIS DRAWING. USE DIMENSIONS IN ALL CASES.
 VERIFY DIMENSIONS TO BE SHOWN IN CONNECTION WITH THE ARCHITECT'S SPECIFICATION.
 THIS DRAWING IS COPYRIGHT AND CAN ONLY BE REPRODUCED WITH THE ARCHITECT'S PERMISSION.

CDP Architecture
 Dublin City Planning - Planning - Architecture - Project Management
 1, The Mall, Malton
 Luton, Bedfordshire, LU30 1JH
 T: 01525 44468
 E: info@cdparch.com
 W: www.cdparch.com

PLANNING

JOB	DATE
RESIDENTIAL DEVELOPMENT AT CRANGE ROAD, RATHFARNHAM, DUBLIN 14	APRIL 2022
CLIENT	DRN
FIRST STEP HOMES LTD	RA
DRAWING TITLE	SCALE
PROPOSED NEW FIRST FLOOR PLAN	1:100@A0
JOB NUMBER	DRAWING NUMBER
2020_134	3.1.107
REVISION	CHECKED
	PM

PROPOSED NEW FIRST FLOOR PLAN
 SCALE 1:100

