

**Proposed Site layout plan**

<b>Drawing:</b>	
<b>Project:</b>	We Alan & Carina Dillon intend to apply for full planning permission for 1: First floor & two storey extension to side 2: Removal of hip section of roof and building up gable wall to form a quarter hip 3: Conversion of attic to useable storage space placing 2 velux windows and a dormer window and solar panels in roof to rear , and 2 velux windows in roof to front 4: For a new single storey extension to rear 5: Window profile change to house 6: For a new single storey shed / home office extension to side of existing house at 29 Woodstown Lane , Dublin 16
<b>Prepared by:</b>	Bdcs Ltd , Lower Friarstown , Bohernabreena , Dublin 24 Ph : 087-2825396 Email : Michael.Finnar043@Gmail.com
<b>Date:</b>	21-4-2022
<b>Scale:</b>	1:125
<b>Drawing nr:</b>	5

Please Note : These drawings are for planning application purposes only and no works to commence until author is notified . Any site dimension discrepancy with drawings to be notified to author immediately . Any builder quoting for works must visit site , and establish exact nature of works prior to preparing works quote .

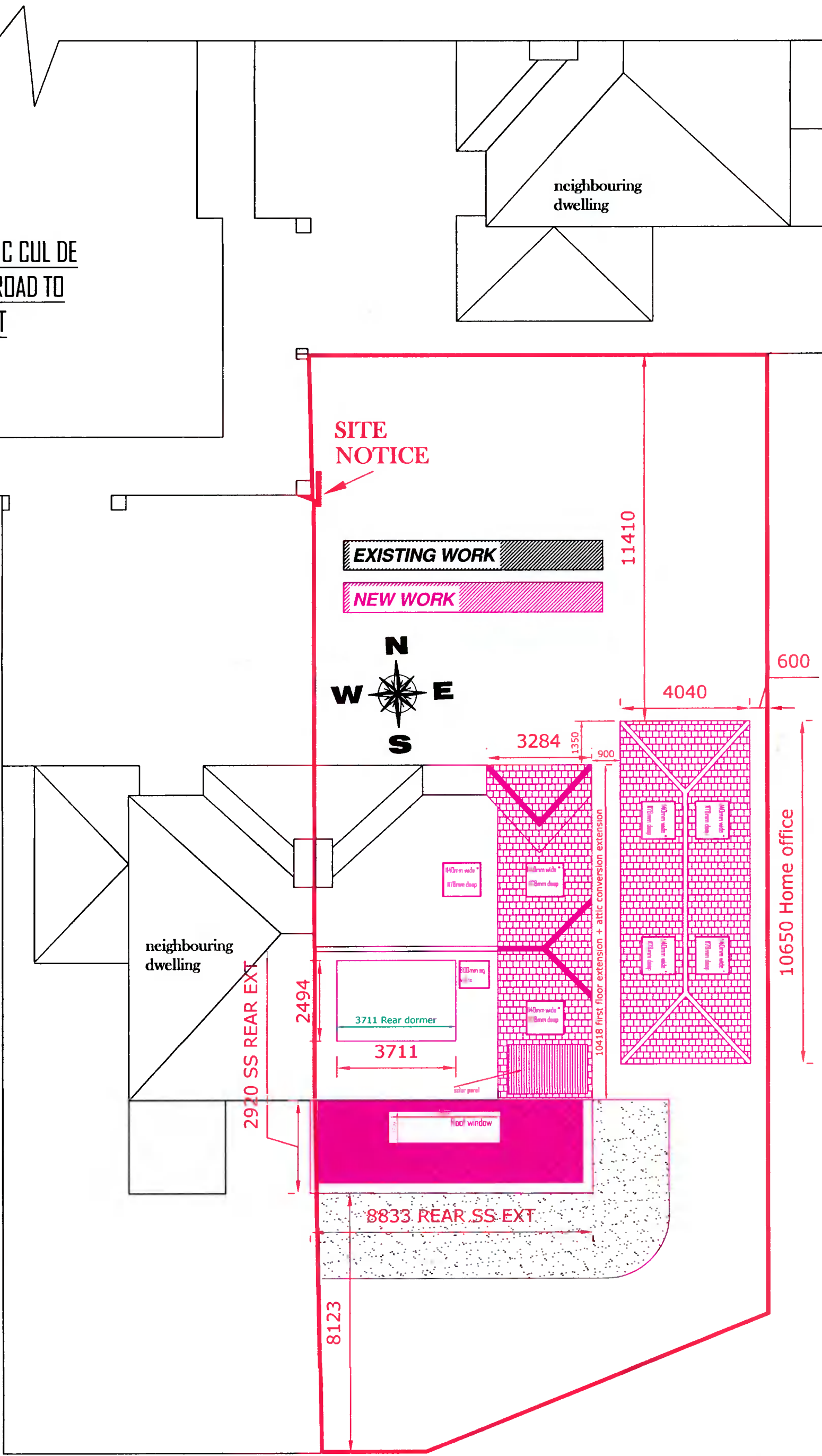

**Drawing : Proposed Site layout plan**