

<b>Drawing:</b>	Existing Site layout plan
<b>Project:</b>	We Alan & Carina Dillon intend to apply for full planning permission for 1: First floor & two storey extension to side 2: Removal of hip section of roof and building up gable wall to form a quarter hip 3: Conversion of attic to useable storage space placing 2 velux windows and a dormer window and solar panels in roof to rear, and 2 velux windows in roof to front 4: For a new single storey extension to rear 5: Window profile change to house 6: For a new single storey shed / home office extension to side of existing house at 29 Woodstown Lane, Dublin 16
<b>Prepared by:</b>	Bdcs Ltd, Lower Friarstown, Bohernabreena, Dublin 24 Ph: 087-2825396 Email: Michael.Finnan043@gmail.com
<b>Date:</b>	21-4-2022
<b>Scale:</b>	1:125
<b>Drawing nr:</b>	4
<p>Please Note : These drawings are for planning application purposes only and no works to commence until author is notified. Any site dimension discrepancy with drawings to be notified to author immediately. Any builder quoting for works must visit site, and establish exact nature of works prior to preparing works quote.</p>	

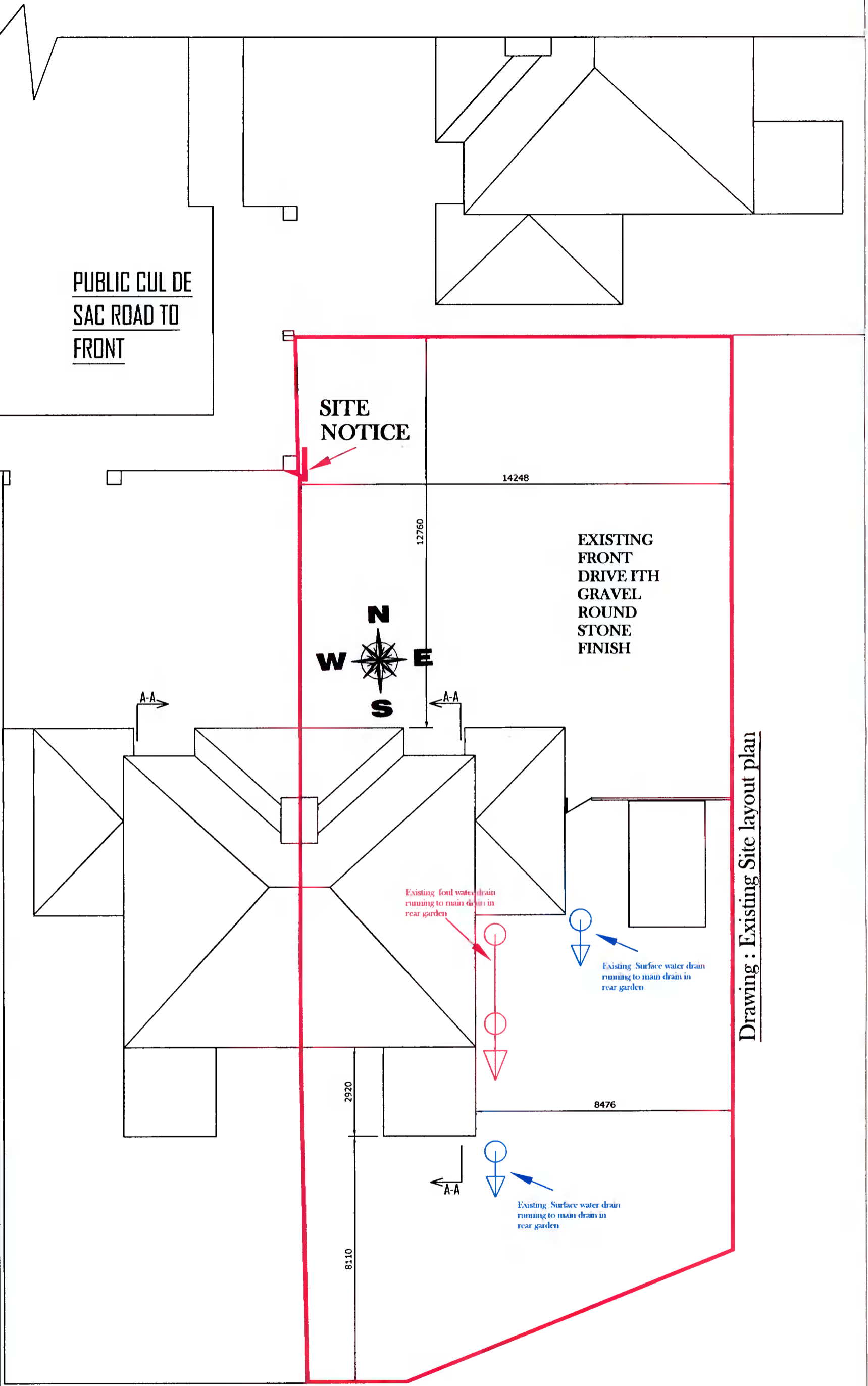

**SITE AREA : 461M2**  
**EXISTING DWELLING AREA : 120.5M2**  
**EXTENSION : 56M2**  
**ATTIC CONVERSION : 44M2**  
**NEW SHED/HOME OFFICE : 34M2**

**Drawing : Existing Site layout plan**