

HOUSE TYPE C / 3 BED / 5 p / 2 STOREY / SEMI-DETACHED

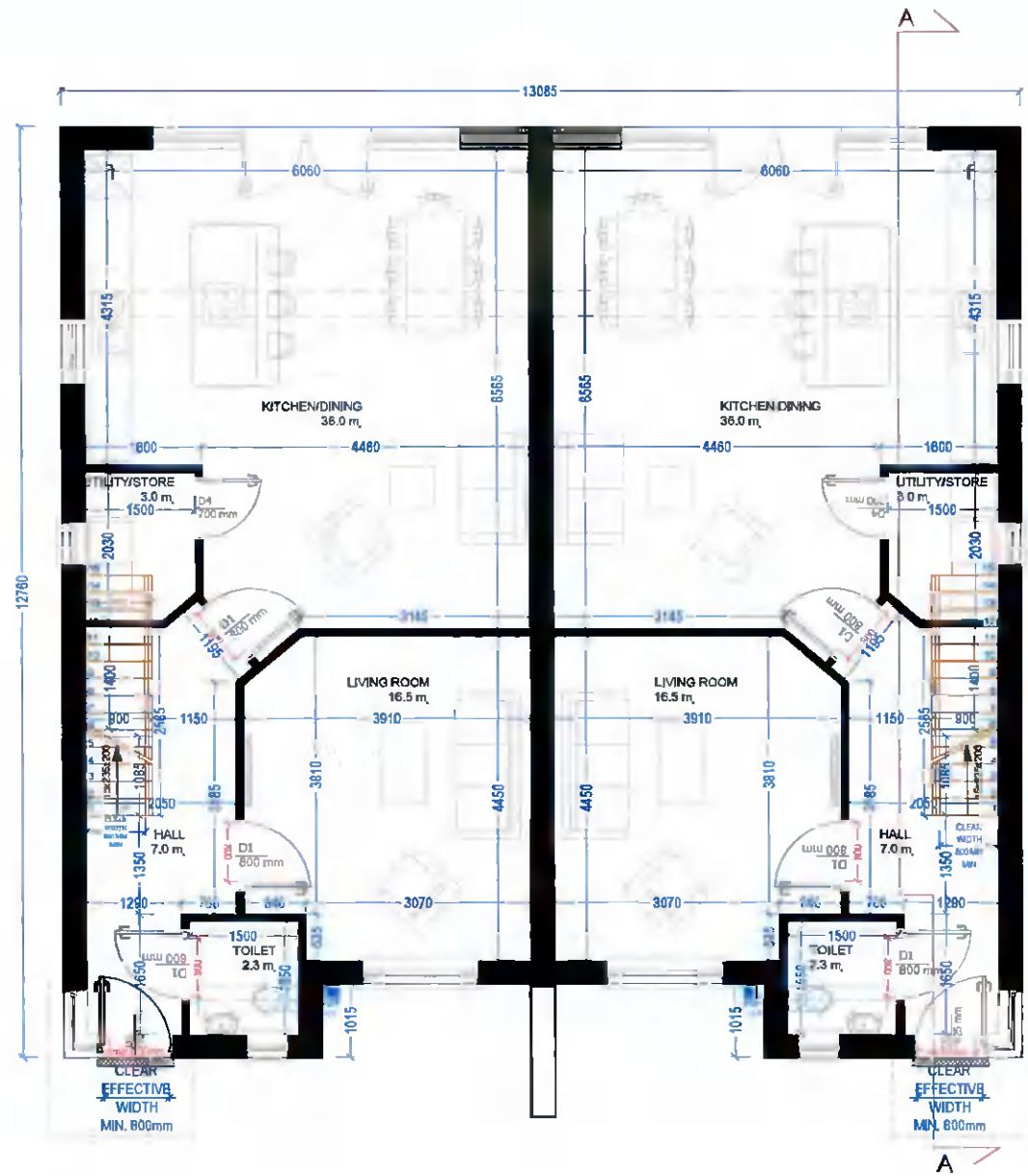

SEE SITE LAYOUT PLAN FOR ORIENTATION OF UNITS

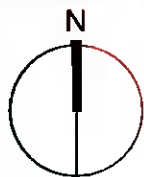

TYPE C - 119 m²
3 BED / 5 P / 2 STOREY / SEMI-DETACHED

MINIMUM ROOM SIZES, DIMENSIONS AND OVERALL FLOOR AREAS AS PER South Dublin County Council Development Plan 2016-2022 and Quality Housing for Sustainable Communities Guidelines, DEHLG (2007).

(MIN AGGREGATE LIVING AREA REQ. 34 m² PROV 51.0 m²)

(MIN AGGREGATE BEDROOM AREA REQ. 32 m² PROV 34.8 m²)

MIN STORAGE SPACE REQ. 5.0 m²

STORAGE SPACE PROVIDED - 5.5 m²

FOR FURTHER INFORMATION PURPOSES ONLY

Decision no. 1379 Reg.ref. SD21A/0246

ISSUE DATE: 06.05.2022

TERRY & O'FLANAGAN LTD.
 REGISTERED ARCHITECTS



Registered in Ireland No. 000000333
 Tel: 01 4050949/4050950 Fax: 01 4050953 E-mail: to@tofa.ie
 F1, Centenary Business Park, Oak Road, D12 www.tofa.ie
 This drawing & design is copyright of Terry & O'Flanagan Ltd.

HOUSE TYPE C (3-BED) 5 P / 2 STOREY / SEMI-DETACHED
GROUND AND FIRST FLOOR PLAN

BECKETT DEVELOPMENTS LTD

PROPOSED 8 HOUSES AT THE PART OF THE GROUNDS OF "PALMYRA",
 WHITECHURCH ROAD (GRANBROOK AVENUE),
 RATHFARNHAM, DUBLIN 16.

MAY 2022

1:100 (A3)

D1194 - 2 - 13

KP

Contractors must verify all dimensions on site before commencing any work.
 Working dimensions to be scaled. Dimensions to blockwork only.
 This drawing and design is copyright and the property of Terry & O'Flanagan Ltd.