

Land Use Planning and Transportation Department

Connecting You to

Mr. Brendan English,
Terry O Flanagan Ltd. Architects,
F1, Centrepoint Business Park,
Oak Road,
Dublin 12

Date: 23rd November 2021.

Subject: Request for Grant of Consent to Beckett Developments Ltd for Site adjacent to Grangebrook Avenue, Palmyra, Whitechurch Road, Rathfarnham, Dublin

Dear Brendan,

I confirm the consent of this Department only to the inclusion of the land as outlined in red but outside the land outlined in blue on Drawing D1194-1-01 as supplied by you for the purpose of the application for planning permission and for no other purpose. It is the responsibility of the applicant for planning permission to ensure that the drawing supplied correctly reflects the boundaries of the land stated to be in the ownership, charge or held under wayleave in favour of the Council.

In the event that planning permission is granted, a Road Opening Licence must be applied for and granted before any works can commence.

Yours sincerely,

Tony O' Grady,
Senior Engineer,
Road Maintenance.

Comhairle Contae Átha Cliath Tíreolaíochta
Kesh na Contae, Tamluaht
Barr Átha Cliath 24

South Dublin County Council,
County Hall, Tallaght,
Dublin 24

Tel: +353 1 414 9000
SMS: 086 173 1707
Email: info@southdublincc.ie

Ceangal 24/7 Connect 24/7
with Council information and
services at www.southdublin.ie

NORTH

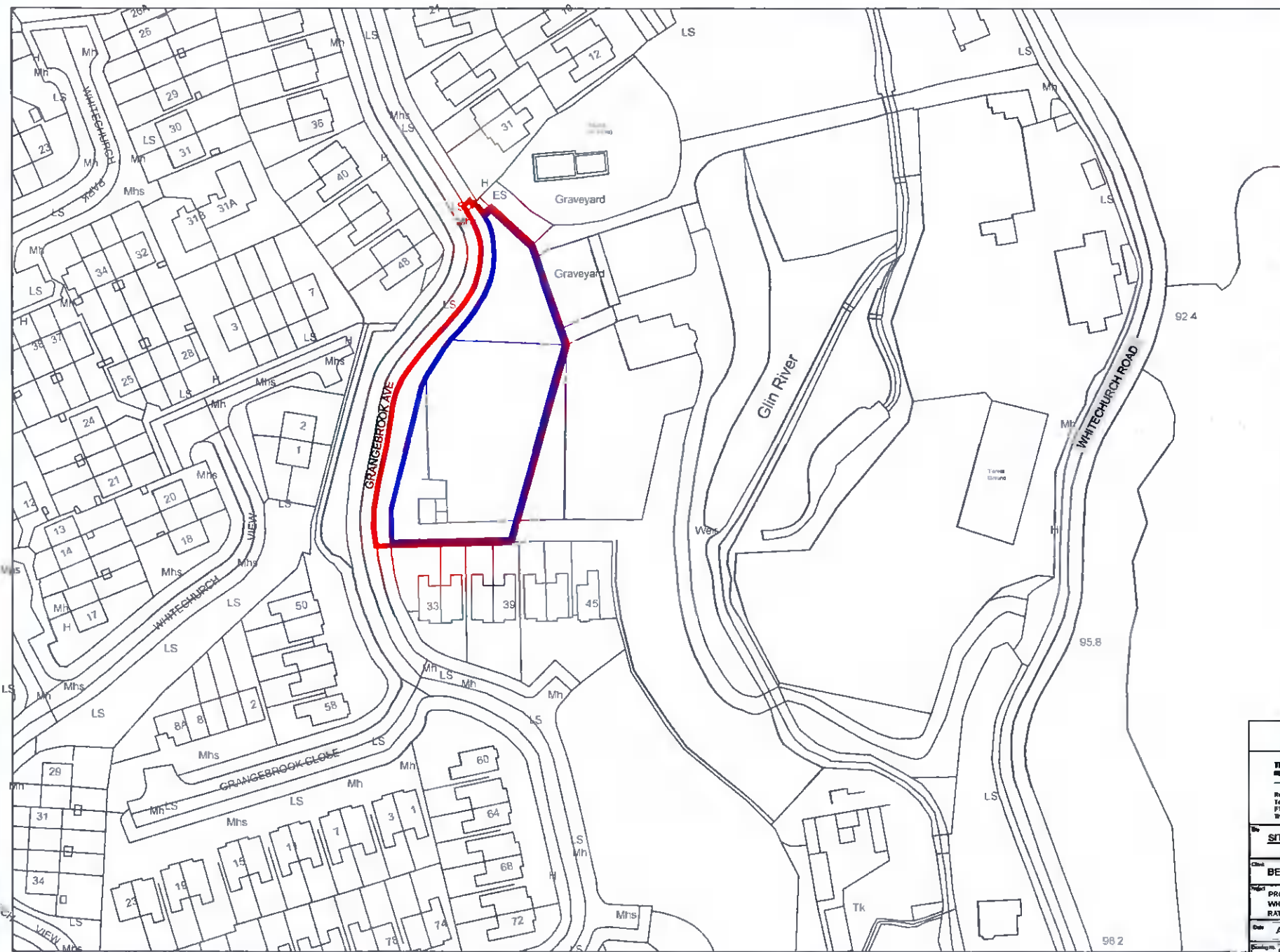
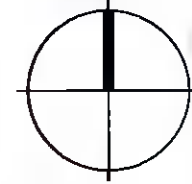

SUBJECT APPLICATION SITE OUTLINED IN RED
AREA: 0.271HA



AREA OF THE SITE IN WHICH APPLICANT HAS A LEGAL INTEREST (TOTAL LAND OWNERSHIP) OUTLINED IN BLUE: 0.226HA

OS MAP REF.: 3391-23.3391-24

ITM. CENTREPOINT COORDINATES
X,Y = 714475.201, 726374.8727

SITE LOCATION PLAN & RED LINE BOUNDARIES BASED ON ORDNANCE SURVEY INFORMATION RECEIVED FROM CLIENT AND REPRODUCED UNDER OS LICENCE TERRY & O'FLANAGAN LTD. AR00108022

FOR PLANNING PURPOSES ONLY
ISSUE DATE: 17.08.2021

TERRY & O'FLANAGAN LTD.
REGISTERED ARCHITECTS
Registered in Ireland No. 3567328
Tel: 01 4689949/4689950 Fax: 01 4689953 E-mail: tso@tso.ie
P1 Carrigrohane Business Park, Carrigrohane, Co. Wick, Ireland
The drawing & design is copyright of Terry & O'Flanagan Ltd.



SITE LOCATION MAP

Client: BECKETT DEVELOPMENTS LTD

Project: PROPOSED 8 HOUSES AT THE PART OF THE GROUNDS OF "PALMYRA" WHITECHURCH ROAD (GRANBROOK AVENUE), RATHFARNHAM, DUBLIN 18.

Date: AUGUST 2021 **Scale:** 1:1000 (A3)

Drawing No.: D1194-1-01 **Rev.:** **Drawn by:** KP

Client to verify all dimensions on site before commencing any work.
No warranty is made by the architect.
This drawing is not to be used for any other purpose without the written consent of Terry & O'Flanagan Ltd.