

EXISTING & PROPOSED WEST ELEVATION

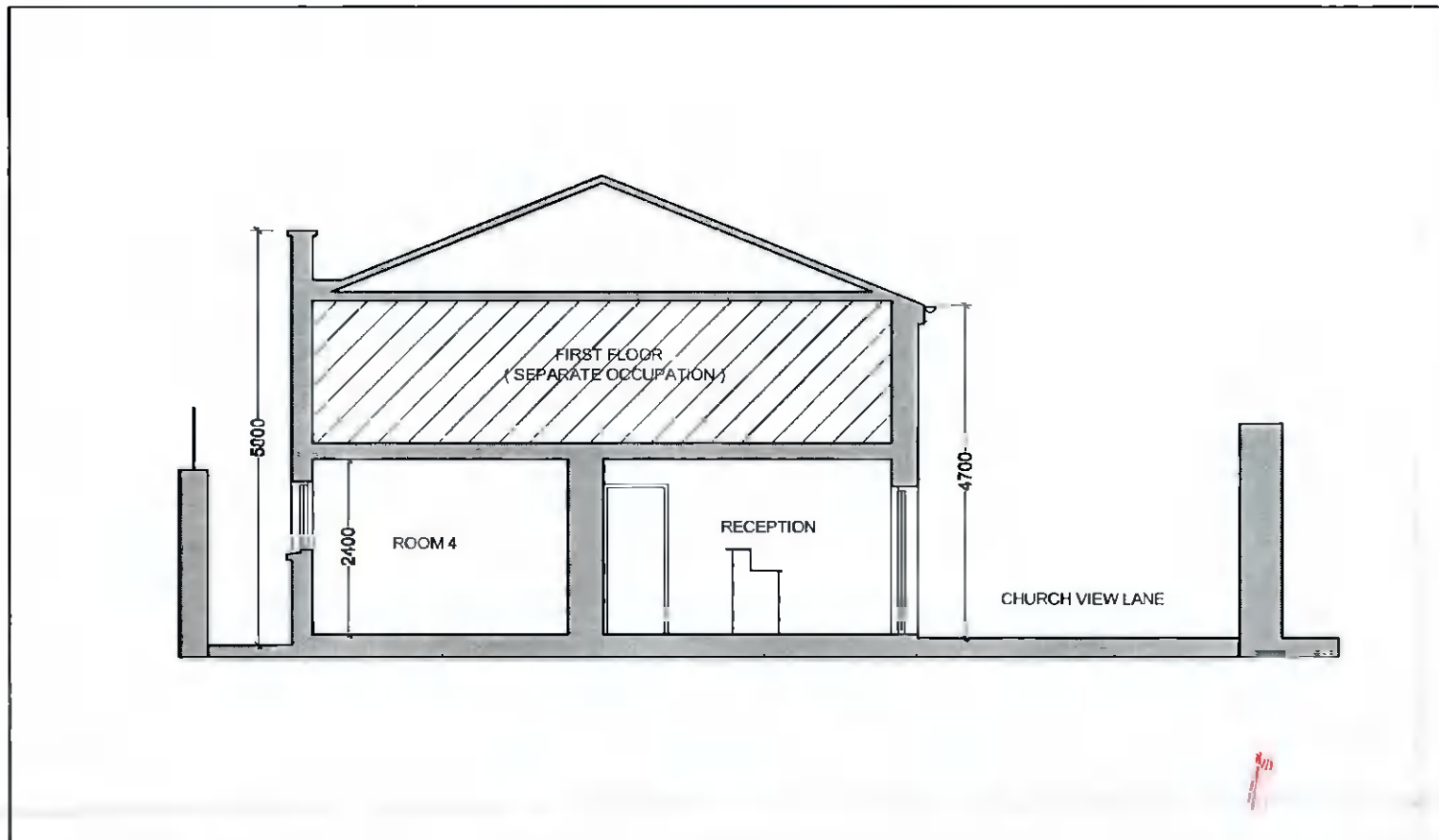

SECTION A - A

FOR PLANNING ONLY

Rev			TITLE
COLIN CARROLL Architectural and Energy Design 96, Wheatfield, Bray, Co. Wicklow Tel: 086 8116806			EXISTING & PROPOSED WEST ELEVATION AND SECTION A-A
Client	DR. PAMROD AGARWAL	Scale	Rev. No
		1:100	
Location	NO. 2, CHURCH VIEW MAIN STREET, LUCAN, CO. DUBLIN	Date	Drg. No
		04/04/2022	22-05-03