

EXISTING LONGITUDINAL SECTION (A-A), Scale: 1/100

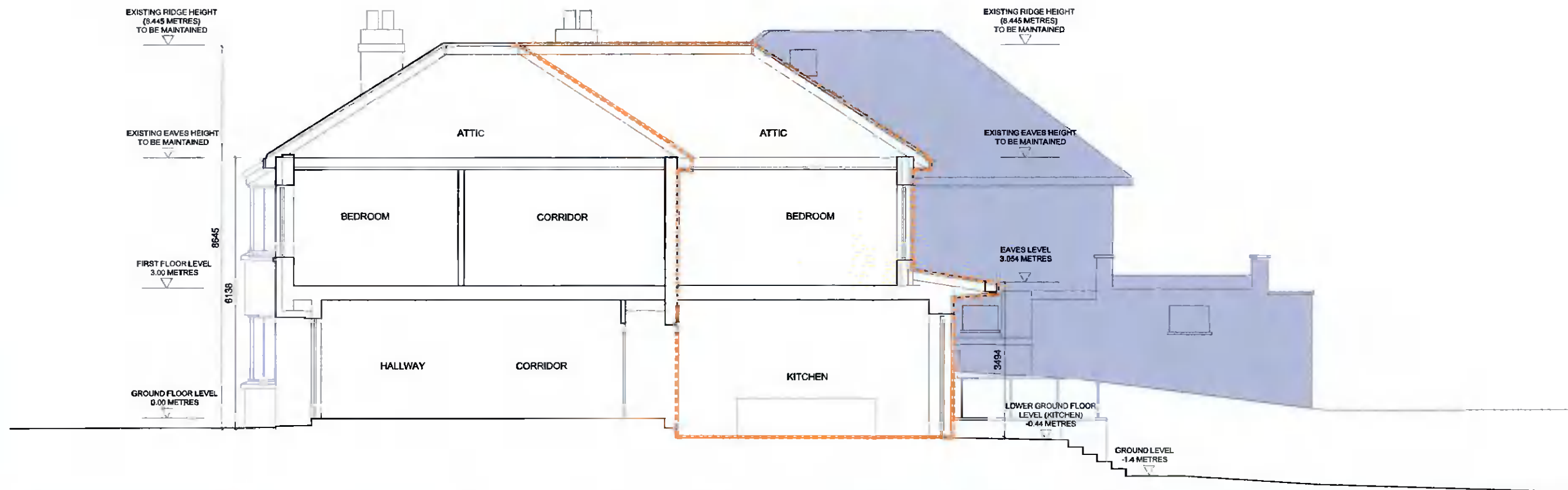

PROPOSED LONGITUDINAL SECTION (A-A), Scale: 1/100

— SITE BOUNDARY SUBJECT OF CURRENT PLANNING APPLICATION      - - - - - PROPOSED EXTENSIONS OUTLINED IN ORANGE



ORIGINAL SHEET SIZE = A3

NO DIMENSIONS TO BE SCALED OFF THIS DRAWING  
ALL DIMENSIONS TO BE CHECKED ON SITE  
THE DRAWING IS COPYRIGHT  
SPOT LEVELS SHOWN IN RELATION TO GROUND FLOOR LEVEL

REV	DATE	DRN	NOTES
A	23.12.21	AL	ISSUED FOR PLANNING
B	29.03.22	AL	ISSUED FOR PLANNING RFI RESPONSE
C	02.05.22	AL	ISSUED FOR PLANNING CLARIFICATION OF ADDITIONAL INFORMATION

REV	DATE	DRN	NOTES

ARANZAZU LERA ANTON ARCHITECT  
141 RATHFARNHAM ROAD, RATHFARNHAM, DUBLIN 14  
T 0871027162 E aleranton@gmail.com

DWG. SERIES 3.1 PLANNING			
PROJECT	PROPOSED HOUSE EXTENSION AT ST KEVIN'S, 17 RATHFARNHAM PK, D 14	JOB NO	21-101
DRN. TITLE	EXISTING AND PROPOSED LONGITUDINAL SECTIONS (A-A)	DATE	23.12.21
CLIENT	WILLIAM JUDGE DRN B1 AL	SCALE	1:100
		DWG NO	3.1_301
		REV	C