

- NOTES**
1. All dimensions in millimetres unless otherwise shown.
 2. All levels in metres above Ordinance Datum (mAOD) unless otherwise shown.
 3. All dimensions to be checked on site and any discrepancies reported to Employer before pricing / work starts.
 4. Any ambiguities or discrepancies within this drawing and any other information given elsewhere must be reported to Camlins and the Employer for clarification before pricing work proceeds.
 5. All drawings to be read in conjunction with other Camlins drawings and specification information as appropriate.
 6. Refer to relevant Engineer's and Architect's information as appropriate for confirmation of all engineering and architectural details.
 7. All works to be carried out in accordance with the latest British Standards and appropriate codes of practice as a minimum.

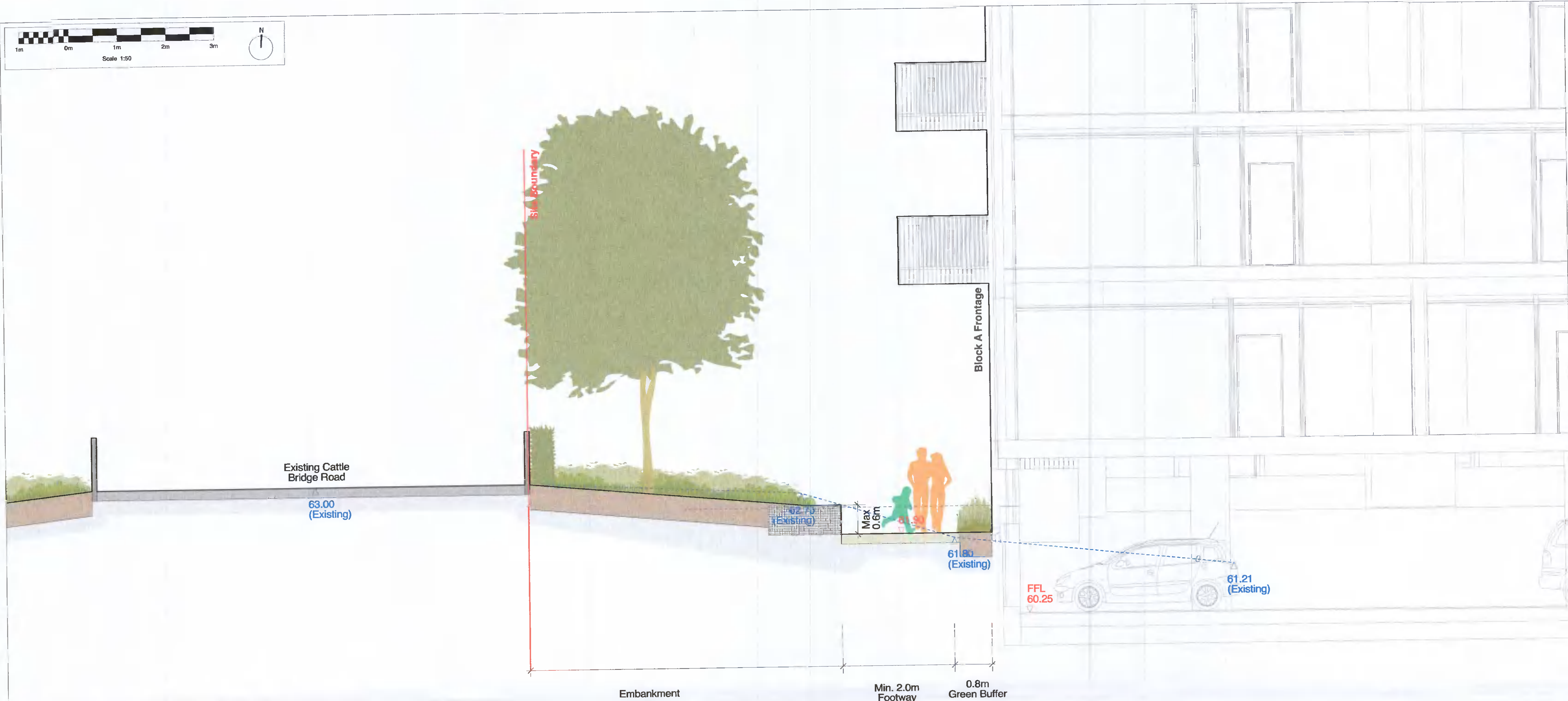

Section D
(Scale 1:50)

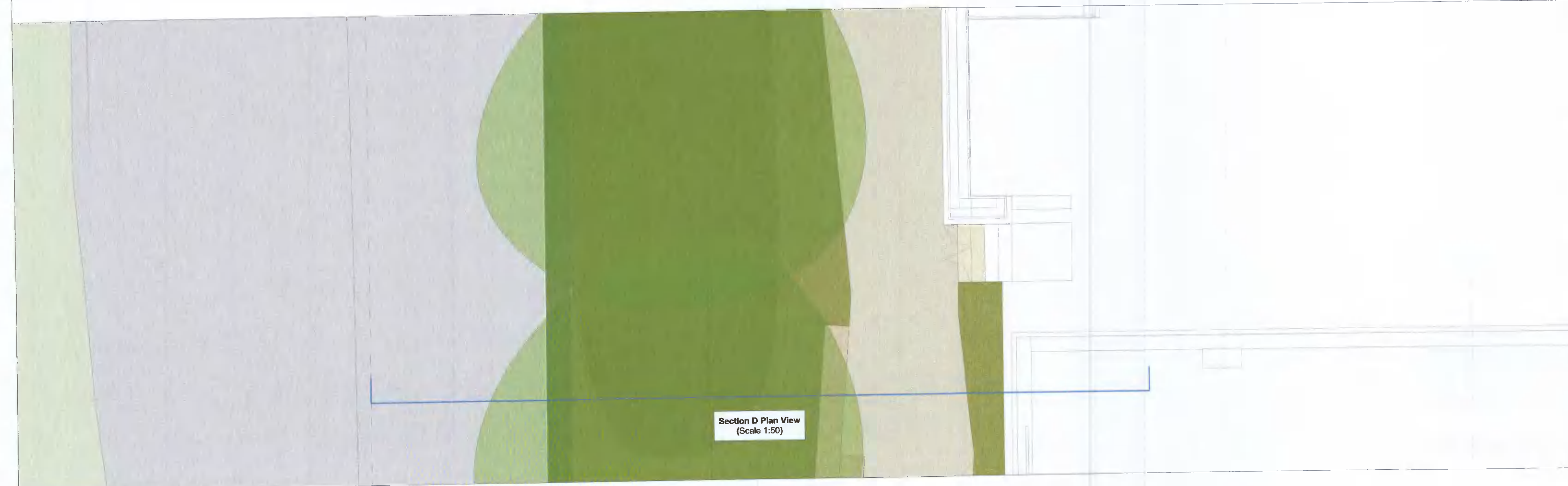

Section D Plan View
(Scale 1:50)

NOTES

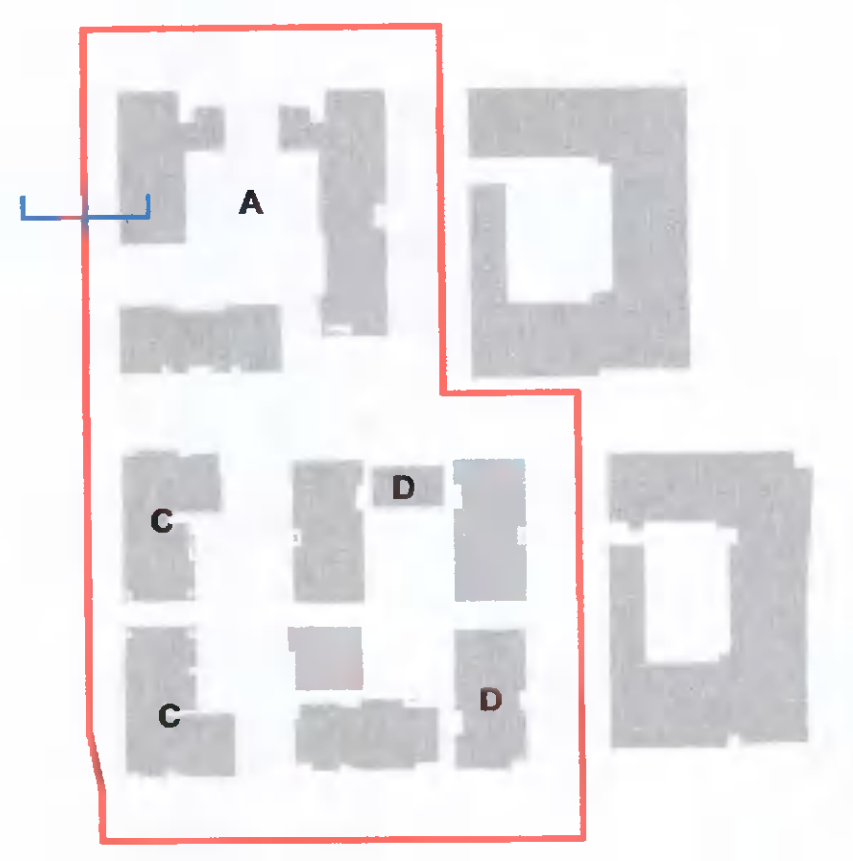

Camlins

New Doding House, Severn Road,
Walspool, Powys, SY21 7AR
01538 854888
www.camlins.com

Adamstown District Blocks A, C, D
Quintain Developments Ireland Ltd

Section D

| | | |
|----------------------------------|------------------|--------------------|
| Scale Planning | Drawn by RS | Checked by PSS |
| Drawing Number LL591-200-0104 | Revision - | Date 07.04.2022 |
| | Scale 1:50@A1 | |