

- NOTES**
1. All dimensions in millimetres unless otherwise shown.
 2. All levels in metres above Ordinance Datum (mAOD) unless otherwise shown.
 3. All dimensions to be checked on site and any discrepancies reported to Employer before pricing / work starts.
 4. Any ambiguities or discrepancies within this drawing and any other information given elsewhere must be reported to Camlins and the Employer for clarification before pricing work proceeds.
 5. All drawings to be read in conjunction with other Camlins drawings and specification information as appropriate.
 6. Refer to relevant Engineer's and Architect's information as appropriate for confirmation of all engineering and architectural details.
 7. All works to be carried out in accordance with the latest British Standards and appropriate codes of practice as a minimum.

- KEY**
- Planning Application Site Boundary
 - Podium Level

- GF Level**
- Stainless Steel Cycle Stands (No. of stands 23)
 - Timber Wall-Mounted Seat Public Realm Quality
 - Timber Seat / Or Similar Material Public Realm Quality
 - Lighting Columns, Taken In Charge
 - Walls, Steps Used For Seating And Informal Play
 - Dedicated Timber Play And Fitness Equipment Public Realm Quality
 - Stepping Stones And Natural Boulders For Informal Play

- Communal Space**
- Stainless Steel Cycle Stands
 - Dedicated Timber Play Equipment
 - Timber Seat
 - Concrete Stepping Seat
 - Timber Pergola
 - Cycle Shelter
 - Stepping Stones For Informal Play

Area Subject To Future Application

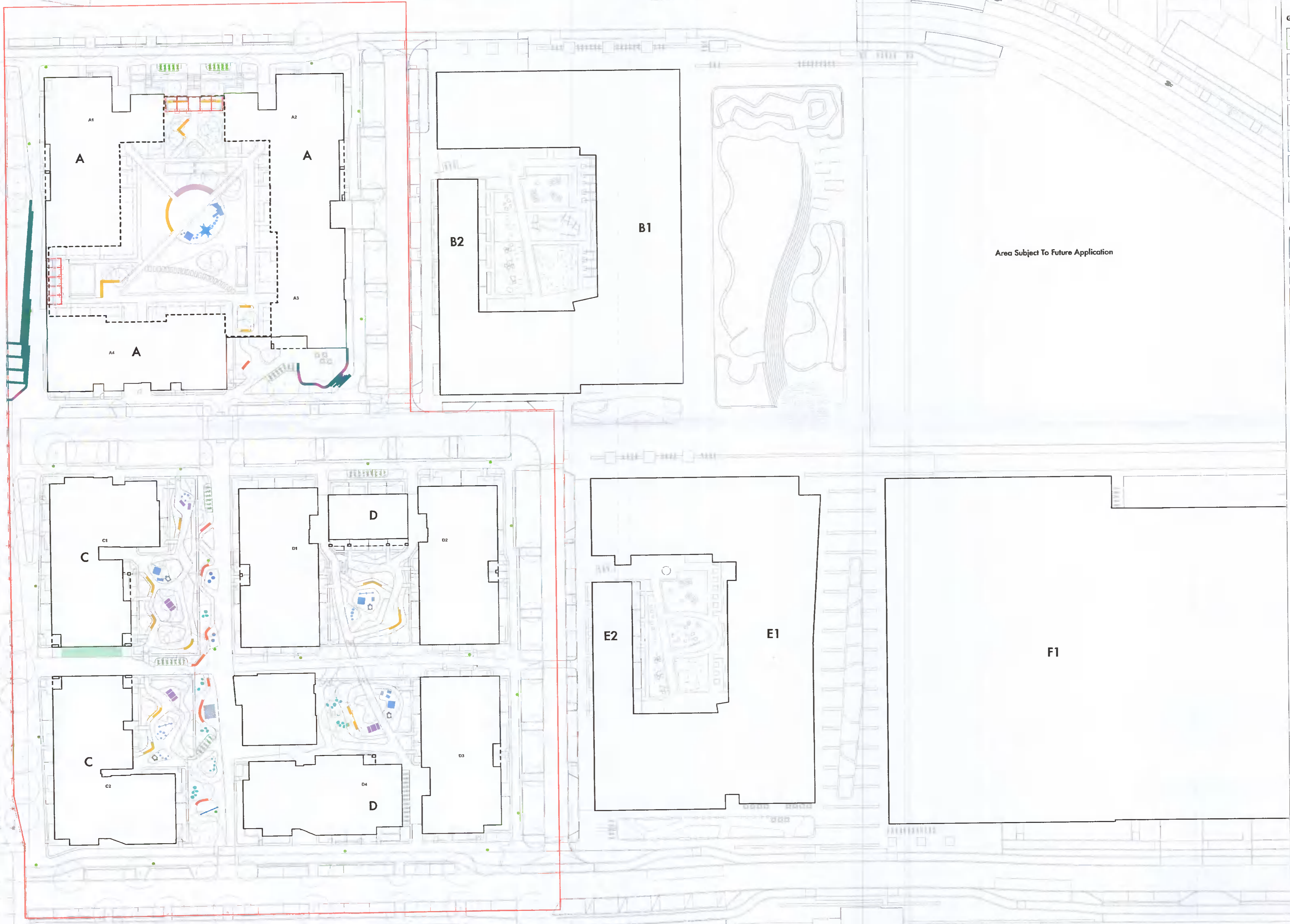

Rev.	Date	Description	Revised by	Checked by

Camlins
 New Zealand House, Abbey Foregate,
 Shrewsbury, Shropshire, SY2 6FD
 01743 290 770
 www.camlins.com

Adamstown District Centre Blocks A, C, D
 Quintain Developments Ireland Ltd
 GA Proposed Furniture And Fixtures Plan

Status Planning	Drawn by RS	Checked by PSS
Drawing Number LL591-200-0051	Revision -	Scale 1:500@A1
	Date 07.04.2022	