

- NOTES**
1. All dimensions in millimetres unless otherwise shown.
 2. All levels in metres above Ordinance Datum (mAOD) unless otherwise shown.
 3. All dimensions to be checked on site and any discrepancies reported to Employer before pricing / work starts.
 4. Any ambiguities or discrepancies within this drawing and any other information given elsewhere must be reported to Camlins and the Employer for clarification before pricing work proceeds.
 5. All drawings to be read in conjunction with other Camlins drawings and specification information as appropriate.
 6. Refer to relevant Engineer's and Architect's information as appropriate for confirmation of all engineering and architectural details.
 7. All works to be carried out in accordance with the latest British Standards and appropriate codes of practice as a minimum.

- KEY**
- Planning Application Site Boundary
 - Podium Level

- Public Realm**
- P1 Bitmac Carriageway Surface
 - P2 Bitmac Cycleway Surface
 - P3 Bitmac Carriageway Surface With Red Chippings
 - P4 Bitmac Carriageway Surface With Coloured Wearing Course
 - P5 Textured Finish Concrete Blocks For Footway Large Units
 - P6a Textured Finish Concrete Blocks For Parking Bay Small Units
 - P6b Textured Finish Concrete Blocks For Footway Small Units
 - P7 Self Binding Gravel
 - P9 Concrete Blister Tactile Paving
 - P11 EPDM
- Communal / Private Space**
- P8 Textured Coloured Concrete Flags
 - P12 Resin Bound Gravel
 - Stops, Structures And Terraces In-situ Concrete With Bespoke Textured Finish
 - Gabion Basket Retaining Wall

Upstand Kerbs, Flush Kerbs And Edging Are Not Shown Separately At This Stage

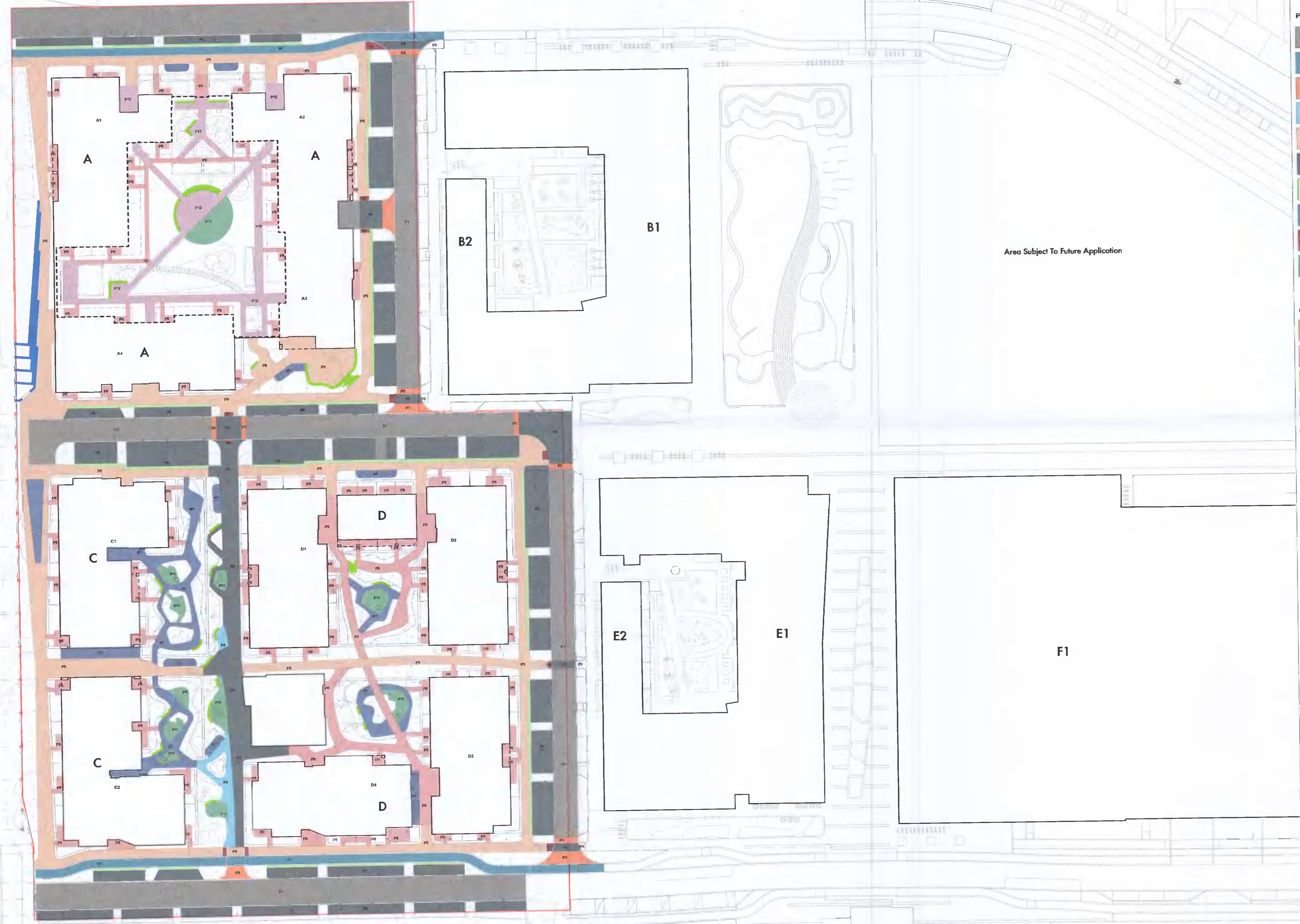

Rev.	Date	Description	Revised by	Checked by

Camlins
 New Zealand House, Abbey Foregate,
 Shrewsbury, Shropshire, SY2 6FD
 01743 250 779
 www.camlins.com

Adamstown District Centre Blocks A, C, D
 Quintain Developments Ireland Ltd
 GA Proposed Materials Plan

Status Planning	Drawn by RS	Checked by PSS
Drawing Number LL591-200-0041	Revision -	Scale 1:500@A1
		Date 07.04.2022