

- NOTES**
1. All dimensions in millimetres unless otherwise shown.
 2. All levels in metres above Ordnance Datum (mAOD) unless otherwise shown.
 3. All dimensions to be checked on site and any discrepancies reported to Employer before pricing / work starts.
 4. Any ambiguities or discrepancies within this drawing and any other information given elsewhere must be reported to Camlins and the Employer for clarification before pricing work proceeds.
 5. All drawings to be read in conjunction with other Camlins drawings and specification information as appropriate.
 6. Refer to relevant Engineer's and Architect's information as appropriate for confirmation of all engineering and architectural details.
 7. All works to be carried out in accordance with the latest British Standards and appropriate codes of practice as a minimum.

- KEY**
- Planning Application Site Boundary
- GF Level**
- R1 1200mm High Steel Mesh Fencing And Gate To Communal Spaces
 - R2 900mm High Steel Mesh Fencing And Gate To Front Gardens
 - F2 800mm High Timber Fence
- Podium Level**
- Podium Level
 - B3 1200 High Steel Structure (As Necessary) With Timber Cladding To Podium Edge
 - F1 1500 High Timber Trellis And Gates To Private Gardens (refer To Drawing LL591-200-0220 For Details)

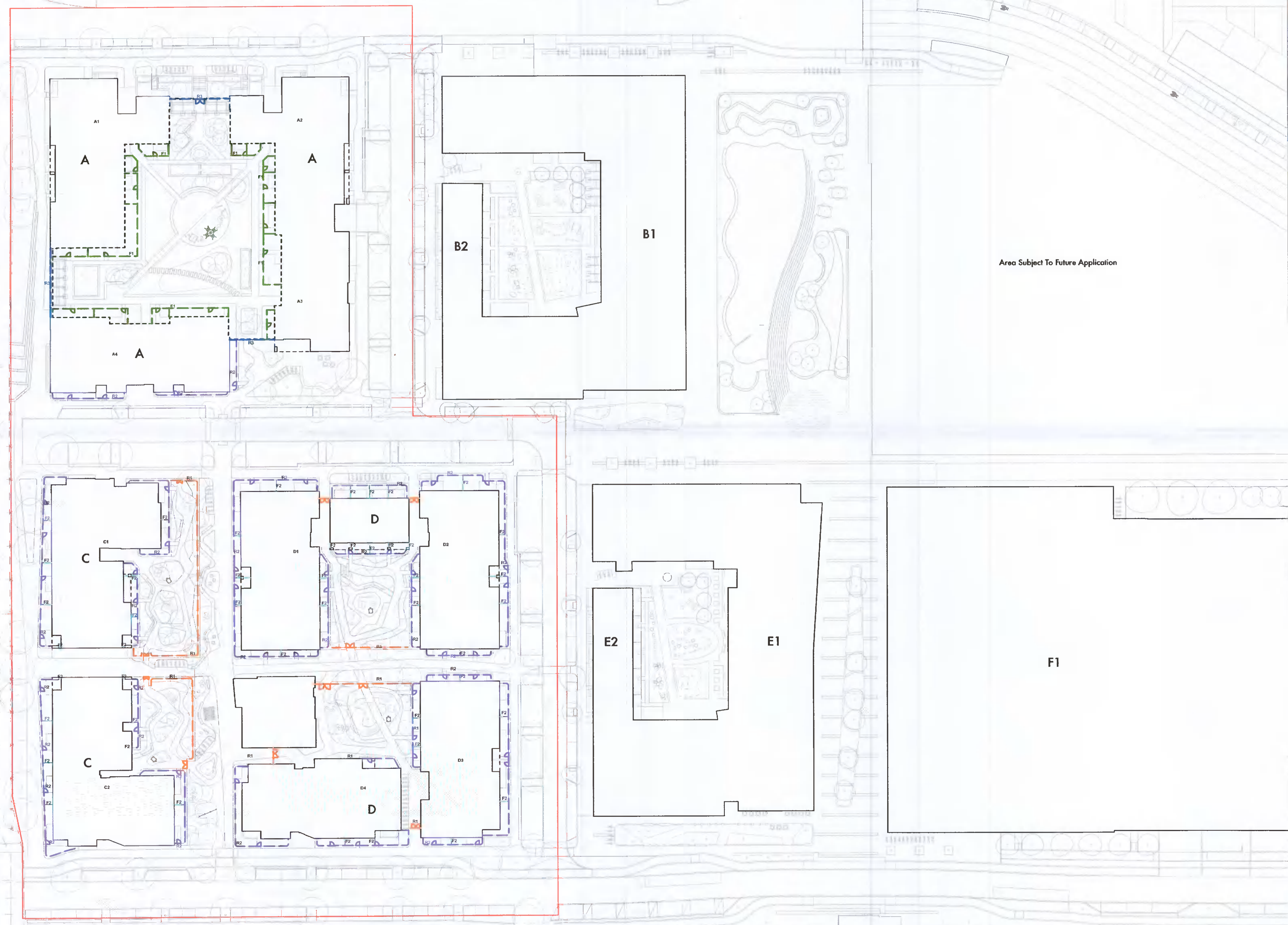

Rev.	Date	Description	Revised by	Checked by

Camlins
 New Zealand House, Abbey Foregate,
 Shrewsbury, Shropshire, SY2 6FD
 01753 200 778
 www.camlins.com

Adamstown District Centre Blocks A, C, D
 Quintain Developments Ireland Ltd

GA Boundary Treatments

Status: Planning
 Drawn by: RS
 Checked by: PSS

Drawing Number: LL591-200-0031
 Revision: -
 Scale: 1:500@A1
 Date: 07.04.2022