







- NOTES**
1. All dimensions in millimetres unless otherwise shown.
 2. All levels in metres above Ordnance Datum (mAOD) unless otherwise shown.
 3. All dimensions to be checked on site and any discrepancies reported to Employer before pricing / work starts.
 4. Any ambiguities or discrepancies within this drawing and any other information given elsewhere must be reported to Camlins and the Employer for clarification before pricing work proceeds.
 5. All drawings to be read in conjunction with other Camlins drawings and specification information as appropriate.
 6. Refer to relevant Engineer's and Architect's information as appropriate for confirmation of all engineering and architectural details.
 7. All works to be carried out in accordance with the latest British Standards and appropriate codes of practice as a minimum.

- KEY**
-  Planning Application Site Boundary
 -  Podium Level
 -  Public Realm Areas Taken In Charge
 -  Public Realm Areas Not Taken In Charge
 -  Communal + Private Areas Not Taken In Charge
 -  Parking Assigned to Blocks B & E Subject To Separate Planning Application

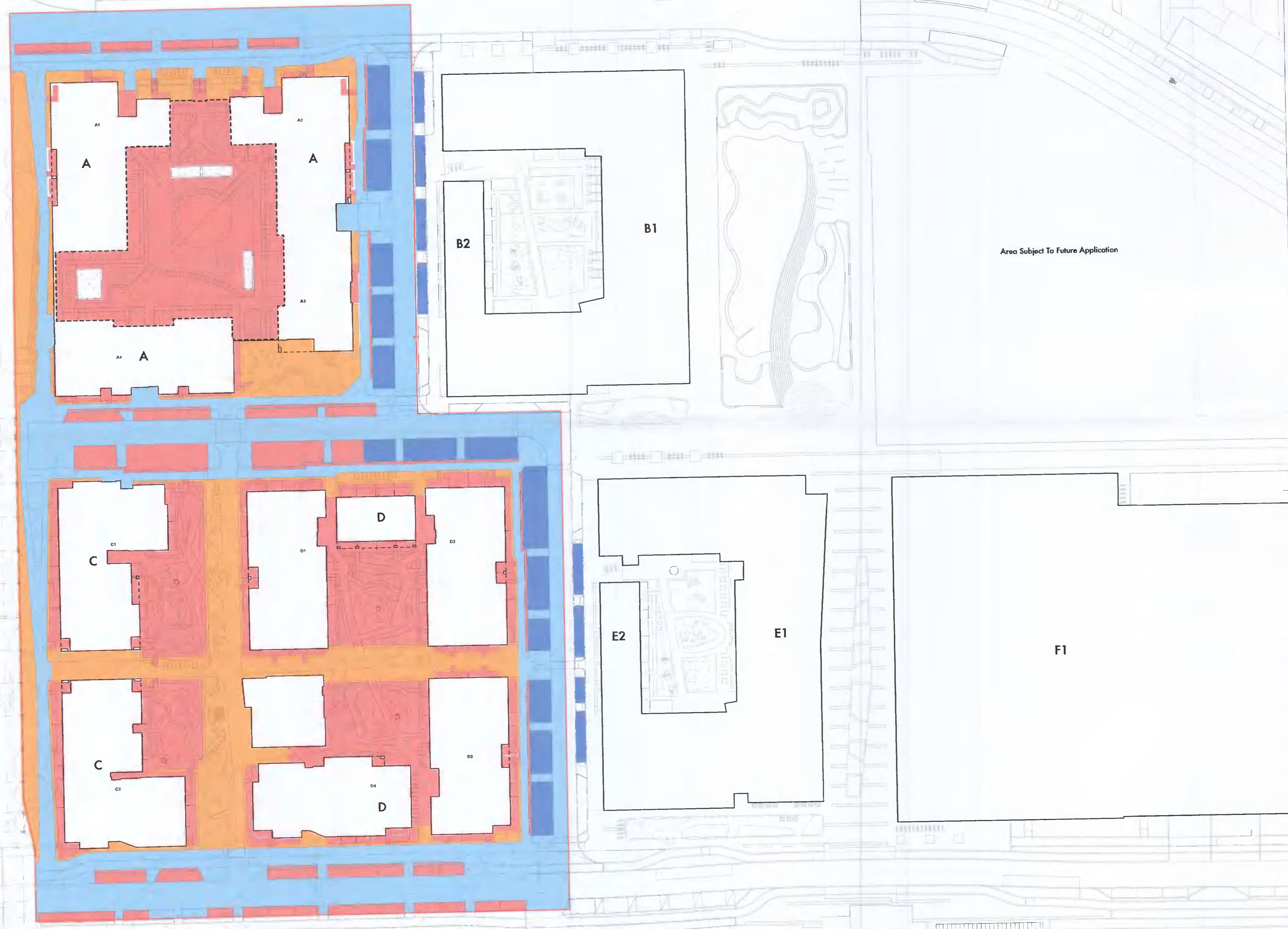

Rev.	Date	Description	Revised by	Checked by

Camlins
 New Zealand House, Abbey Foregate,
 Shrewsbury, Shropshire, SY2 6FD
 01743 290 776
 www.camlins.com

Adamstown District Centre Blocks A, C, D
 Quintain Developments Ireland Ltd

GA Taken In Charge

Status Planning	Drawn by RS	Checked by PSS
Drawing Number LL591-200-0005	Revision -	Date 07.04.2022
	Scale 1:500@A1	