

COLM McLOUGHLIN, ARCHITECT
1 Rear Unit, Ground Floor,
Library Square, Rathcoole, Co. Dublin.
Tel/Fax: 4589 695 Mobile: 086.2617 844

REDMOND
MAIN ST
RATHCOOLE

IG BOUNDARY WALL
TO 1.8m & CAPPED

EAVES
118.131

EAVES 118.627 + RIDGE 121.372

PRIVATE
OPENSOURCE
48.6 m.sq
+113.90

EXISTING
OFFICE

SEE LAYOUT
ON
MAIN
PLAN

FFL
113.95

SPAR
CAR PARK

SITE
NOTICE
EXISTING

Ground Floor

Block Plan
MAP

SCALE: 1:100

SC: 1:100

(3.9)
3.9m

12.9m

23.4m

9.8m

7.0m

3.8m

23.1m

114.66

115.000

+114.78

114.000

56' EF

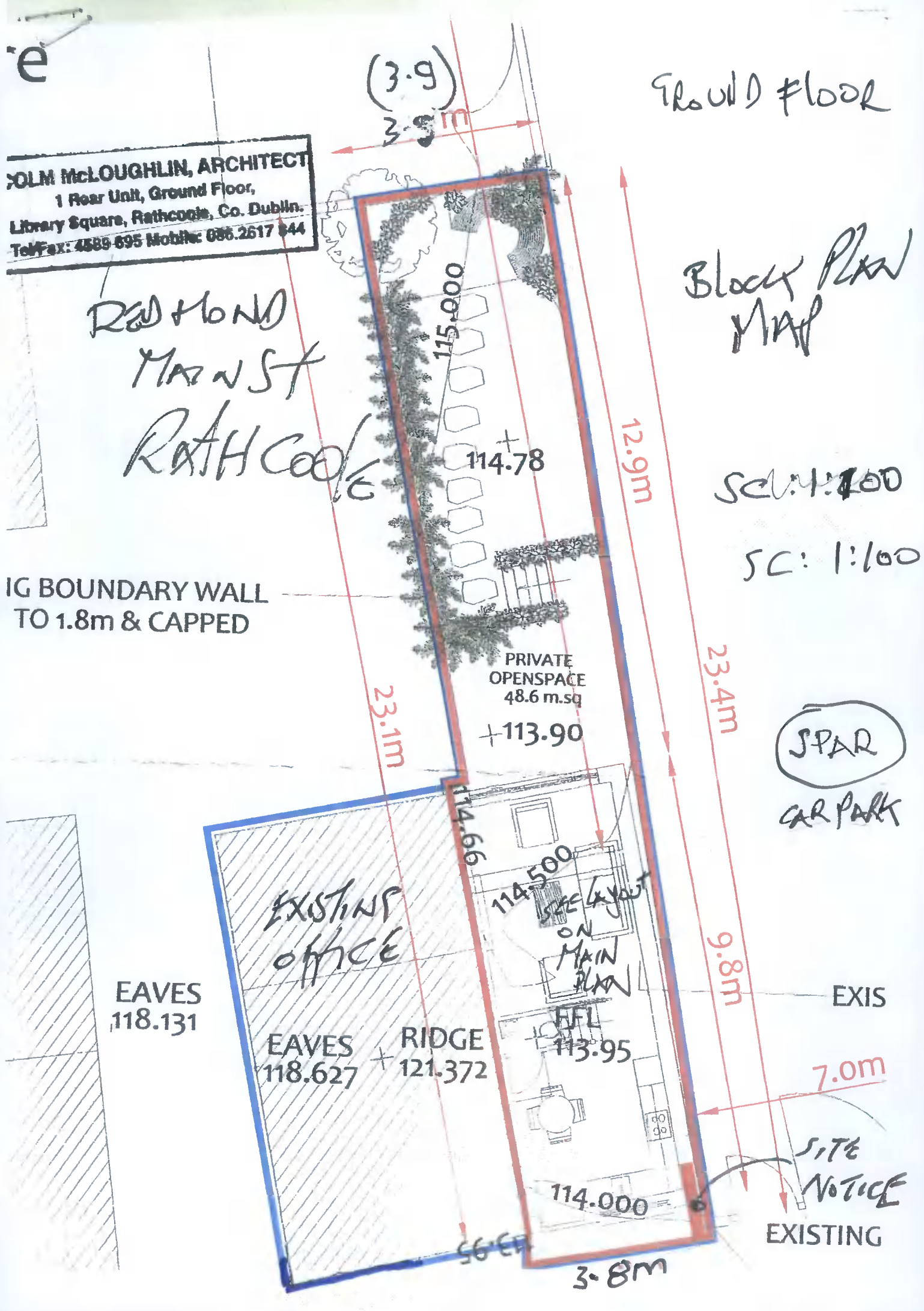

Block Plan

SC: 1:200

BARRENH
COURT

STARTONS

STAR CARPENTRY

STAR
SHOP

EXISTING
AUCT.

PROPOSED
APT

NOTICE

SC: 1:200

ALAN REEDMOND

MAIN ST.

RATHGEE

N



Location
Block (Identify)
Plan

PROPOSED
STUDIO

APARTMENT

ALSO REDHANO

MAIN ST

RATHLEDE

EXISTING CAR PARK

SPAR
SHOP

GARDEN

WALL

WALL

REMOVED

APT

OFFICE

BUILDINGS

MAIN STREET

Colm MacDermott
21 DOOSBRO RD
LIVER
Co Dublin

