





Do not scale. Use figured dimensions only. All dimensions to be checked on site.
 Any discrepancies between site and figured dimensions to be brought forward immediately for verification and correction.
 © The drawing is copyright.
 © The drawing is copyright.
 © The drawing is copyright.
 © The drawing is copyright.
 © The drawing is copyright.
 © The drawing is copyright.
 © The drawing is copyright.
 © The drawing is copyright.
 © The drawing is copyright.
 © The drawing is copyright.

GENERAL NOTE: The proposed applications to be brought mandatorily to the attention of the Council are subject to the minimum requirements of the Building Regulations. All products to be installed in strict accordance with the manufacturer's specifications.
 Any discrepancy between the proposed applications and the Building Regulations shall be brought forward immediately for verification and correction.
 The proposed applications shall be brought to the attention of the Council prior to the submission of the final applications to the Council.
 The proposed applications shall be brought to the attention of the Council prior to the submission of the final applications to the Council.
 The proposed applications shall be brought to the attention of the Council prior to the submission of the final applications to the Council.
 The proposed applications shall be brought to the attention of the Council prior to the submission of the final applications to the Council.



LEGEND

- Site boundary in red, subject of application.
-  Site notice location

-  Extent of new roof material
-  New Rooflights
-  New PV cells

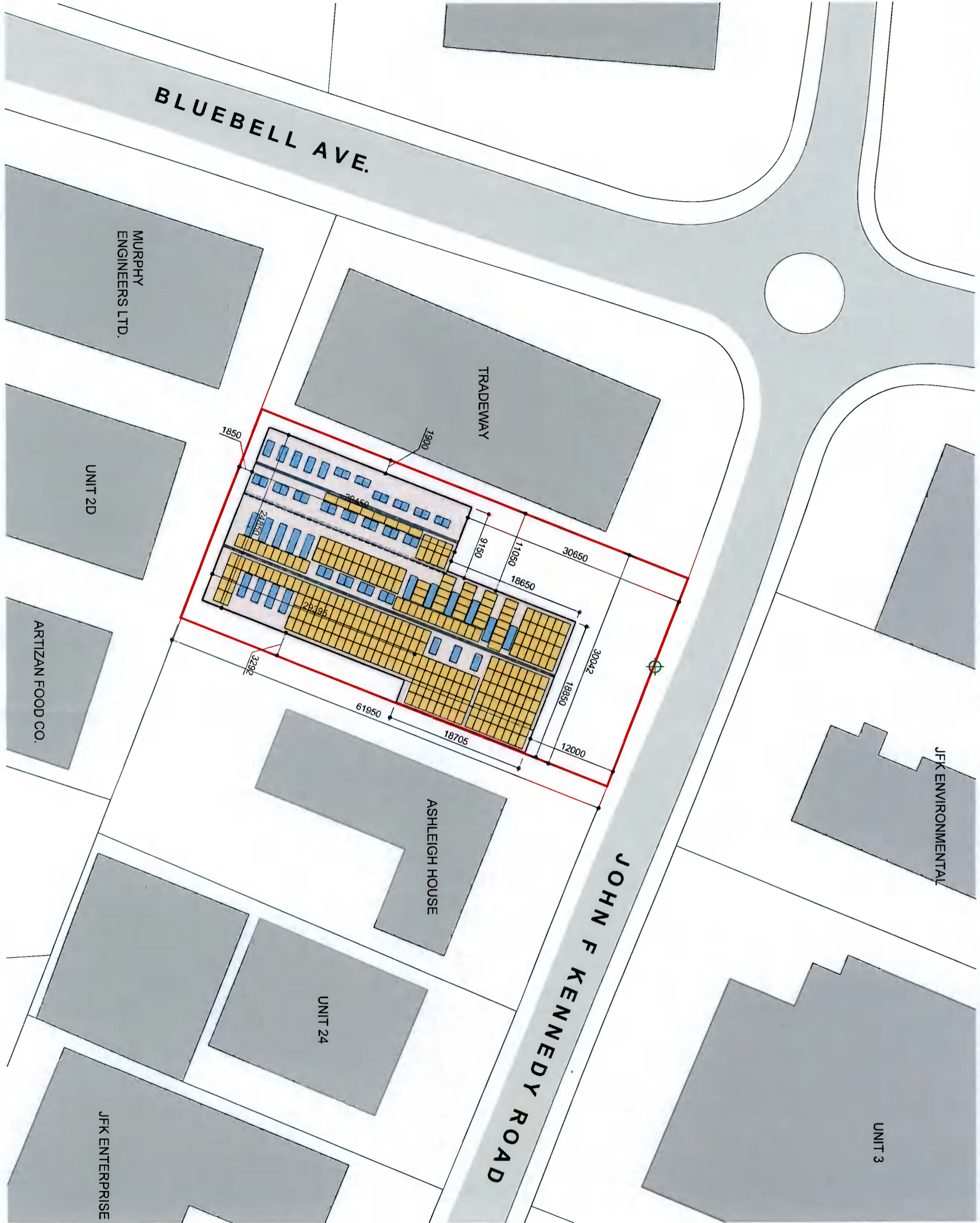

01 Proposed Site Layout Plan
 016 1:500 @ A3

Client	Enlio
Project	Enlio Kitchen Facility
Drawing title	Proposed Site Layout Plan
Job number	22012
Drawing number	016
Drawing reference	22012.AP.AP016.Rev.-
Scale	1:500 @ A3
Date created	04/04/2022
Author	AOD

DMOD ARCHITECTS

Central Court
 One Street
 Chelmsford
 Essex
 CM1 1YU
 Tel: 0203 461 1700
 Email: dm@dmod.co.uk
 Website: www.dmod.co.uk