

Rev	Date	Description	By	Cld
P1	14/04/2022	ISSUED FOR PLANNING	CDA	JM

CONFIDENTIAL INFORMATION: This drawing is the property of the design engineer and is not to be used for any other project without the written consent of the design engineer. The design engineer shall not be held responsible for any errors or omissions in this drawing, which may be the result of incomplete or incorrect information furnished by the client or other parties. In whole or in part, in violation of the terms of the contract.

Drawn by	Checked by	Date
CDA	JM	10/11/21
Scale (@ A0)	Status code	Project number
As indicated	A1	958018

Drawing Title: **PROPOSED SUBSTATION COMPOUND SITE LAYOUT PLAN**

Drawing Number: **ESSDUB98-HJL-01-XX-DR-A-1011**
 Revision: **P1**

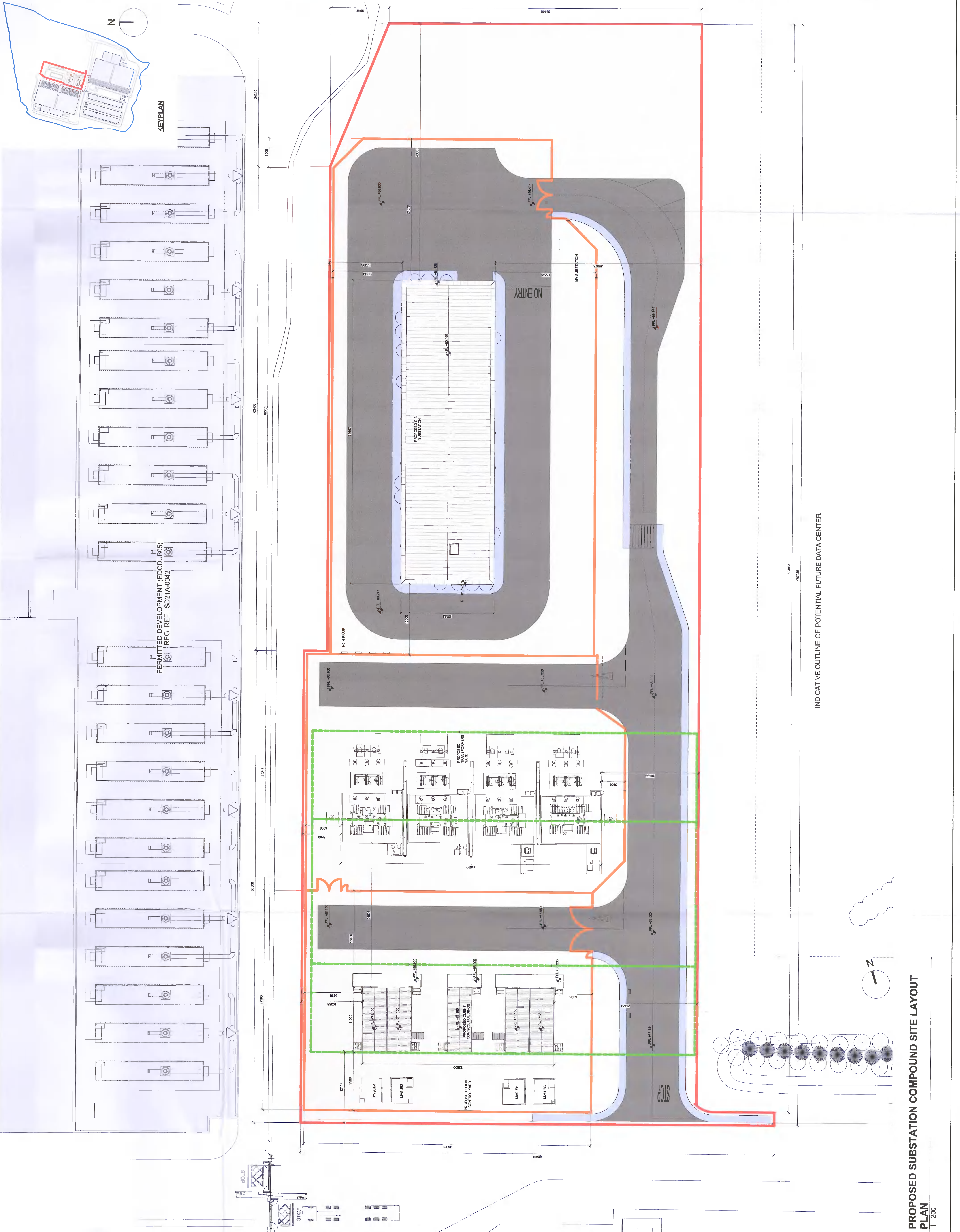

INDICATIVE OUTLINE OF POTENTIAL FUTURE DATA CENTER

PROPOSED SUBSTATION COMPOUND SITE LAYOUT PLAN
 1:200