

FOUL LINE (existing)	-----
SURFACE LINE (existing)	-----
FOUL LINE (proposed)	-----
SURFACE LINE (proposed)	-----
PROPOSED DEMOLITION	-----

ALL CONSTRUCTION WORK TO COMPLY WITH THE CURRENT BUILDING REGULATIONS AND ALL OTHER RELEVANT COMPLIANCE AND SPECIFICATIONS. COMPLIANCE OF SUCH TO BE THE RESPONSIBILITY OF THE BUILDING CONTRACTOR ON SITE OR CLIENT PRIOR TO COMMENCEMENT OF CONSTRUCTION WORK

DEVELOPMENT TO BE BUILT ON THE INSIDE OF THE BOUNDARY, LINE OF THE BOUNDARY TO BE CONFIRMED PRIOR TO CONSTRUCTION BY CONTRACTOR. UNDERPINNING TO ENGINEER'S SPECIFICATION. NO ELEMENT OF THE CONSTRUCTION TO BE ENCROACHING ON THE NEIGHBOUR'S PROPERTY.

DRAINAGE SUBJECT TO SITE INVESTIGATION AND IN ACCORDANCE WITH LOCAL AUTHORITY

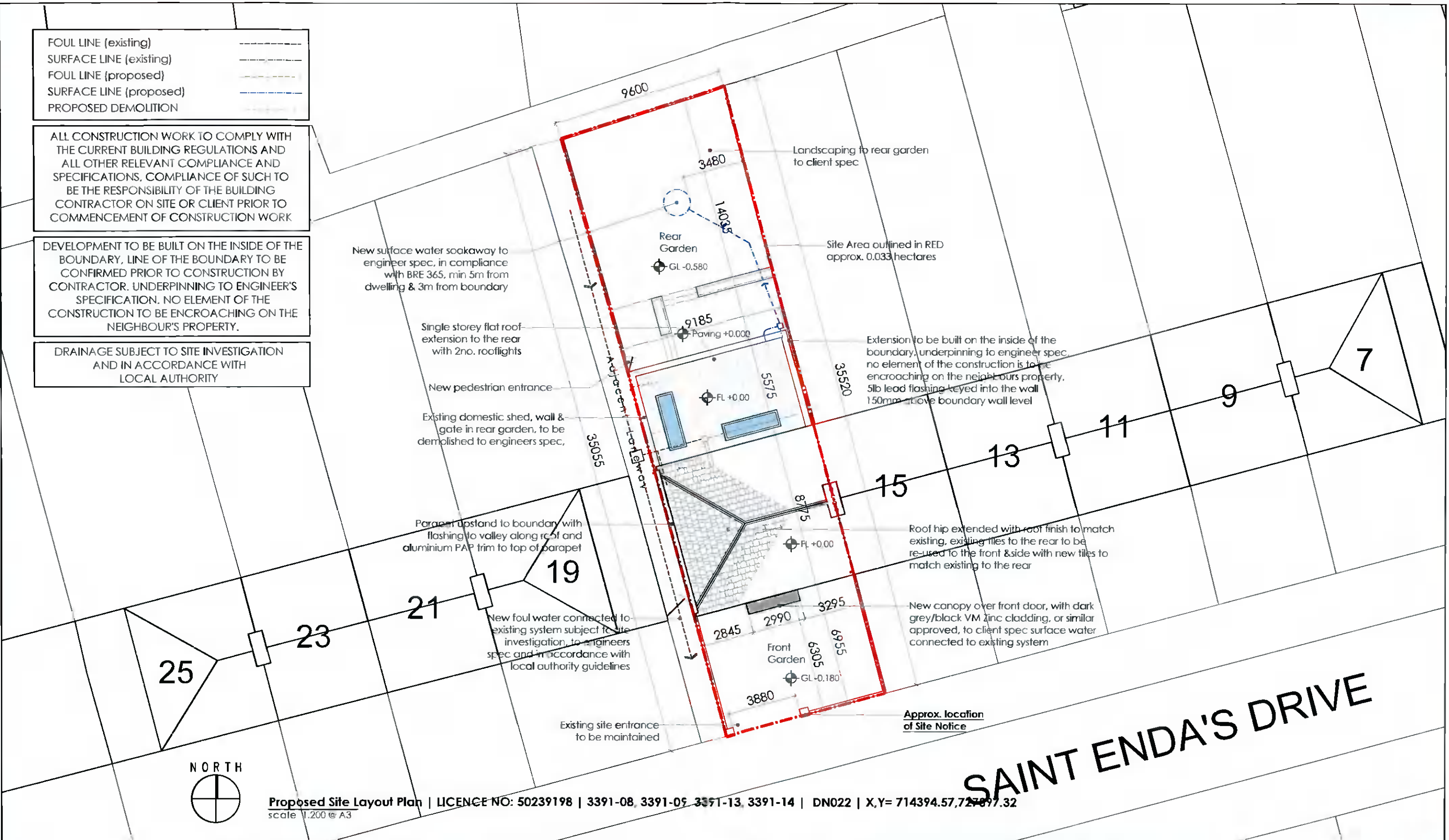

Proposed Site Layout Plan | LICENCE NO: 50239198 | 3391-08, 3391-09, 3391-13, 3391-14 | DN022 | X,Y= 714394.57,727897.32
scale 1:200 @ A3

Client
Tom & Hillary Norton
17 St. Enda's Drive,
Rathfarnham,
Dublin 14,
D14 T2X9.

Revisions



Chartered Institute of Architectural Technologists

STATUS OF DRAWING

PLANNING DRAWING

notes

JOE FALLON DESIGN ARCHITECTURE
First Floor, 6 Main Street, Dundrum, Dublin 14
1A Ryland Street, Buncloody, Enniscorthy, Co. Wexford

P: 01-5143688
M: 087-2566808
F: 053-9377633

A3

project Proposed Extension/Alterations @ 17 St. Enda's Drive
drawing Proposed Site Layout Plan
dwg no. 21055-PP-03

job no. 21055 scale 1:200 date 10.04.22 drawn by DOM checked LK

UNDER THE BUILDING CONTROL ACT 2007, JOE FALLON IS A REGISTERED ASSIGNED CERTIFIER, REG NO. B0244 SCS1

All work to be carried out in accordance with the current Building Regulations and Technical Guidance Documents. These documents take precedence over any dimensions / notes / specifications on these drawings. The contractor / client is to make a thorough inspection of the site and make themselves fully aware of any peculiarities pertaining there to. The contractor is entirely responsible for the proper setting out of works on site. Written dimensions are to be used in preference to scaling. **Contractor / client is to check all dimensions prior to planning stage / construction. Any discrepancies to be reported before work is in hand.** Contractor is deemed to have included for everything required to finish off project to a satisfactory condition though not specifically described on drawings. All work to be supervised and signed off by suitably qualified persons with up to-date insurance and proper Health and Safety. All drainage works to comply with Local Authority Regulations - if in doubt contact Authority. All works must be carried out using proper materials that are fit for the use for which they are intended and for the conditions in which they are to be used; if in doubt, refer to the harmonised technical specifications. All materials and products to be fitted as per manufacturers instructions.