

- NOTES**
- SITE BOUNDARY
 - EXISTING BUILDING
 - EXISTING STRUCTURE TO BE RETAINED
 - PROPOSED NEW WALLS
 - PROPOSED EXTENSION

FF EXTENSION AREA 24.5 SQM
 TOTAL EXTENSION AREA 89.24 SQM

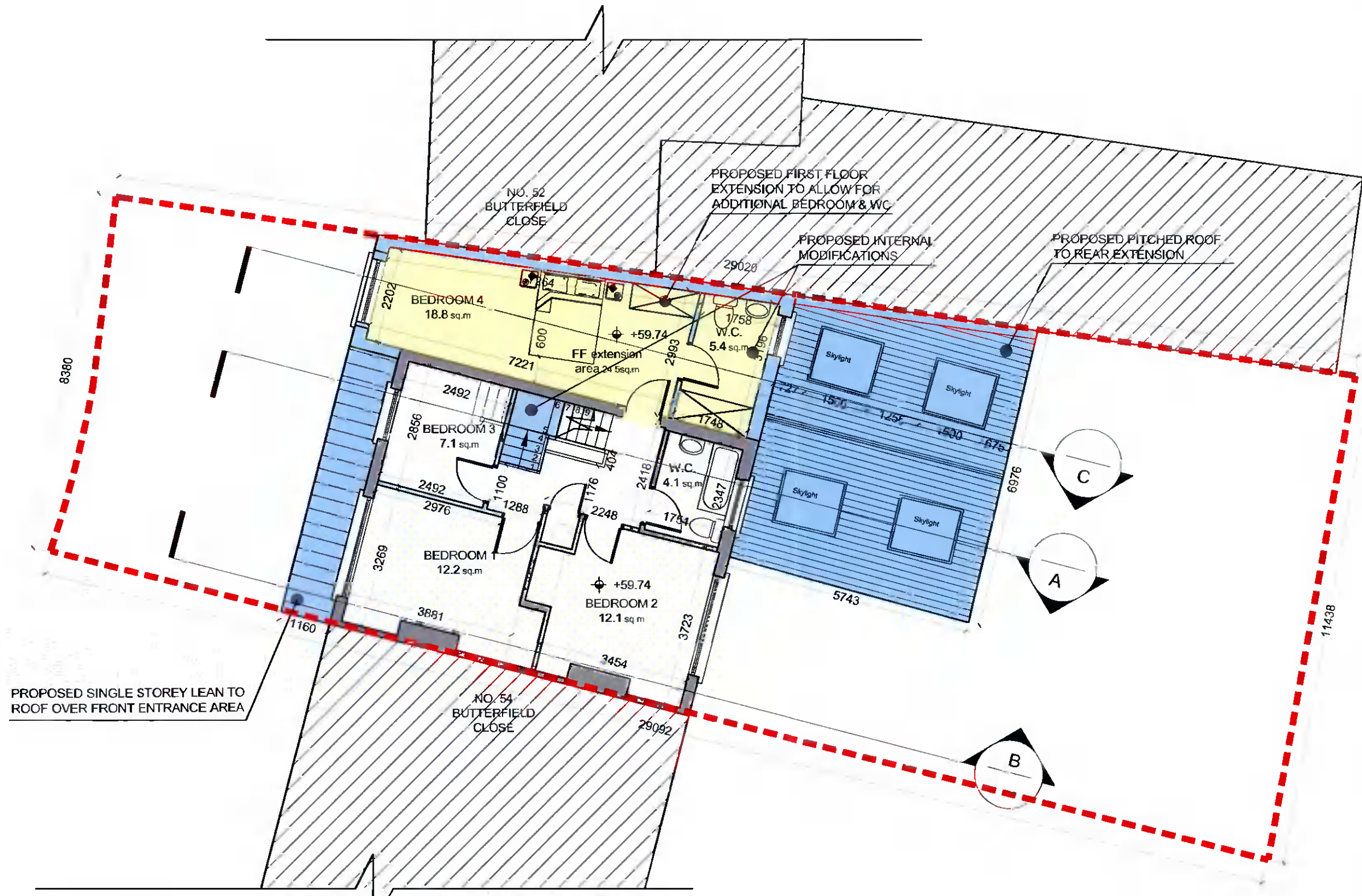

PROPOSED SINGLE STOREY LEAN TO ROOF OVER FRONT ENTRANCE AREA

PROPOSED FIRST FLOOR PLAN
 1:100

REV.	DATE	DESCR. NOTES

DO NOT SCALE FROM THIS DRAWING. USE DIMENSIONS SHOWN IN ALL CASES. VERIFY DIMENSIONS ON SITE AND REPORT ANY DISCREPANCIES TO THE ARCHITECT IMMEDIATELY. THIS DRAWING IS TO BE READ IN CONJUNCTION WITH THE ARCHITECT'S SPECIFICATION.

CDP Architecture
 4 The Mill, Main Street, Liscannor Village, Co. Dublin, K18 V9R5
 T: 01 8216498 E: info@cdparchitecture.ie www.cdp-architecture.com

PLANNING	
JOB	DATE
PROPOSED EXTENSION AT NO. 53 BUTTERFIELD CLOSE EXTENSION RATHFARNHAM, DUBLIN 14	APRIL 2022
CLIENT	DRN
ROISIN & CHRIS CADDEN	KB
DRAWING TITLE	SCALE
PROPOSED FIRST FLOOR PLAN	1:100 @ A3
JOB NUMBER	CHECKED
2021_145	PT
DRAWING NUMBER	REVISION
3 1 201	