

**NOTES:**

- EXISTING STRUCTURE TO BE RETAINED 
- EXISTING STRUCTURE TO BE DEMOLISHED 

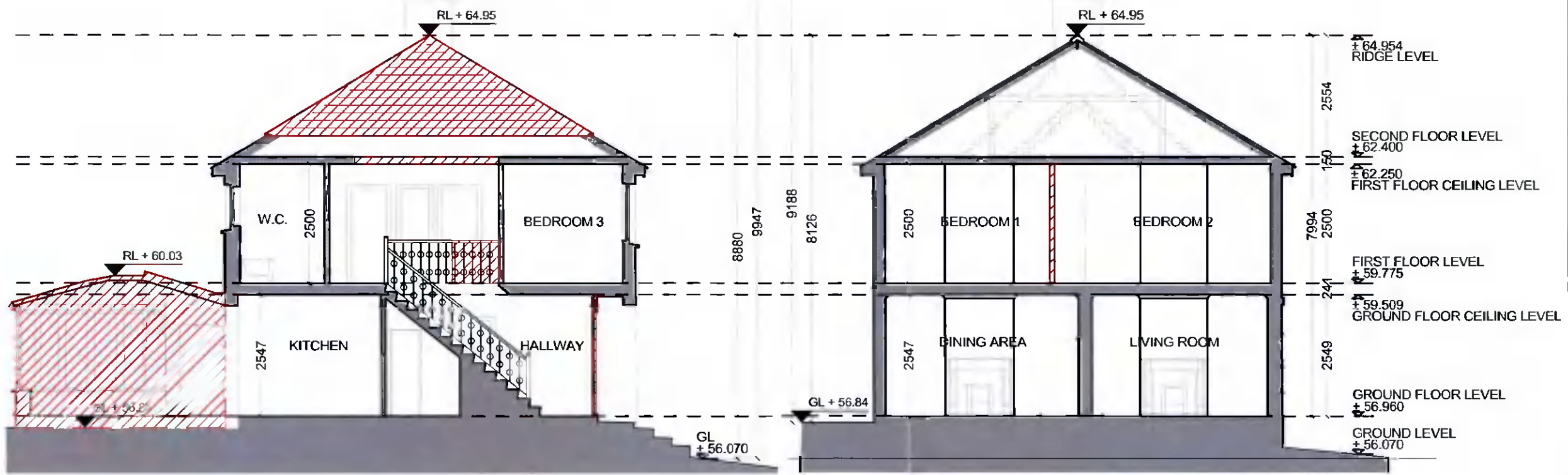

**EXISTING / DEMOLITION SECTION A-A**  
1:100

**EXISTING / DEMOLITION SECTION B-B**  
1:100

NO.	DATE	BY	NOTES

DO NOT SCALE FROM THIS DRAWING. USE FIGURES DIMENSIONED ON DRAWING. VERIFY DIMENSIONS ON SITE AND REPORT ANY DISCREPANCIES TO THE ARCHITECT IMMEDIATELY. THIS DRAWING IS TO BE READ IN CONJUNCTION WITH THE ARCHITECT'S SPECIFICATION. THE DRAWING IS COPYRIGHT AND MAY ONLY BE REPRODUCED WITH THE ARCHITECT'S PERMISSION.

**CDP Architecture**  
6, The Mill, Main Street, Lucan Village, Co. Du. D18 K7B V9R6  
 T: 01 624 8496  
 E: info@cdparchitect.com  
 www.cdp-architect.com

PLANNING	
JOB	DATE
PROPOSED EXTENSION AT No. 53 BUTTERFIELD CLOSE EXTENSION RATHFARNHAM DUBLIN 14	APRIL 2022
CLIENT	DRW
ROISIN & CHRIS CADDEN	KB
DRAWING TITLE	SCALE
EXISTING / DEMOLITION SECTION A-A & B-B	1:100 @ A3
JOB NUMBER	CHECKED
2021_149	PT
DRAWING NUMBER	REVISION
3.1.102	