

157028 (approx site)

BANCROFT PARK

LOCATION OF SITE NOTICE No.4



BANCROFT PARK

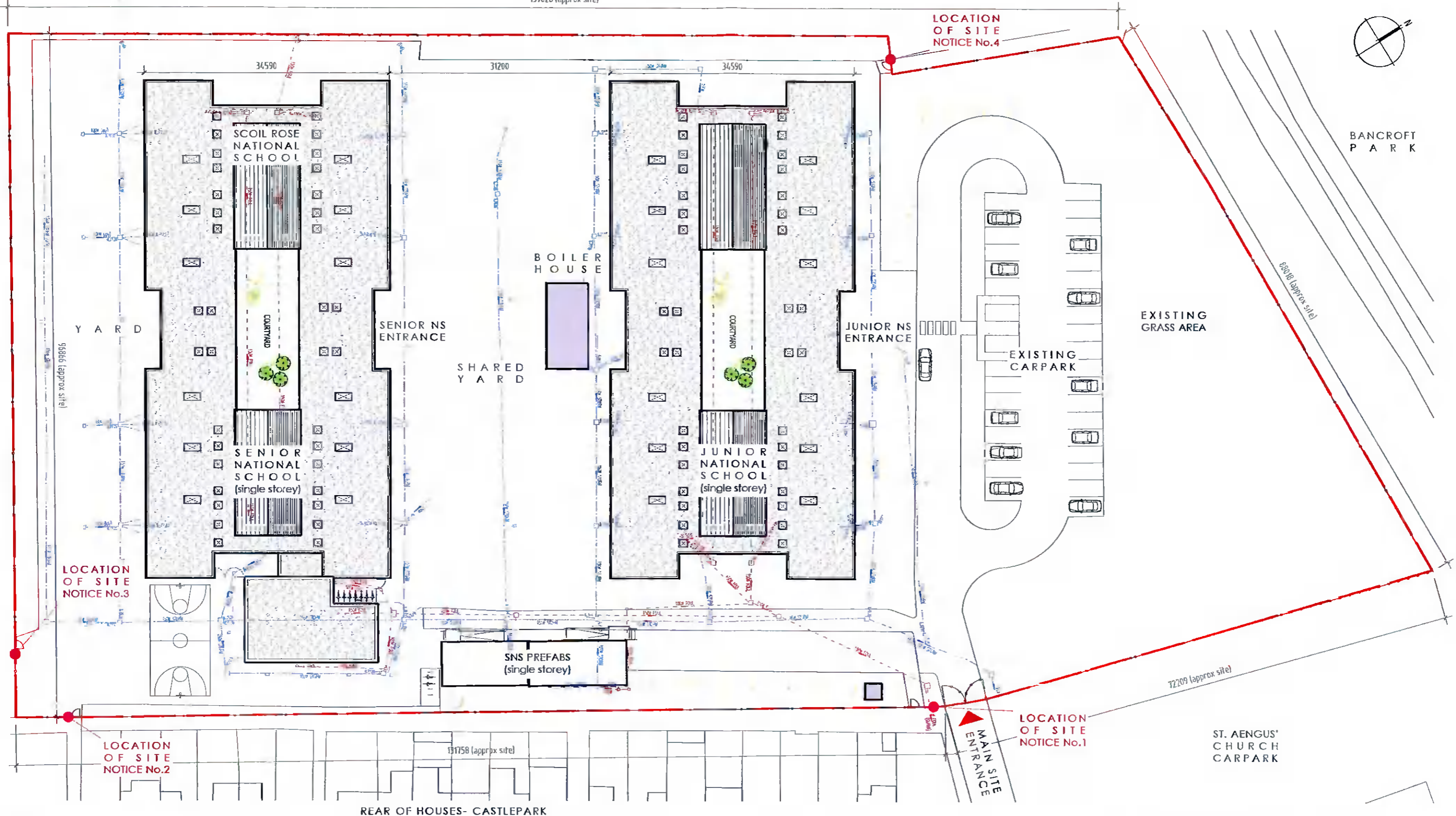

LOCATION OF SITE NOTICE No.3

EXISTING GRASS AREA

EXISTING CARPARK

LOCATION OF SITE NOTICE No.2

LOCATION OF SITE NOTICE No.1

ST. AENGUS' CHURCH CARPARK

REAR OF HOUSES- CASTLEPARK

50m 40m 30m 20m 10m 0m

--- EXISTING FOUL WATER DRAINAGE --- SITE BOUNDARY
 - - - EXISTING SURFACE WATER DRAINAGE SITE AREA: 16.879M2
 1.688 HA / 4.17 AC

PL Site Layout Plan - Existing
 001 Scale 1:500@A3

NOTES	Rev:	Date:	Note:	Initial:
1. Copyright reserved.	A	24.03.2022	Issued for Planning	CT
2. Work to figured dimensions only. Do not scale drawing.				
3. The Contractor is responsible for checking all levels and dimensions on site and shall refer all discrepancies to the Architect.				
4. All Proprietary items / sizes / components / fittings shall be fixed in strict accordance with the Manufacturers Instructions.				
5. It will be the obligation of the Contractor to ensure that the whole of the works comply with the Current Building Regulations.				
6. Contractor shall ensure that all materials specified and/or used under the Contract are fit for the purpose for which they will be used.				
7. Any variations to this drawing, or other instructions, agreed verbally by the Architect shall be confirmed in writing by the Contractor within 7 days.				

Initial: CT

QUINN BARNWALL BUGGY
 architecture · conservation · planning · consultancy

Project: Temporary Accommodation to Scoil Aonghusa Campus, Balrothery, Dublin 24

Client: Board of Management Scoil Aonghusa

Job No: 2910 **Dwg No:** 2910-PL-001-A
Drawn: CT **Scale:** 1:500 @ A3
Status: Planning **Date:** 24.03.2022