

NOTES

1. THIS DRAWING IS TO BE READ IN CONJUNCTION WITH ALL ENGINEERS & ARCHITECT'S DRAWINGS. FIGURED DIMENSIONS ONLY (NOT SCALING) TO BE USED. WHERE A CONFLICT OF INFORMATION EXISTS OR IF IN ANY DOUBT - ASK.
2. CONSULTANTS TO BE INFORMED IMMEDIATELY OF ANY DISCREPANCIES BEFORE WORK PROCEEDS.

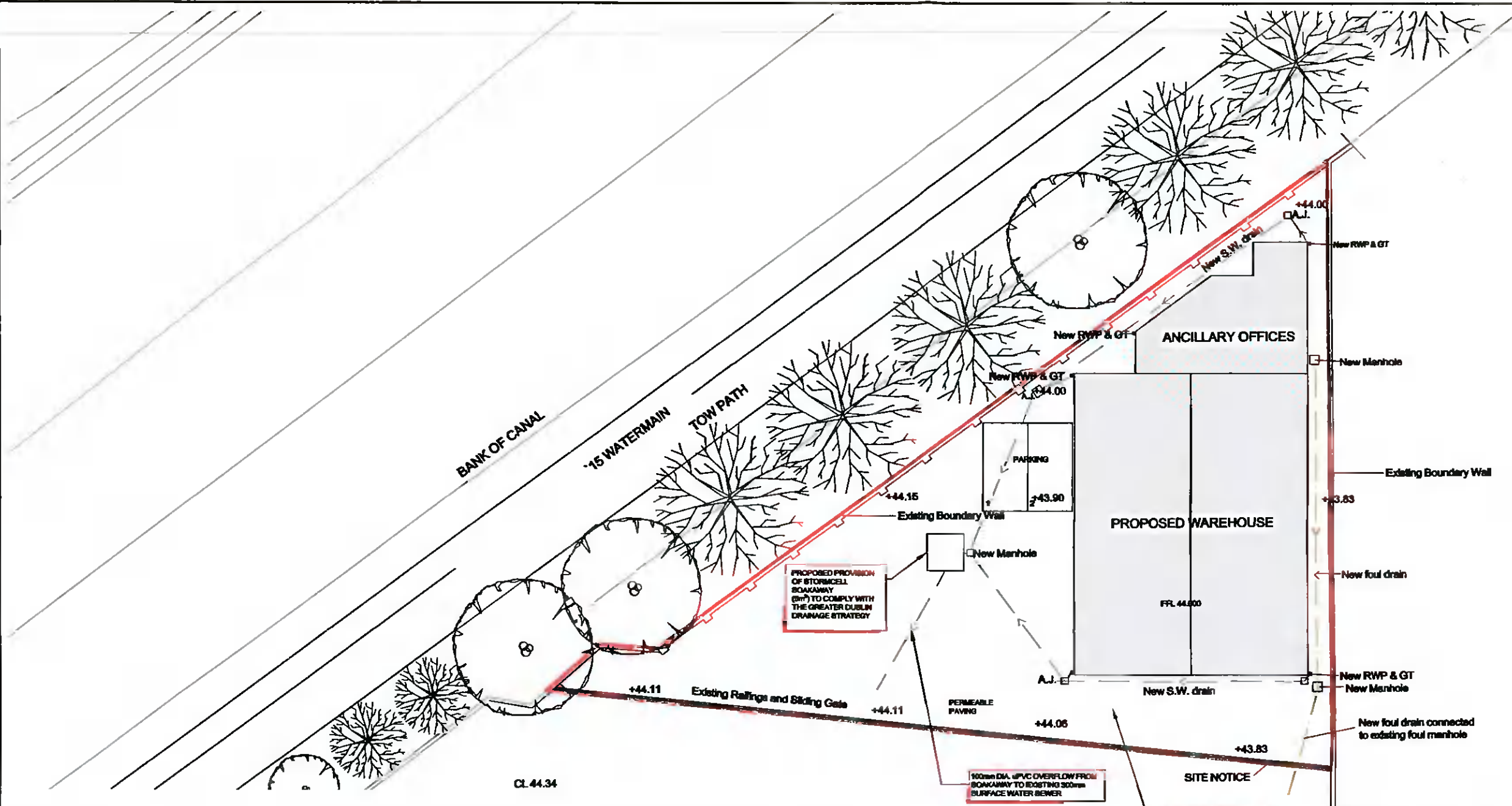
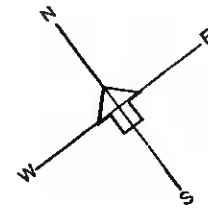

**LEGEND:**

- INDICATES PROPOSED SURFACE WATER DRAIN
- INDICATES PROPOSED SURFACE WATER ACCESS CHAMBER
- INDICATES PROPOSED GULLY TRAP
- INDICATES PROPOSED RAIN WATER PIPE
- INDICATES PROPOSED BACK SILET GULLY TRAP
- M.H. INDICATES PROPOSED SURFACE WATER MANHOLE
- INDICATES EXISTING SURFACE WATER DRAIN
- M.H. INDICATES EXISTING SURFACE WATER MANHOLE
- INDICATES EXISTING SURFACE WATER ACCESS CHAMBER
- INDICATES PROPOSED FOUL SEWER
- INDICATES PROPOSED FOUL MANHOLE
- INDICATES PROPOSED FOUL ACCESS CHAMBER
- INDICATES EXISTING COMBINED SEWER
- INDICATES EXISTING WATERMAIN
- INDICATES EXISTING FOUL SEWER
- M.H. INDICATES EXISTING FOUL MANHOLE
- INDICATES EXISTING FOUL ACCESS CHAMBER
- S.W.P. INDICATES EXISTING SOIL VENT PIPE
- INDICATES PROPOSED STORMWATER MODULES
- INDICATES PROPOSED ADDO DRAIN
- SITE BOUNDARY
- INDICATES EXISTING WATERMAIN
- INDICATES PROPOSED WATERMAIN
- INDICATES PROPOSED SILICE VALVE
- INDICATES PROPOSED HYDRANT
- INDICATES PROPOSED WATER METER

ALL NEW SURFACE TO BE 150mm UPVC PIPE @ 1/200

ALL NEW FOUL TO BE 150mm UPVC PIPE @ 1/60

ALL WORKMANSHIP & MATERIALS TO BE IN ACCORDANCE WITH 'CODE OF PRACTICE FOR DEVELOPMENT WORKS-DRAINAGE' AS PUBLISHED BY DUBLIN CORPORATION JANUARY 1988

All Levels To Be Checked on Site Prior To Commencement of Drainage Works

**NOTE:**  
POSITION AND LEVELS OF EXISTING DRAINAGE TO BE DETERMINED ON SITE BEFORE COMMENCEMENT OF WORKS

R.P.I. REV. 08.04.22		
REV.	DESCRIPTION	DATE
<b>ARCHITECT</b> Roger Cagney Chartered Civil & Structural Engineers Rose House, 124 Ballydoyle Ind. Est., Dublin 13.		
PHONE (01) 8320755 FAX (01) 8320274 e-mail Engineering@roce.ie		
<b>CLIENT</b> J TAYLOR ARCHITECT LTD		
<b>PROJECT</b> PROPOSED WAREHOUSE ON SITE BLUEBELL AVENUE, BLUEBELL IND. ESTATE DUBLIN 12		
<b>DRG. TITLE</b> DRAINAGE SCHEME— SURFACE WATER SOAKAWAY		
<b>DRAWN BY</b> C.B.	<b>SCALE</b> A3 @ 1:100	<b>DATE</b> 08.04.22
<b>CHECKED BY</b> R.C.	<b>DATE</b> 08.04.22	
<b>DRG. NO.</b> 22/2061/01		

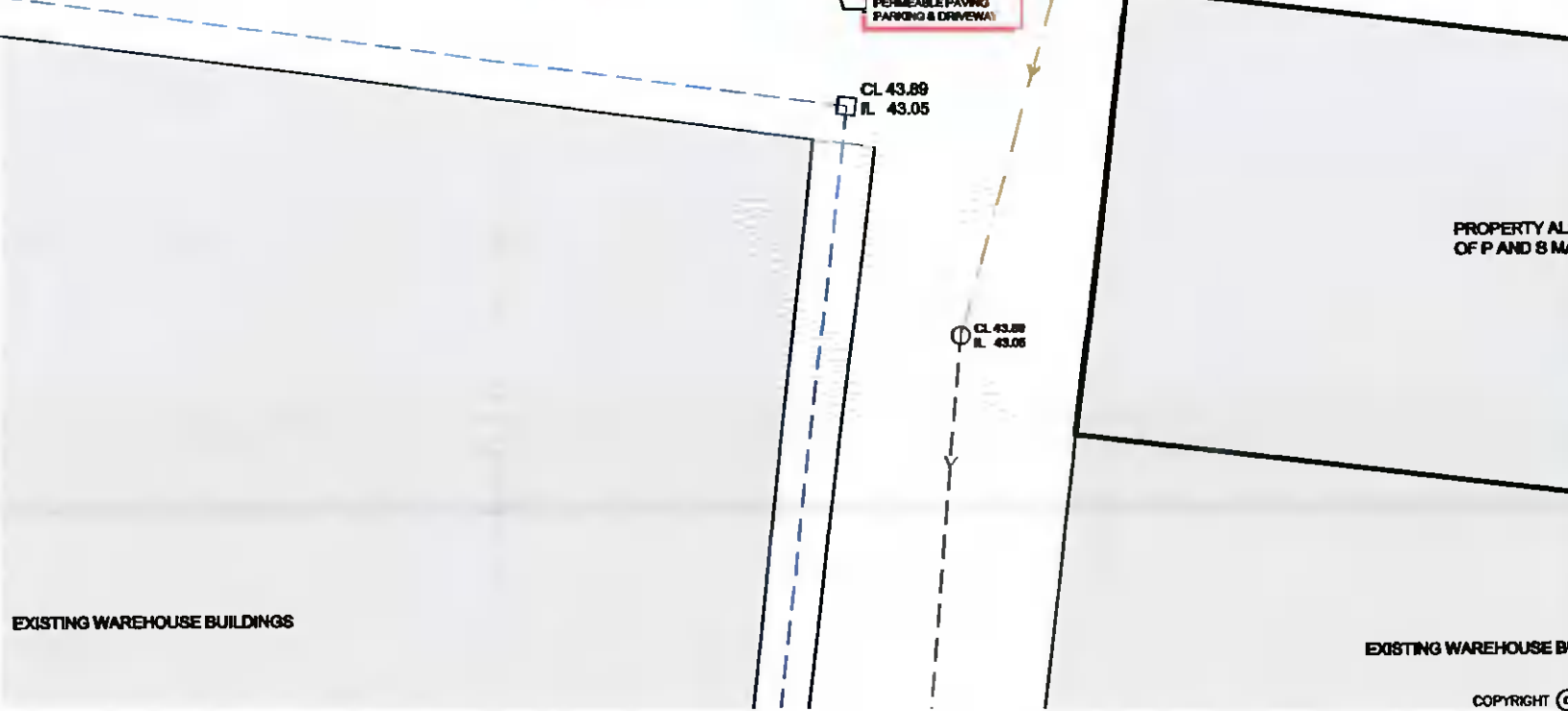

COPYRIGHT ©