

ORANGE SURVEY IRELAND LIMITED
155, WINDY LANE, CO. DUBLIN 15

DATE	15/05/2023	SCALE	AS SHOWN
DRAWN	DM	CHECKED	DM
DATE	15/05/2023	SCALE	AS SHOWN

ORANGE SURVEY IRELAND LIMITED
155, WINDY LANE, CO. DUBLIN 15

CONSULTANTS
DBFL Consulting Engineers
107, WINDY LANE, CO. DUBLIN 15

PROJECT
WAREHOUSING / LOGISTICS & OFFICES
AT CAULMOUNT ROAD, BALLYMOUNT

DRAWN BY
SURFACE WATER LAYOUT

DATE

BLACKWILL LIMITED

23/01/23-DBFL-SW-DR-C-1300 - P01

LEGEND

PROPOSED	PROPOSED SURFACE WATER DRAIN
PROPOSED	SURFACE WATER CHASSEL
PROPOSED	SURFACE WATER CHASSEL WITH MANHOLE
PROPOSED	PETROL INTERCEPTOR
PROPOSED	RETENTION AREA
PROPOSED	PERMANENT PAVING
PROPOSED	RAIN GARDEN
PROPOSED	PERMEABLE PAVING
PROPOSED	PERMEABLE PAVING WITH SAND
PROPOSED	PERMEABLE PAVING WITH SAND AND GEOTEXTILE
PROPOSED	PERMEABLE PAVING WITH SAND AND GEOTEXTILE AND SAND
PROPOSED	PERMEABLE PAVING WITH SAND AND GEOTEXTILE AND SAND AND GRANULAR FILL
PROPOSED	PERMEABLE PAVING WITH SAND AND GEOTEXTILE AND SAND AND GRANULAR FILL AND SAND
PROPOSED	PERMEABLE PAVING WITH SAND AND GEOTEXTILE AND SAND AND GRANULAR FILL AND SAND AND GRANULAR FILL AND SAND
PROPOSED	PERMEABLE PAVING WITH SAND AND GEOTEXTILE AND SAND AND GRANULAR FILL AND SAND AND GRANULAR FILL AND SAND AND GRANULAR FILL

NOTES

1. ALL PROPOSED SURFACE WATER DRAINAGE SYSTEMS SHALL BE DESIGNED TO COMPLY WITH THE REQUIREMENTS OF S.I. 106 (2001) AND S.I. 107 (2001).
2. THE PROPOSED SURFACE WATER DRAINAGE SYSTEM SHALL BE DESIGNED TO HANDLE THE MAXIMUM ANTICIPATED RAINFALL RATE AS DETERMINED BY THE METEOROLOGICAL SERVICE OF IRELAND (MSI).
3. THE PROPOSED SURFACE WATER DRAINAGE SYSTEM SHALL BE DESIGNED TO HANDLE THE MAXIMUM ANTICIPATED RAINFALL RATE AS DETERMINED BY THE METEOROLOGICAL SERVICE OF IRELAND (MSI).
4. THE PROPOSED SURFACE WATER DRAINAGE SYSTEM SHALL BE DESIGNED TO HANDLE THE MAXIMUM ANTICIPATED RAINFALL RATE AS DETERMINED BY THE METEOROLOGICAL SERVICE OF IRELAND (MSI).
5. THE PROPOSED SURFACE WATER DRAINAGE SYSTEM SHALL BE DESIGNED TO HANDLE THE MAXIMUM ANTICIPATED RAINFALL RATE AS DETERMINED BY THE METEOROLOGICAL SERVICE OF IRELAND (MSI).
6. THE PROPOSED SURFACE WATER DRAINAGE SYSTEM SHALL BE DESIGNED TO HANDLE THE MAXIMUM ANTICIPATED RAINFALL RATE AS DETERMINED BY THE METEOROLOGICAL SERVICE OF IRELAND (MSI).
7. THE PROPOSED SURFACE WATER DRAINAGE SYSTEM SHALL BE DESIGNED TO HANDLE THE MAXIMUM ANTICIPATED RAINFALL RATE AS DETERMINED BY THE METEOROLOGICAL SERVICE OF IRELAND (MSI).
8. THE PROPOSED SURFACE WATER DRAINAGE SYSTEM SHALL BE DESIGNED TO HANDLE THE MAXIMUM ANTICIPATED RAINFALL RATE AS DETERMINED BY THE METEOROLOGICAL SERVICE OF IRELAND (MSI).
9. THE PROPOSED SURFACE WATER DRAINAGE SYSTEM SHALL BE DESIGNED TO HANDLE THE MAXIMUM ANTICIPATED RAINFALL RATE AS DETERMINED BY THE METEOROLOGICAL SERVICE OF IRELAND (MSI).
10. THE PROPOSED SURFACE WATER DRAINAGE SYSTEM SHALL BE DESIGNED TO HANDLE THE MAXIMUM ANTICIPATED RAINFALL RATE AS DETERMINED BY THE METEOROLOGICAL SERVICE OF IRELAND (MSI).
11. THE PROPOSED SURFACE WATER DRAINAGE SYSTEM SHALL BE DESIGNED TO HANDLE THE MAXIMUM ANTICIPATED RAINFALL RATE AS DETERMINED BY THE METEOROLOGICAL SERVICE OF IRELAND (MSI).
12. THE PROPOSED SURFACE WATER DRAINAGE SYSTEM SHALL BE DESIGNED TO HANDLE THE MAXIMUM ANTICIPATED RAINFALL RATE AS DETERMINED BY THE METEOROLOGICAL SERVICE OF IRELAND (MSI).
13. THE PROPOSED SURFACE WATER DRAINAGE SYSTEM SHALL BE DESIGNED TO HANDLE THE MAXIMUM ANTICIPATED RAINFALL RATE AS DETERMINED BY THE METEOROLOGICAL SERVICE OF IRELAND (MSI).
14. THE PROPOSED SURFACE WATER DRAINAGE SYSTEM SHALL BE DESIGNED TO HANDLE THE MAXIMUM ANTICIPATED RAINFALL RATE AS DETERMINED BY THE METEOROLOGICAL SERVICE OF IRELAND (MSI).
15. THE PROPOSED SURFACE WATER DRAINAGE SYSTEM SHALL BE DESIGNED TO HANDLE THE MAXIMUM ANTICIPATED RAINFALL RATE AS DETERMINED BY THE METEOROLOGICAL SERVICE OF IRELAND (MSI).
16. THE PROPOSED SURFACE WATER DRAINAGE SYSTEM SHALL BE DESIGNED TO HANDLE THE MAXIMUM ANTICIPATED RAINFALL RATE AS DETERMINED BY THE METEOROLOGICAL SERVICE OF IRELAND (MSI).
17. THE PROPOSED SURFACE WATER DRAINAGE SYSTEM SHALL BE DESIGNED TO HANDLE THE MAXIMUM ANTICIPATED RAINFALL RATE AS DETERMINED BY THE METEOROLOGICAL SERVICE OF IRELAND (MSI).

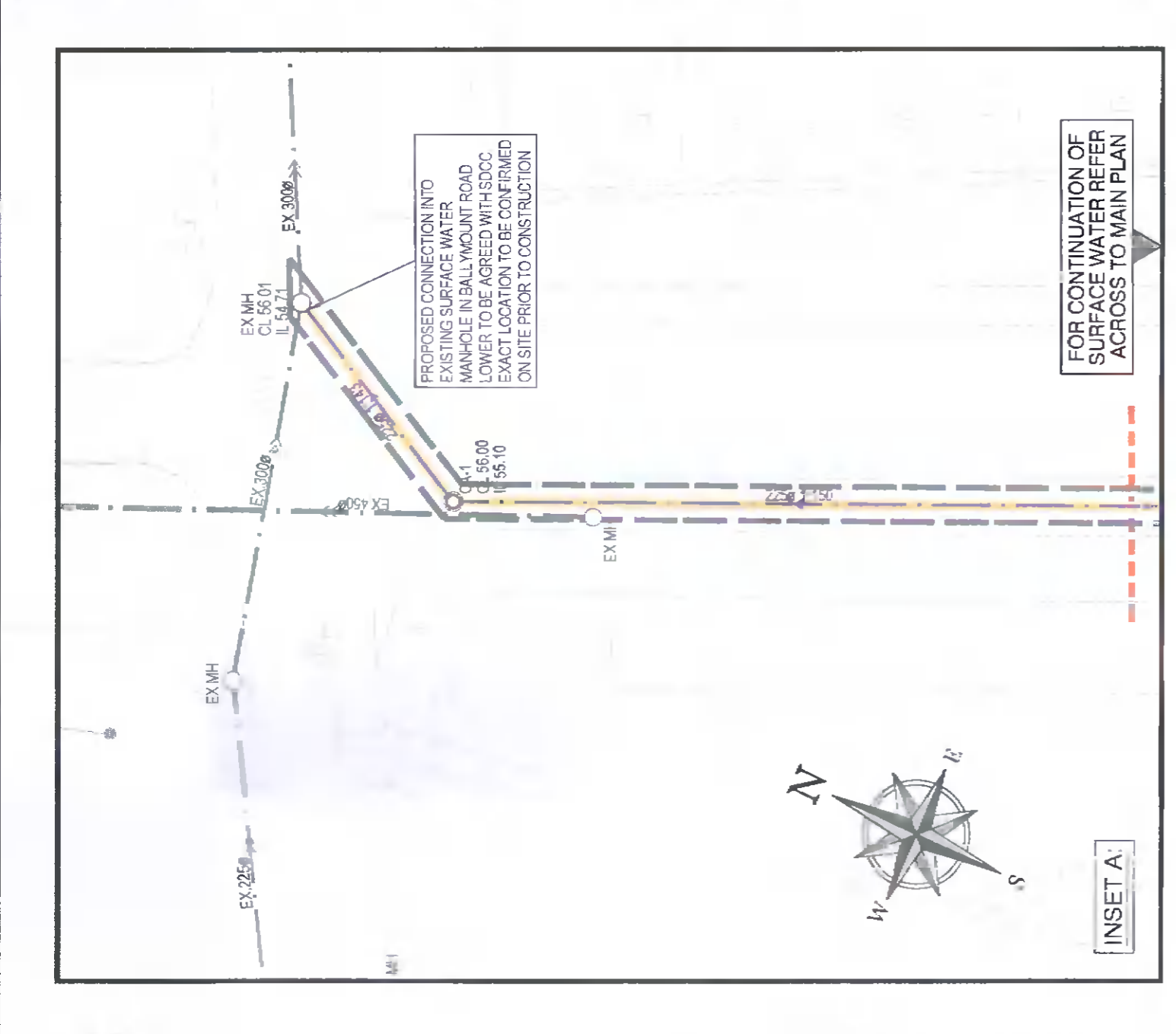

FOR CONTINUATION OF SURFACE WATER LAYOUT TO MAIN PLAN