

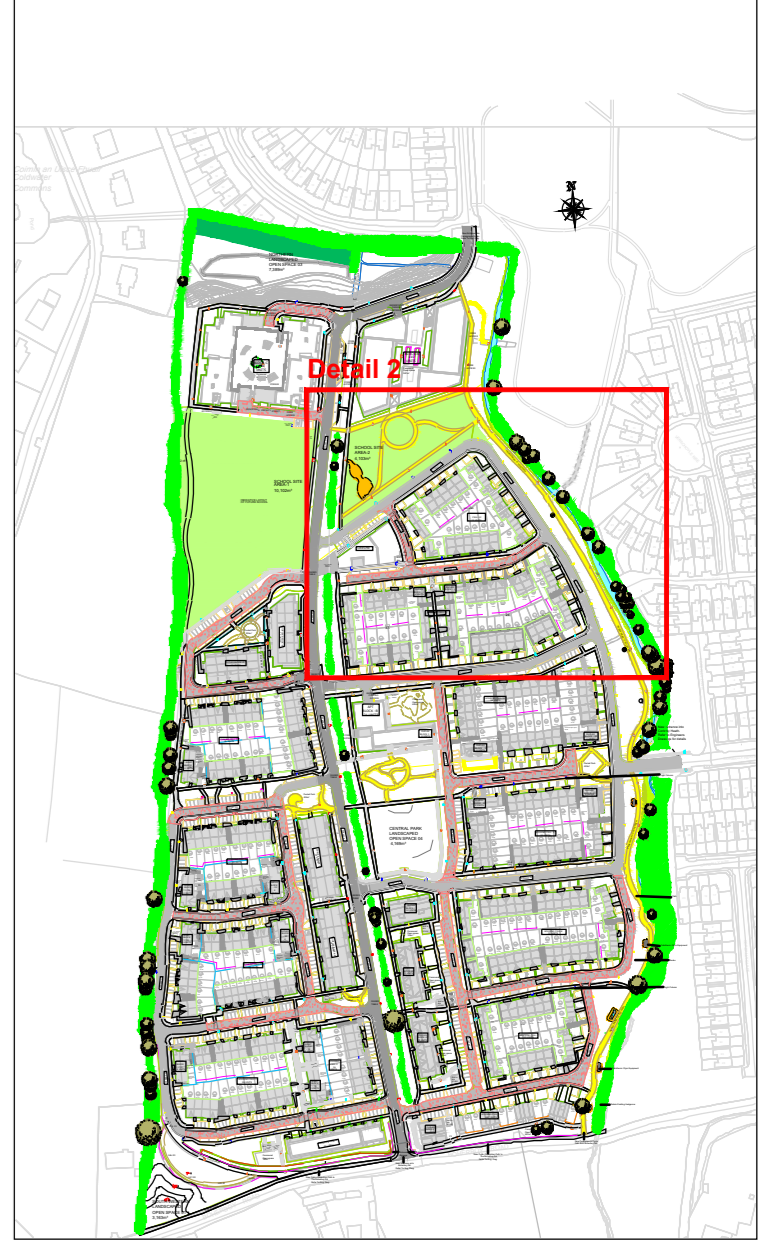

Overall Site Plan



Proposed Trees

No.	Name	Size
T1	Amelanchier lamarckii	150cm
T2	Betula pendula	12-14cm
T3	Betula pendula 'Multi Stem'	200cm
T4	Malus 'John Downie'	12-14cm
T5	Cornus rogersiana	150cm
T6	Acer glabrum 'Multi Stem'	200cm
T7	Rhus typhina	150cm
T8	Prunus avium	14-16cm
T9	Prunus avium 'Prayer'	14-16cm
T10	Prunus avium 'Candy'	14-16cm
T11	Fila cordata 'Grenadier'	14-16cm
T12	Acer glabrum	14-16cm
T13	Acer campestre 'Emerald Queen'	14-16cm
T14	Acer campestre 'Flora Sorbus'	14-16cm
T15	Corylus avellana	18-20cm
T16	Corylus avellana	14-16cm
T17	Salix alba	12-14cm

Open Space Trees

No.	Name	Size
O1	Quercus robur	18-20cm
O2	Quercus petraea	18-20cm
O3	Fagus sylvatica	18-20cm
O4	Agilantia regia	18-20cm
O5	Pinus sylvestris	200cm
O6	Abies balsamea	200cm
O7	Thuja occidentalis	12-14cm
O8	Thuja occidentalis	18-20cm
O9	Thuja occidentalis	18-20cm
O10	Salix alba	12-14cm

Shrub Planting

No.	Name	Size
S1	Asarabacca	2.2m
S2	Asarabacca	2.2m
S3	Bergenia ciliolata	2.2m
S4	Hypericum androsaemum	2.2m
S5	Lythrum salicaria	2.2m
S6	Libertia grandiflora	2.2m
S7	Panicum alopecuroides	2.2m
S8	Rosmarinus 'Prostratus'	2.2m
S9	Prunus laurocerasus	2.2m
S10	Prunus 'Oto Layton'	2.2m

- Suggested Wild-Flower Mix**
- Common knapweed *Centaurea nigra*
 - Ribwort plantain *Plantago lanceolata*
 - Red clover *Trifolium pratense*
 - Bird's-foot trefoil *Lotus corniculatus*
 - Bulbous buttercup *Ranunculus bulbosus*
 - Meadow buttercup *Ranunculus acris*
 - Lady's-bedstraw *Galium verum*
 - Cowslip *Primula veris*
 - Oxeye daisy *Leucanthemum vulgare*
 - Common sorrel *Rumex acetosa*
 - Yellow rattle *Rhinanthus minor*
 - Burnt saxifrage *Pimpinella saxifraga*
 - Autumn hawkbit *Leontodon autumnalis*
 - Rough hawkbit *Leontodon hispidus*
- Suggested Lowland Meadow Grasses**
- Created dog-tail *Cynosurus cristatus*
 - Common bent *Agrostis capillaris*
 - Sweet vernal-grass *Anthoxanthum odoratum*
 - Red fescue *Festuca rubra*
 - Smooth meadow-grass *Poa pratensis*
- PROPOSED MARGINAL PLANTING**
- The following marginal plants are to be certified native origin, to be collected as either seed or rootstock from the wild & introduced into the wetland area Stream Area.
- Yellow flag iris (*Iris pseudacorus*),
 - Marsh marigold (*Calitha palustris*),
 - Water plantain (*Alisma plantago-aquatica*),
 - Water forget-me-not (*Myosotis scorpioides*),
 - Brooklime (*Veronica beccabunga*),
 - Bogbean (*Menyanthes trifoliata*),
 - Ragged robin (*Lychnis flos-cuculi*).
- Suggested Wetland/Marsh Mix**
- Marsh bedstraw *Galium palustre*
 - Greater bird's-foot trefoil *Lotus pedunculatus*
 - Sneezewort *Achillea ptarmica*
 - Valerian *Valeriana officinalis* (tall)
 - Purple loosestrife *Lythrum salicaria* (tall)
 - Hemp-agrimony *Eupatorium cannabinum* (tall)
 - Marsh violet *Viola palustris*
 - Angelica *Angelica sylvestris* (tall)
 - Water mint *Mentha aquatica*
 - Marsh marigold *Calitha palustris*
 - Ragged robin *Lychnis flos-cuculi*
 - Cowslip *Primula veris*
 - Meadowsweet *Filipendula ulmaria* (tall)
- PROPOSED GRASSLAWN AREAS**
- AMENITY LAWN MIX:
 - 20% Perennial Ryegrass 'Jessica'
 - 35% Perennial Ryegrass 'Evita'
 - 20% Strong Creeping Red Fescue
 - 10% Chewings Fescue
 - 10% Slender Creeping Red Fescue
 - 5% Broadleaf Bent
 - at 35-50g/square metre.

SOFT LANDSCAPE TREATMENTS

- PROPOSED SMALLER TREES
- PROPOSED STREET TREE
- PROPOSED OPENSPACE TREE
- PROPOSED HEDGE
- PROPOSED MARGINAL PLANTING
- PROPOSED PRIVATE GRASS AREAS
- PROPOSED SHRUB PLANTING
- PROPOSED PUBLIC OPEN SPACE
- PROPOSED COMMUNAL OPEN SPACE
- WILDFLOWER MEADOW MIX
- Wild Planting
- Marginal Planting
- Proposed Swales
- Proposed Hedgerows

HARD LANDSCAPE TREATMENTS

- SURFACE TREATMENT 1: Main Distributor Road - Tarmac/Asphalt
- SURFACE TREATMENT 2: Secondary Roads - Tarmac/Asphalt
- SURFACE TREATMENT 3: Play Areas - Tarmac/Asphalt
- SURFACE TREATMENT 4: Foot Paths - Concrete
- SURFACE TREATMENT 5: Fertilizer Concrete Area to Create Pedestrian Priority
- SURFACE TREATMENT 6: Concrete/Gravel/Grass Paving
- SURFACE TREATMENT 7: Concrete/Gravel/Grass Paving
- SURFACE TREATMENT 8: Concrete/Gravel/Grass Paving
- SURFACE TREATMENT 9: Concrete/Gravel/Grass Paving
- SURFACE TREATMENT 10: Concrete/Gravel/Grass Paving
- SURFACE TREATMENT 11: Concrete/Gravel/Grass Paving
- SURFACE TREATMENT 12: Concrete/Gravel/Grass Paving

M1 - Hedgerow Planting Detail

Hedge mix: 60-80cm 20%

100% Prunus laurocerasus or Hedges & other trees or similar approved

2 rows @ 500mm centres - 400mm apart.

M2 - Hedgerow Planting Detail

Hedge mix: 60-80cm 20%

Crataegus monogyna, Prunus spinosa, Ilex aquifolium

2 rows @ 500mm centres - 400mm apart.

BOUNDARY TREATMENTS

- BOUNDARY TREATMENT 1: 2m High Fenced Block with Chain Link and 500mm Spacing
- BOUNDARY TREATMENT 2: 2m High Fenced Block with Chain Link and 500mm Spacing
- BOUNDARY TREATMENT 3: 1.8m High Concrete Block & Panel or Similar Approved
- BOUNDARY TREATMENT 4: 1.8m High Concrete Block & Panel or Similar Approved
- BOUNDARY TREATMENT 5: 2m High Fenced Block with Chain Link and 500mm Spacing
- BOUNDARY TREATMENT 6: 2m High Fenced Block with Chain Link and 500mm Spacing

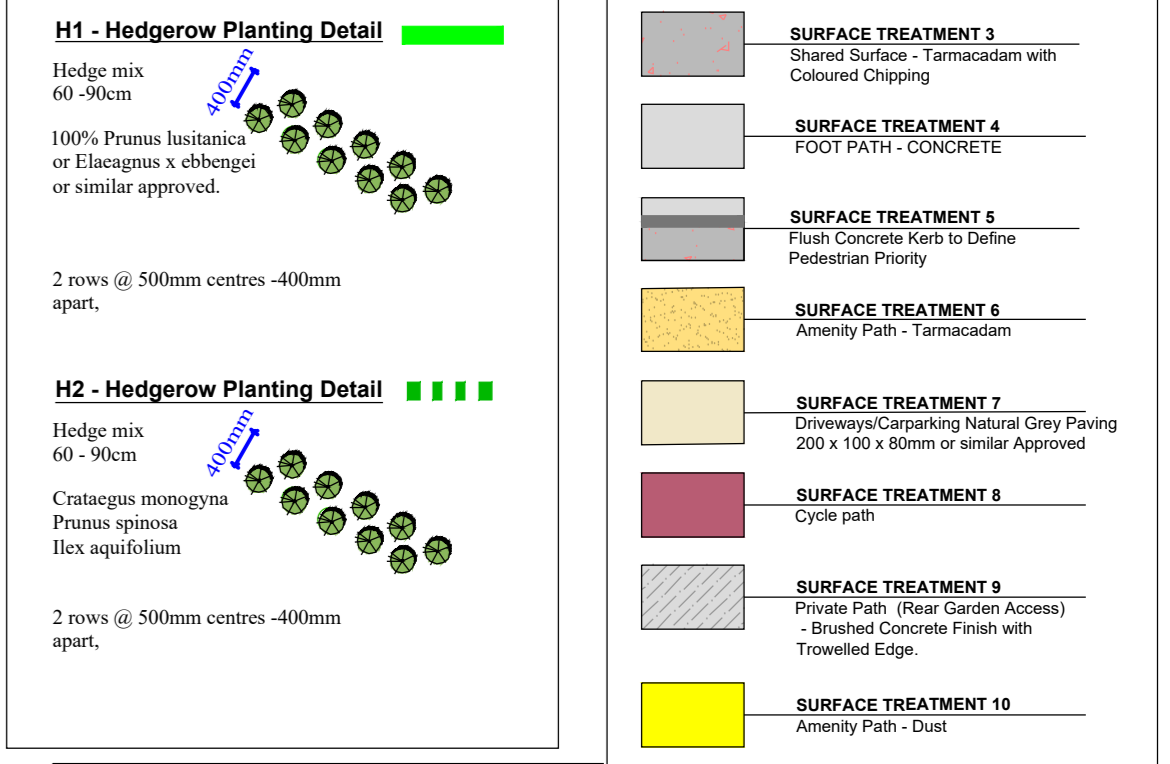

Revisions:

REV	DATE	BY	DESCRIPTION
A	25.05.2021	AMT	Revisions from Architects & Engineers
B	27.07.2021	AMT	Revisions from Architects, Engineers & Lighting

Project Title: Proposed Residential Development at Boherboy, Co. Dublin

Client: Kelland Homes Ltd & Durkan Estates Ireland Ltd.

Drawing Title: Detail 2 Kelland - Housing & Riverside Park

Job No: 1532

Scale: 1:250 @ A0

Date: 28.04.2021

Drawing by: AMT

Checked by: RMD

Ronan MacDiarmada + Associates Ltd.
Landscape Architects and Consultants.
5 Tooterhill, Rathcoole, Co. Dublin
tel: +353 1 412 4476
fax: +353 1 401 3748
mob: 086 26 25 438
e-mail: ronan@rmda.ie

This Drawing is Copyright

