

- NOTES:**
- Read this drawing in conjunction with all other relevant Engineers and Architects drawings.
 - Do not scale this drawing. Use only written dimensions.
 - Do not set out from this drawing unless specifically confirmed by the Engineers beforehand.
 - All levels shown are to Mean Head datum (mOD).
 - The contractor is to check all service connections before commencing any site development works.
 - The Engineer is to be informed of discrepancies that may arise before the contractor commences any site development works, if in doubt - ask!
 - All watermains to be in accordance with the Irish Water Infrastructure Code of Practice (IW CoP) for Water Infrastructure and in accordance with the Irish Water Infrastructure Standard Details (Rev.3).
 - All pipe materials to be in accordance with Section 3.9 the IW CoP as follows:
 Pipe Ø 100-150mm - HDPE, MDPE (PE80) and DI
 Pipe Ø 200-300mm - HDPE (PE-100), HDPE, MDPE (PE-80) and DI
 PE pipes to have an SDR rating of 11 or 17 and be compliant with ISEN 1220 Part 1, 2 and 3 for plastic pipes and fittings under pressure.
 DI pipes to have a C40 pressure rating, with 16 bar fittings and be in compliance with IS EN 545.
 - Bulk meter and chamber to be agreed with DLRCO before construction commences.
 - Domestic and non-domestic meters will be supplied and installed by Irish Water.

DETAIL TYPE	IW STANDARD DETAILS (Rev03)
Hydrant Chambers	STD-W-18
Thrust Blocks	STD-W-28
Bulk Water Meter	STD-W-26
Air Valve	STD-W-22
Sluice Valve	STD-W-15
Bedding/backfilling	STD-W-13
Boundary Connection	STD-W-03
Marker Plates	STD-W-27
Scour Valve	STD-W-30

THIS IS A PLANNING DRAWING AND HAS BEEN APPROVED BY THE IRISH WATER CDS SECTION

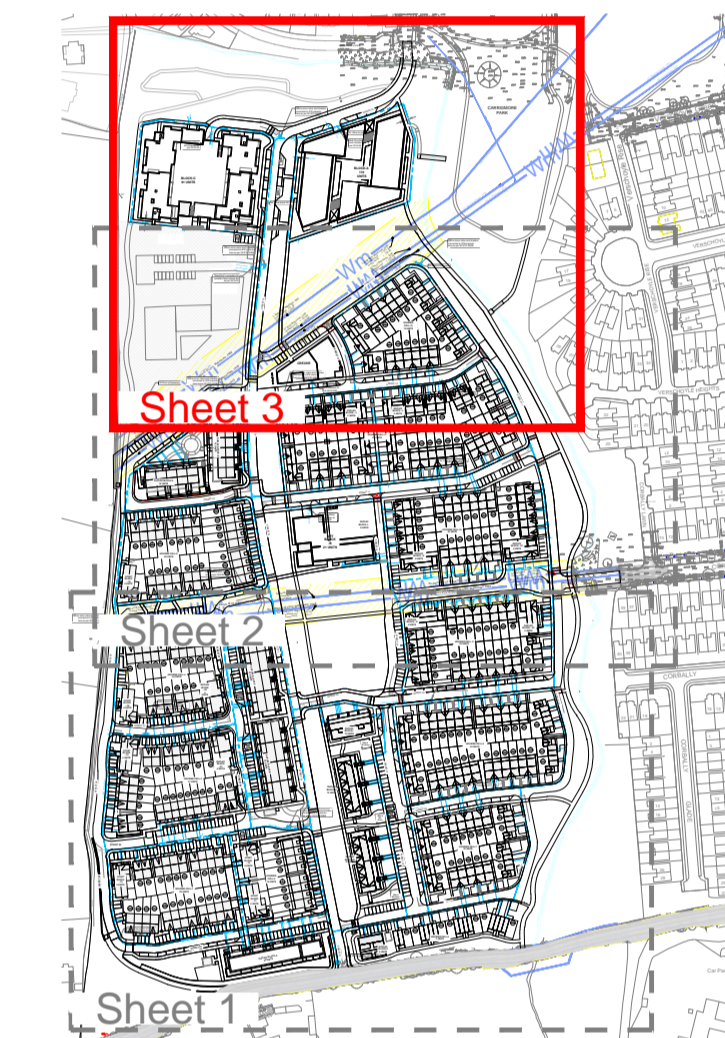

Key Plan
 A1 Scale 1:500
 A3 Scale 1:10000

Watermain Legend

- Existing Watermain
- Proposed Watermain
- Sluice Valve
- Bulk water meter
- Scour Valve
- Hydrant
- Air Valve
- Boundary Box and domestic connection

REV/DATE DESCRIPTION
ROGER MULLARKEY & ASSOCIATES
 Consulting Structural and Civil Engineers
 Duncreevan, Kilcock, Co.Kildare
 Tel: +353 1 610 3755 Mob: +353 87 232 4917
 E-mail: info@rmullarkey.ie www.rmullarkey.ie

Project
BOHERBOY

Drawing Title
WATERMAIN LAYOUT - Sheet 3
 Architect
MCORM/ DAVEY-SMITH

Date	Drawn By	Scales	Dwg.No.	Stage	Rev
Mar'20	RM	1:500 @ A1	1324B/312	PLANNING	

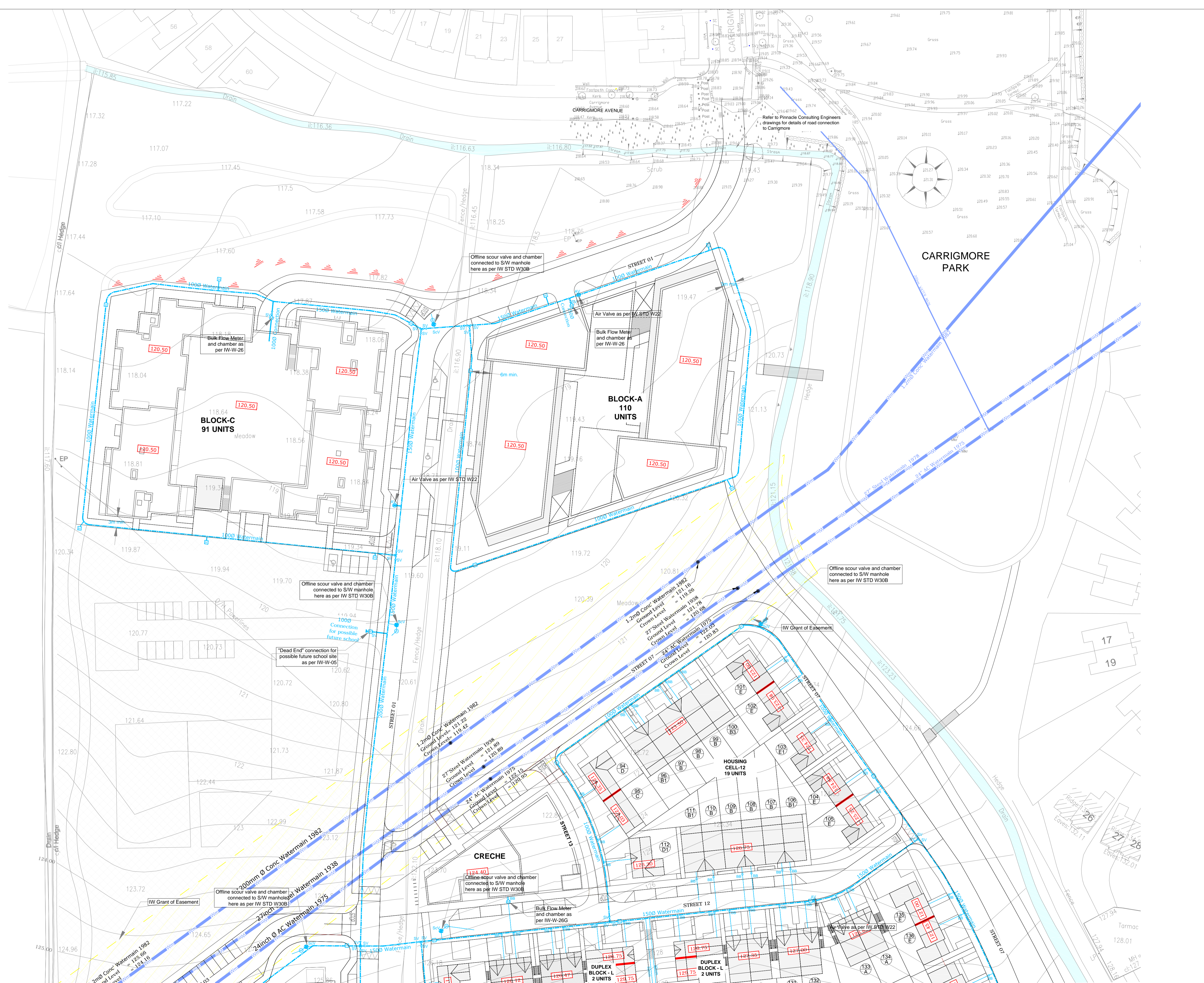

Watermain GA
 © A1 - Scale 1:500