

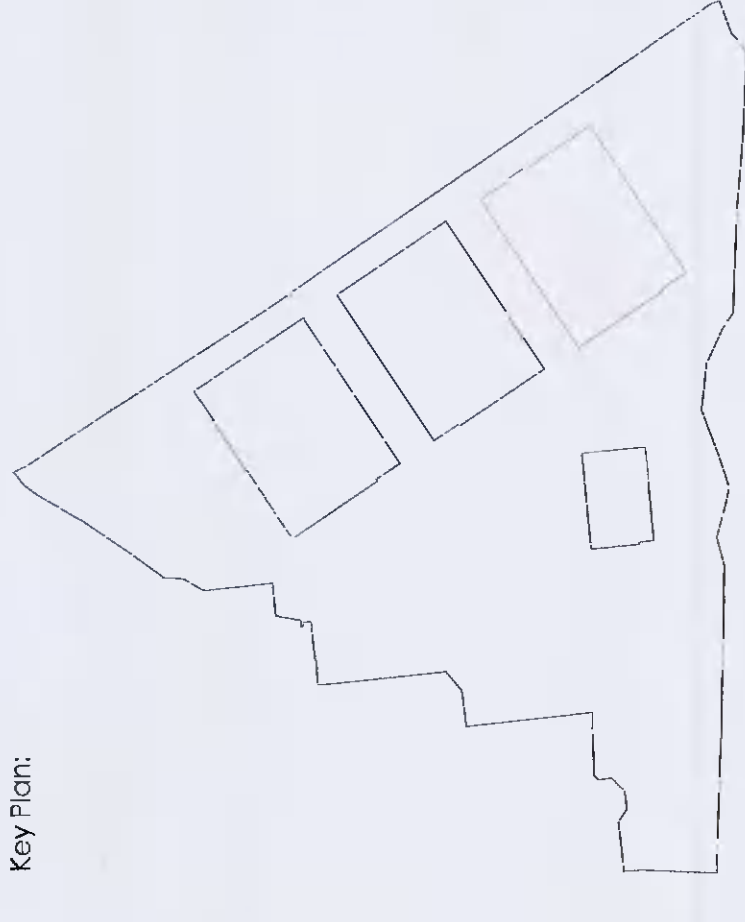

NOTES:
 1. All dimensions are in millimeters unless otherwise stated.
 2. All dimensions are to the centerline of the wall or column unless otherwise stated.
 3. All dimensions are to the centerline of the wall or column unless otherwise stated.
 4. All dimensions are to the centerline of the wall or column unless otherwise stated.
 5. All dimensions are to the centerline of the wall or column unless otherwise stated.
 6. All dimensions are to the centerline of the wall or column unless otherwise stated.
 7. All dimensions are to the centerline of the wall or column unless otherwise stated.
 8. All dimensions are to the centerline of the wall or column unless otherwise stated.
 9. All dimensions are to the centerline of the wall or column unless otherwise stated.
 10. All dimensions are to the centerline of the wall or column unless otherwise stated.

Key Plan:



Note:
 All access to be coordinated with electrical design.
 See drawings:
 01/03/2024 Electrical PCS & RCI House Elevations: Rev 3
 01/03/2024 Electrical PCS & RCI House Plan View: Rev 2

NO CHANGE PROPOSED

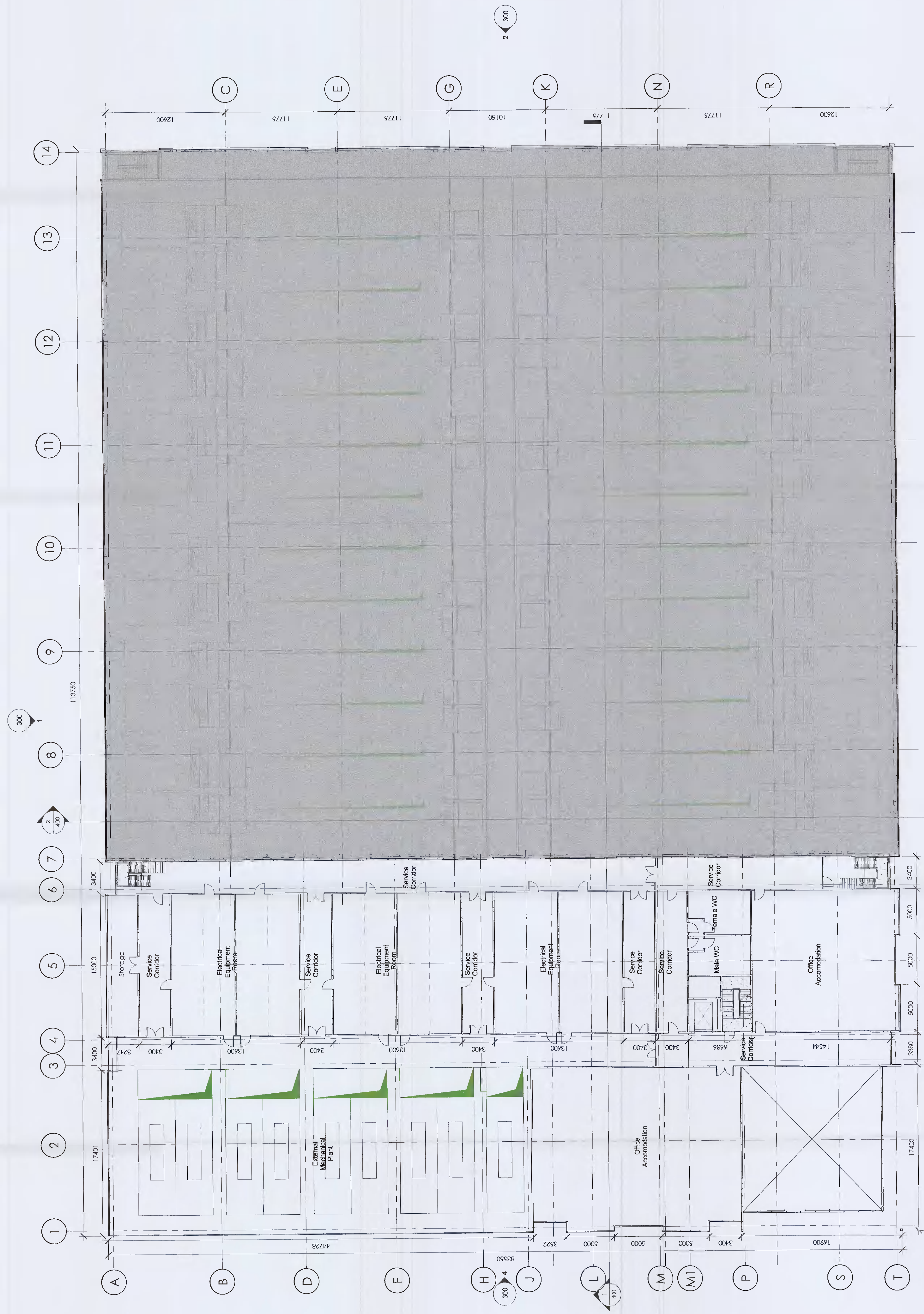

2 Building 1 - Plant Level 1 - Permitted
 1:200

FOR PLANNING
 S2 ISSUED FOR INFORMATION

ARC:MC
 M I S S I O N C R I T I C A L
 140-142 John Street, London EC1V 4PB | 020 341 1571
 REGISTERED IN ENGLAND, COMPANY NO. 2033339

CRAG DIGITAL LIMITED

PROJECT: Chesham ICT Facility
 PROJECT NO: 3183.00
 SHEET: DUB 10 - Building 1 Plant Level 1
 STATUS: - Permitted
 DRAWN: 17/03/2024 B.A.D.
 CHECKED: 17/03/2024 B.A.D.
 DATE: 17/03/2024

SCALE 200
 0 2 4 6 8 10
 M

D10-ARC-B1-P1-DR-A-220 #