

① Proposed Section A-A  
1:100

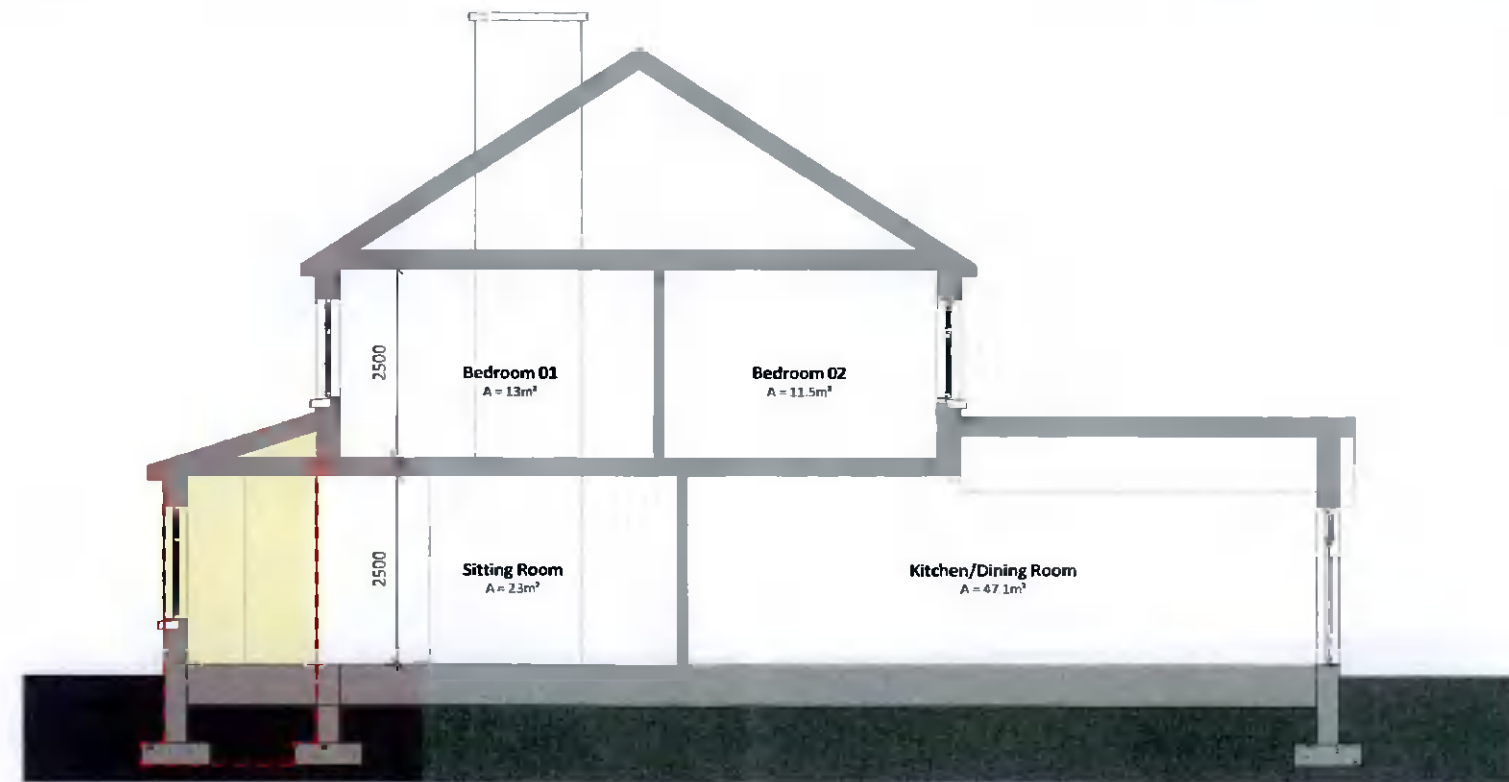

② Proposed Section B-B  
1:100

Proposed Sections

Legend			
	Extent of Proposed Works	----	Foul Water Drainage
	Walls	[AJ]	Foul Water AJ
	Site Boundary		
----	Surface Water Drainage		
[AJ]	Rainwater AJ		
	Rainwater Gutter		

**Notes on Finishes**

External wall to be brick finish to match existing  
 Windows and doors to be PVC to match existing  
 Concrete roof tiles to match the main roof  
 Rainwater goods to be black PVC to match existing

**Area Schedule**

Existing Site Area = 225 m<sup>2</sup>  
 Existing Total Floor Area = 118.3 m<sup>2</sup>  
 Proposed Extension Area = 9.4 m<sup>2</sup>  
 Proposed Total Floor Area = 127.7 m<sup>2</sup>

Revision Description	Date	Rev. No.	Issued by
For Planning	13.03.2022	P01	AQ

Figured dimensions only to be used. This drawing is copyright of O'Mahony Pike Architects Ltd. All information is shared as per approved use in accordance with ISO15650-2:2018, Table 5, Standard Codes for Suitability of Models and Documents and the BCP. If the 'Status' field is empty, this information has been shared as SD - WIP.

<b>Quinn Architectural Design Services</b>		Project No.: 2206	Scale: 1:100 @ A3
Planning Applications	Anthony Quinn BS: Home Arch Tech	Project Lead: AQ	Date Printed: 13.03.2022
Extension & Renovation	25 Elmcastle Green	Drawn By: AQ	Current Rev.: P01
Presentation	Tallaght, Dublin 24	Job No.: 2206	
Visualisation	+353 856198266 aquinn.ads@gmail.com	Purpose: Planning Permission	
Project:	Extension & Renovation		
Location:	2 Birchview Rise, Kilnamanagh		
Client:	Chris McCreevey		
Drawing Title:	Proposed Sections		
Drawing No.:	DR-A-0006		