

ROOF SLATES LAID ON 50x25 BATTENS LAID OVER UNTEARABLE ROOFING FELT. FELT TO RUN OUT OVER FILET PIECE AND INTO PVC GUTTER

ROOF TRUSS RAFTERS 150x50mm @400 C.C. ON 100x75 WALL PLATES SUPPORT WITH 175x75 PURLINS AND 150x50 HANGERS & TIES TO COMPLY WITH I.S. 193

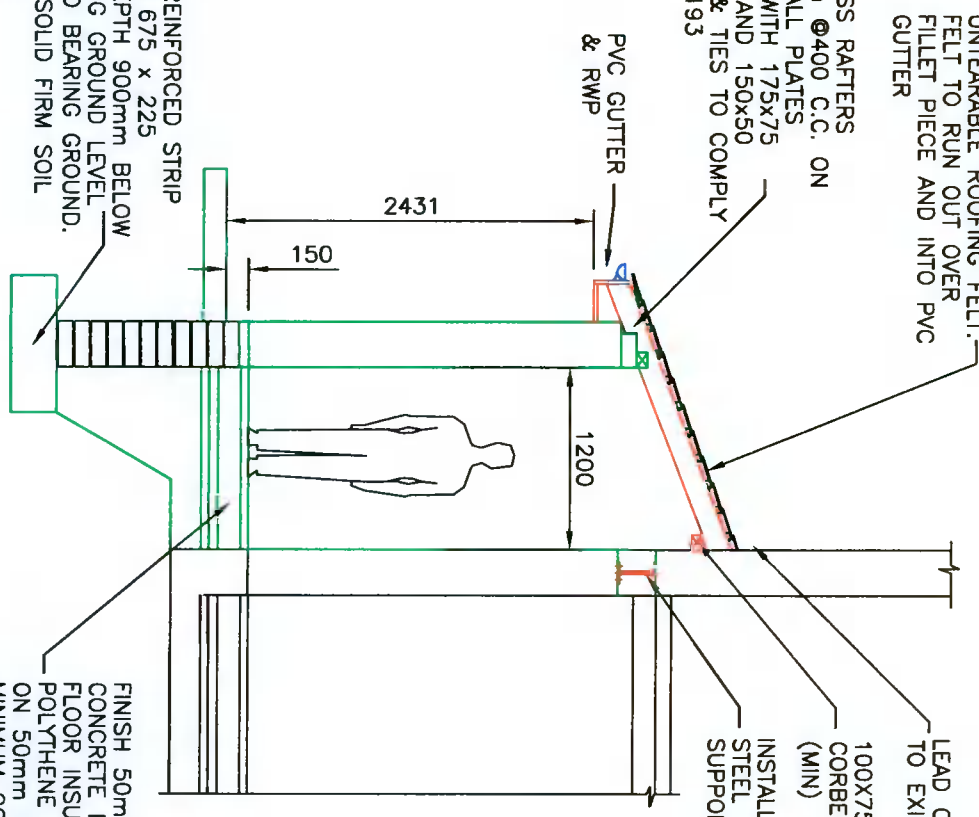

FINISH 50mm SCREED ON 100mm CONCRETE FLOOR SLAB ON 50mm FLOOR INSULATION ON 1000 GAUGE POLYTHENE DPM TURNED UP AT EDGES ON 50mm SAND BLINDING ON 150mm MINIMUM CONSOLIDATED HARDCORE DPC MINIMUM 150mm ABOVE GROUND LEVEL SOLID BLOCKWORK BELOW DPC

NOTES:  
ALL TIMBERS TO BE SCB AND IN ACCORDANCE WITH SR 11 1991 PROVIDE LATERAL SUPPORT TO WALLS WHERE THEY RUN PARALLEL TO JOISTS, BY FIXING 30x6mm GALV. M.S. STRAPS AT 2m CRS ACROSS 2 No JOISTS. SOLID NOGGING PIECES TO BE FIXED DIRECTLY UNDER STRAPS DITTO ALONG ROOF SLOPE.

255 HOLLOW CONCRETE BLOCK FINISHED AS PER EXISTING HOUSE. 90mm XTRATHERM THIN-R/TLMF (FOILBACKED) BONDED TO 12.5 PLASTERBOARD MECHANICALLY FIXED TO INNER FACE AND WITH 6mm PLASTER SKIM FINISH. PROVIDE GROUNDS AS INDICATED/REQUIRED

CONCRETE REINFORCED STRIP FOUNDATION 675 x 225 MINIMUM, DEPTH 900mm BELOW SURROUNDING GROUND LEVEL OR TO SOLID BEARING GROUND. (BASED ON SOLID FIRM SOIL CONDITIONS)

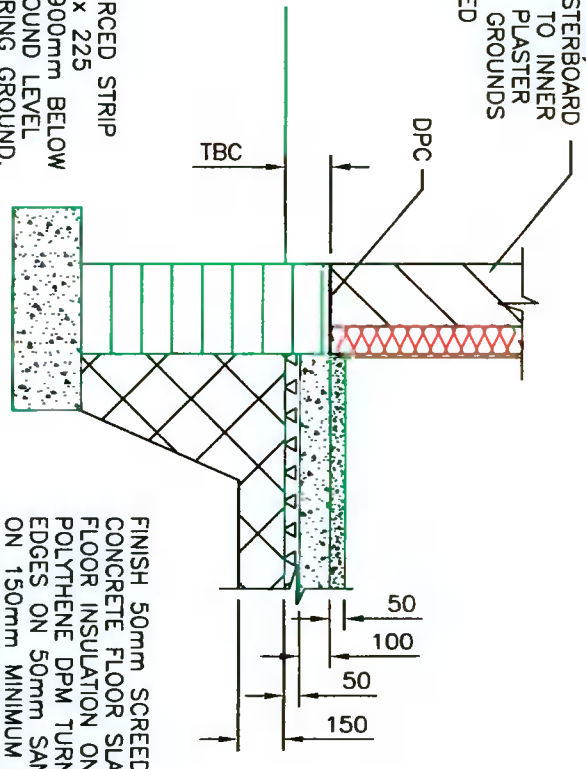

FINISH 50mm SCREED ON 100mm CONCRETE FLOOR SLAB ON 50mm FLOOR INSULATION ON 1000 GAUGE POLYTHENE DPM TURNED UP AT EDGES ON 50mm SAND BLINDING ON 150mm MINIMUM CONSOLIDATED HARDCORE DPC MINIMUM 150mm ABOVE GROUND LEVEL. SOLID BLOCKWORK BELOW DPC

**TYPICAL FOUNDATION DETAIL**

**PROPOSED SECTION VIEW**

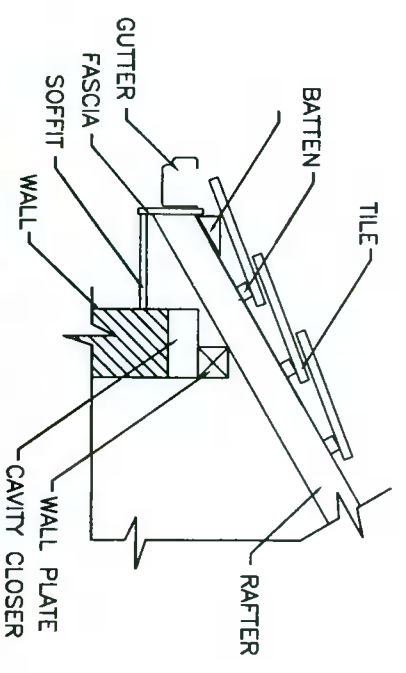

**TYPICAL ROOF DETAIL**

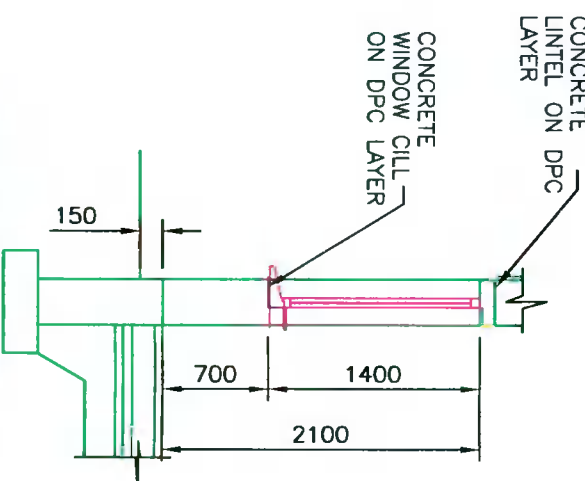

**TYPICAL WINDOW DETAIL**

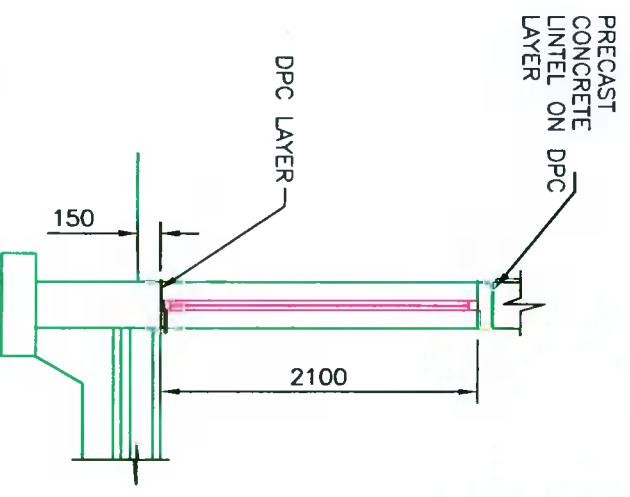

**TYPICAL EXTERNAL DOOR DETAIL**

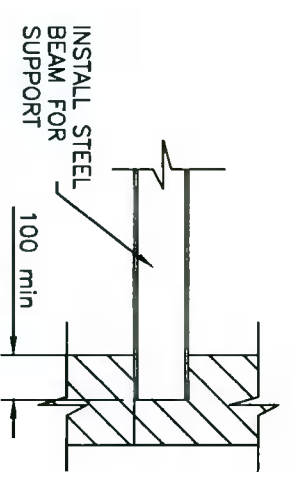

**SUPPORT DETAIL**



The information contained in this drawing is confidential and must not be divulged to any third party without the written consent of 4bes Design Services.



38 Larkfield Avenue  
Lucan  
Co. Dublin

34 Tamarisk Drive,  
Tallaght, Dublin 24,  
D24 FPR4

**PROPOSED SECTION AND DETAILS**

DRAWN	JOHN FORBES , 38 LARKFIELD AVE. , LUCAN, CO. DUBLIN
DATE	Feb 2022
SCALE	1:50 @ A3
Ronan and Nicola O'Reilly	