

GENERAL NOTES:

- FOR STANDARD DOBA NOTES REFER TO DRAWING LCC-DOB-XX-SI-DR-S00.1 & S00.2
- THIS DRAWING IS TO BE READ IN CONJUNCTION WITH ALL OTHER RELEVANT ARCHITECTS & ENGINEER'S DRAWINGS AND SPECIFICATIONS.
- USE FIGURED DIMENSIONS ONLY. DO NOT SCALE
- THE CONTRACTOR SHALL VERIFY ALL DIMENSIONS AND LEVELS WITH ARCHITECTURAL DRAWINGS PRIOR TO START OF CONSTRUCTION. ANY DISCREPANCIES TO BE NOTIFIED TO THE ENGINEER & ARCHITECT FOR RESOLUTION



REFER TO DRAWING DOBA-S-0800 FOR WORKS TO EXISTING STRUCTURE

FMH 3.1
CL: +49.450m
IL: +48.790m

CONNECT TO EX. FMH

FMH 3.0
CL: +49.450m
IL: +46.825m

MANHOLE FMH 3.0 TO BE CONSTRUCTED ON EXISTING FOUL DRAINAGE NETWORK

EXISTING FOUL NETWORK AS PER CCTV SURVEY

Note!
REFER TO ARCHITECTS DRAWINGS & SPECIFICATIONS FOR ALL LOCAL DRAINAGE, POP UPS & CONNECTION ROUTES TO MAIN DRAINAGE SYSTEMS INDICATED ON DOBA ENGINEERING DRAWINGS

Ex. FMH
CL: +49.36m
IL: +48.60m

Ex. FMH
CL: +49.58m
IL: +48.79m

Ex. FMH
CL: +49.61m
IL: +48.04m

FMH 2.2
CL: +48.450m
IL: +47.887m

EXISTING FOUL CONNECTIONS FROM SCHOOL BUILDING TO BE CONNECTED TO NEW FOUL NETWORK FOLLOWING REMOVAL OF EXISTING FOUL DRAINAGE NETWORK

FMH 2.1
CL: +48.1

Ex. FMH
CL: +50.29m
IL: +49.76m

FMH 2.0
CL: +49.450m
IL: +48.550m

FMH 1.0
CL: +49.450m
IL: +48.850m

FMH 1.1
CL: +49.450m
IL: +48.468m

FMH 1.2
CL: +48.450m
IL: +48.257m

NOTES:

- REFER TO SURVEY DRAWINGS FOR EXISTING SERVICES LAYOUTS AND MANHOLE INFORMATION
- DECOMMISSIONING & REMOVAL OF SERVICES TO TAKE PLACE FOLLOWING DEANTING OF SCHOOL FROM EFFECTED BUILDINGS U.N.O.
- WORKS TAKING PLACE OUTSIDE OF DESIGNATED CONTRACTORS SITE ARE TO BE CARRIED OUT DURING SCHOOL HOLIDAY PERIODS
- ALL EXISTING SURFACES TO BE REINSTATED FOLLOWING DIVERSION OF SERVICES/CONSTRUCTION OF NEW SERVICES AT PHASE 0
- FOR TYPICAL MANHOLE DETAILS REFER TO DRAWING DOBA-C-0013

PIPE SIZES:

- ALL PIPE RUNS BETWEEN MANHOLES TO BE 2250 U.N.O
- ALL PIPE RUNS BETWEEN INSPECTION CHAMBERS TO BE 1500 U.N.O
- ALL PIPE RUNS BETWEEN AJs AND FROM RAINWATER PIPES OR GULLIES TO BE 1100 U.N.O

LEGEND

- EXISTING FOUL WATER SEWER
- PROPOSED FOUL WATER SEWER
- PROPOSED LOCAL FOUL DRAINAGE TO ARCHITECTS DESIGN & DETAIL
- FMH PROPOSED FOUL WATER MH
- FIC PROPOSED INSPECTION CHAMBER
- FAJ PROPOSED FOUL WATER AJ
- FOUL POP-UP

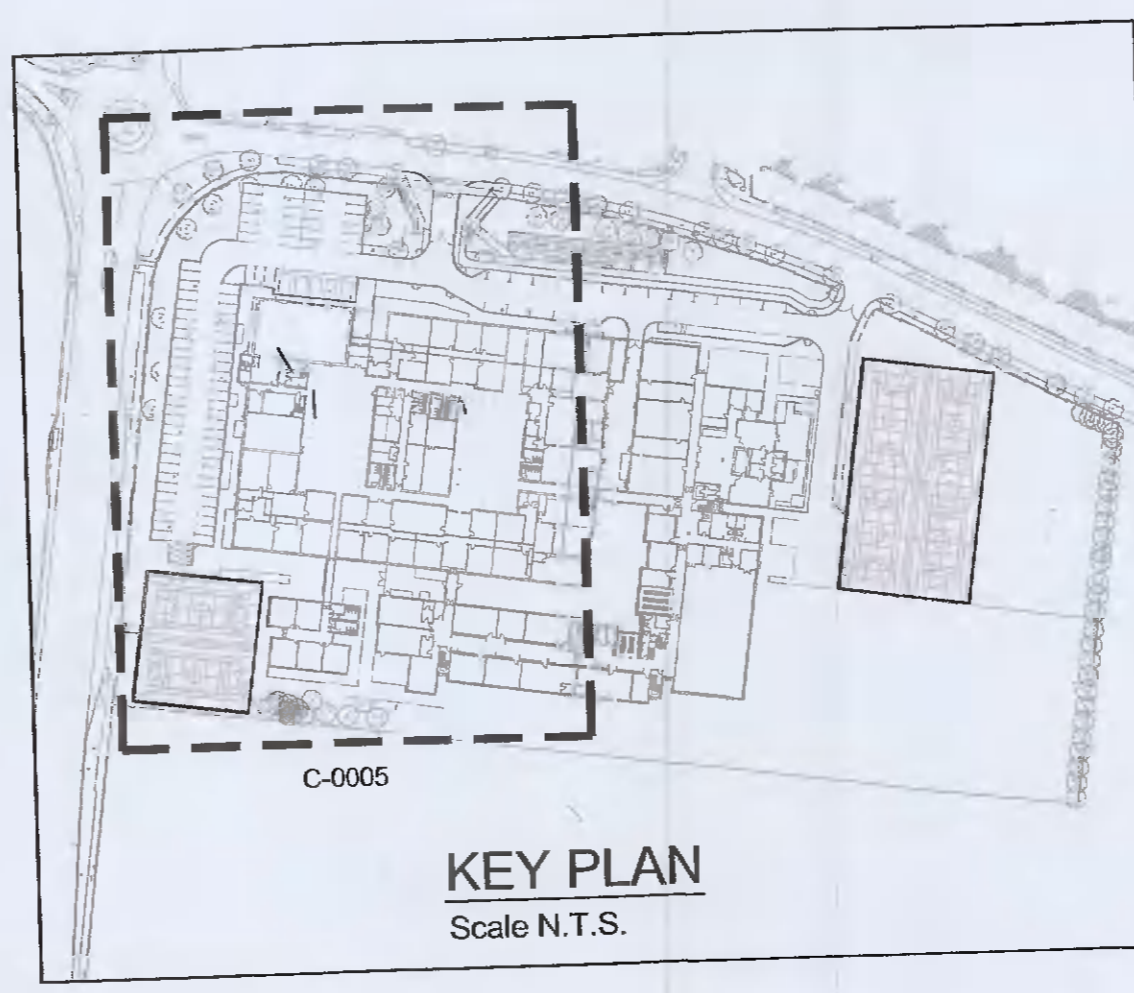

ISSUED FOR PLANNING

S4.P01	ISSUED FOR PLANNING	15.02.2022	TN	RK
Rev.	Note	Date	Drawn	Check
<p>DONNACHADH O'BRIEN & ASSOCIATES CONSULTING ENGINEERS</p> <p>UNIT 5C RIM HOUSE MILLERSKILL PARK NAAS CO. KILDARE</p> <p>PHONE: +353 45 984 042 WWW.DOBRIEN-ENGINEERS.IE</p>		<p>Client: DUBLIN & DUN LAOGHAIRE ETB</p> <p>Project: LUCAN COMMUNITY COLLEGE</p> <p>Drawing Title: FOUL DRAINAGE SHEET 1 OF 2</p>		
Drawn By: RR	Checked By: RK	Approved By: DOB	Date: MAY '17	Scale: 1:250
Project Number: DOBA1446	Drawing Number: LCC-DOB-XX-SI- DR-C-0005	Status Code: S4	Rev Number: P01	Sheet Size: A1