

GENERAL NOTES:

- FOR STANDARD DOBA NOTES REFER TO DRAWING LCC-DOB-XX-SI-DR-S00.1 & S00.2
- THIS DRAWING IS TO BE READ IN CONJUNCTION WITH ALL OTHER RELEVANT ARCHITECTS & ENGINEERS DRAWINGS AND SPECIFICATIONS
- USE FIGURED DIMENSIONS ONLY. DO NOT SCALE
- THE CONTRACTOR SHALL VERIFY ALL DIMENSIONS AND LEVELS WITH ARCHITECTURAL DRAWINGS PRIOR TO START OF CONSTRUCTION. ANY DISCREPANCIES TO BE NOTIFIED TO THE ENGINEER & ARCHITECT FOR RESOLUTION
- FOR ALL WATERMAIN DETAILS REFER TO DRAWINGS LCC-DOB-XX-SI-DR-C-0015, LCC-DOB-XX-SI-DR-C-0016 & LCC-DOB-XX-SI-DR-C-0017



NEW FIRE-FIGHTING WATER STORAGE TANK REQUIRED. CAPACITY TO BE 126m³. 5 No. PRECAST CONCRETE TANKS SIDE BY SIDE (26m³ CAPACITY EACH) WITH A SUMP TANK CHAMBER FITTED WITH 100mm DIAM. STAINLESS STEEL PIPE WITH STRAINER AT BASE TO ALLOW 3000l/s FLOW - SEE DRAWING 1446-C-0023 FOR DETAILS. CONSTRUCT TANKS UNDERGROUND IN GREEN SPACE TO FRONT OF SCHOOL

EXISTING WATERMAIN INFRASTRUCTURE OUTSIDE OF SITE AS PER IRISH WATER DRAWINGS

NOTE: ALLOW FOR DIVERSION OF EXISTING SERVICES DURING CONSTRUCTION

EX. HYDRANT TO BE RELOCATED

PROVIDE NEW WATERMAIN CONNECTION FEED TO TANK FROM EXISTING WATERMAIN INCLUDING BALL VALVE STOP-COCK FOR FILLING PURPOSES IN INSPECTION CHAMBER.

ASSUMED CONTINUATION OF EXISTING WATERMAIN (NOT PICKED UP ON SURVEY) TO BE DIVERTED AROUND PROPOSED EXTENSION. CONTRACTOR TO VERIFY LOCATION ON SITE WITH SLIT TRENCHING

NOTE: ALLOW FOR DIVERSION OF EXISTING WATERMAIN

Note!

- DIVERSION OF WATERMAIN TO BE PHASED. DIVERSION OF WATERMAIN AROUND NEW BUILDING TO TAKE PLACE EARLY IN CONTRACT
- DIVERSION OF WATERMAIN THROUGH NEW BALLCOURTS & CAR PARKING TO TAKE PLACE FOLLOWING REMOVAL OF PREFABS

HYDRANT LOCATED NOT MORE THAN 30m FROM HARDSTANDING

NOTES:

- REFER TO SURVEY DRAWINGS FOR EXISTING SERVICES LAYOUTS AND MANHOLE INFORMATION
- DECOMMISSIONING & REMOVAL OF SERVICES TO TAKE PLACE FOLLOWING DECAINTING OF SCHOOL FROM EFFECTED BUILDINGS U.N.O.
- WORKS TAKING PLACE OUTSIDE OF DESIGNATED CONTRACTORS SITE ARE TO BE CARRIED OUT DURING SCHOOL HOLIDAY PERIODS
- ALL EXISTING SURFACES TO BE REINSTATED FOLLOWING DIVERSION OF SERVICES/CONSTRUCTION OF NEW SERVICES AT PHASE 0

NOTE: WATERMAIN TO BE HDPE TYPE PE-100 SDR 11 ALL WATERMANS DETAILS TO BE IN ACCORDANCE WITH THE IRISH WATER INFRASTRUCTURE STANDARD DETAILS IW-CDS-5020-01

WATERMAIN LEGEND

- EXISTING WATERMAIN
- EXISTING WATERMAIN TO BE REMOVED
- PROPOSED WATERMAIN
- HYDRANT
- WATER METER
- REMOTE TELEMETRY UNIT
- AIR VALVE
- SLUICE VALVE
- SCOUR VALVE
- THRUST BLOCK

!NOTE
EXISTING WATERMAIN SHOWN IS INDICATIVE ONLY. CONTRACTOR IS RESPONSIBLE FOR LOCATING ON SITE, MAINTAINING FULL SERVICE FOR EX. BUILDING & CO-ORDINATING ITS DIVERSION WITH OTHER SERVICES

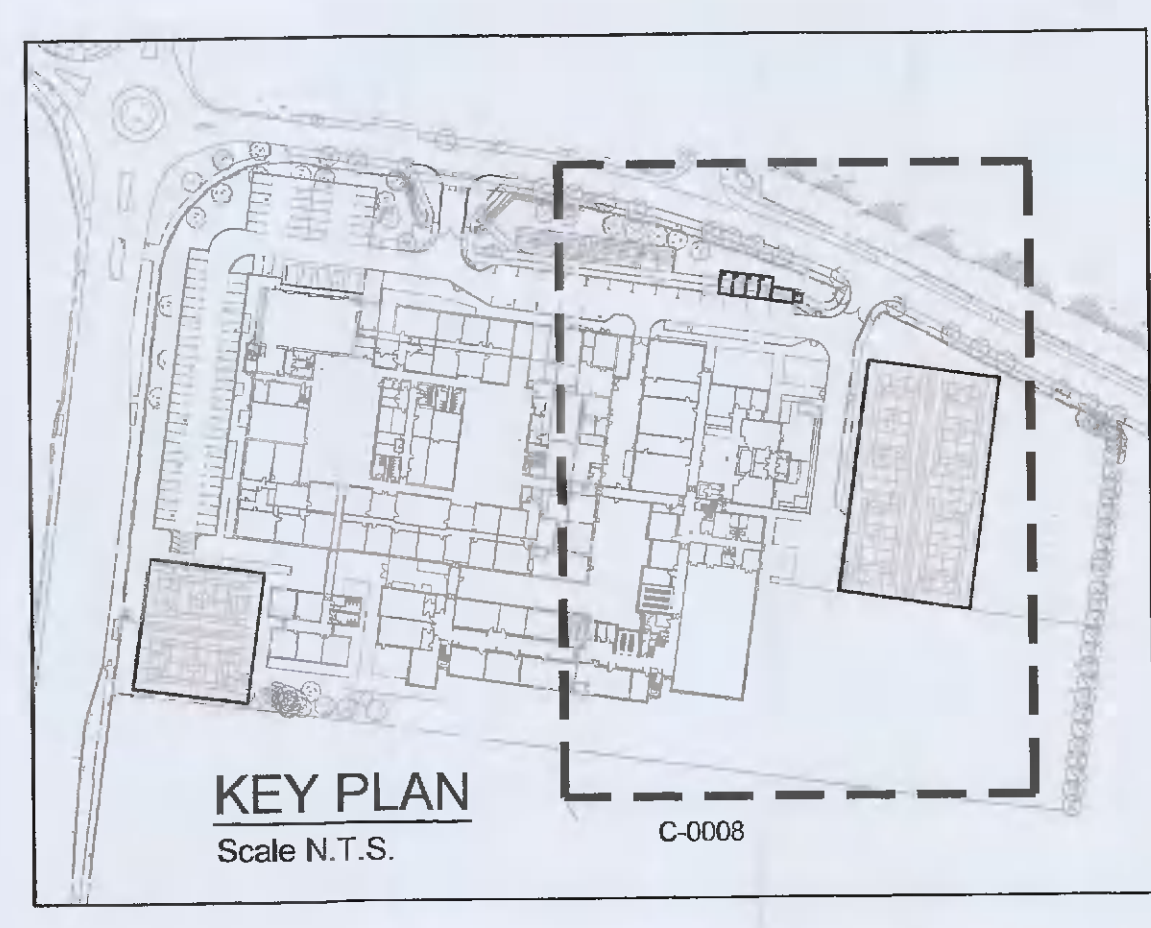

ISSUED FOR PLANNING

S4.P01	ISSUED FOR PLANNING	15.02.2022	TN	RK
Rev.	Note	Date	Drawn	Check
DONNACHADH O'BRIEN & ASSOCIATES CONSULTING ENGINEERS		UNIT 5C ELM HOUSE MILLENNIUM PARK NAAS CO. KILDARE	PHONE: +353 45 984 042 INFO@DOBRIEN-ENGINEERS.IE WWW.DOBRIEN-ENGINEERS.IE	
Client:		DUBLIN & DUN LAOGHAIRE ETB		
Project:		LUCAN COMMUNITY COLLEGE		
Drawing Title:		WATERMAIN LAYOUT SHEET 2 OF 2		
Drawn By:	Checked By:	Approved By:	Date:	Scale:
RR	RK	DOB	SEPT '16	1:250
Project Number:	Drawing Number:	Status Code:	Rev Number:	
DOBA1446	LCC-DOB-XX-SI- DR-C-0008	S4	P01	