

GENERAL NOTES:

- FOR STANDARD DOBA NOTES REFER TO DRAWING LCC-DOB-XX-XX-DR-S00.1 & S00.2
- THIS DRAWING IS TO BE READ IN CONJUNCTION WITH ALL OTHER RELEVANT ARCHITECT'S & ENGINEER'S DRAWINGS AND SPECIFICATIONS.
- USE FIGURED DIMENSIONS ONLY. DO NOT SCALE
- THE CONTRACTOR SHALL VERIFY ALL DIMENSIONS AND LEVELS WITH ARCHITECTURAL DRAWINGS PRIOR TO START OF CONSTRUCTION. ANY DISCREPANCIES TO BE NOTIFIED TO THE ENGINEER & ARCHITECT FOR RESOLUTION



REFER TO DRAWING DOBA-S-0800 FOR WORKS TO EXISTING STRUCTURE

MANHOLE FMH 3.0 TO BE CONSTRUCTED ON EXISTING FOUL DRAINAGE NETWORK

EXISTING FOUL NETWORK AS PER CCTV SURVEY

EXISTING FOUL CONNECTIONS FROM SCHOOL BUILDING TO BE CONNECTED TO NEW FOUL NETWORK FOLLOWING REMOVAL OF EXISTING FOUL DRAINAGE NETWORK

Note!
REFER TO ARCHITECTS DRAWINGS & SPECIFICATIONS FOR ALL LOCAL DRAINAGE, POP UPS & CONNECTION ROUTES TO MAIN DRAINAGE SYSTEMS INDICATED ON DOBA ENGINEERING DRAWINGS

NOTES:

- REFER TO SURVEY DRAWINGS FOR EXISTING SERVICES LAYOUTS AND MANHOLE INFORMATION
- DECOMMISSIONING & REMOVAL OF SERVICES TO TAKE PLACE FOLLOWING DECANTING OF SCHOOL FROM EFFECTED BUILDINGS U.N.O.
- WORKS TAKING PLACE OUTSIDE OF DESIGNATED CONTRACTORS SITE ARE TO BE CARRIED OUT DURING SCHOOL HOLIDAY PERIODS
- ALL EXISTING SURFACES TO BE REINSTATED FOLLOWING DIVERSION OF SERVICES/CONSTRUCTION OF NEW SERVICES AT PHASE 0
- FOR TYPICAL MANHOLE DETAILS REFER TO DRAWING DOBA-C-0013

PIPE SIZES:

- ALL PIPE RUNS BETWEEN MANHOLES TO BE 2250 U.N.O
- ALL PIPE RUNS BETWEEN INSPECTION CHAMBERS TO BE 1500 U.N.O
- ALL PIPE RUNS BETWEEN AJs AND FROM RAINWATER PIPES OR GULLIES TO BE 1100 U.N.O

LEGEND

- EXISTING FOUL WATER SEWER
- PROPOSED FOUL WATER SEWER
- PROPOSED LOCAL FOUL DRAINAGE TO ARCHITECTS DESIGN & DETAIL
- FMH PROPOSED FOUL WATER MH
- FIC PROPOSED INSPECTION CHAMBER
- FAJ PROPOSED FOUL WATER AJ
- FOUL POP-UP

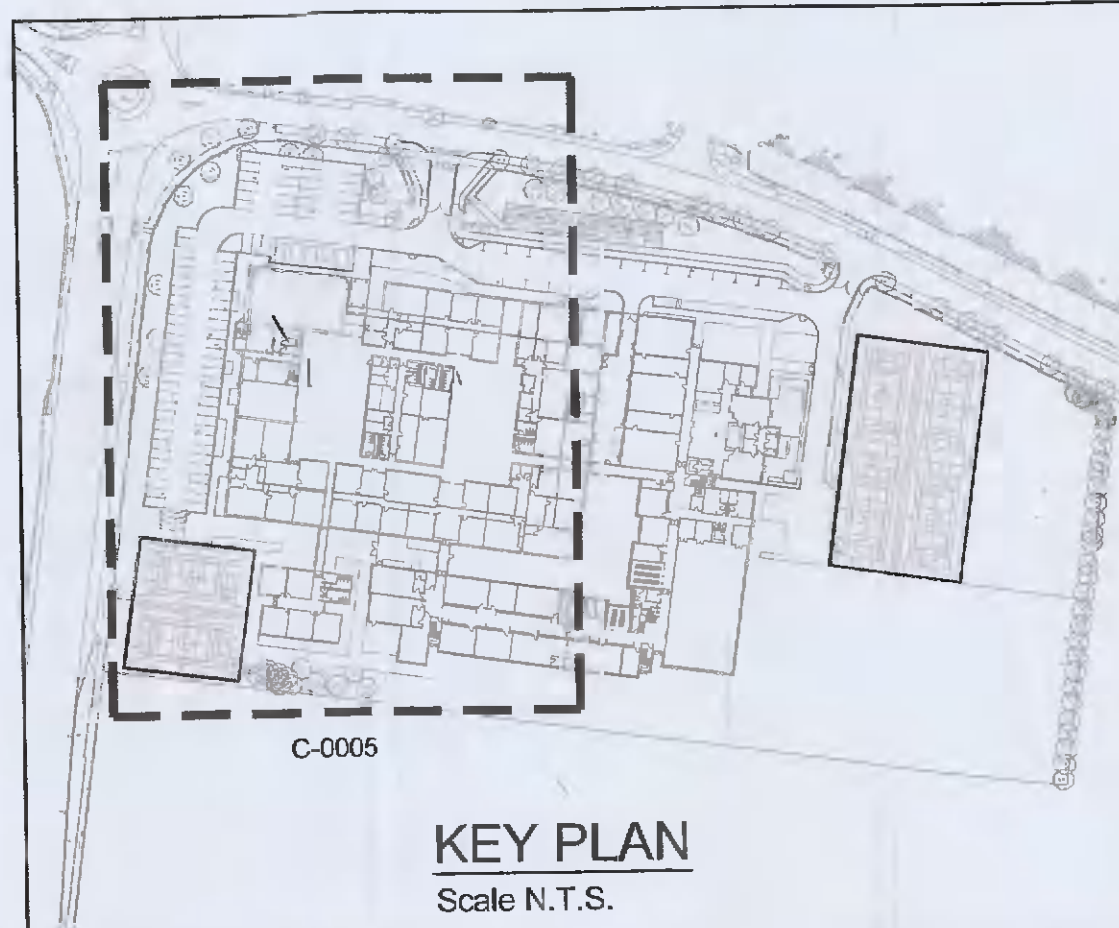

ISSUED FOR PLANNING

S4.P01	ISSUED FOR PLANNING	15.02.2022	TN	RK
Rev.	Note	Date	Drawn	Check
DONNACHADH O'BRIEN & ASSOCIATES CONSULTING ENGINEERS		UNIT 5C BLM HOUSE MILLERSHILL PARK NAAS CO. KILDARE		PHONE +353 45 984 042 INFO@DOBRIEN-ENGINEERS.IE WWW.DOBRIEN-ENGINEERS.IE
Client:	DUBLIN & DUN LAOGHAIRE ETB			
Project:	LUCAN COMMUNITY COLLEGE			
Drawing Title:	FOUL DRAINAGE SHEET 1 OF 2			
Drawn By:	Checked By:	Approved By:	Date:	Scale:
RR	RK	DOB	MAY '17	1:250
Project Number:	Drawing Number:	Status Code:	Rev Number:	
DOBA1446	LCC-DOB-XX-SI- DR-C-0005	S4	P01	